

Property Identification

Site Address: 801 FLORIDA AVE
 Sec/Town/Range: 10/35S/40E
 Map ID: 24/10S
 Zoning: R1

Parcel ID: 2410-709-0121-000-5
 Account #: 23714
 Use Type: 0100
 Jurisdiction: Fort Pierce

Ownership

Robert S Cheyne
 Kristen K Cheyne
 801 Florida Ave
 Fort Pierce, FL 34950

Legal Description

OAKLAND PARK BLK 14 LOTS 1 AND 4 ANDE 5 FT OF VAC ALLEY
 ADJ ON W (MAP 24/10F) (OR 2902-1949)

Current Values

Just/Market Value: \$61,800
 Assessed Value: \$56,885
 Exemptions: \$31,885
 Taxable Value: \$25,000

Taxes for this parcel: SLC Tax Collector's Office 



Total Areas

Finished/Under Air (SF): 2,284
 Gross Area (SF): 2,629
 Land Size (acres): 0.31
 Land Size (SF): 13,500

Sale History

Date	Book/Page	Sale Code	Deed	Grantor	Price
Nov 5, 2007	2902 / 1949	00	WD	Neill,Nancy M	\$250,000
Jul 29, 2005	2327 / 0681	01	PB	Manchester (EST),Helen A	\$0
Aug 1, 1973	0217 / 0659	00	CV		\$45,000

Building Information (1 of 1)

Finished Area: 2,284 SF
 Gross Total Area: 2,629 SF

Exterior Data

View:	Roof Cover: Metal	Roof Structure: Hip
Building Type: HC-	Year Built: 1938	Frame:
Grade: C-	Effective Year: 1970	Primary Wall: Wood no Sh
Story Height: 2 Story	No. Units: 1	Secondary Wall:

Interior Data

Bedrooms: 4	Electric: MAXIMUM	Primary Int Wall:
Full Baths: 2	Heat Type: FredHotAir	Avg Hgt/Floor: 0
Half Baths: 0	Heat Fuel: ELEC	Primary Floors: Hardwood
A/C %: 50%	Heated %: 50%	Sprinkled %: 0%

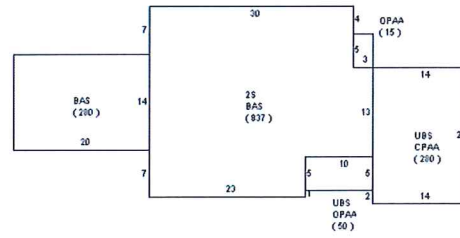

Sketch Area Legend

Sub Area	Description	Area	Fin. Area	Perimeter
2S	ONE FULL STORY OVER BASE (TOTAL 2 FLOORS)	837	837	122
BAS	BASE AREA	1117	1117	190
CPAA	Carport Attached Average	280	0	68
OPAA	Open Porch Attached Average	65	0	46
UBS	UPPER BASE AREA+1	330	330	98

Special Features and Yard Items

Type	Qty	Units	Year Blt
------	-----	-------	----------

Current Year Values

Current Values Breakdown		Current Year Exemption Value Breakdown				
		Tax Year	Grant Year	Code	Description	Amount
Building:	\$50,600					
Land:	\$11,200	2015	2008	0500	Homestead Exemption	\$25,000
Just/Market:	\$61,800	2015	2008	0550	Homestead Exemption over \$50,000	\$6,434
Ag Credit:	\$0					
Save Our Homes or 10% Cap:	\$4,915					
Assessed:	\$56,885					
Exemption(s):	\$31,885					
Taxable:	\$25,000					

Current Year Special Assessment Breakdown

Start Year	AssessCode	Units	Description	Amount
1999	0041	1	Fort Pierce Stormwater Charge	\$54.00

This does not necessarily represent the total Special Assessments that could be charged against this property. The total amount charged for special assessments is reflected on the most current tax statement and information is available with the SLC Tax Collector's Office.

Historical Values

Year	Just/Market	Assessed	Exemptions	Taxable
2015	\$61,800	\$56,885	\$31,885	\$25,000
2014	\$59,700	\$56,434	\$31,434	\$25,000
2013	\$55,600	\$55,600	\$30,600	\$25,000

0800000085

Apr 8, 2008

Air Conditioning
Only

\$4,975

\$75

Notice: This does not necessarily represent all the permits for this property.
Click the following link to check for additional permit data in Fort Pierce

This information is believed to be correct at this time but it is subject to change and is not warranted.
© Copyright 2016 Saint Lucie County Property Appraiser. All rights reserved.

