

Property Identification

Site Address: 920 GEORGIA AVE
 Sec/Town/Range: 10/35S/40E
 Map ID: 24/10S
 Zoning: R1

Parcel ID: 2410-710-0019-000-1
 Account #: 23743
 Use Type: 0100
 Jurisdiction: Fort Pierce

Ownership

John F R Morris
 Kara Y Wood
 1717 S US Hwy 1 Ste 5 PMB 668
 Fort Pierce, FL 34950

Legal Description

NEBRASKA COURT S/D BLK 4 S 10 FTOF LOT 2 AND ALL LOT 3
 AND E 5 FT OFVAC ALLEY ADJ ON W (MAP 24/10F) (OR 3627-1712)

Current Values

Just/Market Value: \$35,600
 Assessed Value: \$35,600
 Exemptions: \$0
 Taxable Value: \$35,600

Taxes for this parcel: SLC Tax Collector's Office

Download TRIM for this parcel: [Download PDF](#)



Total Areas

Finished/Under Air (SF): 1,984
 Gross Area (SF): 2,062
 Land Size (acres): 0.19
 Land Size (SF): 8,151

Sale History

Date	Book/Page	Sale Code	Deed	Grantor	Price
Apr 29, 2014	3627 / 1712	0001	WD	Musick, Vegenia J	\$42,500
Feb 18, 2010	3172 / 2791	0114	WD	Newton, Josiah P	\$100
Jan 1, 1900					\$0

Building Information (1 of 1)

Finished Area: 1,984 SF

Gross Total Area: 2,062 SF

Exterior Data

View:	Roof Cover: Dim Shingle	Roof Structure: Gable
Building Type: HD	Year Built: 1930	Frame:
Grade: D	Effective Year: 1970	Primary Wall: CB Stucco
Story Height: 1 Story	No. Units: 1	Secondary Wall: Frm Stucco

Interior Data

Bedrooms: 4	Electric: AVERAGE	Primary Int Wall:
Full Baths: 2	Heat Type:	Avg Hgt/Floor: 0
Half Baths: 0	Heat Fuel:	Primary Floors: Carpet
A/C %: 0%	Heated %: 0%	Sprinkled %: 0%

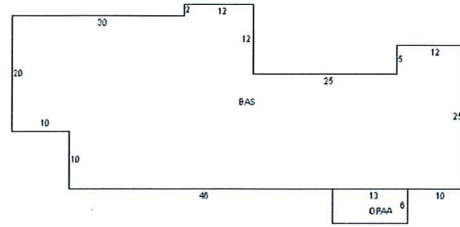

Sketch Area Legend

Sub Area	Description	Area	Fin. Area	Perimeter
BAS	BASE AREA	1984	1984	232
OPAA	Open Porch Attached Average	78	0	38

Special Features and Yard Items

Type	Qty	Units	Year Blt
------	-----	-------	----------

Current Year Values

Current Values Breakdown		Current Year Exemption Value Breakdown				
		Tax Year	Grant Year	Code	Description	Amount
Building:	\$28,700					
Land:	\$6,900					
Just/Market:	\$35,600					
Ag Credit:	\$0					
Save Our Homes or 10% Cap:	\$0					
Assessed:	\$35,600					
Exemption(s):	\$0					
Taxable:	\$35,600					

Current Year Special Assessment Breakdown

Start Year	AssessCode	Units	Description	Amount
1999	0041	1	Fort Pierce Stormwater Charge	\$54.00

This does not necessarily represent the total Special Assessments that could be charged against this property. The total amount charged for special assessments is reflected on the most current tax statement and information is available with the SLC Tax Collector's Office.

Historical Values

Year	Just/Market	Assessed	Exemptions	Taxable
2016	\$35,600	\$35,600	\$0	\$35,600
2015	\$36,700	\$36,700	\$0	\$36,700

Permits

Number	Date	Description	Amount	Fee
F900001158	Sep 4, 1990	Roof	\$2,000	\$2,000
F910001072	Aug 20, 1991	Roof	\$1,000	\$1,000
RF2004243	Oct 21, 2004	Roof	\$7,000	\$195
BP04-7980	May 15, 2014	Re Roof Permit	\$7,000	\$129
BP14-3069	Jan 20, 2015	Wood Fence	\$900	\$80

Notice: This does not necessarily represent all the permits for this property.
Click the following link to check for additional permit data in Fort Pierce

This information is believed to be correct at this time but it is subject to change and is not warranted.
© Copyright 2016 Saint Lucie County Property Appraiser. All rights reserved.