

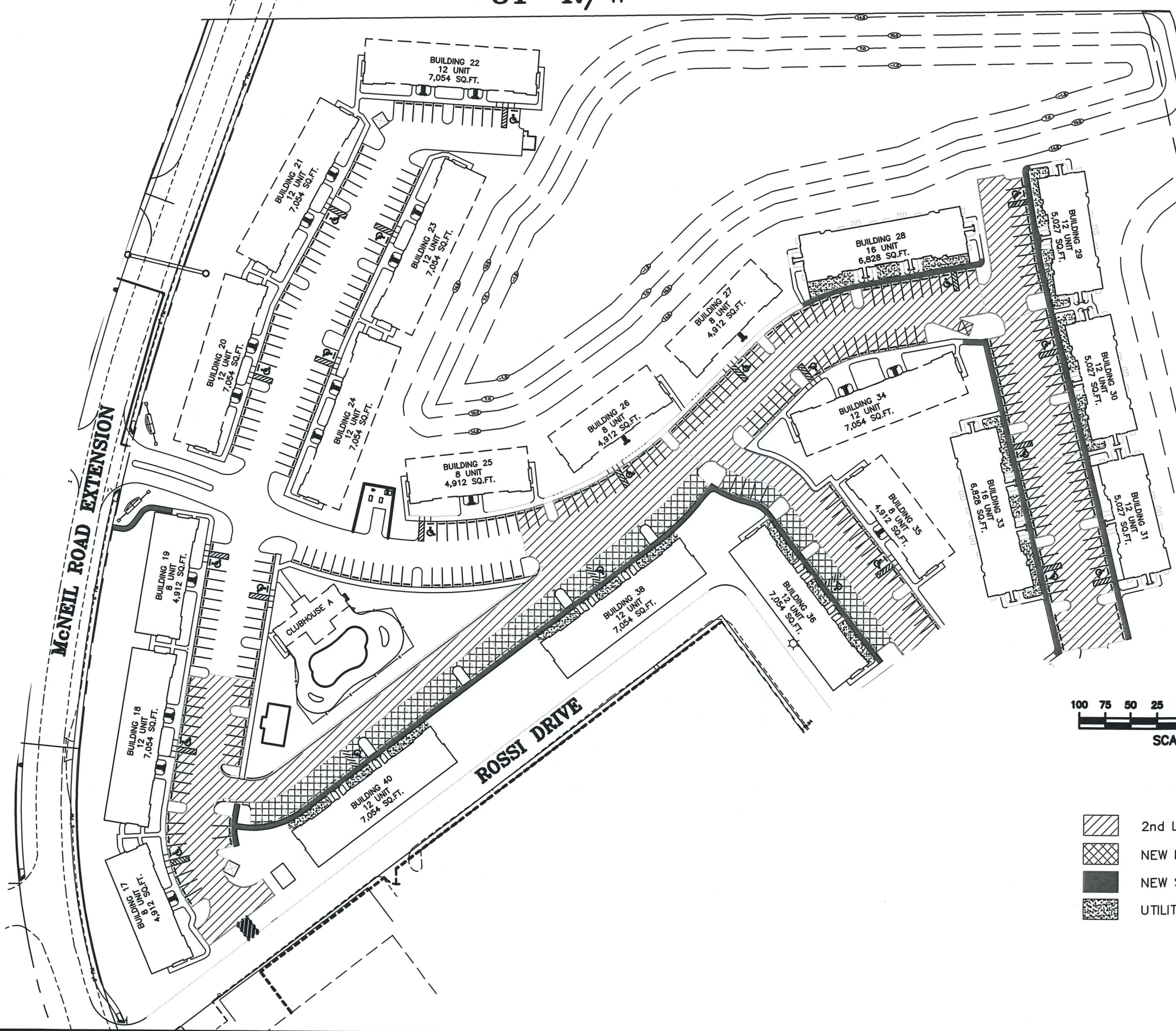



NSLRWCD CANAL No. 37
81' R/W

NORTH SECTION LINE 19

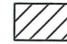

FIVE MILE CREEK
NSLRWCD CANAL No. 29
131' R/W



-  2nd LIFT 3/4" ASPHALT
-  NEW PAVEMENT
-  NEW SIDEWALK
-  UTILITY REVISION

DATE	4/19/2017
DRAWN BY	CLG
F.B./ PG.	00000
SCALE	00000
JOB NO.	7795

REVISIONS	DATE	BY

CAULFIELD & WHEELER, INC.
CIVIL ENGINEERING - LAND SURVEYING
7900 GLADES ROAD - SUITE 100
BOCA RATON, FLORIDA 33434
PHONE (561)-392-1991 / FAX (561)-750-1452



PORTOFINO LANDINGS
IMPROVEMENTS EXHIBIT
FORT PIERCE, FLORIDA