



THE SUNRISE CITY  
**FORT PIERCE**  
ENGINEERING  
DEPARTMENT

**FORT PIERCE**  
*Florida*



**TO : Vennis Gilmore, Planner**

**FROM : John R. Andrews, P.E., City Engineer**

**RE : Portofino Landings Final Plat – Okeechobee & McNeil  
TRC No. 17-09000001**

**DATE : May 2, 2017**

This is to advise you that we have completed the review of the following documents as received by this office on May 1, 2017:

- |   |  |
|---|--|
| <input checked="" type="checkbox"/> Final Plat  | <input type="checkbox"/> P/D Drawings  |
| <input type="checkbox"/> Test Reports & Related Documents                                 | <input type="checkbox"/> Certificate of Completion                               |
| <input type="checkbox"/> Record Drawings  | <input type="checkbox"/> Permits from applicable Local, State & Federal Agencies |
| <input type="checkbox"/> Clearances from all applicable Local, State and Federal Agencies |  |

Based on our reviews and appropriate site final inspection, we

- |  |  |                              |
|--|--|------------------------------|
| <input checked="" type="checkbox"/> Recommend conditional approval | <input type="checkbox"/> Do not recommend approval |                              |
| <input checked="" type="checkbox"/> Final Plat                     | <input type="checkbox"/> Building Permit           | <input type="checkbox"/> C/O |

Developer, Owner, Engineer, Contractor and other members of the Development Team must be aware, the above recommendation is based only on the construction requirements of the engineering plans and other engineering documentation approved by this department. The Development Team shall be responsible for the compliance with other City department requirements and all approved documents, as well as Local, State and Federal regulations. The development requirements for this project may necessitate additional construction requirements that are not subject to this department's review for approval.

- See attached for conditions of approval

ENGINEERING COMMENTS:

1. The certified Engineer's Opinion of Cost and exhibit depicting the areas of outstanding work has been reviewed and approved and is being forwarded to you for attachment to the Developer's Agreement.
2. Advisory Comment: Prior to endorsing the final plat the developer will be required to enter into an agreement with the City of Fort Pierce and post the appropriate bond regarding the completion of the outstanding site work.

JRA/TST/tst

**CAULFIELD & WHEELER, INC.**

7900 Glades Road, Boca Raton, Florida 33434 • (561) 392-1991 • FAX (561) 750-1452

Land Development Permit No.  
Control No.:

Job No.: 7795  
Lender:

Instrument No.:  
Surety Amount:

Prepared by: CLG  
Developer: Prime Group

\$192,788

**Engineer's Opinion of Construction Cost**

**Portofino Landings - Site Plan Revision**

Fort Pierce, Florida

Original Cost Estimate

DESCRIPTION	COST QUANTITY CODE	UNITS	ORIGINAL UNIT PRICE	Work Completed-to-Date		Work Remaining	
				TOTAL	QUANTITY UNITS	TOTAL	QUANTITY UNIT PRICE
<b>I. Pavement &amp; Grading</b>							
<b>General</b>							
Mobilization		1	LS	\$7,500.00			\$7,500.00
Testing		1	LS	\$2,500.00			\$2,500.00
Survey		1	LS	\$2,300.00			\$2,300.00
Silt Fence		1,250	LF	\$1.10			\$1,375.00
NPDES Monitoring		1	LS	\$1,000.00			\$1,000.00
				<b>Subtotal</b>			<b>\$14,675.00</b>
<b>Tract A</b>							
<b>Demolition</b>							
Saw Cut ex. Asphalt		1,065	LF	\$1.50			\$1,597.50
Demo Ex. Asphalt Section		1,123	SY	\$1.90			\$2,133.70
Demo Ex. Type "D" Curb		99	LF	\$1.50			\$148.50
<b>Proposed Pavement</b>							
Type "D" Curb		532	LF	\$14.50			\$7,714.00
8" Stabilized Subgrade		1,921	SY	\$4.00			\$7,684.00
6" Compacted Limerock Base		1,835	SY	\$11.50			\$21,102.50
1 1/4" Type S-I ACSC Asphalt (1st Lift)		1,835	SY	\$6.50			\$11,927.50
3/4" Type S-III ACSC Asphalt (2nd Lift)		11,386	SY	\$3.90			\$44,405.40
5' Sidewalk (Thickened Edge)		9,638	SF	\$3.10			\$29,877.80
5' Sidewalk (4" Thick)		336	SF	\$3.10			\$1,041.60
Striping (6" White)		3,724	LF	\$0.80			\$2,979.20
Striping (HC Spaces)		15	EA	\$150.00			\$2,250.00
				<b>Tract A Subtotal</b>			<b>\$132,861.70</b>
<b>Tract B</b>							
<b>Demolition</b>							
Saw Cut ex. Asphalt		110	LF	\$1.50			\$165.00
Demo Ex. Asphalt Section		110	SY	\$1.90			\$209.00
<b>Proposed Pavement</b>							
8" Stabilized Subgrade		44	SY	\$4.00			\$176.00
6" Compacted Limerock Base		37	SY	\$11.50			\$425.50
1 1/4" Type S-I ACSC Asphalt (1st Lift)		37	SY	\$6.50			\$240.50
3/4" Type S-III ACSC Asphalt (2nd Lift)		37	SY	\$3.90			\$144.30
5' Sidewalk (Thickened Edge)		385	SF	\$3.10			\$1,193.50
				<b>Tract B Subtotal</b>			<b>\$2,553.80</b>
<b>SUBTOTAL</b>							<b>\$150,090.50</b>

**CAULFIELD & WHEELER, INC.**

7900 Glades Road, Boca Raton, Florida 33434 • (561) 392-1991 • FAX (561) 750-1452

Land Development Permit No. Control No.: 7795 Instrument No.: \$192,788 Prepared by: CLG Developer: Prime Group

**Portofino Landings - Site Plan Revision**

Original Cost Estimate		Work Completed-to-Date			Work Remaining						
DESCRIPTION	COST CODE	QUANTITY	UNITS	UNIT PRICE	TOTAL	QUANTITY	UNITS	TOTAL	QUANTITY	CURRENT UNIT PRICE	COST
<b>III. Water &amp; Sewer Utilities</b>											
<b>Tract A</b>											
<b>Water Utilities</b>											
2" Water Service w/RPZ (New)		12	EA	\$550.00	\$6,600.00				12	\$550.00	\$6,600.00
2" Water Service w/RPZ (Existing relocate)		46	EA	\$250.00	\$11,500.00				46	\$250.00	\$11,500.00
4" Fire Line Relocate		5	EA	\$800.00	\$4,000.00				5	\$800.00	\$4,000.00
<b>Sewer Utilities</b>											
6" Sanitary Sewer Lateral Relocate		8	EA	\$250.00	\$2,000.00				8	\$250.00	\$2,000.00
					<b>Tract A Subtotal</b>			<b>\$24,100.00</b>			<b>\$24,100.00</b>
<b>SUBTOTAL</b>								<b>\$24,100.00</b>			<b>\$24,100.00</b>

**CAULFIELD & WHEELER, INC.**

7900 Glades Road, Boca Raton, Florida 33434 \* (561) 392-1991 \* FAX (561) 750-1452

Prepared by: CLG  
Developer: Prime Group

Instrument No.:  
Surety Amount: \$192,788

Job No.: 7795  
Lender:

Land Development Permit No.  
Control No.:

**Portofino Landings - Site Plan Revision**

Fort Pierce, Florida

Original Cost Estimate

DESCRIPTION	Work Completed-to-Date		Work Remaining	
	TOTAL	TOTAL	CURRENT	COST
<b>SUMMARY</b>				
I. Pavement & Grading	\$150,090.50			\$150,090.50
II. Drainage				
III. Water & Sewer Utilities	\$24,100.00			\$24,100.00
IV. Sewer				
IV. Reclaimed Water				
V. Permitting				
Development Permit	\$200.00			
Plan Review Fee @ 05%	\$870.95			
<b>TOTAL</b>	<b>\$175,261.45</b>			<b>\$175,261.45</b>

Christopher L. Goetzfried, P.E.  
Florida P.E. No. 98153  
Date: 4/26/2017

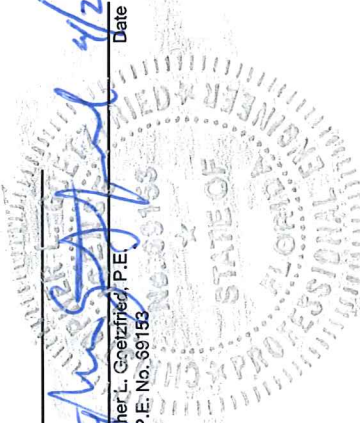



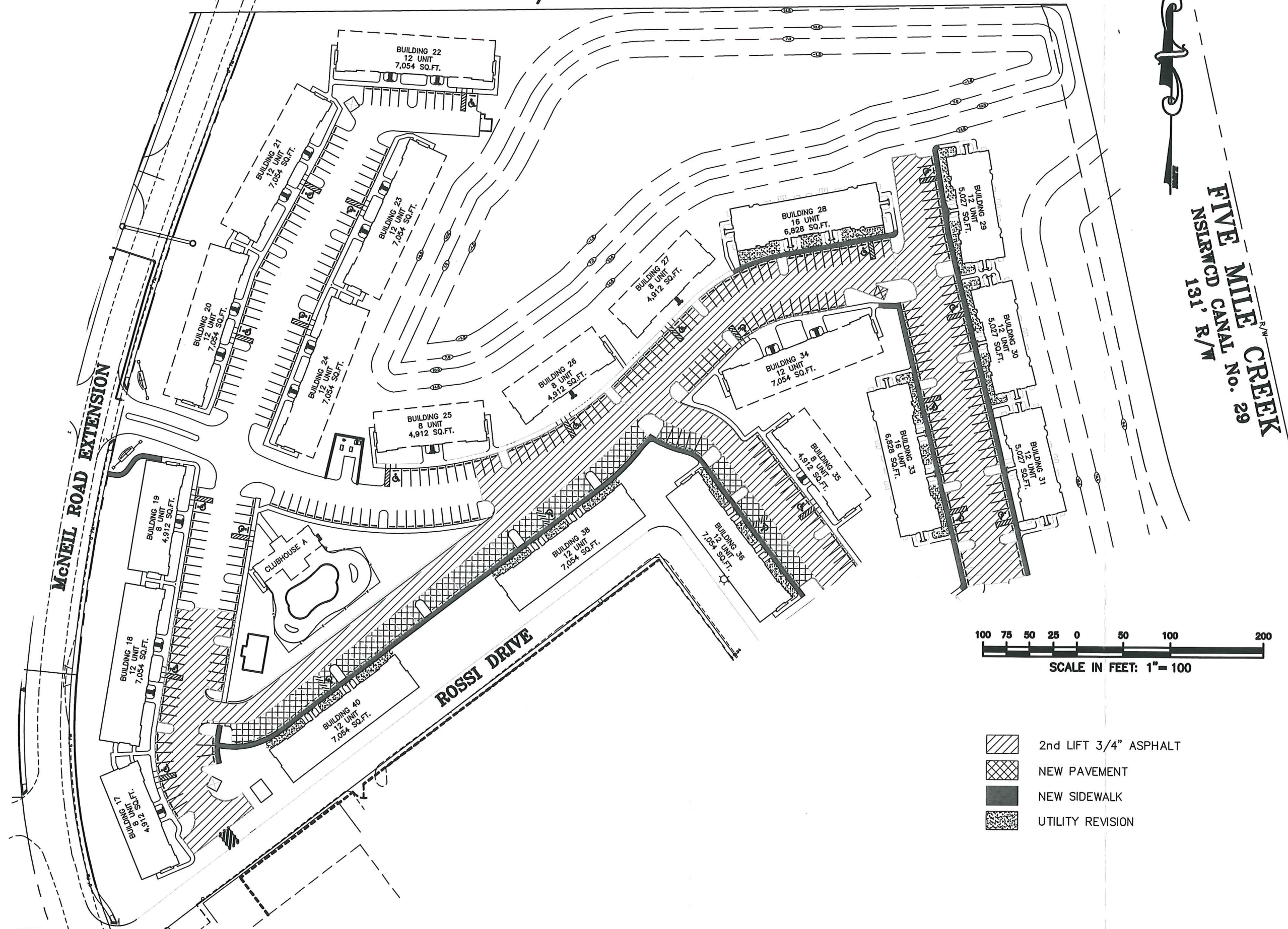

NSLRWCD CANAL No. 37  
81' R/W

NORTH SECTION LINE 19

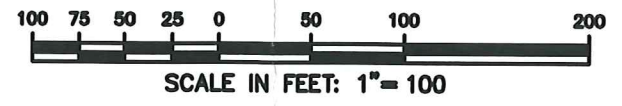

FIVE MILE CREEK  
NSLRWCD CANAL No. 29  
131' R/W



-  2nd LIFT 3/4" ASPHALT
-  NEW PAVEMENT
-  NEW SIDEWALK
-  UTILITY REVISION

DATE	4/19/2017
DRAWN BY	CLG
F.B./ PG.	00000
SCALE	00000
JOB NO.	7795

REVISIONS	DATE	BY

FILE NAME 00000

CAULFIELD & WHEELER, INC.  
CIVIL ENGINEERING - LAND SURVEYING  
7900 GLADES ROAD - SUITE 100  
BOCA RATON, FLORIDA 33434  
PHONE (561)-392-1991 / FAX (561)-750-1452



**PORTOFINO LANDINGS**  
IMPROVEMENTS EXHIBIT  
FORT PIERCE, FLORIDA

**Project:** PORTOFINO LANDINGS FINAL PLAT

**Subject:** Review Comments

**To:** Venis Gilmore

**From:** Rod Reed, County Surveyor  
PW-Engineering Division

**Date:** April 20, 2017

I have no comments



**Rod Reed, County Surveyor**  
St. Lucie County, Fl.  
2300 Virginia Avenue  
Ft. Pierce, Fl. 34982-5652  
[www.stlucieco.org](http://www.stlucieco.org)  
Ph. (772) 462-1721  
E-mail [reedr@stlucieco.org](mailto:reedr@stlucieco.org)



TECHNICAL REVIEW COMMITTEE (TRC) COMMENTS FORM

**FROM :** Paul Thomas, CBO, CFM, Interim Building Official

**RE :** Final Plat – Portofino Landings

**DATE :** 4.19.17

No Comment.

PT/km

