

Michelle Franklin, CFA -- Saint Lucie County Property Appraiser -- All rights reserved.

Property Identification

Site Address: N 2nd ST
 Sec/Town/Range: 03/35S/40E
 Map ID: 24/03S
 Zoning: C6

Parcel ID: 2403-801-0006-000-4
 Account #: 16201
 Use Type: 1200
 Jurisdiction: Fort Pierce

Ownership

Tyler J Horvath
 Trevor G Horvath
 Taryn M Horvath
 2301 River Hammock LN
 Fort Pierce, FL 34981-4934

Legal Description

INDIAN RIVER MEMORIAL PARK ALL OF TRACTS D, E, F, G, H AND ASSESSOR'S MAP OF NORTH PART OF FORT PIERCE THAT PART OF LOT 1 AND LOT 4 LYING E OF SECOND STREET, AND 3 35 40 FROM PROJECTED INT OF E R/W OF N 2 ST WITH S R/W OF FISHERMAN'S WHARF RUN SLY ALG N 2 ST R/W 303.20 FT TO POB, TH CONT SLY ON R/W 143.43 FT TO N LI AV G, TH E ALG SD N LI 202 FT M/L TO W LI IND RIVER DR, TH NWLY ALG SD R/W 200 FT M/L, TH S 88 DEG 14.5 MIN W 190.57 FT TO POB - LESS ROAD R/WS (1.52 AC - 66,244 SF) (MAP 24/03S) (OR 546-2504 : 556-2611 : 744-1800 : 749-38 : 1358-1490 THRU 1494: 1363-2552 THRU 2556 : 3329-865 : 3406-390: 3422-1751: 3478-836: 3697-2628: 3918-903)



Current Values

Just/Market Value: \$1,139,400
 Assessed Value: \$1,139,400
 Exemptions: \$0
 Taxable Value: \$1,139,400
 Taxes for this parcel: SLC Tax Collector's Office
 Download TRIM for this parcel: Download PDF

Total Areas

Finished/Under Air (SF): 4,575
 Gross Area (SF): 8,075
 Land Size (acres): 1.52
 Land Size (SF): 66,244

Sale History

Date	Book/Page	Sale Code	Deed	Grantor	Price
Sep 30, 2016	3918 / 0903	0111	PR	Horvath (EST) Dennis J	\$100
Nov 21, 2014	3697 / 2628	0111	QC	Horvath (EST) Dennis J	\$100
Jan 25, 2013	3478 / 0836	0111	MS	Horvath, Dennis J	\$0
Aug 17, 2012	3422 / 1751	0111	MS	Horvath, Dennis J	\$0
Jun 19, 2012	3406 / 0390	0311	QC	Horvath, Dennis J	\$300,000
Oct 3, 2011	3329 / 0865	0111	CT	Smyth, Harold H	\$230,000
Jan 22, 2001	1358 / 1494	XX04	QC	Wade, Deena Ree H	\$100
Jan 22, 2001	1358 / 1492	XX01	DE	Wade, Deena Ree H	\$100
Jan 22, 2001	1358 / 1490	XX01	PR	Rakowich (Est), Margaret A	\$100
Sep 1, 1987	0556 / 2611	XX01	CV		\$23,100
Sep 1, 1987	0556 / 2611	XX00	CV		\$23,100

Building Information (1 of 2)

Finished Area: 2,687 SF
 Gross Total Area: 3,921 SF

Exterior Data

View:	Roof Cover: Metal	Roof Structure: Hip
Building Type: REST	Year Built: 1988	Frame:
Grade: Y_B-	Effective Year: 1988	Primary Wall: CB Stucco
Story Height: 1 Story	No. Units: 1	Secondary Wall: Frm Stucco

Interior Data

Bedrooms: 0	Electric: MAXIMUM	Primary Int Wall:
-------------	-------------------	-------------------

Full Baths: 0
 Half Baths: 0
 A/C %: 100%

Heat Type: FrcdHotAir
 Heat Fuel: ELEC
 Heated %: 100%

Avg Hgt/Floor: 0
 Primary Floors: Carpet
 Sprinkled %: 0%

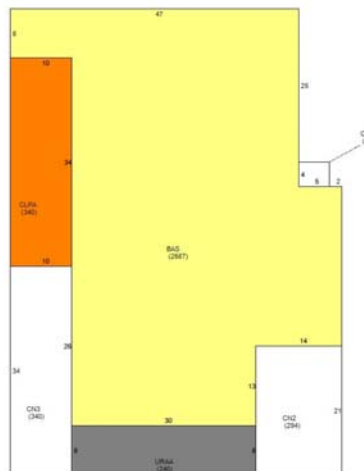

Sketch Area Legend

Sub Area	Description	Area	Fin. Area	Perimeter
BAS	BASE AREA	2687	2687	244
CLPA	Closed Porch Average	340	0	88
CN1	CANOPY	20	0	18
CN2	CANOPY	294	0	70
CN3	CANOPY	340	0	88
URAA	Utility Room Attached Average	240	0	76

Building Information (2 of 2)

Finished Area: 1,888 SF
 Gross Total Area: 4,154 SF

Exterior Data

View:
 Building Type: STRL
 Grade: Y_D
 Story Height: 2 Story

Roof Cover: Tar & Gravel
 Year Built: 1950
 Effective Year: 1980
 No. Units: 2

Roof Structure: Flat/Shed
 Frame:
 Primary Wall: Conc Block
 Secondary Wall: Abs Shingle

Interior Data

Bedrooms: 0
 Full Baths: 0
 Half Baths: 0
 A/C %: 100%

Electric: MAXIMUM
 Heat Type: FrcdHotAir
 Heat Fuel: ELEC
 Heated %: 100%

Primary Int Wall:
 Avg Hgt/Floor: 0
 Primary Floors: CONC GRD
 Sprinkled %: 0%



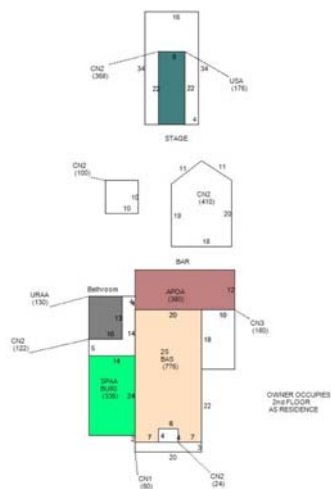

Sketch Area Legend

Sub Area	Description	Area	Fin. Area	Perimeter
2S	ONE FULL STORY OVER BASE (TOTAL 2 FLOORS)	776	776	128
APOA	Aluminium Porch (Open) Average	360	0	84
BAS	BASE AREA	776	776	128
BU80	UNFINISHED AREA ADJUST 20% FOR BUILDOUT	336	336	76
CN1	CANOPY	60	0	46
CN2	CANOPY	1024	0	347
CN3	CANOPY	180	0	56
SPAA	Screen Porch Attached Average	336	0	76
URAA	Utility Room Attached Average	130	0	46
USA	Utility Shed Average	176	0	60

Special Features and Yard Items

Type	Qty	Units	Year Blt
DOUBLE LIGHT	1	2	1988
CEMENT CURB	1	144	1988
CONCRETE LOW	1	10800	1988
WOOD FEN 3'	1	75	2004
WOOD FEN 6'	1	334	2012
CONCRETE LOW	1	1000	2013

Current Year Values

Current Values Breakdown		Current Year Exemption Value Breakdown				
		Tax Year	Grant Year	Code	Description	Amount
Building:	\$200,400					
Land:	\$939,000					
Just/Market:	\$1,139,400					
Ag Credit:	\$0					
Save Our Homes or 10% Cap:	\$0					
Assessed:	\$1,139,400					
Exemption(s):	\$0					
Taxable:	\$1,139,400					

Current Year Special Assessment Breakdown

Start Year	AssessCode	Units	Description	Amount
2013	0041	10	Fort Pierce Stormwater Charge	\$540.00

This does not necessarily represent the total Special Assessments that could be charged against this property. The total amount charged for special assessments is reflected on the most current tax statement and information is available with the SLC Tax Collector's Office .

Historical Values

Year	Just/Market	Assessed	Exemptions	Taxable
2017	\$1,139,400	\$1,139,400	\$0	\$1,139,400
2016	\$1,129,200	\$1,129,200	\$0	\$1,129,200
2015	\$1,091,900	\$1,091,900	\$0	\$1,091,900

Permits

Number	Issue Date	Description	Amount	Fee
F89000025E	Jan 1, 1989	Additions to existing construction	\$100	\$100
F94-001275	Oct 31, 1994	Enclosure	\$2,400	\$2,400
SH200432	Jun 23, 2004	Shed	\$500	\$75
FE200484	Jul 16, 2004	Wood Fence	\$1,000	\$75
SE200436	Sep 15, 2004	Enclosure	\$4,900	\$50
MC2005234	May 26, 2005	Alterations/Remodeling	\$6,000	\$135
CA20058	Sep 2, 2005	Additions to existing construction	\$4,500	\$101
DMC200656	Nov 1, 2006	Demolition	\$2,450	\$130
0800001603	Dec 5, 2008	Awning/Shutters	\$3,500	\$100
BP11-2982	Dec 16, 2011	Plumbing	\$6,000	\$154
BP12-1574	Sep 14, 2012	Wood Fence	\$1,200	\$80
BP12-1681	Oct 30, 2012	Commercial New Construction	\$1,500	\$100
BP12-1682	Oct 30, 2012	Commercial New Construction	\$2,000	\$100
BP12-1802	Oct 10, 2012	Electric	\$1,000	\$155
BP12-1739	Jan 28, 2013	Alterations/Remodeling	\$1,000	\$75
BP13-1269	Mar 26, 2013	Plumbing	\$200	\$155
BP13-1316	Mar 28, 2013	Electric	\$300	\$155
BP12-2358	Jun 4, 2013	Paving	\$115,000	\$1,194
BP13-1992	Jun 3, 2013	Roof	\$4,500	\$164
BP14-1034	May 1, 2014	Paving	\$1,560	\$90
BP15-2674	Oct 1, 2015	Air Conditioning Only	\$4,613	\$170
BP16-0766	Apr 6, 2016	Re Roof Permit	\$22,475	\$0
BP16-3310	Dec 27, 2016	Re Roof Permit	\$6,000	\$0

Notice: This does not necessarily represent all the permits for this property.

Click the following link to check for additional permit data in Fort Pierce

This information is believed to be correct at this time but it is subject to change and is not warranted.

© Copyright 2017 Saint Lucie County Property Appraiser. All rights reserved.