

**Property Identification**

Site Address: 2625 S US HWY 1      Parcel ID: 2422-602-0249-000-7      Account #: 30342      Sec/Town/Range: 22/35S/40E  
 Map ID: 24/22N      Zoning: C3      Use Type: 2100      Jurisdiction: Fort Pierce

**Ownership**

Fort Pierce LLC  
 7241 High Ridge RD  
 Boynton Beach, FL 33426

**Legal Description**

MARAVILLA GARDENS S/D UNIT 1 E 416 FT OF LOT 56 LESS W 90 FT AND E 7 FT FOR RD R/W (OR 3133-2600; 3142-478)

**Current Values**

Just/Market:      \$359,100      Assessed:      \$324,390  
 Exemptions:      \$0      Taxable:      \$324,390

**Historical Values 3-year**

Year	Just/Market	Assessed	Exemptions	Taxable
2016	\$359,100	\$324,390	\$0	\$324,390
2015	\$294,900	\$294,900	\$0	\$294,900
2014	\$269,300	\$269,300	\$0	\$269,300

**Sale History**

Date	Book/Page	Sale Code	Deed	Grantor	Price
10-01-2009	3142 / 0478	0111	WD	Fort Pierce LLC,	\$0
10-01-2009	3133 / 2600	0001	WD	Johnson,Bethany I-Lessor-	\$335,000
03-17-2009	3070 / 1135	0111	QC	Johnson,Bethany I-Lessor-	\$0

**Primary Building Information**

Finished Area of this building: 3,923 SF  
 Gross Area of this building: 3,923 SF

View:  
 Year Built: 1974  
 Primary Wall: CB Stucco

Roof Cover: Tar & Gravel  
 Frame:  
 Story Height: 1 Story

**Exterior Data**

Roof Structure: BarJst/Rigid  
 Grade: Y\_C  
 No. Units: 1

Building Type: REST  
 Effective Year: 1980  
 Secondary Wall:

Bedrooms: 0  
 Full Baths: 0  
 Half Baths: 0

A/C %: 100%  
 Heated %: 100%  
 Sprinkled %: 100%

**Interior Data**

Electric: MAXIMUM  
 Heat Type: FredHotAir  
 Heat Fuel: ELEC

Primary Int Wall:  
 Avg Hgt/Floor: 0  
 Primary Floors: Tile-Ceramic

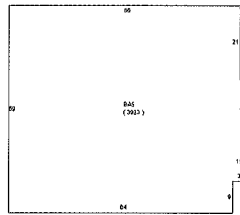
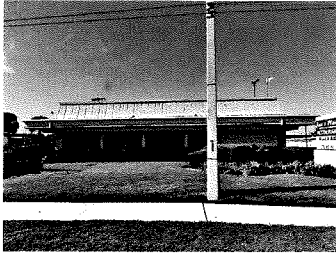

**Total Areas**

Finished/Under Air (SF):	3,923
Gross Area (SF):	3,923
Land Size (acres):	1.02
Land Size (SF):	44,606
Total Building Count:	1

**Special Features and Yard Items**

Type	Qty	Units	Year Blt
CONCRETE LOW	1	500	1950
CEMENT CURB	1	180	1950
ASP2 LOW	1	29400	1950
DOUBLE LIGHT	1	6	1974
SINGLE LIGHT	1	1	1974

This information is believed to be correct at this time but it is subject to change and is not warranted.  
 © Copyright 2017 Saint Lucie County Property Appraiser. All rights reserved.