



N. St. Lucie River W.M.D. Canal

S Jenkins Road

McNeil Road

Lake 1
(3.95 ac.)

Lake 2
(1.45 ac.)

Outdoor Storage,
Maintenance & Refuse
(2.93 ac.)

Edwards Road



N.T.S.



Key / Location:

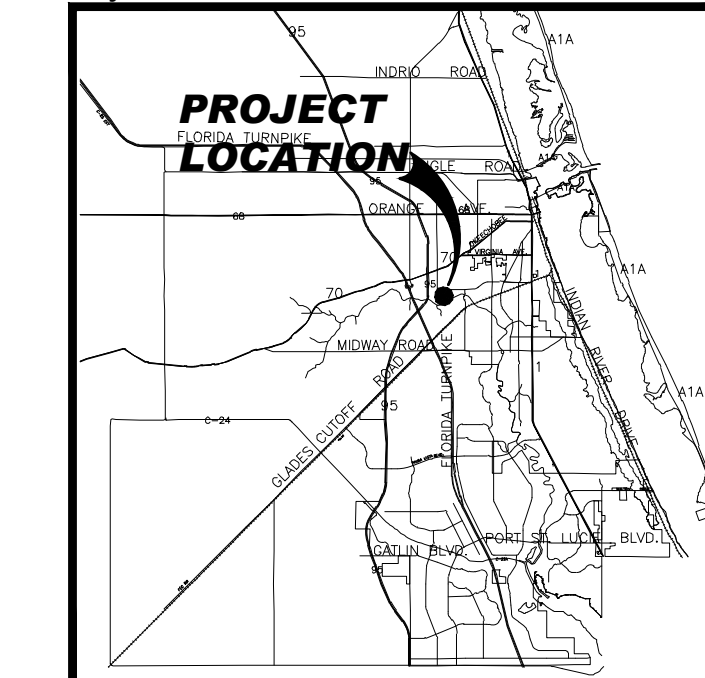

N.T.S.

Project Team:

Applicant: S.R. Enterprises, LLC
 1821 N. US1
 Fort Pierce, FL 34946

Land Planner / Landscape Architect: Lucido & Associates
 701 East Ocean Boulevard
 Stuart, Florida 34994

Legal Counsel: W. Lee Dobbing, Esq.
 Dean, Mead, Minton & Zimmer
 1903 S. 25th Street, Suite 200
 Fort Pierce, FL 34947



Jenkins Road KOA
 Fort Pierce, Florida
 Phase Plan

Date	By	Description
9.5.17	JJ	Initial Submittal
10.10.17	DC	Resubmittal

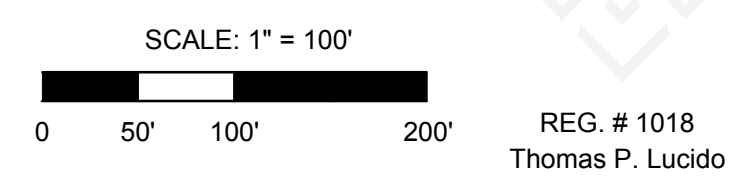
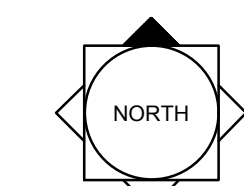

Designer	JJ	Sheet
Manager	BN	
Project Number	17-445	SP-2
Municipal Number	---	
Computer File	17-446 Jenkins Road KOA - Resubmittal.dwg	

© Copyright Lucido & Associates. These documents and their contents are the property of Lucido & Associates. Any reproductions, revisions, modifications or use of these documents without the express written consent of Lucido & Associates is prohibited by law.

- Phasing Data:**
- Phase 1 - Proposed construction Spring '18 to Spring '19.**
 - 92 Pull-Through Lots, 24 Back-In Lots
 - Water Main Loop
 - Sanitary Sewer
 - Lift Station
 - Project Entrances
 - Electric Services
 - Administration Building -- First Phase of 2-Phase construction
 - Pool, Pool Fence, Patio, Parking
 - Lake
 - Drainage Outfall
 - Storage Area
 - Landscape Buffers
 - Active Play Area
 - Phase 2 - Proposed construction Spring '19 to '21.**
 - 80 Back-In Lots
 - Water Main Loop
 - Sanitary Sewer
 - Electric Service
 - Lake
 - Landscape Buffers
 - Workshop/Restrooms
 - Horseshoe Pits, Pickleball Courts, Shuffleboard Courts
 - Phase 3 - Proposed construction Spring '21 to '23.**
 - 105 Pull-Through Lots, 22 Back-In Lots
 - Water Main Loop
 - Sanitary Sewer
 - Electric Service
 - Administration Building -- Second Phase of 2-Phase construction
 - Restrooms & Workshop
 - Multi-Purpose Field
 - Shuffleboard Courts

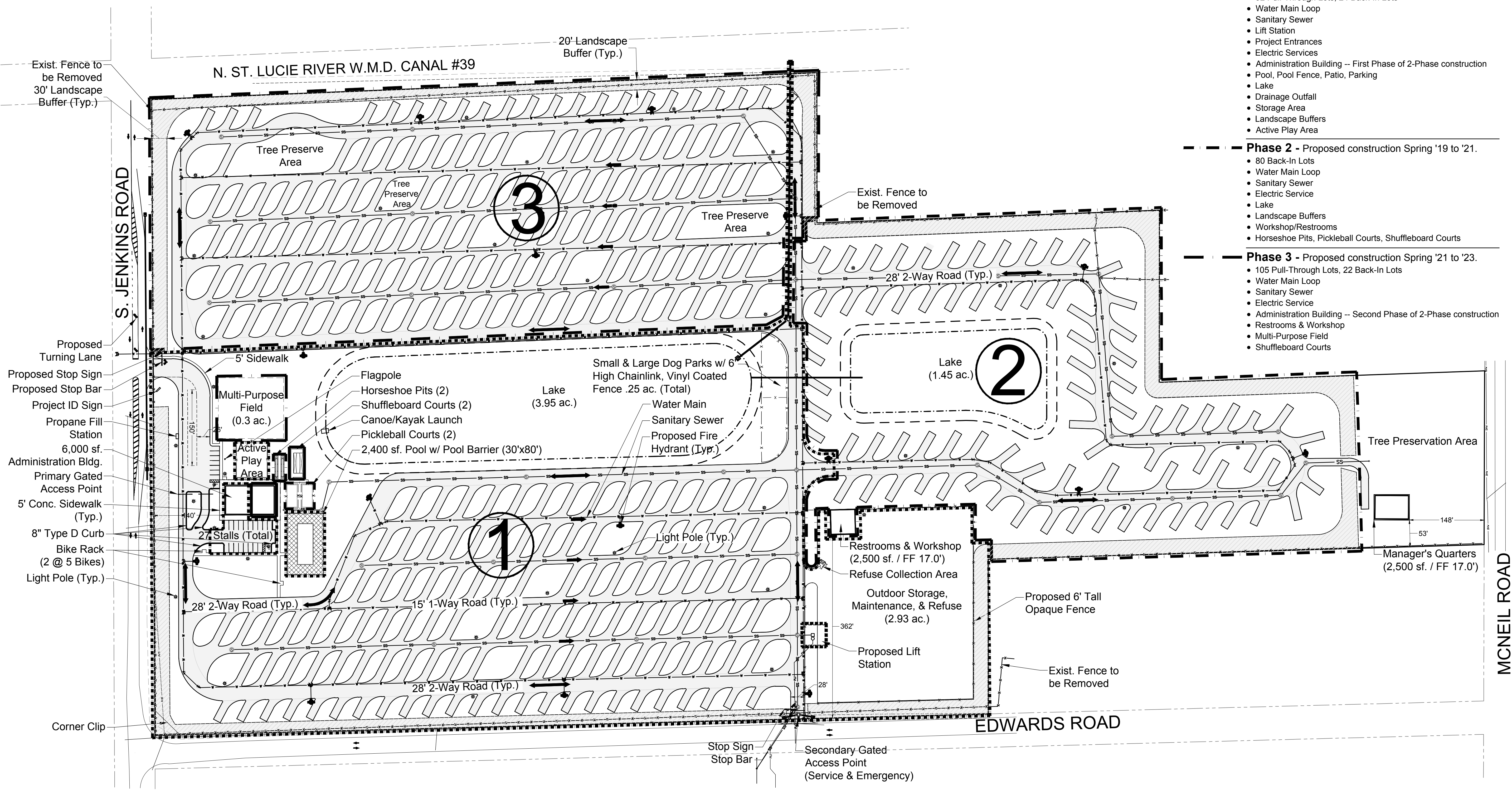

Exist. Fence to be Removed
 30' Landscape Buffer (Typ.)

S. JENKINS ROAD

Proposed Turning Lane

Proposed Stop Sign

Proposed Stop Bar

Project ID Sign

Propane Fill Station

6,000 sf. Administration Bldg.

Primary Gated Access Point

5' Conc. Sidewalk (Typ.)

8" Type D Curb

Bike Rack (2 @ 5 Bikes)

Light Pole (Typ.)

Corner Clip

Stop Sign
 Stop Bar

Secondary Gated Access Point (Service & Emergency)

MCNEIL ROAD

EDWARDS ROAD