

Administrative Certificates of Appropriateness

Attached are Certificates of Appropriateness issued administratively in December 2016.

- COA #16-73, 301 S 7th Street – Remove and replace the existing doors.
- COA #16-75, 801 Florida Avenue – Remove and replace 10 existing, aluminum frame windows. No change in openings.
- COA #16-78, 102 S 2nd Street – Install a new wall sign for “Brooklyn Sweets”.
- COA #16-79, 600 N 15th Street – Infill one door. Entrance had originally two doors.
- COA #16-80, 658 N 2nd Street - Remove tar and gravel from the flat roof and install modified bitumen.



CITY OF FORT PIERCE

PLANNING DEPARTMENT

COMPREHENSIVE PLANNING ◊ DEVELOPMENT REVIEW
HISTORIC PRESERVATION ◊ URBAN DESIGN ◊ URBAN FORESTRY ◊ ZONING

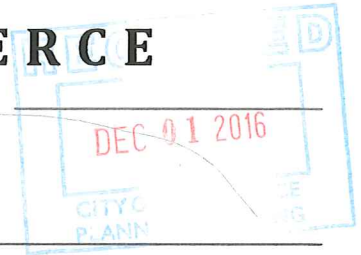

Certificate of Appropriateness Application

Building & Site Information

Address of the Site: 301 S. 7th street
Parcel ID #: 2410-705-0012-000/6
Type of Designation: Contributing Non-contributing Site within the _____ Historic District
 Individually Designated Site, City Commission Resolution No. _____

Property Owner / Applicant Information

Property Owner(s) Name(s): charles hayek
Mailing Address: 1111 fernandina street
Phone Number(s): 772-828-1080 Email: cchawk77@aol.com

Applicant Name(s): same as above
Mailing Address: _____
Phone Number(s): _____ Email: _____

Representative Name(s): same
Mailing Address: _____
Phone Number(s): _____ Email: _____

Property Owner(s) Acknowledgements:- This application will not be considered complete without the signature of all property owners of record, which shall serve as an acknowledgement of the submission of this application. The property owner's signature below shall also authorize the Applicant (if other than the property owner) and/or Representative to act in his/her behalf for the purposes of seeking approval for the application described herein. The undersigned consents to inspection and photographing of the subject property by the Historic Preservation staff for purposes of consideration of this Application and/or presentation to the Historic Preservation Board.

I / We, charles hayek as Owner(s) of the subject property, do hereby authorize the filing of this application on my/our behalf.

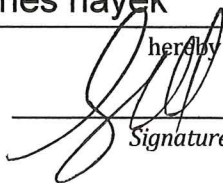

Signature of Owner

11-23-2016
Date

Description of Requested Work

Please indicate the type of work requested:

Fence

Shed

Door(s)

Roof

Window(s)

Signage

Shutter(s)

Porch

Rehabilitation

New Construction

Demolition

Relocation

Site Improvements (describe) install new roof and doors Door on 7th St to be 9 panel

Other (describe) of glass above 2 panel below - remaining doors are 6 panel doors

Please provide a detailed description of the proposed work to be performed: _____

install new roof, new doors, remodel interior

Have other alterations been made to the site within the last 12 months? No Yes, _____

Will the proposed work require a Zoning Variance? No Yes, Code Section(s): _____

Application Requirements

\$10.00 Application fee

Site Plan with dimensions.

Architectural Drawings:

- > Drawings should show all current and proposed floor plans and elevations, fences, walls, and any other landscape features.
- > Drawings should indicate materials to be used.

Photos - One (1) color photograph of the main façade of the site and photographs of any areas affected by the proposed project.

Material(s) specifications and/or sample(s)

Color samples.

Demolition - Plans for what will be taking the demolished structure's place should be submitted.



Google Earth

© 2016 Google
© 2016 Google



Google Earth

7th Street View





Google Earth

© 2016 Google
© 2016 Google
© 2016 INEGI
US Dept of State Geographer

feet 10
meters

5

Google Earth





BCIS Home | Log In | User Registration | Hot Topics | Submit Surcharge | Stats & Facts | Publications | FBC Staff | BCIS Site Map | Links | Search



Product Approval
USER: Public User

Product Approval Menu > Product or Application Search > Application List > Application Detail

OFFICE OF THE SECRETARY

FL #
Application Type
Code Version
Application Status

FL15225-R3
Revision
2014
Approved

FL 15225.3

*Approved by DBPR. Approvals by DBPR shall be reviewed and ratified by the POC and/or the Commission if necessary.

Comments
Archived

Product Manufacturer
Address/Phone/Email

Therma-Tru Corporation
118 Industrial Drive
Edgerton, OH 43517
(419) 298-1740
rickw@rwbldgconsultants.com

Authorized Signature

Vivian Wright
rickw@rwbldgconsultants.com

Technical Representative
Address/Phone/Email

Quality Assurance Representative
Address/Phone/Email

Category
Subcategory

Exterior Doors
Swinging Exterior Door Assemblies

Compliance Method

Certification Mark or Listing

Certification Agency
Validated By

National Accreditation & Management Institute
Ryan J. King, P.E.
 Validation Checklist - Hardcopy Received

Referenced Standard and Year (of Standard)

Standard	Year
101/I.S.2	1997
ASTM E1886	2002
ASTM E1996	2002
ASTM E330	2002
TAS 201, 202, 203	1994

Equivalence of Product Standards
Certified By

Product Approval Method

Method 1 Option A

Date Submitted
Date Validated

06/13/2015
06/28/2015

Date Pending FBC Approval

Date Approved

07/05/2015

Summary of Products

FL #	Model, Number or Name	Description
15225.1	a. "Classic-Craft" and "Benchmark by Therma-Tru"	6/8 and 8/0 Opaque and Glazed Fiberglass Door with and without Sidelites. Inswing and Outswing
Limits of Use Approved for use in HVHZ: No Approved for use outside HVHZ: Yes Impact Resistant: No Design Pressure: N/A Other: See INST 15225.1-68 (6'8 Door Products), INST 15225.1-80 (8'0 Door Products) and INST 15225-68M (6'8 Door Products Direct to Masonry) for installation instructions. (Note - Glazing Shall comply with ASTM E1300-04)		Certification Agency Certificate FL15225_R3_C_CAC_15225.1_NAMI_certs.pdf Quality Assurance Contract Expiration Date 12/31/2021 Installation Instructions FL15225_R3_II_INST_15225.1-68.pdf FL15225_R3_II_INST_15225.1-80.pdf FL15225_R3_II_INST_15225-68M.pdf Verified By: Lyndon F. Schmidt, P.E. 43409 Created by Independent Third Party: Yes Evaluation Reports FL15225_R3_AE_Eval_15225.1-68.pdf FL15225_R3_AE_EVAL_15225.1-80.pdf FL15225_R3_AE_EVAL_15225-68M.pdf Created by Independent Third Party: Yes
15225.2	b. "Construction Series" and "Benchmark by Therma-Tru"	6/8 Opaque Steel Door with and without Sidelites. Inswing and Outswing
Limits of Use Approved for use in HVHZ: No Approved for use outside HVHZ: Yes Impact Resistant: Yes Design Pressure: N/A Other: See INST 15225.2-68 (6'8 Door Products) and INST 15225-68M (6'8 Door Products Direct to Masonry) for installation instructions. (Note - Glazing Shall comply with ASTM E1300-04)		Certification Agency Certificate FL15225_R3_C_CAC_15225.2_NAMI_certs.pdf Quality Assurance Contract Expiration Date 12/31/2021 Installation Instructions FL15225_R3_II_INST_15225.2-68.pdf FL15225_R3_II_INST_15225-68M.pdf Verified By: Lyndon F. Schmidt, P.E. 43409 Created by Independent Third Party: Yes Evaluation Reports FL15225_R3_AE_EVAL_15225.2-68.pdf FL15225_R3_AE_EVAL_15225-68M.pdf Created by Independent Third Party: Yes
15225.3	c. "Fiber-Classic" and "Benchmark by Therma-Tru"	6/8 and 8/0 Opaque and Glazed Fiberglass Door with and without Sidelites. Inswing and Outswing
Limits of Use Approved for use in HVHZ: No Approved for use outside HVHZ: Yes Impact Resistant: No Design Pressure: N/A Other: See INST 15225.3-68 (6'8 Door Products), INST 15225.3-80 (8'0 Door Products) and INST 15225-68M (6'8 Door Products Direct to Masonry) for installation instructions. Note - Glazing Shall comply with ASTM E1300-04. (This product approval requires the use of "J" part number doors and sidelites, which have been stained or painted within 6 months of installation - Excludes Opaque Benchmark Door Panels.)		Certification Agency Certificate FL15225_R3_C_CAC_15225.3_NAMI_certs.pdf Quality Assurance Contract Expiration Date 12/31/2021 Installation Instructions FL15225_R3_II_INST_15225.3-68.pdf FL15225_R3_II_INST_15225.3-80.pdf FL15225_R3_II_INST_15225-68M.pdf Verified By: Lyndon F. Schmidt, P.E. 43409 Created by Independent Third Party: Yes Evaluation Reports FL15225_R3_AE_EVAL_15225.3-68.pdf FL15225_R3_AE_EVAL_15225.3-80.pdf FL15225_R3_AE_EVAL_15225-68M.pdf Created by Independent Third Party: Yes
15225.4	d. "Premium Series" and "Benchmark by Therma-Tru"	6/8 and 8/0 Opaque and Glazed Steel Door with and without Sidelites. Inswing and Outswing
Limits of Use Approved for use in HVHZ: No Approved for use outside HVHZ: Yes Impact Resistant: Yes Design Pressure: N/A Other: See INST 15225.4-68 (6'8 Door Products), INST 15225.4-80 (8'0 Door Products) and INST 15225-68M (6'8 Door Products Direct to Masonry) for installation instructions. (Note - Glazing Shall comply with ASTM E1300-04)		Certification Agency Certificate FL15225_R3_C_CAC_15225.4_NAMI_certs.pdf Quality Assurance Contract Expiration Date 12/31/2021 Installation Instructions FL15225_R3_II_INST_15225.4-68.pdf FL15225_R3_II_INST_15225.4-80.pdf FL15225_R3_II_INST_15225-68M.pdf Verified By: Lyndon F. Schmidt, P.E. 43409 Created by Independent Third Party: Yes Evaluation Reports FL15225_R3_AE_EVAL_15225.4-68.pdf FL15225_R3_AE_EVAL_15225.4-80.pdf FL15225_R3_AE_EVAL_15225-68M.pdf Created by Independent Third Party: Yes
15225.5	e. "Smooth-Star" and "Benchmark by Therma-Tru"	6/8 and 8/0 Opaque and Glazed Fiberglass Door with and without Sidelites. Inswing and Outswing

THERMA TRU®

THERMA TRU DOORS
118 INDUSTRIAL DR., EDGEMONT, OH 43517

"Fiber-Classic" and "Benchmark by Therma-Tru"

6"8" SINGLE AND DOUBLE OPAQUE OR GLAZED PANELS
W/ & W/OUT SIDELITES
INSWING / OUTSWING
INSULATED FIBERGLASS DOOR WITH WOOD FRAMES

General Notes

- This product anchoring drawing has been developed in compliance with the 5th Edition (2014) Florida Building Code (FBC) excluding the "High Velocity Hurricane Zone". See the Certification Agency Certificate for sizes, specifications and ratings.
- Product anchors shall be as listed and spaced as shown on details. Anchor embedment to base material shall be beyond wall dressing, stucco, foam, brick and other wall coverings.
- Wood screws shall be installed following installation instructions of ANSI/APA NDS 2012. All other fastener types to be installed following fastener manufacturer's installation instructions.
- Fastener embedment depths, edge distances and center-center distances shall be as specified by the fastener manufacturer but in no instance shall they be less than shown in this drawing.
- Where shims are used, they must be a "rigid / stiff" material that complies with the requirements of the FBC.
- Positive and negative design pressure requirements for use with this drawing shall be determined by others for specific jobs in accordance with the governing code.
- Site conditions not covered by this drawing are subject to further engineering analysis.

TABLE OF CONTENTS	
SHEET #	DESCRIPTION
1	Typical elevations, design pressures & general notes
2	Buck anchoring
3	Frame anchoring
4	Frame anchoring & bill of materials
5	Horizontal & vertical cross sections
6	Vertical cross sections

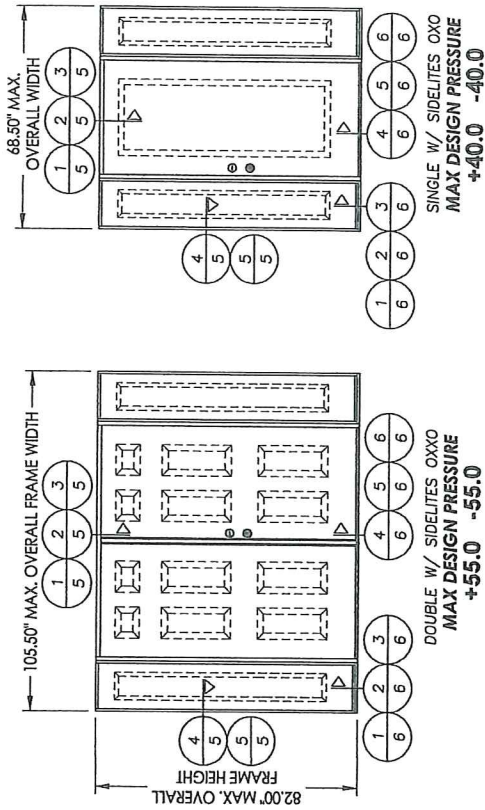

DOUBLE W/ SIDELITES OXO
MAX DESIGN PRESSURE
+55.0 -55.0

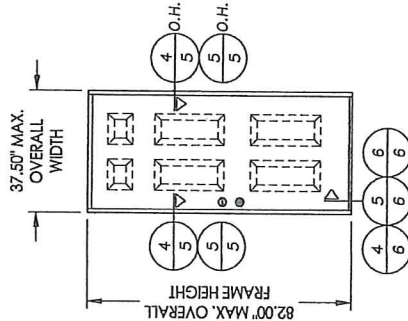

SINGLE X
MAX DESIGN PRESSURE
+67.0 -67.0

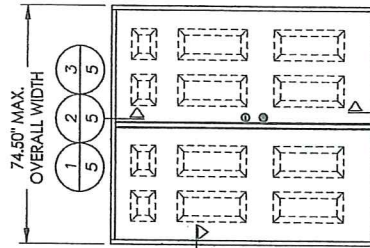

DOUBLE XX
MAX DESIGN PRESSURE
+55.0 -55.0

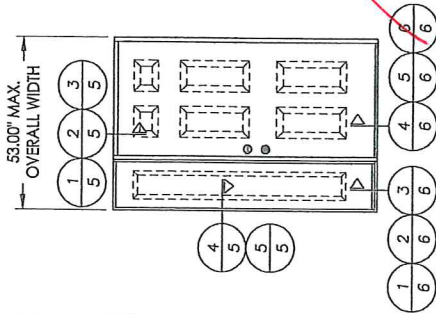

SINGLE W/ SIDELITE OX
MAX DESIGN PRESSURE
+40.0 -40.0

L.F. SCHMIDT
 STATE OF FLORIDA
 LICENSE NO. 43409

Documents Prepared By: Lyndon F. Schmidt
 P.E. No. 43409

BUILDING CONSULTANTS, INC.
 P.O. Box 230, Vero Beach, FL 33595
 Phone No.: 813.659.9197
 FBPE C.A. No. 9813

PRODUCT:	THERMA-TRU FIBERGLASS DOOR
PART OR ASSEMBLY:	TYPICAL ELEVATION, DESIGN PRESSURES & GENERAL NOTES
LFS	BY
FBC	UPDATE TO 5TH ED. (2014)
DATE	2/05/15
NO	1
DATE	2/21/12
SCALE:	N.T.S.
DWG. BY:	JK
CHK. BY:	LFS
DRAWING NO.:	FL-15225.3-68
SHEET	1 OF 6

LOCK HARDWARE MFG & SERIES
KWIKSET SIGNATURE SERIES LATCH
KWIKSET SIGNATURE SERIES 760 DEADBOLT

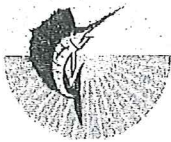

THE SUNRISE CITY
FORT PIERCE
 PLANNING DEPARTMENT
Florida



Bldg. Permit # _____

COA# 16-75

Certificate of Appropriateness Application

Building & Site Information

Address of the Site: 801 Florida Ave. Fort Pierce, FL 34950

Parcel ID #: 2410-709-0121-000-5

Type of Designation: Contributing Non-contributing Site within the _____ Historic District

Individually Designated Site, City Commission Resolution No. _____

Property Owner / Applicant Information

Property Owner(s)

Name(s): Kristen Cheyne

Mailing Address: 801 Florida Ave. Fort Pierce, FL 34950

Phone Number(s): (772) 519 - 6538 Email: _____

Applicant

Name(s): The Home Depot At Home Services

Mailing Address: 674 S Military Trail Deerfield Beach, FL 33442

Phone Number(s): (407) 469 - 5599 Ext 357 Email: amber.flenker@expeditepermit.com

Representative

Name(s): _____

Mailing Address: _____

Phone Number(s): _____ Email: _____

Property Owner(s) Acknowledgements:- This application will not be considered complete without the signature of all property owners of record, which shall serve as an acknowledgement of the submission of this application. The property owner's signature below shall also authorize the Applicant (if other than the property owner) and/or Representative to act in his/her behalf for the purposes of seeking approval for the application described herein. The undersigned consents to inspection and photographing of the subject property by the Historic Preservation staff for purposes of consideration of this Application and/or presentation to the Historic Preservation Board.

→ I / We, KRISTEN CHEYNE as Owner(s) of the subject property do hereby authorize the filing of this application on my/our behalf.

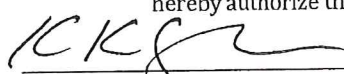
 11.18.16
 Signature of Owner Date



Description of Requested Work

Please indicate the type of work requested:

- Fence
- Shed
- Door(s)
- Roof
- Window(s)
- Signage
- Shutter(s)
- Porch
- Rehabilitation
- New Construction
- Demolition
- Relocation

Site Improvements (describe) _____

Other (describe) _____

Please provide a detailed description of the proposed work to be performed: Replacing 10 windows size for size, clear glass, white frame, no grids - match existing. Homeowner has existing permanent mounted Bahama shutters permit # 15-1712.

Have other alterations been made to the site within the last 12 months? No Yes, Re-roof Permit 15-3536

Will the proposed work require a Zoning Variance? No Yes, Code Section(s): _____

Application Requirements

- \$10.00 Application fee
- Site Plan with dimensions.
- Architectural Drawings:
 - Drawings should show all current and proposed floor plans and elevations, fences, walls, and any other landscape features.
 - Drawings should indicate materials to be used.
- Photos - One (1) color photograph of the main façade of the site and photographs of any areas affected by the proposed project.
- Material(s) specifications and/or sample(s)
- Color samples.
- Demolition - Plans for what will be taking the demolished structure's place should be submitted.



Re: Permit 2016-2909 Certificate of Appropriateness

Amber Flenker

to:

Maria Lewicka

12/01/2016 11:38 AM

Hide Details

From: Amber Flenker <amber.flenker@expeditepermit.com>

To: Maria Lewicka <MLewicka@city-ftpirce.com>

Please see the photos below:



Thank You
Amber

On Thu, Dec 1, 2016 at 11:23 AM, Maria Lewicka <MLewicka@city-ftpirce.com> wrote:
Hi Amber,

I attached two photos of the building elevations as example.
I need you to mark/show all windows you will be replacing on the elevations photos.
Thank you,
Maria

16-2909

MEASURE DIAGRAM SHEET

Customer: Charlene Koblegard

Job #: 9625855

Estimate: Stacy DeAngelis 10/12/16

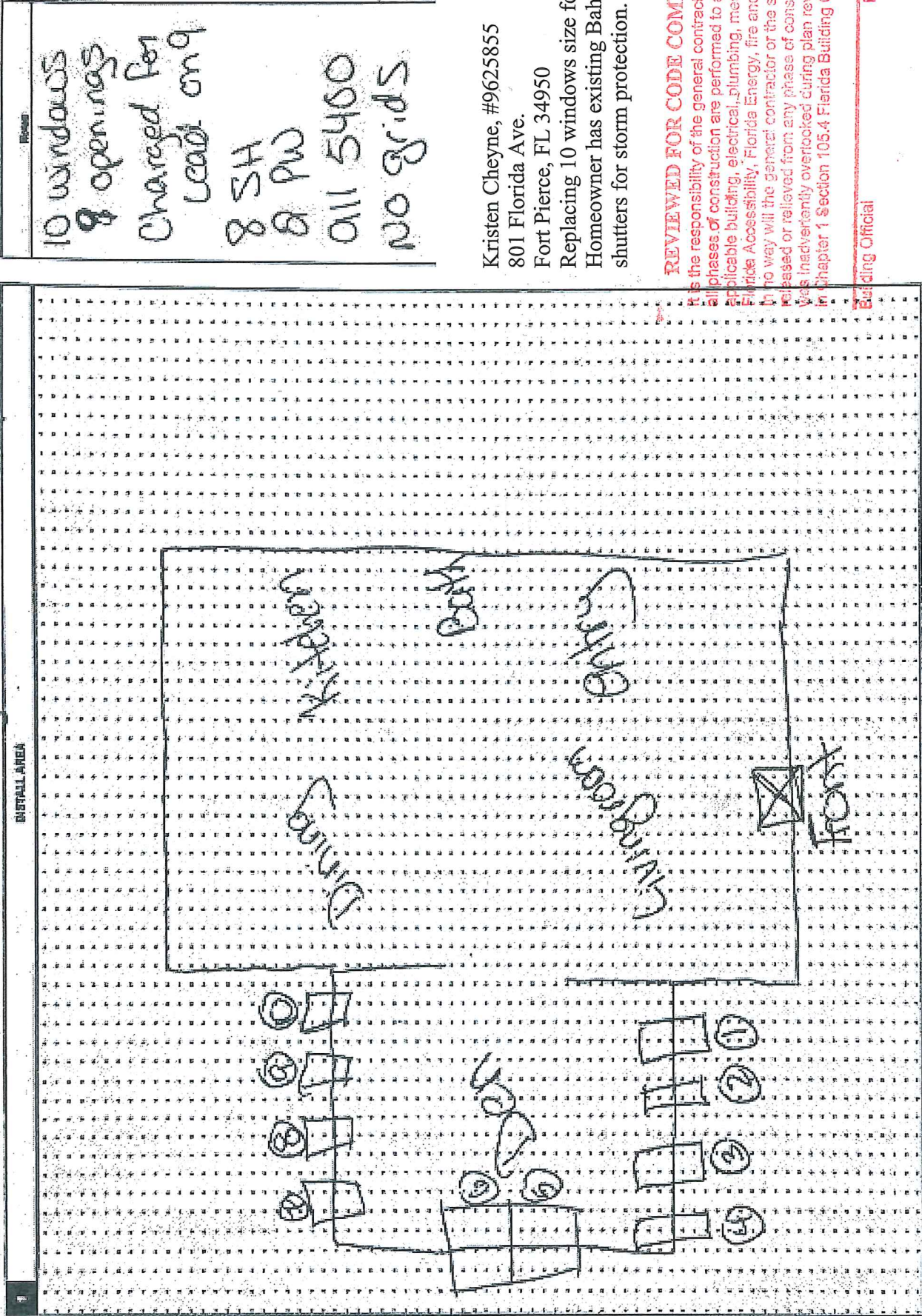

10 windows
 8 openings
 Charged for
 Lead on 9
 8 SH
 8 PW
 All 5400
 NO Grids

Kristen Cheyne, #9625855
 801 Florida Ave.
 Fort Pierce, FL 34950
 Replacing 10 windows size for size.
 Homeowner has existing Bahama
 shutters for storm protection.

REVIEWED FOR CODE COMPLIANCE

It is the responsibility of the general contractor to insure that all phases of construction are performed to and meet all applicable building, electrical, plumbing, mechanical, gas, Florida Accessibility, Florida Energy, fire and safety codes. In no way will the general contractor or the subcontractor be released or relieved from any phase of construction that was inadvertently overlooked during plan review as outlined in Chapter 1 Section 105.4 Florida Building Code (FBC)

Building Official _____ Date _____

These plans and all proposed work are subject to any corrections required by field inspectors that may be necessary in order to comply with all applicable codes

CITY OF FORT PIERCE REVIEWED BY

DATE

REMOVED 11/10/2016
 removed 11/14/2016 - App loc 845m in box App

Sales Order Acknowledgement

PO#: 9625855

Job Name: CHAYNE

Job Address:

SO#: 228616

Ship Date: 11/21/2016

Ordered By:

Tape#: 1028 MH EM

Florida Customer Contact:
877-342-1183
Fax 800-477-3655
Outside of Florida Customer Contact:
866-748-6444
Fax 866-748-6411
International Customer Contact:
866-748-6444
Fax 941-480-2754

www.pgtindustries.com

Bill To

16-2909

Ship To

012228
T H D AT-HOME SERVICES INC
2455 PACES FERRY RD SE C-1
ATLANTA, GA 30339-1834
Phone# Fax#

A07359 T H D AT-HOME SERVICES INC
3620 S FEDERAL HIGHWAY
FORT PIERCE, FL 34982-6618
Ship Via: PGT MON WED TRUCK
Phone# Fax# (772) 468-5959

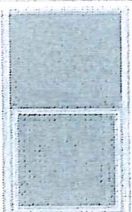
Line #	Item Description	Quantity	Line Pricing
0001 (1.00)	SH5400 VINYL SINGLE HUNG 5400 32.5X72.625X.,STD,5/8" FL,W,EQUAL,TIG,CL,ARG,SB 70XL,NO GRID,AUTO,2020BVK,DURASEAL,CMFRT LFT HNDL,,,.x.	Ordered: 1.00	
	 <p>Certification Type: MIAMI Package Selection: NONE Vent Configuration: EQUAL Size Selection: CUSTOM Width: 32 1/2 Actual Size: 32 1/2 X 72 5/8 Wood Frame: 32 3/4 X 72 7/8 Frame Color: White Glass Family: Insulating Tempered Location: UNIT Glass Color: CLEAR Privacy Glass: NONE Grid Type: NO Grid Screen Frame Type: EXTRUDED Boxing Options: None Comfort Lift: Y Top Sash Comfort Lift: NONE Lock Type: Snap Lock Vent Ht: 35.9550 PositiveDesignPressure: 65.0000 PANumber: FL-239 CondensationResistance: 60.0000 SolarHeatGainCoeff: 0.2100 VTCOG: 0.6400</p>		<p>NOA Selection: 16-0714.04 Frame Type: .625FLANGE Window Style: STD Size Ref: ACTUAL Height: 72 5/8 Rough Masonry: 34 1/4 X 73 5/8 Egress: 28 1/4 X 28 1/8 (5.524 SQFT) Does unit need to meet Turtle Code: NO Glass: 3/4" IG (1/8 TMP - 1/2 ARG - 1/8 TMP) Argon Gas: ARGON Low E: ENERGY SHIELD MAX Glass Spacer Type: DS Screen Type: BetterVue Charcoal Anchor Group: D.SH5400 Vent Latch: N Lift Rail: N WOCD: N Decralite: N CAR#: 16-0714.04 NegativeDesignPressure: 109.9000 EnergyStar: 123.0000 UF: 0.2900 VT: 0.4900</p>
Ship Via: PGT: MONWED TRUCK		Location:	DEN
Notes:			
0002 (2.00)	SH5400 VINYL SINGLE HUNG 5400 32.5X72.625X.,STD,5/8" FL,W,EQUAL,TIG,CL,ARG,SB 70XL,NO GRID,AUTO,2020BVK,DURASEAL,CMFRT LFT HNDL,,,.x.	Ordered: 1.00	

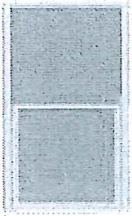

Certification Type: MIAMI
 Package Selection: NONE
 Vent Configuration: EQUAL
 Size Selection: CUSTOM
 Width: 32 1/2
 Actual Size: 32 1/2 X 72 5/8
 Wood Frame: 32 3/4 X 72 7/8
 Frame Color: White
 Glass Family: Insulating
 Tempered Location: UNIT
 Glass Color: CLEAR
 Privacy Glass: NONE
 Grid Type: NO Grid
 Screen Frame Type: EXTRUDED
 Boxing Options: None
 Comfort Lift: Y
 Top Sash Comfort Lift: NONE
 Lock Type: Snap Lock
 Vent Ht: 35.9550
 PositiveDesignPressure: 65.0000
 PANumber: FL-239
 CondensationResistance: 60.0000
 SolarHeatGainCoeff: 0.2100
 VTCOG: 0.6400

NOA Selection: 16-0714.04
 Frame Type: .625FLANGE
 Window Style: STD
 Size Ref: ACTUAL
 Height: 72 5/8
 Rough Masonry: 34 1/4 X 73 5/8
 Egress: 28 1/4 X 28 1/8 (5.524 SQFT)
 Does unit need to meet Turtle Code: NO
 Glass: 3/4" IG (1/8 TMP - 1/2 ARG - 1/8 TMP)
 Argon Gas: ARGON
 Low E: ENERGY SHIELD MAX
 Glass Spacer Type: DS
 Screen Type: BetterVue Charcoal
 Anchor Group: D.SH5400
 Vent Latch: N
 Lift Rail: N
 WOCD: N
 Decralite: N
 CAR#: 16-0714.04
 NegativeDesignPressure: 109.9000
 EnergyStar: 123.0000
 UF: 0.2900
 VT: 0.4900

Ship Via: PGT: MONWED TRUCK

Location: DEN

Notes:

0005 (5.00) PW5420 PW5420 VINYL PICTURE WINDOW
 54.125X72.625,5/8" FL,W,TIG,CL,ARG,SB 70XL,OUTSIDE
 GLZ,NO GRD,,.x.

Ordered:
1.00

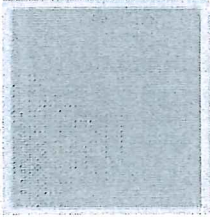

Certification Type: MIAMI
 Package Selection: NONE
 Size Selection: CUSTOM
 Width: 54.1250
 Actual Size: 54 1/8 X 72 5/8
 Wood Frame Opening: 54 3/8 X 72 7/8
 Does unit need to meet Turtle Code: NO
 Tempered Location: UNIT
 Glass: 7/8" IG (3/16 TMP - 1/2 ARG - 3/16 TMP)
 Low E: ENERGY SHIELD MAX
 Glass Spacer Type: TB
 Boxing Options: None
 CAR#: 16-0629.11
 NegativeDesignPressure: 84.4000
 EnergyStar: 1234.0000
 UF: 0.2500
 VT: 0.5300

NOA Selection: 16-0629.11
 Frame Type: .625FLANGE
 Size Ref: ACTUAL
 Height: 72.6250
 Rough Masonry Opening: 55 7/8 X 73 5/8
 Frame Color: White
 Glass Family: Insulating
 Argon Gas: ARGON
 Glass Color: CLEAR
 Privacy Glass: NONE
 Grid Type: NO Grid
 Decralite: N
 PositiveDesignPressure: 80.0000
 PANumber: FL 243
 CondensationResistance: 61.0000
 SolarHeatGainCoeff: 0.2300
 VTCOG: 0.6300

Ship Via: PGT: MONWED TRUCK

Location: DEN

Notes:

0006 (6.00) PW5420 PW5420 VINYL PICTURE WINDOW
 54.125X72.625,5/8" FL,W,TIG,CL,ARG,SB 70XL,OUTSIDE
 GLZ,NO GRD,,.x.

Ordered:
1.00

Sales Order# 228616

Print Date 10/28/2016

Page 3 of 6

Back Wall.

Replacing 3 ^{Joined} windows w/ 2 ^{Joined} windows

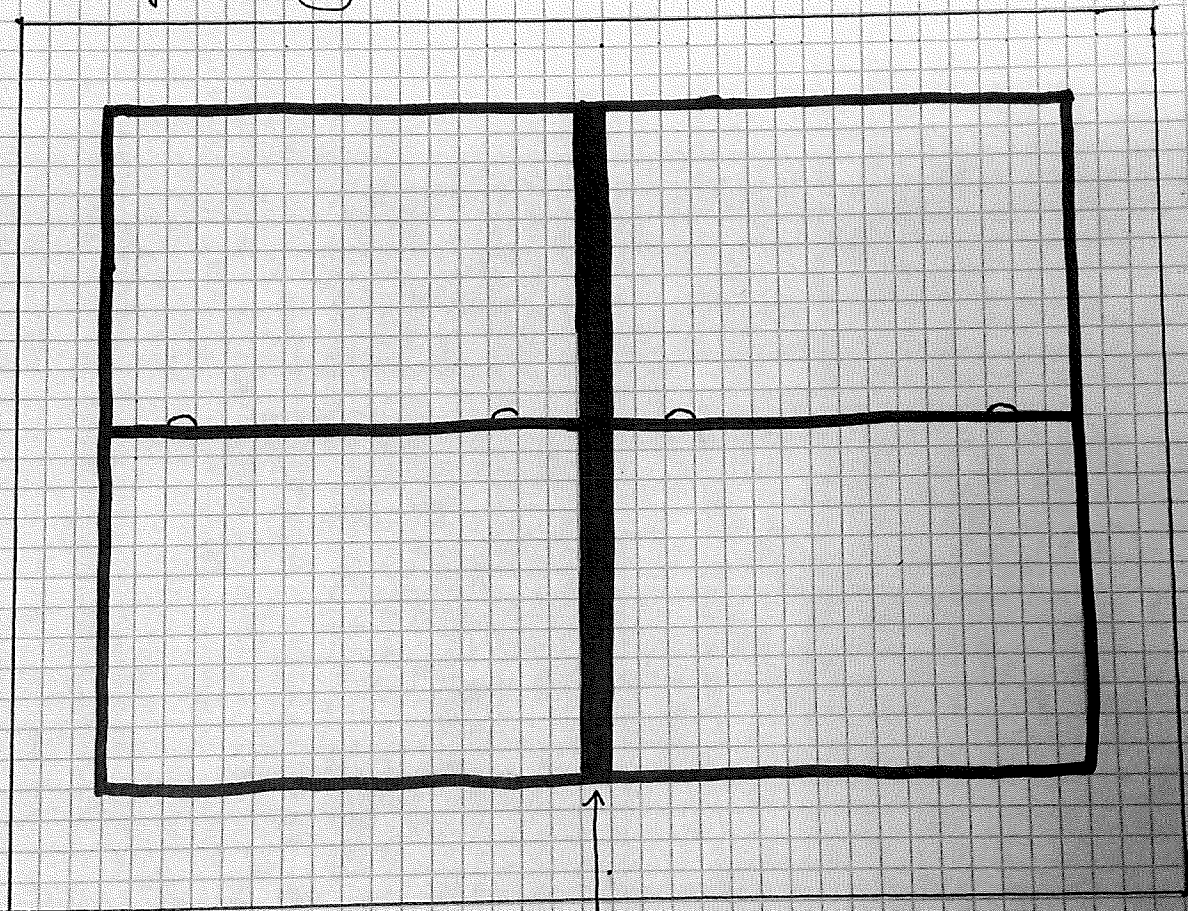

↑
mulling bar

Left Wall and Right Wall the Same
Replacing each window individually

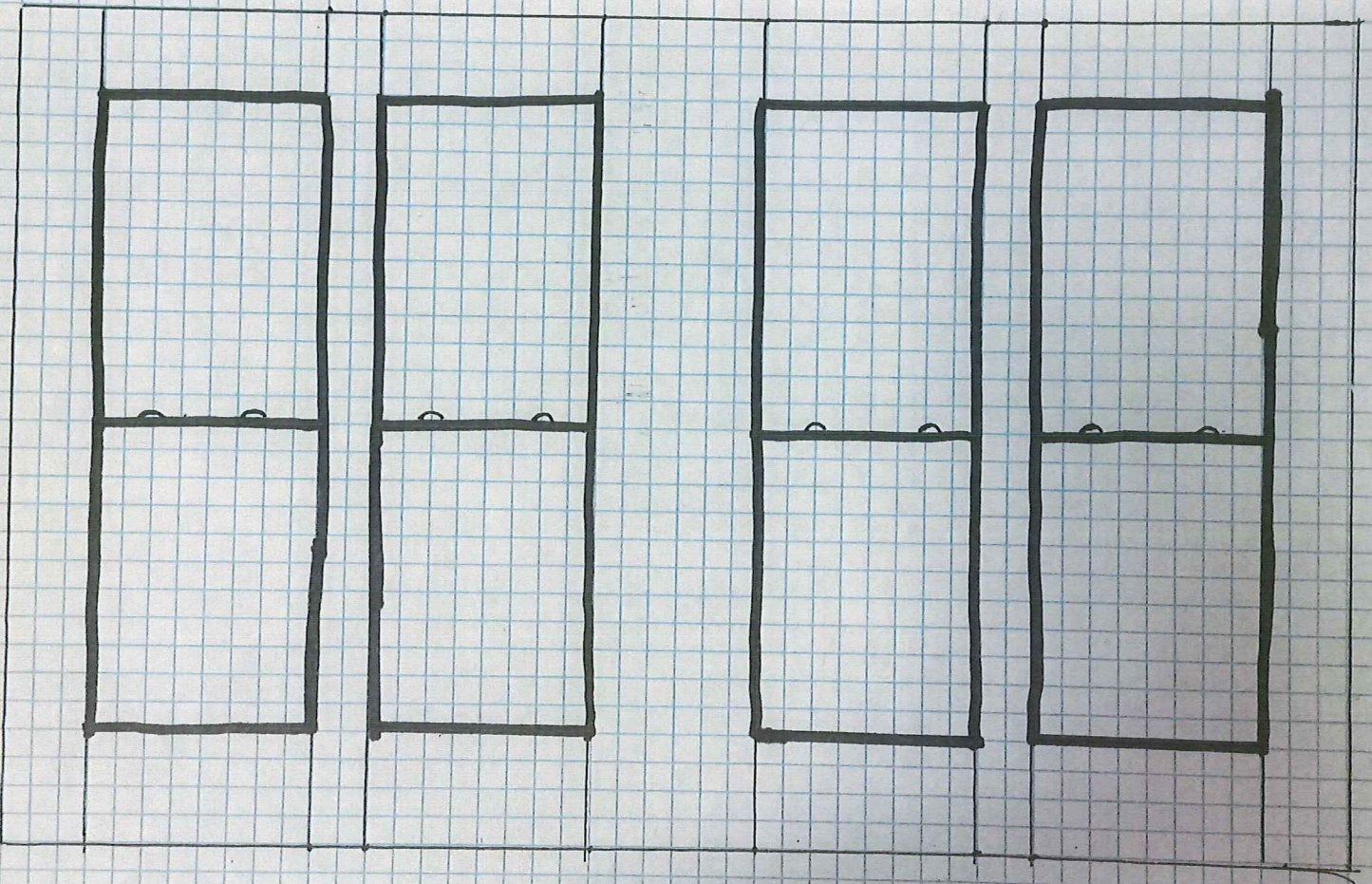













[Maria Lewicka, AICP](#) | Historic Preservation Planner | City of Fort Pierce

Planning Department

Phone: [772.467.3738](tel:772.467.3738) Fax: [772.466.5808](tel:772.466.5808) 100 North U.S. 1 Fort Pierce, FL 34950

[Website](#) | [Facebook](#) | [Survey](#)





Rotten siding replacement



New siding





Residence view from 8th Street



DEC 9 2016

COA# 16-78

Bldg. Permit # _____

Certificate of Appropriateness Application

Building & Site Information

Address of the Site: 102 S 2ND STREET

Parcel ID #: 2410-503-0108-000/6

Type of Designation: Contributing Non-contributing Site within the Historic District

Individually Designated Site, City Commission Resolution No. _____

Property Owner/ Applicant Information

X Property Owner(s)
Name(s): GUS GUTIERREZ
Mailing Address: 117 ORANGE AVE
Phone Number(s): (772) 801-5729 Email: FERRERO@PIERCEHARBOR.COM

Applicant
Name(s): ROD WALLER SUNRISE CITY CHDO
Mailing Address: 3550 OKEECHOBEE RD
Phone Number(s): 772-201 2850 Email: RODWALLER1@GMAIL.COM
SIGNATURESNL@AOL.COM

Representative
Name(s): _____
Mailing Address: _____
Phone Number(s): _____ Email: _____

Property Owner(s) Acknowledgements:- This application will not be considered complete without the signature of all property owners of record, which shall serve as an acknowledgement of the submission of this application. The property owner's signature below shall also authorize the Applicant (if other than the property owner) and/or Representative to act in his/her behalf for the purposes of seeking approval for the application described herein. The undersigned consents to inspection and photographing of the subject property by the Historic Preservation staff for purposes of consideration of this Application and/or presentation to the Historic Preservation Board.

I / We, _____ as Owner(s) of the subject property do hereby authorize the filing of this application on my/our behalf.

[Signature]
Signature of Owner

Date

Description of Requested Work

Please indicate the type of work requested:

- Fence
- Shed
- Door(s)
- Roof
- Window(s)
- Signage
- Shutter(s)
- Porch
- Rehabilitation
- New Construction
- Demolition
- Relocation

Site Improvements (describe) Sign INSTALLATION

Other (describe) _____

Please provide a detailed description of the proposed work to be performed: _____

Channel Letters For Tenant Space

Have other alterations been made to the site within the last 12 months? No Yes, _____

Will the proposed work require a Zoning Variance? No Yes, Code Section(s): _____

Application Requirements

- \$10.00 Application fee
- Site Plan with dimensions.
- Architectural Drawings:
 - Drawings should show all current and proposed floor plans and elevations, fences, walls, and any other landscape features.
 - Drawings should indicate materials to be used.
- Photos - One (1) color photograph of the main façade of the site and photographs of any areas affected by the proposed project.
- Material(s) specifications and/or sample(s)
- Color samples.
- Demolition – Plans for what will be taking the demolished structure’s place should be submitted.

Building Install Diagram



Customer: Ethel King
 Company: Brooklyn Sweets
 Address: 102 N 2nd Street
 City: Fort Pierce
 State: FL 34950
 Phone:
 Fax:



Roderick Waller, VP
 Sunrise City Community
 Housing Development Corporation
 1513 N 23rd Street
 Fort Pierce, FL, 34950

Job No.:	Job:
Order Date:	Completion:
Sign Location:	Estimate:
Comments:	

MARK DISOSWAY, PE
163 SW Midtown Pl, Ste 103
Latic City, Florida 32025
386-754-5419
FLPE53915

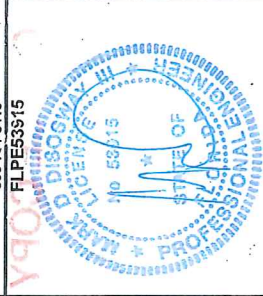

This seal for structural engineering per scope of work (Fasteners only)
11/18/2016

SCOPE OF WORK
ENGINEERING: Calculation of minimum fasteners. ONLY. (See equation)

This seal is NOT: architecture, electric, or structure of sign and wall.

By using this engineering sign installer, manufacturer, and owner agrees to:
1. Select fastener from table based on wall structure.
2. Install fasteners per fastener manufacturer instructions in locations required by sign manufacturer; this may mean more fasteners are required than shown in table.
3. Make sure sign and wall meets building code, sign code, and UL. Verify stated wind (speed, risk, exp. topo), sign (size, area, location on wall, max weight), wall (materials and construction).

PASTED IMAGES, DETAILS, DRAWINGS, AND NOTES ON THIS SHEET ARE NOT ENGINEERED OR REVIEWED.

They were pasted in at customer's request to help relate fastener engineering to the job.

Signature Signs
-N- Lettering

Job #161313

WALL SIGN
Flat on wall max 12" thick

Brooklyn Sweets

102 N. 2nd St.
Fort Pierce, FL 34950

For one sign each type at this location.

disoswaydesign@gmail.com
ref 2012 IBC, ASCE7-10

5th EDITION FLORIDA BUILDING CODE (2014)

Risk Category
II, Normal hazard to human life; III, Substantial hazard to human life; IV, Essential, emergency, critical

Wind Speed
Basic Wind Speed, Ultimate, mph, from ASCE7-10, Fig.26.5-1A, Risk II, or Fig.26.5-1B, Risk III/IV

Exposure
Wind Exposure C, No unobstructed area within 1200ft; Wind Exposure D, Unobstructed area upwind

Sign Height
Sign Height Above Ground, ft, H; Sign cannot be higher than top of wall or 60'. For multiple signs use worst case.

Sign Area
Gross Sign Area, sq.ft., means the overall area surrounding and including all sign letters and logos.

WIND LOAD CALC: ASCE 7-10, Section 29.4.2, "Solid Attached Signs"
C & C Wind pressure on solid sign attached flat against wall or parallel to wall, ⁺ from surface and ⁻ from edge, equals wall wind pressure from ASCE7-10, Section 30.4.

See Table
Wind Force on Sign: F = Psst * Net Sign Area
Wind Pressure: Psst = Qsust * Gp, ASD, C&C, ASCE7-10, Eq.30.4-1
Velocity Pressure: Qsust = 0.00256 * Kz * Kd * V^2, ASCE7-10, Eq.30.3-1
Wind Speed: Vast = sqrt(Vult^2 * G), for allowable stress design
Veloc Pres Expos Coeff: Kz = 2.01 * H^0.900 * (29.9)^0.25 * Cp, (700 & 1.5) / (30.3-1)
External Pressure Coeff: Gp = -1.8, Zone 5, 102 area, ASCE7-10, Fig.30.4-1
Internal Pressure Coeff: Cpi = 0, sign flat against wall, ASCE7-10, Sec.29.4.2
Topographic Factor: Kzt = 1 for flat ground, no hill, ridge, or escarpment > 15'

Sign Weight: must be less than 5 pounds per sq.ft. net area.

SIGN INSTALLER INSTRUCTIONS
1. Verify (sq.ft.) (flush, raceway, or pin) (solid area or letters)
2. Select fastener for wall structure.
3. Evenly space fasteners over whole sign area.

USE MORE FASTENERS IF THE SIGN NEEDS IT! ONLY ATTACH TO STRUCTURAL WALL MATERIAL (CMU). Shapes and strength of sign may require more fasteners. Example: "I" may need 2 fasteners, "V", "3", "4", "10", "5" and "18" thick plate may need more fasteners to avoid bending. Follow sign manufacturer's instructions and code requirements for placement of fasteners. At least put pins in each corner top and bottom. Raceway sign fasteners spaced evenly in two rows 5"-7" apart, half on top row, and half on bottom row. Place fastener on centroid line of sign or increase fasteners by (offset * 3) / 8". Follow fastener manufacturer's instructions and code requirements for installation.

CALCULATION: Minimum Number of Fasteners Evenly Spaced Over Whole Sign
(Fasteners = Wind Force on Whole Sign Area / Fastener Allowable Tension)

Fastener	Wall Structure	Pull	Fastener Installation
4	3/8" or 1/2" Thru Bolt	500	3/8" or 1/2" bolt, nut, washer thru wall; CMU, brick, concrete, 2x4 or unframed backer
5	3/8" or 1/2" Thru Bolt	100	3/8" or 1/2" bolt, nut, and washer thru 1/2" OSB or plywood sheathing
4	3/8" Lag Shield	200	3/8" - 16 screw in 5/8" hole, tap anchor flush.
5	3/8" Lag Shield	100	3/8" - 16 screw in 5/8" hole, tap anchor flush.
4	1/4" Tapcon	171	1/4" Tapcon, min 1.5" embedment, protect from moisture.
11	1/4" Tapcon	43	1/4" Tapcon, min 1.25" embedment, protect from moisture.
6	#12 Metal Screw	83	#12-14 Self-drilling screws 3 threads thru 20ga steel frame.
6	#12 Wood Screw	77	#12-14 wood screw or SMS into 5/8" OSB or plywood sheathing.
4	Timber Screw	170	FastenerMaster TimberLOK, 1/4" thread wood screw 1.25" in wood
9	1/2" Toggle Bolt	53	Toggle Bolt, Powers spring-wing, in CMU, OSB, or 5/8" DensGlass.
4	1/2" Sleeve Anchor	380	1/2" HILTI HLC-H or HLC-HX304SS3/8 Sleeve Anchor, 1.5" embed
4	1/2" Liberty Toggle	360	DEFS Liberty Toggle
10	3/8" Stud Glued	50	3/8" stud glued in solid wall mat'l, Liquid Nails LN-950, Hilti DP-70, or equal.
	Pin Stud Thru	100	3/16" pin-stud, nut, and washer thru structural wall or 2x4 blocking
	Structural Wall	25	3/16" pin-stud glued in solid wall mat'l, Liquid Nails LN-950 or equal
	Solid Wall Mat'l		
	Pin Stud Thru		
	Structural Wall		
	Solid Wall Mat'l		

IMPORTANT - Adhesives are strong but none have code approval for structural applications. Sign installer must test glued stud connection strength. For 3/16" stud pull 50 lb per stud; for 3/8" stud pull 100 lb per stud. Use tripod, game scale, and blocks.

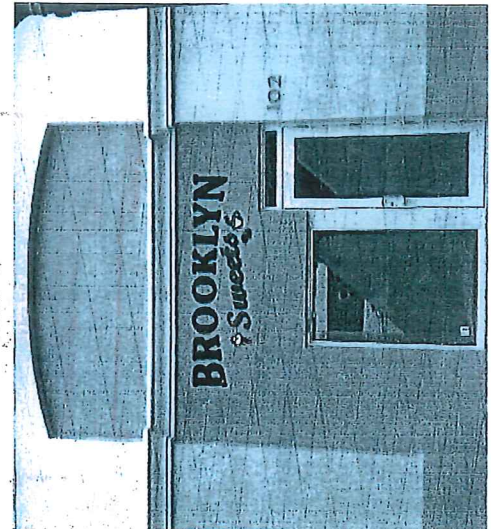
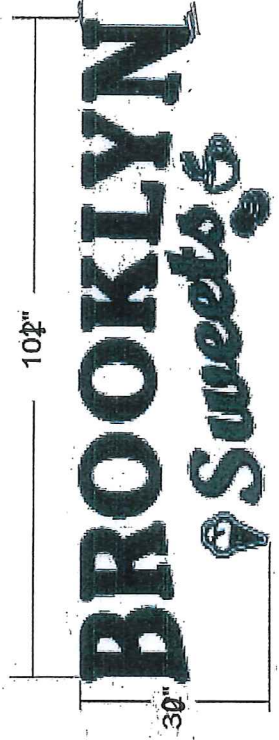



CERTIFICATE OF APPROPRIATENESS
 TO ALTER A DESIGNATED HISTORIC SITE

COA#16-79 HISTORIC PRESERVATION BOARD APPROVAL ADMINISTRATIVE APPROVAL

Site address 600 N 15th Street
 Contributing Non-Contributing Individually Designated

SITE ALTERATIONS:

Request	Conditions	Applicable Standards
Infill one door. Entrance had originally two doors. Please see attached drawings.	.	Secretary of the Interior's Standards for Rehabilitation of Historic Properties, Standard 9.

APPROVED:

Board Approval

Administrative Approval

 Paul Samson, Chair Date
 Historic Preservation Board



 _____ 12/12/16
 Maria Lewicka, AICP Date
 Historic Preservation Planner

This alteration meets the Secretary of the Interior's Standards for the Treatment of Historic Properties and the City of Fort Pierce Code of Ordinances.

Should you have any further questions or concerns, contact Maria Lewicka, Historic Preservation Planner, at (772) 467-3738 or via e-mail at mlewicka@city-ftpierce.com.

Thank you for your efforts to preserve and redevelop historic Fort Pierce through your participation in the Certificate of Appropriateness Application process. Staff looks forward to working with you in the future to preserve and rehabilitate our historic neighborhoods and structures.

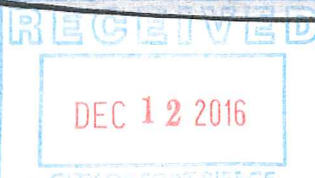
Provided to:	Name/Address	Via
Owner	Brenda Brunson 600 N 15 th Street Fort Pierce, FL 34950	E-Mail
Applicant	Rod Waller 3550 Okeechobee Road Fort Pierce, FL 34947	E-Mail Rodwaller1@gmail.com
Other	Paul Thomas, CFP Building Administrator Kim West, CFP Building Department Susan Keller, CFP Building Department	E-Mail E-Mail E-Mail



Bldg. Permit # 16-2432

COA# 16-79

Certificate of Appropriateness Application

Building & Site Information

Address of the Site: 600 N 15TH ST
 Parcel ID #: 2404-814-0006-000/7
 Type of Designation: Contributing Non-contributing Site within the _____ Historic District
 Individually Designated Site, City Commission Resolution No. _____

Property Owner/ Applicant Information

Property Owner(s)
 Name(s): BRUNSON, BRENDA
 Mailing Address: 600 N 15TH ST, FORT PIERCE fl
 Phone Number(s): 772-882-0929 Email: _____

Applicant
 Name(s): Rod Waller / Sunrise City CHDO Inc.
 Mailing Address: 3550 OKEECHOBEE RD FORT PIERCE FL 34947
 Phone Number(s): 772-201-2850 Email: RODWALLER1@GMAIL.COM

Representative
 Name(s): _____
 Mailing Address: _____
 Phone Number(s): _____ Email: _____

Property Owner(s) Acknowledgements:- This application will not be considered complete without the signature of all property owners of record, which shall serve as an acknowledgement of the submission of this application. The property owner's signature below shall also authorize the Applicant (if other than the property owner) and/or Representative to act in his/her behalf for the purposes of seeking approval for the application described herein. The undersigned consents to inspection and photographing of the subject property by the Historic Preservation staff for purposes of consideration of this Application and/or presentation to the Historic Preservation Board.

I / We, Roderick J Waller as Owner(s) of the subject property do hereby authorize the filing of this application on my/our behalf.

Brenda Brunson
 Signature of Owner

12/12/16
 Date

Description of Requested Work

Please indicate the type of work requested:

- | | | | |
|--|---|---|-------------------------------------|
| <input type="checkbox"/> Fence | <input type="checkbox"/> Shed | <input checked="" type="checkbox"/> Door(s) | <input type="checkbox"/> Roof |
| <input type="checkbox"/> Window(s) | <input checked="" type="checkbox"/> Signage | <input type="checkbox"/> Shutter(s) | <input type="checkbox"/> Porch |
| <input checked="" type="checkbox"/> Rehabilitation | <input type="checkbox"/> New Construction | <input type="checkbox"/> Demolition | <input type="checkbox"/> Relocation |

Site Improvements (describe) _____

Other (describe) _____

Please provide a detailed description of the proposed work to be performed: Entrance had 2

Doors. Fill one door

Have other alterations been made to the site within the last 12 months? No Yes, _____

Will the proposed work require a Zoning Variance? No Yes, Code Section(s): _____

Application Requirements

- \$10.00 Application fee
- Site Plan with dimensions.
- Architectural Drawings:
 - Drawings should show all current and proposed floor plans and elevations, fences, walls, and any other landscape features.
 - Drawings should indicate materials to be used.
- Photos - One (1) color photograph of the main façade of the site and photographs of any areas affected by the proposed project.
- Material(s) specifications and/or sample(s)
- Color samples.
- Demolition - Plans for what will be taking the demolished structure's place should be submitted.



Old Location of Door



Google Earth

© 2016 Google
© 2016 Google

feet
meters

10

4

Google Earth





CERTIFICATE OF APPROPRIATENESS
TO ALTER A DESIGNATED HISTORIC SITE

COA#16-80 HISTORIC PRESERVATION BOARD APPROVAL ADMINISTRATIVE APPROVAL

Site address 658 N 2nd Street
 Contributing Non-Contributing Individually Designated

SITE ALTERATIONS:

Request	Conditions	Applicable Standards
Remove tar and gravel from the flat roof and install modified bitumen. Please see attached.		Secretary of the Interior's Standards for Rehabilitation of Historic Properties, Standard 9.

APPROVED:

Board Approval

Administrative Approval

Paul Samson, Chair Date
Historic Preservation Board

Maria Lewicka, MCP 12/27/16
Historic Preservation Planner Date

This alteration meets the Secretary of the Interior's Standards for the Treatment of Historic Properties and the City of Fort Pierce Code of Ordinances.

Should you have any further questions or concerns, contact Maria Lewicka, Historic Preservation Planner, at (772) 467-3738 or via e-mail at mlewicka@city-ftpierce.com.

Thank you for your efforts to preserve and redevelop historic Fort Pierce through your participation in the Certificate of Appropriateness Application process. Staff looks forward to working with you in the future to preserve and rehabilitate our historic neighborhoods and structures.

Provided to:	Name/Address	Via
Owner	Trevor G Horvath Taryn M Horvath 2301 River Hammock LN Fort Pierce, FL 34981-4934	E-Mail
Applicant	Castoneway Roofing LLC 3271 Oleander Ave. Fort Pierce, FL 34982	castonguayroofing@gmail.com
Other	Paul Thomas, CFP Building Administrator Kim West, CFP Building Department Susan Keller, CFP Building Department	E-Mail E-Mail E-Mail



DEC 21 2016

COA# 16-80

Bldg. Permit # _____

Certificate of Appropriateness Application

Building & Site Information

Address of the Site: 658 N. 2nd St FT PIERCE

Parcel ID #: 2403 8010006 0004

Type of Designation: Contributing Non-contributing Site within the _____ Historic District

Individually Designated Site, City Commission Resolution No. _____

Property Owner/ Applicant Information

Property Owner(s)

Name(s): CAPTAIN'S GALLEY / JANET POWER

Mailing Address: 2301 RIVER HAMMOCK LN FT PIERCE FL 34981

Phone Number(s): 772 979 5970 Email: _____

Applicant

Name(s): CASTLEWAY ROOFING LLC

Mailing Address: 3271 OLEANDER AVE FT PIERCE FL 34982

Phone Number(s): 772-216-8047 Email: CastlewayRoofing@gmail.com

Representative

Name(s): _____

Mailing Address: _____

Phone Number(s): _____ Email: _____

Property Owner(s) Acknowledgements:- This application will not be considered complete without the signature of all property owners of record, which shall serve as an acknowledgement of the submission of this application. The property owner's signature below shall also authorize the Applicant (if other than the property owner) and/or Representative to act in his/her behalf for the purposes of seeking approval for the application described herein. The undersigned consents to inspection and photographing of the subject property by the Historic Preservation staff for purposes of consideration of this Application and/or presentation to the Historic Preservation Board.

I / We, Janet Power as PRESIDENT Owner(s) of the subject property do hereby authorize the filing of this application on my/our behalf.

Janet Power
Signature of Owner

12/21/2016
Date

Description of Requested Work

Please indicate the type of work requested:

- Fence
- Shed
- Door(s)
- Roof
- Window(s)
- Signage
- Shutter(s)
- Porch

- Rehabilitation
- New Construction
- Demolition
- Relocation

- Site Improvements (describe) TO REMOVE TAR & GRAVEL AND INSTALL MODIFIED BITUMEN
- Other (describe) _____

Please provide a detailed description of the proposed work to be performed: _____

Have other alterations been made to the site within the last 12 months? No Yes, _____

Will the proposed work require a Zoning Variance? No Yes, Code Section(s): _____

Application Requirements

- \$10.00 Application fee
- Site Plan with dimensions.
- Architectural Drawings:
 - Drawings should show all current and proposed floor plans and elevations, fences, walls, and any other landscape features.
 - Drawings should indicate materials to be used.
- Photos - One (1) color photograph of the main façade of the site and photographs of any areas affected by the proposed project.
- Material(s) specifications and/or sample(s)
- Color samples.
- Demolition - Plans for what will be taking the demolished structure's place should be submitted.

CITY OF FORT PIERCE
BUILDING DEPARTMENT
RE-ROOF FORM
PHONE: 772-467-3529 or 467-3724
FAX: 772-467-3849

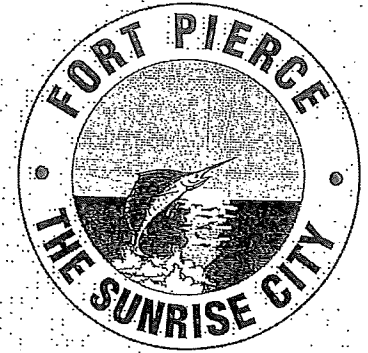

Owner Name: CAPTAIN'S GALLEY (JANET Power)

Property Address: 658 N. 2nd ST

Description of Work: REMOVE AND REPLACE ROOFING (2 stories ONLY)

Roof Spec's: _____

Notice: Shingles **can not** be used on roof slope less than 2/12 pitch.
Check manufacturer specifications, some indicate min 3/12.

Less than 4/12 requires 19" lap for underlayment.

**Flat Roofs: Less than 7 degrees and less than 400sqft area
requires enhanced nailing**

2014 (5th Edition) FBC Residential Section 905

2014 (5th Edition) FBC Building Section 1507

Roof Dimensions: 45' x 30'

Square Footage: 1400-

Rotten Wood: Yes No ?

Roof Type: Gable Hip Flat Other

Roof Material Shingle Metal Tile Tar & Gravel Other

Pitch/Slope: FLAT

Underlayment: ALL WEATHER
EMPIRE BASE # Felt: _____ Other: MODIFIED BITUMEN
SHEET

** Must note on Product Approval any material used**



THIS WILL BE MATERIAL USE FOR 658 N. 2nd ST
MODIFIED BITUMEN ROOF REPAIR TO REPLACE
THE EXISTING TAR & GRAVEL.

