

Michelle Franklin, CFA -- Saint Lucie County Property Appraiser -- All rights reserved.

Property Identification

Site Address: 615 S INDIAN RIVER DR
 Sec/Town/Range: 10/35S/40E
 Map ID: 24/10H
 Zoning: R4

Parcel ID: 2410-812-0001-000-5
 Account #: 23918
 Use Type: 0100
 Jurisdiction: Fort Pierce

Ownership

Jacob Z Berg
 Dustan P Berg
 1633 NE 33rd ST
 Oakland Park, FL 33334-5323

Legal Description

HOOFNAGLE'S S/D LOTS 1, 2 AND 3 (MAP 24/10H) (OR 3918-1344)

Current Values

Just/Market Value: \$161,900
 Assessed Value: \$161,900
 Exemptions: \$0
 Taxable Value: \$161,900
 Taxes for this parcel: SLC Tax Collector's Office
 Download TRIM for this parcel: Download PDF



Total Areas

Finished/Under Air (SF): 1,958
 Gross Area (SF): 3,196
 Land Size (acres): 0.47
 Land Size (SF): 20,560

Sale History

Date	Book/Page	Sale Code	Deed	Grantor	Price
Oct 3, 2016	3918 / 1344	0001	WD	Esvan Yannick	\$100,000
Apr 26, 2012	3384 / 1072	0205	WD	IRFL Properties LLC,	\$338,000
Feb 15, 2011	3272 / 0371	0330	WD	Allen ,Robert	\$100
Dec 8, 2010	3255 / 0261	0311	PB	Starcher (EST),Mildred Allen	\$0
Dec 1, 1976	0262 / 1809	XX01	CV		\$49,300

Building Information (1 of 1)

Finished Area: 1,958 SF
 Gross Total Area: 3,196 SF

Exterior Data

View:	Roof Cover: Conc Tile	Roof Structure: Gable
Building Type: HC+	Year Built: 1920	Frame:
Grade: C+	Effective Year: 1940	Primary Wall: CB Stucco
Story Height: 2 Story	No. Units: 1	Secondary Wall:

Interior Data

Bedrooms: 2	Electric: MAXIMUM	Primary Int Wall:
Full Baths: 2	Heat Type: FrcdHotAir	Avg Hgt/Floor: 0
Half Baths: 0	Heat Fuel: ELEC	Primary Floors: Carpet
A/C %: 100%	Heated %: 100%	Sprinkled %: 0%

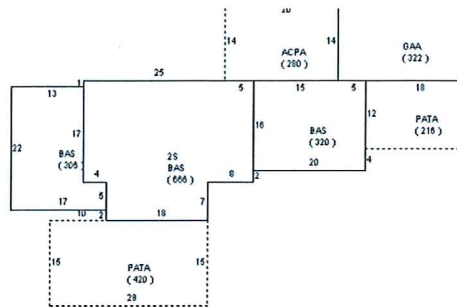

Sketch Area Legend

Sub Area	Description	Area	Fin. Area	Perimeter
2S	ONE FULL STORY OVER BASE (TOTAL 2 FLOORS)	666	666	110
ACPA	Aluminium Carport Average	280	0	68
BAS	BASE AREA	1292	1292	260
GAA	Garage Attached Average	322	0	74
PATA	Patio Average (Plain Slab)	636	0	146

Special Features and Yard Items

Type	Qty	Units	Year Blt
Driv-Concret	1	1965	1920

Current Year Values

Current Values Breakdown		Current Year Exemption Value Breakdown				
		Tax Year	Grant Year	Code	Description	Amount
Building:	\$64,900					
Land:	\$97,000					
Just/Market:	\$161,900					
Ag Credit:	\$0					
Save Our Homes or 10% Cap:	\$0					
Assessed:	\$161,900					
Exemption(s):	\$0					
Taxable:	\$161,900					

Current Year Special Assessment Breakdown

Start Year	AssessCode	Units	Description	Amount
1999	0041	1	Fort Pierce Stormwater Charge	\$54.00

This does not necessarily represent the total Special Assessments that could be charged against this property. The total amount charged for special assessments is reflected on the most current tax statement and information is available with the SLC Tax Collector's Office.

Historical Values

Year	Just/Market	Assessed	Exemptions	Taxable
2016	\$161,900	\$161,900	\$0	\$161,900
2015	\$172,100	\$172,100	\$0	\$172,100
2014	\$163,500	\$163,500	\$0	\$163,500

Number	Issue Date	Description	Amount	Fee
F93-001627	Dec 20, 1993	Heat and Air Conditioning	\$8,000	\$8,000
RR20051033	Sep 23, 2005	Alterations/Remodeling	\$9,000	\$165
0700001236	Aug 30, 2007	Air Conditioning Only	\$1,500	\$75

Notice: This does not necessarily represent all the permits for this property.
Click the following link to check for additional permit data in Fort Pierce

This information is believed to be correct at this time but it is subject to change and is not warranted.
© Copyright 2017 Saint Lucie County Property Appraiser. All rights reserved.