

Michelle Franklin, CFA -- Saint Lucie County Property Appraiser -- All rights reserved.

Property Identification

Site Address: 1011 BOSTON AVE
 Sec/Town/Range: 09/35S/40E
 Map ID: 24/09S
 Zoning: R4

Parcel ID: 2409-802-0016-000-8
 Account #: 22611
 Use Type: 0100
 Jurisdiction: Fort Pierce

Ownership

Kevin J Deese
 Heather L Deese
 1011 Boston AVE
 Fort Pierce, FL 34950-8846

Legal Description

DUKETT S/D BLK 2 LOTS 5, 6 AND 7 (OR 3917-380)

Current Values

Just/Market Value: \$101,400
 Assessed Value: \$80,595
 Exemptions: \$50,000
 Taxable Value: \$30,595

Taxes for this parcel: SLC Tax Collector's Office

Download TRIM for this parcel: Download PDF



Total Areas

Finished/Under Air (SF): 3,376
 Gross Area (SF): 4,526
 Land Size (acres): 0.46
 Land Size (SF): 19,950

Sale History

Date	Book/Page	Sale Code	Deed	Grantor	Price
Sep 28, 2016	3917 / 0380	0001	WD	Bennett Anna R	\$275,000
Jul 12, 2005	2327 / 2779	XX01	QC	Bennett,Anna R	\$100
Jun 14, 2002	1541 / 1319	XX04	QC	Bennett,Anna R	\$100
Jul 1, 1987	0573 / 0668	XX01	CV		\$0
May 1, 1985	0467 / 1843	XX01	CV		\$0

Building Information (1 of 3)

Finished Area: 2,128 SF

Gross Total Area: 2,694 SF

Exterior Data

View:	Roof Cover: Metal	Roof Structure: Gable
Building Type: HC	Year Built: 1936	Frame:
Grade: C	Effective Year: 1975	Primary Wall: Wood/Sheath
Story Height: 2 Story	No. Units: 1	Secondary Wall:

Interior Data

Bedrooms: 1	Electric: MAXIMUM	Primary Int Wall:
Full Baths: 2	Heat Type: FredHotAir	Avg Hgt/Floor: 0
Half Baths: 0	Heat Fuel: ELEC	Primary Floors: Double Pine
A/C %: 100%	Heated %: 100%	Sprinkled %: N/A%

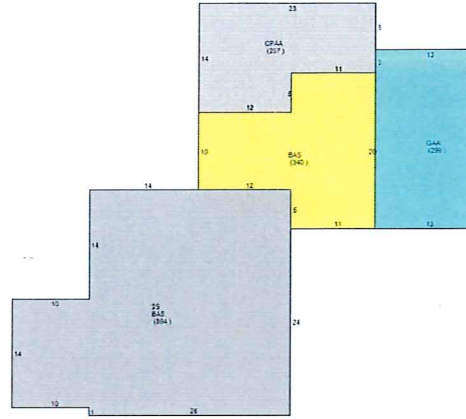

Sketch Area Legend

Sub Area	Description	Area	Fin. Area	Perimeter
2S	ONE FULL STORY OVER BASE (TOTAL 2 FLOORS)	894	894	130
BAS	BASE AREA	1234	1234	216
CPAA	Carport Attached Average	267	0	74
GAA	Garage Attached Average	299	0	72

Building Information (2 of 3)

Finished Area: 1,248 SF

Gross Total Area: 1,348 SF

Exterior Data

View:
 Building Type: HC
 Grade: C
 Story Height: 2 Story

Roof Cover: Metal
 Year Built: 1936
 Effective Year: 1975
 No. Units: 1

Roof Structure: Gable
 Frame:
 Primary Wall: Wood/Sheath
 Secondary Wall:

Interior Data

Bedrooms: 3
 Full Baths: 2
 Half Baths: 0
 A/C %: 100%

Electric: MAXIMUM
 Heat Type: FrcdHotAir
 Heat Fuel: ELEC
 Heated %: 100%

Primary Int Wall:
 Avg Hgt/Floor: 0
 Primary Floors: Hardwood
 Sprinkled %: %

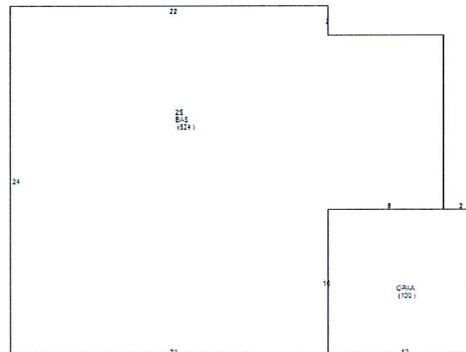

Sketch Area Legend

Sub Area	Description	Area	Fin. Area	Perimeter
2S	ONE FULL STORY OVER BASE (TOTAL 2 FLOORS)	624	624	108
BAS	BASE AREA	624	624	108
OPAA	Open Porch Attached Average	100	0	40

Building Information (3 of 3)

Finished Area: 0 SF

Gross Total Area: 484 SF

Exterior Data

View:
 Building Type: DCAR
 Grade: DC
 Story Height: 1 Story

Roof Cover: Tar & Gravel
 Year Built: 1936
 Effective Year: 1956
 No. Units: 0

Roof Structure: Flat/Shed
 Frame:
 Primary Wall:
 Secondary Wall:

Interior Data

Bedrooms: 0
 Full Baths: 0
 Half Baths: 0
 A/C %: %

Electric: NONE
 Heat Type:
 Heat Fuel:
 Heated %: %

Primary Int Wall:
 Avg Hgt/Floor: 0
 Primary Floors: CONC GRD
 Sprinkled %: %

*Image
 or
 Sketch
 unavailable
 for display*

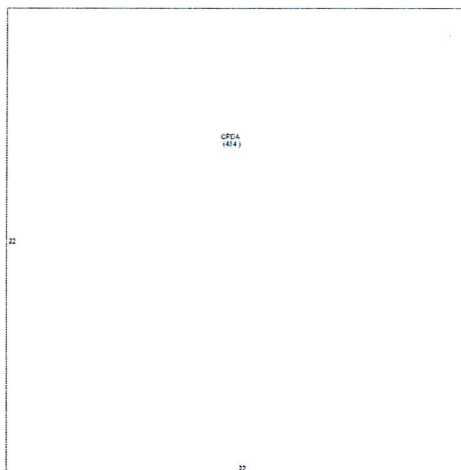

Sketch Area Legend

Sub Area	Description	Area	Fin. Area	Perimeter
CPDA	Carport Detached Average	484	0	88

Special Features and Yard Items

Type	Qty	Units	Year Blt
------	-----	-------	----------

Current Year Values

Current Values Breakdown		Current Year Exemption Value Breakdown				
		Tax Year	Grant Year	Code	Description	Amount
Building:	\$89,100					
Land:	\$12,300	2016	2003	0500	Homestead Exemption	\$25,000
Just/Market:	\$101,400	2016	2008	0550	Homestead Exemption over \$50,000	\$25,000
Ag Credit:	\$0					

Property Card

10% Cap:
 Assessed: \$80,595
 Exemption(s): \$50,000
 Taxable: \$30,595

Current Year Special Assessment Breakdown

Start Year	AssessCode	Units	Description	Amount
1999	0041	1	Fort Pierce Stormwater Charge	\$54.00

This does not necessarily represent the total Special Assessments that could be charged against this property. The total amount charged for special assessments is reflected on the most current tax statement and information is available with the SLC Tax Collector's Office .

Historical Values

Year	Just/Market	Assessed	Exemptions	Taxable
2016	\$101,400	\$80,595	\$50,000	\$30,595
2015	\$82,500	\$80,035	\$50,000	\$30,035
2014	\$79,400	\$79,400	\$50,000	\$29,400

Permits

Number	Issue Date	Description	Amount	Fee
RF20052488	Jan 6, 2005	Roof	\$10,800	\$233
BP16-0358	Feb 12, 2016	Re Roof Permit	\$3,300	\$100

Notice: This does not necessarily represent all the permits for this property.

Click the following link to check for additional permit data in Fort Pierce

This information is believed to be correct at this time but it is subject to change and is not warranted.

© Copyright 2017 Saint Lucie County Property Appraiser. All rights reserved.