

Michelle Franklin, CFA -- Saint Lucie County Property Appraiser -- All rights reserved.

Property Identification

Site Address: 502 N 19th ST
 Sec/Town/Range: 09/35S/40E
 Map ID: 24/09N
 Zoning: C2

Parcel ID: 2409-602-0285-000-0
 Account #: 21909
 Use Type: 7100
 Jurisdiction: Fort Pierce

Ownership

Triumph Ch and Kingdom Of God
 PO Box 1311
 Fort Pierce, FL 34954

Legal Description

ALAMANDA VISTA S/D BLK N LOT 12 AND W 5 FT OF VAC ALLEY
 ADJ ON E

Current Values

Just/Market Value: \$62,200
 Assessed Value: \$62,200
 Exemptions: \$62,200
 Taxable Value: \$0

Taxes for this parcel: SLC Tax Collector's Office
 Download TRIM for this parcel: Download PDF



Total Areas

Finished/Under Air (SF): 3,002
 Gross Area (SF): 3,002
 Land Size (acres): 0.17
 Land Size (SF): 7,250

Sale History

Date	Book/Page	Sale Code	Deed	Grantor	Price
Jan 1, 1900					\$0

Building Information (1 of 1)

Finished Area: 3,002 SF

Gross Total Area: 3,002 SF

Exterior Data

View:	Roof Cover: Fibrglss Shg	Roof Structure: Gable
Building Type: CH3	Year Built: 1950	Frame:
Grade: Y_D	Effective Year: 1976	Primary Wall: Conc Block
Story Height: 1 Story	No. Units: 1	Secondary Wall:

Interior Data

Bedrooms: 0	Electric: MAXIMUM	Primary Int Wall:
Full Baths: 0	Heat Type: FredHotAir	Avg Hgt/Floor: 0
Half Baths: 0	Heat Fuel: ELEC	Primary Floors: Sing Pine
A/C %: 100%	Heated %: 100%	Sprinkled %: 0%

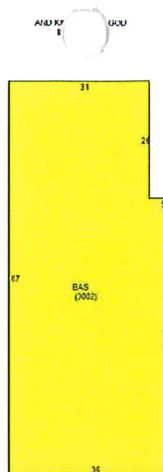

Sketch Area Legend

Sub Area	Description	Area	Fin. Area	Perimeter
BAS	BASE AREA	3002	3002	246

Special Features and Yard Items

Type	Qty	Units	Year Blt
------	-----	-------	----------

Current Year Values

Current Values Breakdown		Current Year Exemption Value Breakdown				
		Tax Year	Grant Year	Code	Description	Amount
Building:	\$54,900					
Land:	\$7,300	2016		3600	Church	\$62,200
Just/Market:	\$62,200					
Ag Credit:	\$0					
Save Our Homes or 10% Cap:	\$0					
Assessed:	\$62,200					
Exemption(s):	\$62,200					
Taxable:	\$0					

Current Year Special Assessment Breakdown

Start Year	AssessCode	Units	Description	Amount
------------	------------	-------	-------------	--------

This does not necessarily represent the total Special Assessments that could be charged against this property. The total amount charged for special assessments is reflected on the most current tax statement and information is available with the SLC Tax Collector's Office.

Historical Values

Year	Just/Market	Assessed	Exemptions	Taxable
2016	\$62,200	\$62,200	\$62,200	\$0
2015	\$68,200	\$68,200	\$68,200	\$0
2014	\$69,100	\$69,100	\$69,100	\$0

Permits

Number	Issue Date	Description	Amount	Fee
RF20051758	Apr 28, 2005	Roof	\$1,500	\$50

Notice: This does not necessarily represent all the permits for this property.
Click the following link to check for additional permit data in Fort Pierce

This information is believed to be correct at this time but it is subject to change and is not warranted.
© Copyright 2017 Saint Lucie County Property Appraiser. All rights reserved.