

Michelle Franklin, CFA -- Saint Lucie County Property Appraiser -- All rights reserved.

Property Identification

Site Address: 104 ROSELYN AVE Map ID: 24/22N Parcel ID: 2422-504-0042-000-5 Zoning: R3 Account #: 29967 Use Type: 0100 Sec/Town/Range: 22/35S/40E Jurisdiction: Fort Pierce

Ownership

Barbara L Johnston
3190 SW Armucher St
Port St Lucie, FL 34953

Legal Description

SUNSET PARK BLK 3 LOT 12 (OR 3669-2090)

Current Values

Just/Market: \$59,400 Assessed: \$39,930
Exemptions: \$0 Taxable: \$39,930

Historical Values 3-year

| Year | Just/Market | Assessed | Exemptions | Taxable |
|------|-------------|----------|------------|----------|
| 2017 | \$59,400 | \$39,930 | \$0 | \$39,930 |
| 2016 | \$39,200 | \$36,300 | \$0 | \$36,300 |
| 2015 | \$33,000 | \$33,000 | \$0 | \$33,000 |

Sale History

| Date | Book/Page | Sale Code | Deed | Grantor | Price |
|------------|-------------|-----------|------|---------------------|----------|
| 09-08-2014 | 3669 / 2090 | 0111 | QC | Partington,Thomas S | \$100 |
| 10-01-1977 | 0276 / 0504 | XX00 | CV | | \$24,000 |
| 06-01-1972 | 0203 / 0887 | XX00 | CV | | \$15,700 |

Primary Building Information

Finished Area of this building: 1,336 SF
Gross Area of this building: 1,608 SF

Exterior Data

| | | | |
|--------------------------|-------------------------|-----------------------|----------------------|
| View: | Roof Cover: Dim Shingle | Roof Structure: Gable | Building Type: HC- |
| Year Built: 1960 | Frame: | Grade: C- | Effective Year: 1975 |
| Primary Wall: Conc Block | Story Height: 1 Story | No. Units: 1 | Secondary Wall: |

Interior Data

| | | | |
|---------------|-------------------|-------------------|------------------------|
| Bedrooms: 2 | A/C %: 0% | Electric: MAXIMUM | Primary Int Wall: |
| Full Baths: 1 | Heated %: 0% | Heat Type: | Avg Hgt/Floor: 0 |
| Half Baths: 0 | Sprinkled %: N/A% | Heat Fuel: | Primary Floors: Carpet |

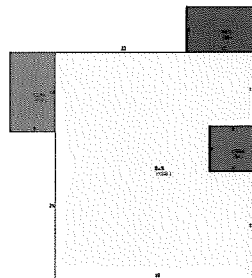

Total Areas

| | |
|--------------------------|-------|
| Finished/Under Air (SF): | 1,336 |
| Gross Area (SF): | 1,608 |
| Land Size (acres): | 0.16 |
| Land Size (SF): | 7,032 |
| Total Building Count: | 1 |

Special Features and Yard Items

| Type | Qty | Units | Year Blt |
|------|-----|-------|----------|
|------|-----|-------|----------|

This information is believed to be correct at this time but it is subject to change and is not warranted.
© Copyright 2017 Saint Lucie County Property Appraiser. All rights reserved.