

**SKETCH OF PARENT TRACT BOUNDARY
DETAIL OF RG TOWERS LEASE PARCEL
NON-EXCLUSIVE ACCESS AND UTILITY EASEMENT
2006 ORANGE AVENUE, FORT PIERCE, FL 34950
ORANGE AVENUE**

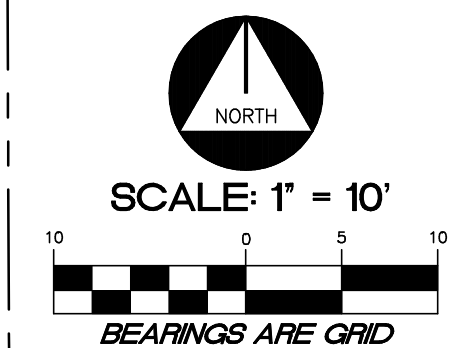

BEARING NOTE

THE BEARINGS SHOWN HEREON ARE GRID NORTH AND RELATIVE TO THE FLORIDA DEPARTMENT OF TRANSPORTATION (FDOT) FLORIDA PERMANENT REFERENCE NETWORK (FPRN) THAT IS RELATIVE TO THE NORTH AMERICAN DATUM OF 1983/2011 (NAD83/2011), AS PROJECTED TO THE FLORIDA STATE PLANE COORDINATE SYSTEM (EAST ZONE).
THE BEARING REFERENCE LINE IS THE NORTH LINE OF BLOCK 3, FLORIANA PARK, PLAT BOOK 2, PAGE 7, SAINT LUCIE COUNTY PUBLIC RECORDS, HAVING A GRID BEARING OF S88°19'00"E.

ORANGE AVENUE

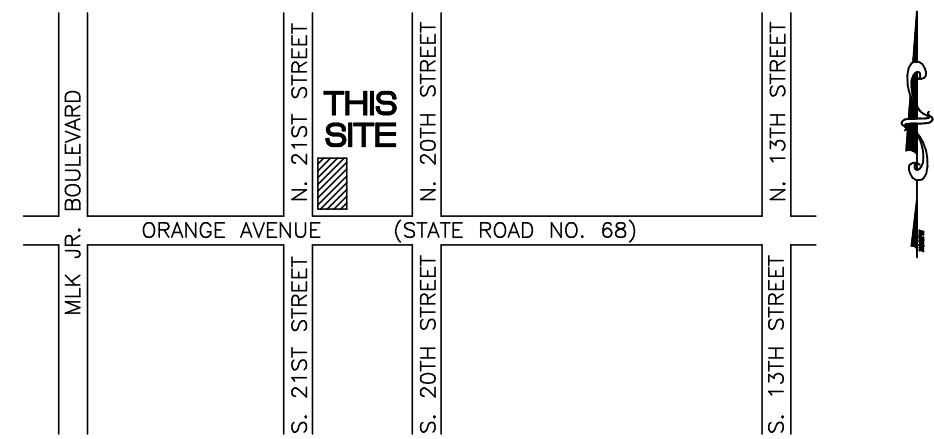

LOCATION SKETCH
SECTION 09-1555-140E
NOT TO SCALE

LEGEND

- | | | | |
|----------|--------------------------|----|-------------------|
| P.O.C. | POINT OF COMMENCEMENT | MM | WATER METER |
| P.O.B. | POINT OF BEGINNING | SM | SANITARY MANHOLE |
| S.L.C.R. | ST. LUCIE COUNTY RECORDS | AW | GUY ANCHOR WIRE |
| R/W | RIGHT-OF-WAY | SC | SANITARY CLEANOUT |
| E/P | EDGE OF PAVEMENT | PH | FIRE HYDRANT |
| O.R. | OFFICIAL RECORD | BL | BOLLARD |
| (P) | PLAT | ES | ELECTRIC SERVICE |
| SPOT | ELEVATION | LP | LAMP POST |
| PT | PINE TREE | EM | ELECTRIC METER |
| HP | HANDICAP PARKING | GM | GAS METER |
| WUP | WOOD UTILITY POLE | ST | STORE SIGN |
| OH | OVERHEAD UTILITY | | |

DESCRIPTION OF PARENT TRACT

(PER OFFICIAL RECORD BOOK 3822, PAGE 1761 OF THE PUBLIC RECORDS OF ST. LUCIE COUNTY, FLORIDA)
LOTS 3, 4 AND 5, LESS THE SOUTH 15 FEET THEREOF, BLOCK 3 OF FLORIANA PARK, ACCORDING TO THE PLAT THEREOF AS RECORDED IN PLAT BOOK 2, PAGE 7C, OF THE PUBLIC RECORDS OF ST. LUCIE COUNTY, FLORIDA.

REPORT OF BOUNDARY AND TOPOGRAPHIC SURVEY

1. THE PARENT TRACT SHOWN HEREON IS BASED ON A SEARCH CONDUCTED BY WSP CONSULTANTS, INC. OF THE PUBLIC RECORDS OF ST. LUCIE COUNTY, FLORIDA. THE REPORT OF TITLE PREPARED BY U.S. TITLE SOLUTIONS, DATED OCTOBER 14, 2017, FILE NO. 58394-FL1710-5030.
2. UNLESS OTHERWISE NOTED HEREON RECORD AND MEASURED VALUES (SHOWN) ARE IN SUBSTANTIAL AGREEMENT.
3. THE PURPOSE OF THIS SURVEY IS TO LOCATE THE EXISTING FEATURES WITHIN THE PARENT TRACT FOR THE FUTURE INSTALLATION OF A COMMUNICATIONS FACILITY.
4. THE EXPECTED USE OF THE SURVEY AND MAP IS FOR THE PREPARATION OF LEASE AGREEMENTS, DESIGN PLANS, PERMITTING SETS AND CONSTRUCTION OF A MONOPOLE TOWER ON THE PARENT TRACT.
5. THIS SURVEY IS CLASSIFIED AS COMMERCIAL/HIGH RISK AND EXCEEDS THE MINIMUM RELATIVE DISTANCE ACCURACY OF 1 FOOT IN 10,000 FEET AS REQUIRED BY THE FLORIDA STANDARDS OF PRACTICE (FS-17.051 THROUGH FS-17.053 F.A.C.). THE ACCURACY OBTAINED BY MEASUREMENT AND CALCULATION OF A CLOSED GEOMETRIC FIGURE WAS FOUND TO EXCEED THIS REQUIREMENT.
6. ALL MEASUREMENTS ARE IN ACCORDANCE WITH THE UNITED STATES STANDARD, IN FEET.
7. THE HORIZONTAL FEATURES SHOWN HEREON ARE PLOTTED TO WITHIN 1/20 OF THE MAP SCALE.
8. HORIZONTAL AND VERTICAL DATA SHOWN HEREON WAS OBTAINED UTILIZING A "LEICA TCPR1205+" TOTAL STATION AND "ALLEGRO MX CARLSON" DATA COLLECTION SYSTEM.
9. ELEVATIONS OF WELL-IDENTIFIED FEATURES CONTAINED IN THIS SURVEY AND MAP HAVE BEEN MEASURED TO AN ESTIMATED VERTICAL ACCURACY OF 0.1'.
10. HORIZONTAL FEATURE LOCATION IS TO THE CENTER OF THE SYMBOL AND MAY BE ENLARGED FOR CLARITY.
11. UNDERGROUND FOUNDATIONS AND/OR UTILITIES HAVE NOT BEEN LOCATED.
12. FLOOD ZONE INFORMATION SHOWN HEREON WAS OBTAINED FROM THE FEDERAL EMERGENCY MANAGEMENT AGENCY (FEMA), FLOOD INSURANCE RATE MAP (FIRM).
13. THE ELEVATIONS SHOWN HEREON ARE BASED ON THE NORTH AMERICAN VERTICAL DATUM OF 1988 (NAVD 88) AND ARE REFERENCED TO THE FLORIDA DEPARTMENT OF TRANSPORTATION (FDOT) FLORIDA PERMANENT REFERENCE NETWORK (FPRN). THE MEASUREMENTS WERE OBTAINED UTILIZING A "HEMISPHERE S320 GNSS" RTK GPS RECEIVER.
14. THE VALUES FOR THE LATITUDE, LONGITUDE AND ELEVATIONS SHOWN HEREON ARE WITHIN THE ALLOWABLE TOLERANCES FOR THE FEDERAL AVIATION ADMINISTRATION 1-A LETTER.
15. THE LATITUDE AND LONGITUDE SHOWN HEREON WERE OBTAINED UTILIZING THE FLORIDA DEPARTMENT OF TRANSPORTATION (FDOT) FLORIDA PERMANENT REFERENCE NETWORK (FPRN) THAT IS RELATIVE TO THE NORTH AMERICAN DATUM OF 1983/2011 (NAD83/2011), AS PROJECTED TO THE FLORIDA STATE PLANE COORDINATE SYSTEM (EAST ZONE). THE MEASUREMENTS WERE OBTAINED UTILIZING A "HEMISPHERE S320 GNSS" RTK GPS RECEIVER.
16. THE RG TOWERS LEASE PARCEL SHOWN IN THIS SURVEY LIES ENTIRELY WITHIN THE DESCRIBED PARENT TRACT.
17. THE SURVEYOR HAS REVIEWED THE REPORT OF TITLE PREPARED BY U.S. TITLE SOLUTIONS, DATED OCTOBER 14, 2017, FILE NO. 58394-FL1710-5030. ALL PLOTTABLE MATTERS OF RECORD IDENTIFIED IN THE REPORT OF TITLE THAT ARE PERTINENT TO THE RG TOWERS LEASE PARCEL AND ITS ACCESS AND UTILITY EASEMENT, IF APPLICABLE, HAVE BEEN SHOWN OR NOTED ON THIS SURVEY. THE SURVEYOR RELIED SOLELY UPON THAT REPORT OF TITLE WITH RESPECT TO EASEMENTS, RIGHTS-OF-WAY, SETBACK LINES AGREEMENTS, RESERVATIONS AND OTHER SIMILAR MATTERS.
18. BASED UPON THE REPORT OF TITLE, THE RG TOWERS LEASE PARCEL HAS ACCESS TO N. 21ST STREET, A PUBLIC RIGHT-OF-WAY, BY MEANS OF THE ACCESS AND UTILITY EASEMENT DEPICTED HEREON. THE EASEMENT LIES ENTIRELY WITHIN THE LANDS OF THE OWNER(S) OF THE PARCEL DESCRIBED IN SAID REPORT OF TITLE AND NO EASEMENTS OR RIGHTS OF OTHER THIRD PARTIES DISCLOSED BY THAT REPORT OF TITLE WOULD PRECLUDE ACCESS OVER THE PARENT TRACT FROM THE RG TOWERS LEASE PARCEL TO THAT PUBLIC RIGHT-OF-WAY.
19. ADDITIONS OR DELETIONS TO SURVEY MAPS OR REPORTS BY OTHER THAN THE SIGNING PARTY OR PARTIES IS PROHIBITED WITHOUT WRITTEN CONSENT OF THE SIGNING PARTY OR PARTIES.
20. SURVEY DATE: FIELD SURVEY WAS COMPLETED OCTOBER 10, 2017, WHICH IS THE DATE OF DATA ACQUISITION.

CERTIFICATE

I, WILLIAM S. PAYNE, DO HEREBY STATE THAT THIS MAP OF BOUNDARY AND TOPOGRAPHIC SURVEY WAS PERFORMED UNDER MY DIRECT SUPERVISION AND IS ACCURATE AND CORRECT TO THE BEST OF MY KNOWLEDGE AND BELIEF. I FURTHER STATE THAT THIS MAP OF BOUNDARY AND TOPOGRAPHIC SURVEY WAS COMPLETED IN ACCORDANCE WITH THE STANDARDS OF PRACTICE FOR SURVEYING AND MAPPING STATED IN RULES 5J-17.051 THROUGH 5J-17.053 OF THE FLORIDA ADMINISTRATIVE CODE, PURSUANT TO FLORIDA STATUTES CHAPTER 472.027.

W.S. Payne
WILLIAM S. PAYNE
PROFESSIONAL SURVEYOR AND MAPPER #LS 5685
WSP CONSULTANTS, INC. #LB 7188
STATE OF FLORIDA

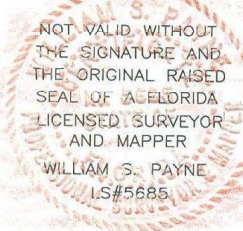

MAP OF BOUNDARY AND TOPOGRAPHIC SURVEY

ORANGE AVENUE
PREPARED FOR:
RG Towers, LLC
LOCATED IN:
ST. LUCIE COUNTY, FLORIDA

PROJECT NO:
17-1404
SHEET NO:
1 OF 2

BLOCK 8
BLOCK 4
FLORIANA PARK
PLAT BOOK 2, PAGE 7C, S.L.C.R.

**150' MONOPOLE
PROPOSED TOWER INFORMATION**

LATITUDE = 27°26'51.584" NORTH
LONGITUDE = 080°20'45.150" WEST
NORTH AMERICAN DATUM OF 1983/2011 NAD 83(2011)
EXISTING AVERAGE GROUND ELEVATION AT TOWER = 19.8 FEET
NORTH AMERICAN VERTICAL DATUM OF 1988 (NAVD 88)

SEE SHEET 2 OF 2 FOR DESCRIPTION OF
RG TOWERS LEASE PARCEL
NON-EXCLUSIVE ACCESS AND UTILITY EASEMENT
SEE SHEET 2 OF 2 FOR REVIEW OF TITLE SEARCH REPORT

FLOOD ZONE INFORMATION				
COMMUNITY NUMBER	PANEL NUMBER	SUFFIX	DATE OF FIRM	FIRM ZONE
120286	0178	J	02/16/2012	X
				N/A

FIELD SURVEY DATE: 10/10/2017				
DRAWN: WSP				
CHECKED: WSP				
MANAGER: WSP	1	01/23/2018	REVISE SURVEY TO ADDRESS ST. LUCIE COUNTY SURVEYOR COMMENTS	
DWG FILE: 17-1404.DWG	No.	DATE		REVISION

WSP Consultants, Inc.
SURVEYORS & MAPPERS
18815 ANNELIS DRIVE, LUTZ, FL 33548
PHONE (813) 909-2420
PROFESSIONAL SURVEYING & MAPPING CERTIFICATE OF AUTHORIZATION:
LB 7188, STATE OF FLORIDA

WSP
BY

ORANGE AVENUE

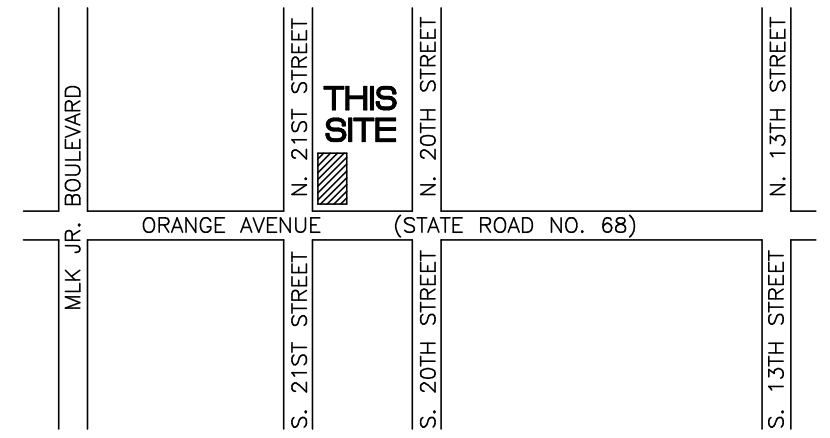

LOCATION SKETCH
SECTION 09-1555-140E
NOT TO SCALE

150' MONOPOLE PROPOSED TOWER INFORMATION
LATITUDE = 27°26'51.584" NORTH
LONGITUDE = 080°20'45.150" WEST
NORTH AMERICAN DATUM OF 1983/2011 NAD 83/2011)
EXISTING AVERAGE GROUND ELEVATION AT TOWER = 19.8 FEET
NORTH AMERICAN VERTICAL DATUM OF 1988 (NAVD 88)

DESCRIPTION OF RG TOWERS LEASE PARCEL

A PARCEL OF LAND BEING A PORTION OF LOT 5, BLOCK 3, FLORIANA PARK, AS RECORDED IN PLAT BOOK 2, PAGE 7C OF THE PUBLIC RECORDS OF ST. LUCIE COUNTY, FLORIDA, SAID PARCEL BEING MORE PARTICULARLY DESCRIBED AS FOLLOWS:

COMMENCE AT THE NORTHWEST CORNER OF SAID LOT 5, BLOCK 3;

THENCE ON A GRID BEARING OF S88°19'00"E ALONG THE NORTH LINE OF LOT 5, BLOCK 3, A DISTANCE OF 19.52 FEET;

THENCE S01°41'00"W A DISTANCE OF 15.00 FEET TO A POINT ON A LINE 15.00 FEET SOUTH OF AND PARALLEL WITH THE NORTH LINE OF SAID LOT 5, BLOCK 3, SAID POINT ALSO BEING THE POINT OF BEGINNING;

THENCE S88°19'00"E ALONG SAID PARALLEL LINE, A DISTANCE OF 25.01 FEET;

THENCE S00°16'00"E A DISTANCE OF 79.98 FEET TO A POINT ON A LINE 25.00 FEET NORTH OF AND PARALLEL WITH THE NORTH RIGHT-OF-WAY LINE OF ORANGE AVENUE (80 FOOT PUBLIC RIGHT-OF-WAY);

THENCE N88°19'00"W ALONG SAID PARALLEL LINE, A DISTANCE OF 25.01 FEET TO A POINT ON A LINE 19.00 FEET EAST OF AND PARALLEL WITH THE WEST LINE OF SAID LOT 5, BLOCK 3;

THENCE N00°16'00"W ALONG SAID PARALLEL LINE, A DISTANCE OF 79.98 FEET TO THE POINT OF BEGINNING;

SAID PARCEL OF LAND SITUATE WITHIN ST. LUCIE COUNTY, FLORIDA CONTAINING 1,999.47 SQUARE FEET MORE OR LESS.

DESCRIPTION OF NON-EXCLUSIVE ACCESS AND UTILITY EASEMENT

A PARCEL OF LAND BEING A PORTION OF LOT 5, BLOCK 3, FLORIANA PARK, AS RECORDED IN PLAT BOOK 2, PAGE 7C OF THE PUBLIC RECORDS OF ST. LUCIE COUNTY, FLORIDA, SAID PARCEL BEING MORE PARTICULARLY DESCRIBED AS FOLLOWS:

COMMENCE AT THE NORTHWEST CORNER OF SAID LOT 5, BLOCK 3;

THENCE ON A GRID BEARING OF S88°19'00"E ALONG THE NORTH LINE OF LOT 5, BLOCK 3, A DISTANCE OF 19.52 FEET;

THENCE S01°41'00"W A DISTANCE OF 15.00 FEET TO A POINT ON A LINE 15.00 FEET SOUTH OF AND PARALLEL WITH THE NORTH LINE OF SAID LOT 5, BLOCK 3;

THENCE S88°19'00"E ALONG SAID PARALLEL LINE, A DISTANCE OF 25.01 FEET;

THENCE S00°16'00"E A DISTANCE OF 79.98 FEET TO A POINT ON A LINE 25.00 FEET NORTH OF AND PARALLEL WITH THE NORTH RIGHT-OF-WAY LINE OF ORANGE AVENUE (80 FOOT PUBLIC RIGHT-OF-WAY);

THENCE N88°19'00"W ALONG SAID PARALLEL LINE, A DISTANCE OF 25.01 FEET TO A POINT ON A LINE 19.00 FEET EAST OF AND PARALLEL WITH THE WEST LINE OF SAID LOT 5, BLOCK 3;

THENCE N00°16'00"W ALONG SAID PARALLEL LINE, A DISTANCE OF 29.99 FEET TO THE POINT OF BEGINNING;

THENCE S89°44'00"W A DISTANCE OF 19.00 FEET TO A POINT ON THE WEST LINE OF SAID LOT 5, BLOCK 3, SAID POINT ALSO BEING ON THE EAST RIGHT-OF-WAY LINE OF NORTH 21ST STREET (60 FOOT PUBLIC RIGHT-OF-WAY);

THENCE N00°16'00"W ALONG SAID WEST LINE AND EAST RIGHT-OF-WAY LINE, A DISTANCE OF 20.00 FEET;

THENCE N89°44'00"E A DISTANCE OF 19.00 FEET;

THENCE S00°16'00"E A DISTANCE OF 20.00 FEET TO THE POINT OF BEGINNING;

SAID PARCEL OF LAND SITUATE WITHIN ST. LUCIE COUNTY, FLORIDA CONTAINING 380.00 SQUARE FEET MORE OR LESS.

REVIEW OF TITLE SEARCH REPORT

I HAVE REVIEWED THE REPORT OF TITLE PREPARED BY U.S. TITLE SOLUTIONS, DATED OCTOBER 14, 2017, FILE NO. 58394-FL1710-5030, AND FIND AS FOLLOWS WITH RESPECT TO MATTERS OF RECORDS LISTED IN SAID REPORT.

1. TAXES, TAX LIENS, TAX SALES, WATER RATES, SEWER AND ASSESSMENTS SET FORTH IN SCHEDULE HEREIN.
2. MORTGAGES RETURNED HEREIN. (-3-). SEE SEPARATE MORTGAGE SCHEDULE.
3. ANY STATE OF FACTS WHICH AN ACCURATE SURVEY MIGHT SHOW OR SURVEY EXCEPTIONS SET FORTH HEREIN.
4. RIGHTS OF TENANTS OR PERSON IN POSSESSION.

(JUDGMENTS, LIENS AND UCC)
5. NONE WITHIN PERIOD SEARCHED

(COVENANTS/RESTRICTIONS)
6. NONE WITHIN PERIOD SEARCHED

(EASEMENTS AND RIGHTS OF WAY)
7. NONE WITHIN PERIOD SEARCHED

(OTHER FILED DOCUMENTS)
8. PLAT OF FORT PIERCE FARMS IN BOOK 2, PAGE 7-A.

- PARENT TRACT DOES NOT LIE WITHIN SAID PLAT.

9. PLAT OF OAKLAND PARK IN BOOK 2, PAGE 7-B.

- PARENT TRACT DOES NOT LIE WITHIN SAID PLAT.

10. PLAT OF FLORIANA PARK IN BOOK 2, PAGE 7-C.

- BLANKET IN NATURE - PARENT TRACT LIES COMPLETELY WITHIN SAID PLAT.

- THERE ARE NO EASEMENTS, RESTRICTIONS AND / OR SETBACKS DEPICTED ON SAID PLAT, NOTHING TO PLOT.

11. CERTIFICATION OF TRUST BETWEEN JOHN C. WALKER TRUST DATED JULY 26, 1994 AND JOHN C. WALKER, TRUSTEE OF THE JOHN C. WALKER TRUST DATED JULY 26, 1994 DATED 12/24/2015 RECORDED 12/31/2015 IN BOOK 3822, PAGE 1764.

- BLANKET IN NATURE - DESCRIBES PARENT TRACT.

- SAID TRUST IS NO LONGER THE OWNER OF THE PARENT TRACT.

12. MEMORANDUM OF WIRELESS COMMUNICATIONS FACILITY LEASE BETWEEN LESLEY PHILLIPS & ABDEL JEDBAR ELBAKARRI, A MARRIED COUPLE AND RG TOWERS, LLC, A DELAWARE LIMITED LIABILITY COMPANY DATED 9/27/2017 RECORDED 10/2/2017 IN BOOK 4047, PAGE 36.

- BLANKET IN NATURE - DESCRIBES PARENT TRACT.

SEE SHEET 1 OF 2 FOR DETAIL OF
RG TOWERS LEASE PARCEL
NON-EXCLUSIVE ACCESS AND UTILITY EASEMENT

FLOOD ZONE INFORMATION					
COMMUNITY NUMBER	PANEL NUMBER	SUFFIX	DATE OF FIRM	FIRM ZONE	BASE FLOOD ELEVATION
120286	0178	J	02/16/2012	X	N/A

FIELD SURVEY DATE:	10/10/2017								
DRAWN:	WSP								
CHECKED:	WSP								
MANAGER:	WSP	1	01/23/2018	REVISE SURVEY TO ADDRESS ST. LUCIE COUNTY SURVEYOR COMMENTS					WSP
DWG FILE:	17-1404.DWG	No.	DATE						BY

WSP Consultants, Inc.
SURVEYORS & MAPPERS
18815 ANNELIS DRIVE, LUTZ, FL 33548
PHONE (813) 909-2420
PROFESSIONAL SURVEYING & MAPPING CERTIFICATE OF AUTHORIZATION:
LB 7188, STATE OF FLORIDA

MAP OF BOUNDARY AND TOPOGRAPHIC SURVEY
ORANGE AVENUE
PREPARED FOR:
RG Towers, LLC
LOCATED IN:
ST. LUCIE COUNTY, FLORIDA

PROJECT NO:
17-1404
SHEET NO:
2 OF 2