

Michelle Franklin, CFA -- Saint Lucie County Property Appraiser -- All rights reserved.

**Property Identification**

Site Address: 426 N 10th ST Parcel ID: 2410-601-0007- Account #: 23150 Sec/Town/Range:  
 1230 Avenue I 000-9 10/35S/40E  
 Map ID: 24/10N Zoning: R4 Use Type: 0800 Jurisdiction: Fort Pierce

**Ownership**

Leroy Chavis (EST)  
 1230 Avenue I  
 Fort Pierce, FL 34950

**Legal Description**

FEE AND MAY'S RE-S/D BLK A LOT 7-LESS W 40 FT  
 FOR ST R/W- (MAP 24/10C) (OR 695-1012)

**Current Values**

Just/Market: \$18,900 Assessed: \$13,714  
 Exemptions: \$0 Taxable: \$13,714

**Historical Values 3-year**

Year	Just/Market	Assessed	Exemptions	Taxable
2017	\$18,900	\$13,714	\$0	\$13,714
2016	\$14,000	\$12,468	\$0	\$12,468
2015	\$10,100	\$10,100	\$5,247	\$4,853

**Sale History**

Date	Book/Page	Sale Code	Deed	Grantor	Price
06-04-1990	0695 / 1012	XX01	QC	Arthur Chavis	\$100
11-01-1978	0298 / 0333	XX01	CV		\$0
12-01-1976	0260 / 2912	XX01	CV		\$0

**Primary Building Information**

Finished Area of this building: 720 SF  
 Gross Area of this building: 864 SF

**Exterior Data**

View: Roof Cover: Sheet Metal Roof Structure: Hip Building Type: MFH  
 Year Built: 1926 Frame: Grade: MFFQ Effective Year: 1950  
 Primary Wall: Frm Stucco Story Height: 1 Story No. Units: 3 Secondary Wall:

**Interior Data**

Bedrooms: 0 A/C %: 0% Electric: AVERAGE Primary Int Wall:  
 Full Baths: 1 Heated %: 0% Heat Type: Avg Hgt/Floor: 0  
 Half Baths: 0 Sprinkled %: 0% Heat Fuel: Primary Floors: Double Pine

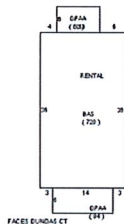

**Total Areas**

Finished/Under Air (SF):	2,006
Gross Area (SF):	2,368
Land Size (acres):	0.14
Land Size (SF):	6,250
Total Building Count:	3

**Special Features and Yard Items**

Type Qty Units Year Blt

This information is believed to be correct at this time but it is subject to change and is not warranted.  
 © Copyright 2017 Saint Lucie County Property Appraiser. All rights reserved.