

Michelle Franklin, CFA -- Saint Lucie County Property Appraiser -- All rights reserved.

Rtqrgrtv{ #f g p v h e c v i q p

Site Address: 513 N 13th ST Parcel ID: 2409-502-0006- Account #: 21284 Sec/Town/Range:
 000-4 Use Type: 0100 09/35S/40E
 Map ID: 24/09N Zoning: R4 Jurisdiction: Fort Pierce

Q y p g t u j k r Ngicr# g u e t k r v k p
 TTLREO 2 LLC CLYDE KILLER'S A/D BLK 1 LOT 5 (OR 4073-2618)
 4747 Executive DR Ste 510
 San Diego, CA 92121-3100

Fwttg p v # k c n w g u K k u v t l e c r # k c n w g u # 0 { g c t

Just/Market:	Assessed:	Year	Just/Market	Assessed	Exemptions	Taxable
\$35,000	\$35,000	2017	\$35,000	\$35,000	\$0	\$35,000
Exemptions: \$0	Taxable: \$35,000	2016	\$32,800	\$32,800	\$0	\$32,800
		2015	\$38,900	\$38,900	\$0	\$38,900

U c r g # k k u v t {

Date	Book/Page	Sale Code	Deed	Grantor	Price
12-07-2017	4073 / 2618	0111	TD	Smith (EST) Annie L	\$0
03-14-2006	2515 / 2679	XX00	WD	Eames , Timothy	\$124,000
05-13-2005	2247 / 2909	XX01	QC	Clark, Alan	\$75,000

R t o c t { # e w k f p i # p h t o c v i q p

Finished Area of this building: 1,246 SF
 Gross Area of this building: 1,618 SF

Exterior Data

View: Roof Cover: Tar & Gravel Roof Structure: Flat/Shed Building Type: HC-
 Year Built: 1956 Frame: Grade: C- Effective Year: 1956
 Primary Wall: Conc Block Story Height: 1 Story No. Units: 1 Secondary Wall:

Interior Data

Bedrooms: 2 A/C %: 100% Electric: MAXIMUM Primary Int Wall:
 Full Baths: 2 Heated %: 100% Heat Type: FredHotAir Avg Hgt/Floor: 0
 Half Baths: 0 Sprinkled %: N/A% Heat Fuel: ELEC Primary Floors: Double Pine

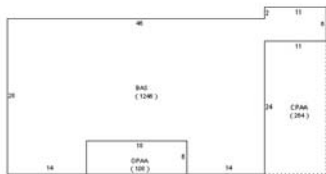

V q v e r # t g c u

Finished/Under Air (SF):	1,246
Gross Area (SF):	1,618
Land Size (acres):	0.17
Land Size (SF):	7,500
Total Building Count:	1

U r g e k r # g c w t g u # p f # c t f # v g o u

Type Qty Units Year Blt

This information is believed to be correct at this time but it is subject to change and is not warranted.
 © Copyright 2018 Saint Lucie County Property Appraiser. All rights reserved.