

Michelle Franklin, CFA -- Saint Lucie County Property Appraiser -- All rights reserved.

Property Identification

Site Address: 1700 N 16th ST
 Map ID: 24/04N
 Parcel ID: 2404-512-0017-000-0
 Zoning: R3
 Account #: 16408
 Use Type: 0100
 Sec/Town/Range: 04/35S/40E
 Jurisdiction: Fort Pierce

Ownership

Vincent T Benjamin
 239 W 63rd St #6-C
 New York, NY 10023

Legal Description

IRENE PLAZA BLK 2 LOTS 6 AND 7 (OR 3070-563)

Current Values

Just/Market: \$13,300
 Exemptions: \$0
 Assessed: \$7,920
 Taxable: \$7,920

Historical Values 3-year

Year	Just/Market	Assessed	Exemptions	Taxable
2017	\$13,300	\$7,920	\$0	\$7,920
2016	\$7,200	\$7,200	\$0	\$7,200
2015	\$7,100	\$7,100	\$0	\$7,100

Sale History

Date	Book/Page	Sale Code	Deed	Grantor	Price
02-27-2009	3070 / 0563	0001	WD	Dixon,Thelma L	\$36,000
01-01-1900					\$0

Primary Building Information

Finished Area of this building: 2,527 SF
 Gross Area of this building: 2,921 SF

Exterior Data

View: Roof Cover: Dim Shingle Roof Structure: Hip Building Type: HD+
 Year Built: 1940 Frame: Grade: D+ Effective Year: 1940
 Primary Wall: Frm Stucco Story Height: 1 Story No. Units: 1 Secondary Wall:

Interior Data

Bedrooms: 0 A/C %: 100% Electric: MAXIMUM Primary Int Wall:
 Full Baths: 2 Heated %: 100% Heat Type: FrdHotAir Avg Hgt/Floor: 0
 Half Baths: 0 Sprinkled %: N/A% Heat Fuel: ELEC Primary Floors: Carpet

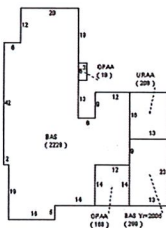

Total Areas

Finished/Under Air (SF):	2,527
Gross Area (SF):	2,921
Land Size (acres):	0.29
Land Size (SF):	12,650
Total Building Count:	1

Special Features and Yard Items

Type	Qty	Units	Year Blt
Driv-Concret	1	325	1940
CHAINLINK 4'	1	180	1992

This information is believed to be correct at this time but it is subject to change and is not warranted.
 © Copyright 2018 Saint Lucie County Property Appraiser. All rights reserved.