

Sheet Legend

- Sheet L-1 Cover Sheet
- Sheet L-2 Landscape Plan
- Sheet L-3 Landscape Plan
- Sheet L-4 Landscape Plan
- Sheet L-5 Landscape Plan
- Sheet L-6 Landscape Plan
- Sheet L-7 Landscape Plan
- Sheet L-8 Landscape Data, Plant List, Details & Specifications

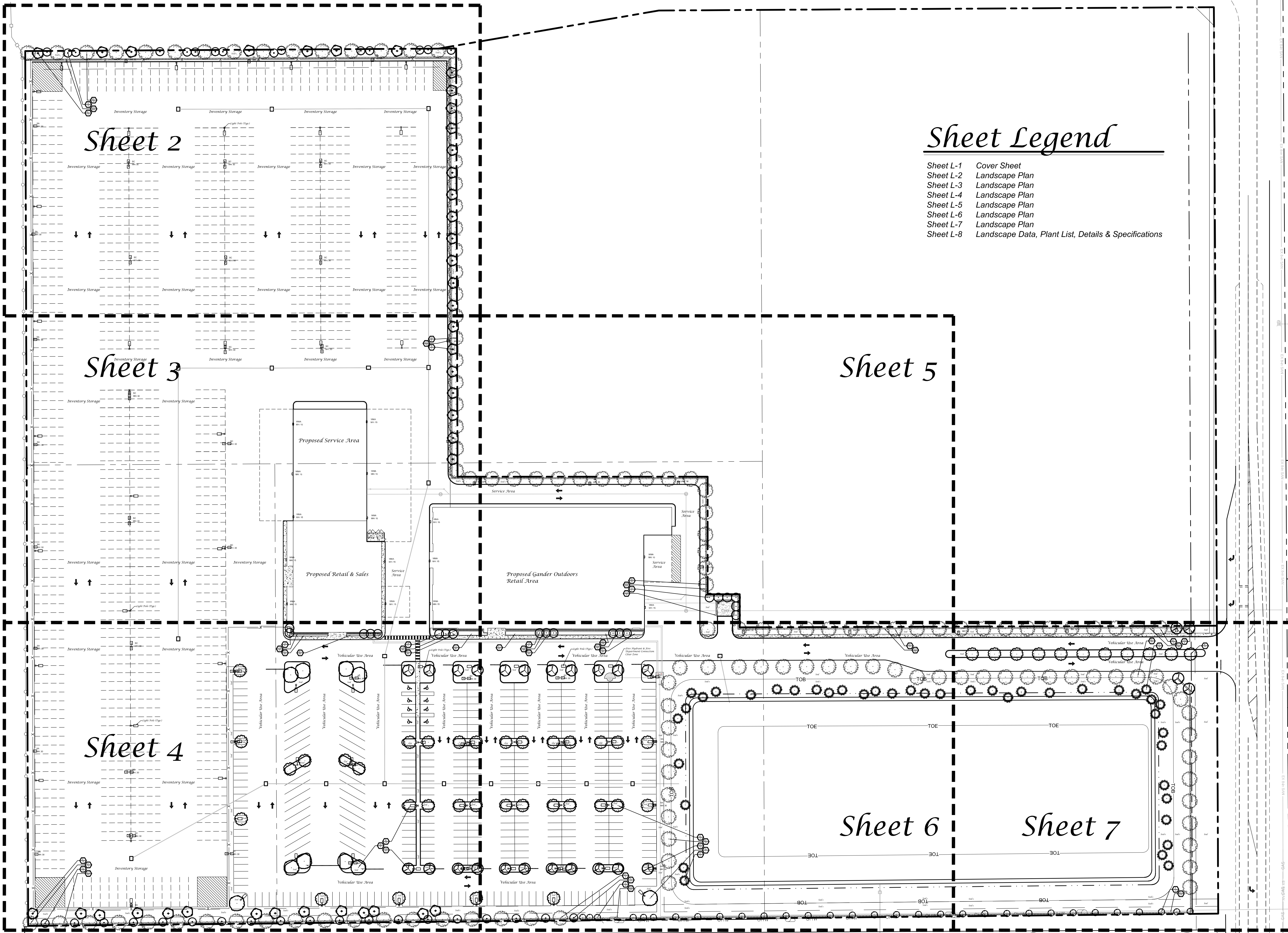

Camping World

South Jenkins Road
City of Fort Pierce, Florida

City Project Number:
18-0700003

Jeffrey W. Smith, RLA
Florida Registration Number:
LA 0001635

Job No. 18-0305
Drawn By JWS
Submission Dates 3-19-2018
4-27-2018

Revision Dates
4/18 City Comments 4-27-2018

These drawings are the property of the landscape architect and are not to be used for other projects except by written permission from the landscape architect. Report any discrepancies immediately to the landscape architect.

L-1 8
Sheet of

Landscape Plan

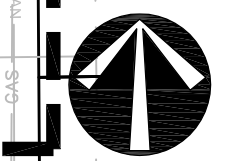

North
Scale: 1" = 60'

0 30' 60' 120'

Camping World

South Jenkins Road
City of Fort Pierce, Florida

City Project Number:
18-07000003

Jeffrey W. Smith, RLA
Florida Registration Number:
LA 0001635

Job No. 18-0305
Drawn By JWS
Submission Dates 3-19-2018
4-27-2018

Revision Dates
4/18 City Comments 4-27-2018

These drawings are the property of the
landscape architect and are not to be
used for other projects except by written
permission from the landscape architect.
Report any discrepancies immediately
to the landscape architect.

L-2 8
Sheet of

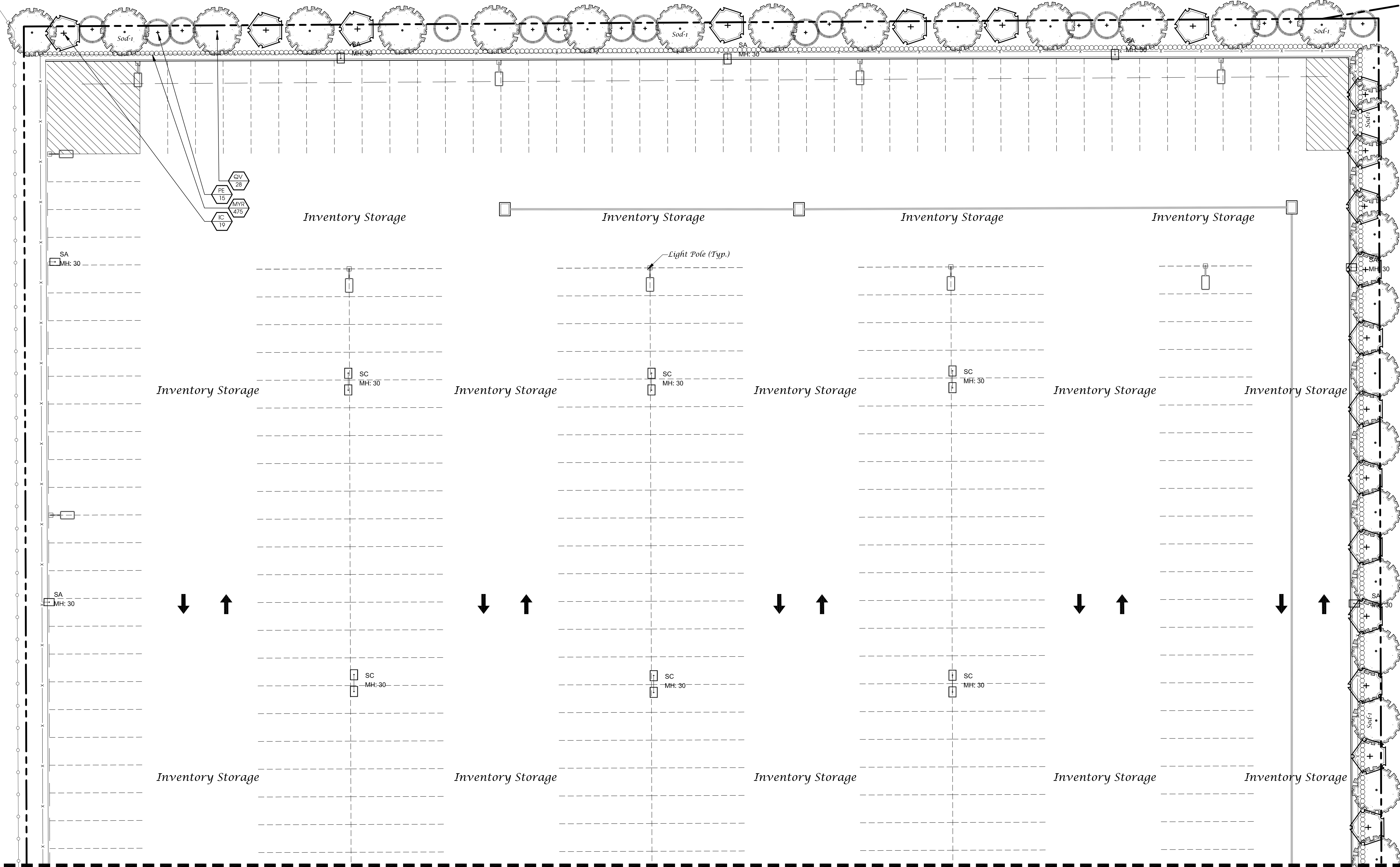

Match Line - See Sheet L-3

Landscape Plan

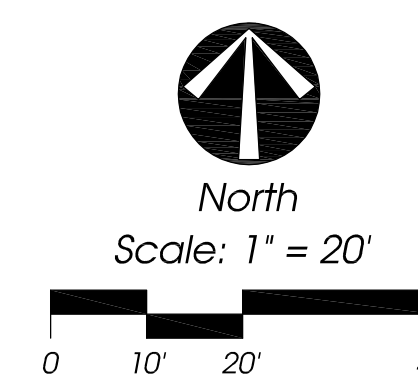

Match Line - See Sheet L-2

Conceptual Design Group, Inc.

Landscape Architecture - Site Planning

900 East Ocean Boulevard, Suite 1304
Stuart, Florida 34994
(772) 344-2340
L.C. 26000198

Camping World

South Jenkins Road
City of Fort Pierce, Florida

City Project Number:
18-07000003

Jeffrey W. Smith, RLA
Florida Registration Number:
LA 0001635

Job No. 18-0305
Drawn By JWS
Submittal Dates 3-19-2018
4-27-2018

Revision Dates
4/18 City Comments 4-27-2018

These drawings are the property of the landscape architect and are not to be used for other projects except by written permission from the landscape architect. Report any discrepancies immediately to the landscape architect.

L-3 8
Sheet of

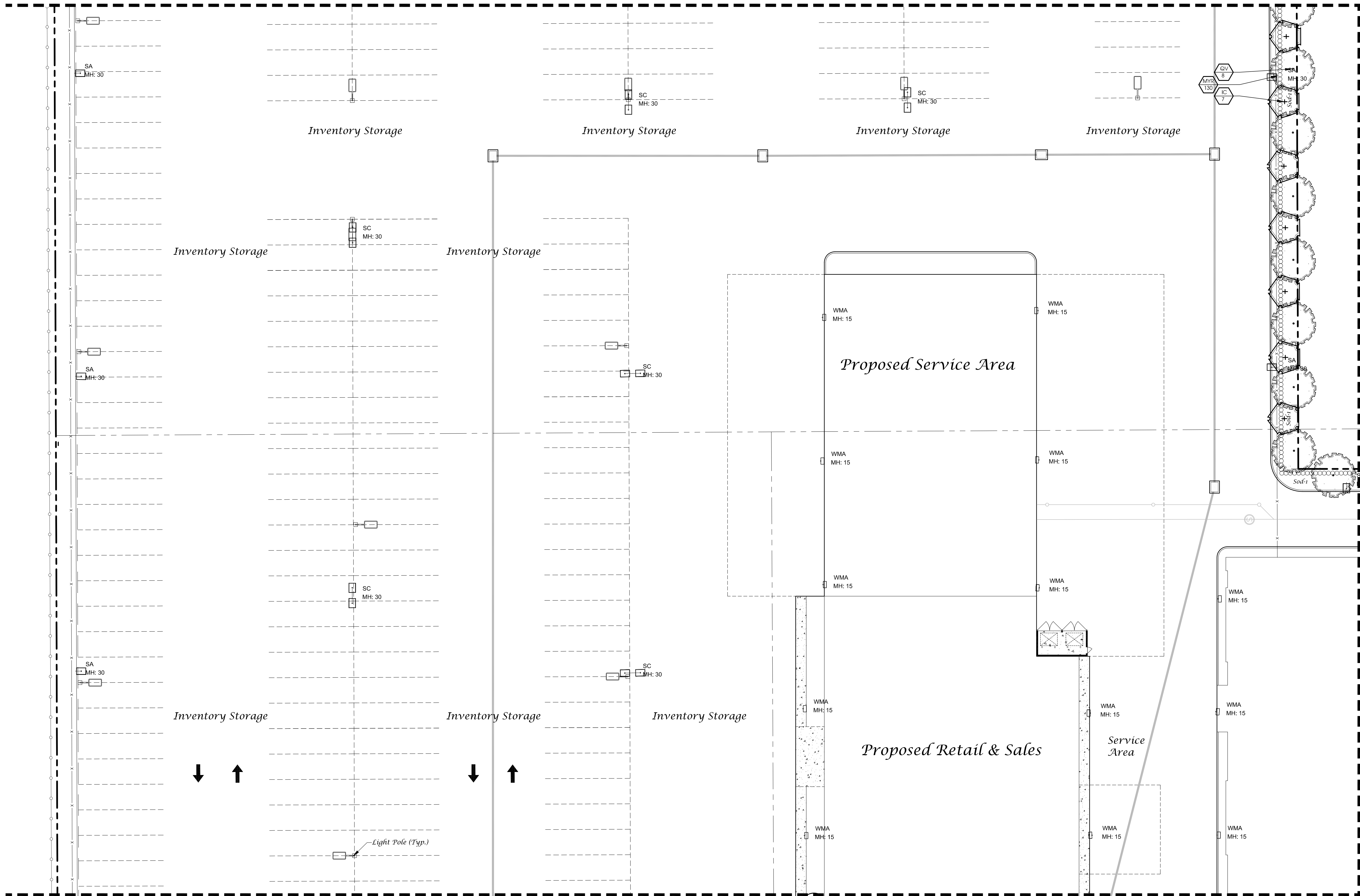

Match Line - See Sheet L-4

Match Line - See Sheet L-5

Landscape Plan

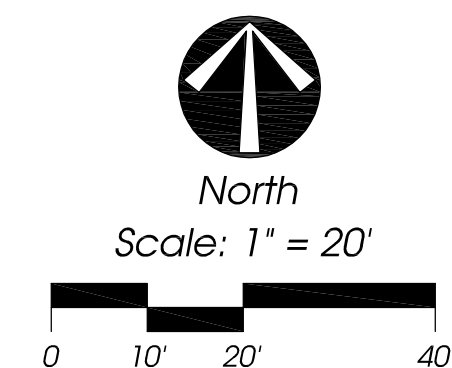

Match Line - See Sheet L-3

Conceptual Design Group, Inc.
 Landscape Architecture - Site Planning
 900 East Ocean Boulevard, Suite 1304
 Stuart, Florida 34994
 (772) 344-2340
 LC: 26000198

Camping World
 South Jenkins Road
 City of Fort Pierce, Florida

City Project Number: 18-07000003

Jeffrey W. Smith, RLA
 Florida Registration Number: LA 0001635

Job No. 18-0305
 Drawn By JWS
 Submittal Dates 3-19-2018
 4-27-2018

Revision Dates
 4/18 City Comments 4-27-2018

These drawings are the property of the landscape architect and are not to be used for other projects except by written permission from the landscape architect. Report any discrepancies immediately to the landscape architect.

L-4 8
 Sheet of

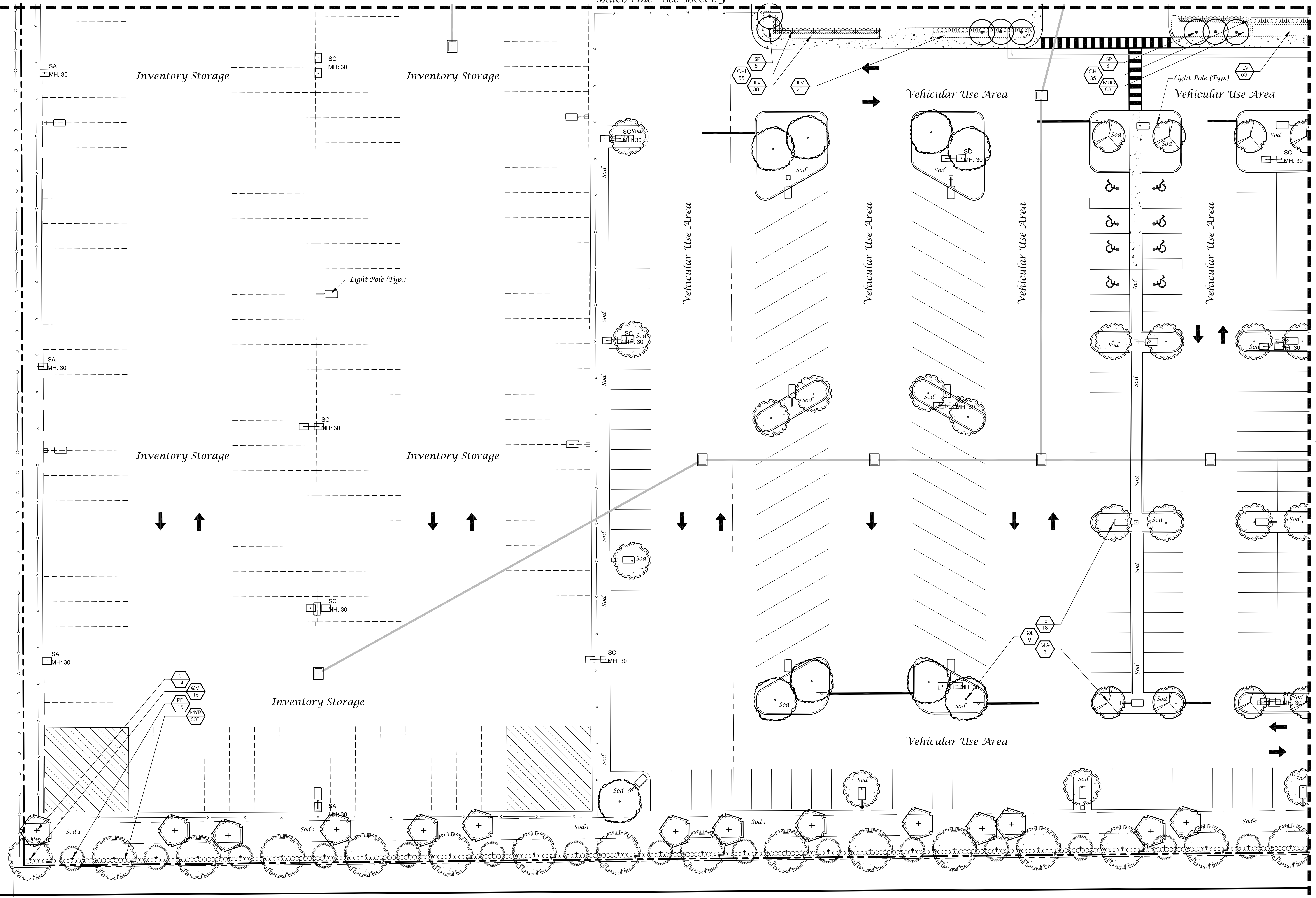

Landscape Plan

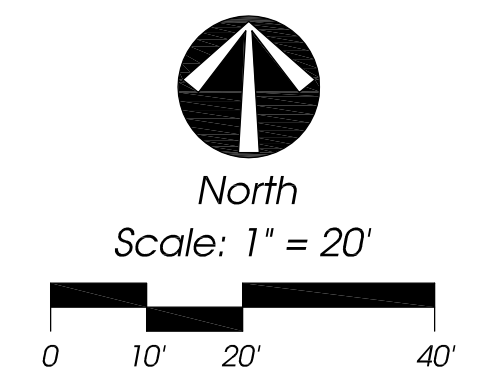

Camping World

South Jenkins Road
City of Fort Pierce, Florida

City Project Number:
18-07000003

Jeffrey W. Smith, RLA
Florida Registration Number:
LA 0001635

Job No. 18-0305
Drawn By JWS
Submittal Dates 3-19-2018
4-27-2018

Revision Dates
4/18 City Comments 4-27-2018

These drawings are the property of the landscape architect and are not to be used for other projects except by written permission from the landscape architect. Report any discrepancies immediately to the landscape architect.

L-5 of 8
Sheet of

Landscape Plan

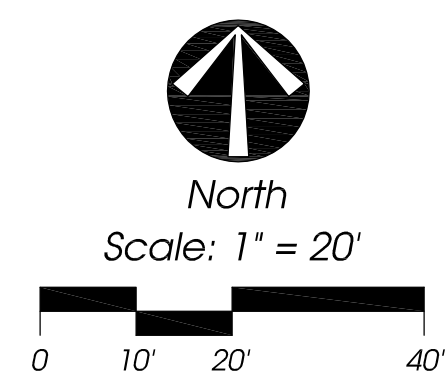

Match Line - See Sheet L-3

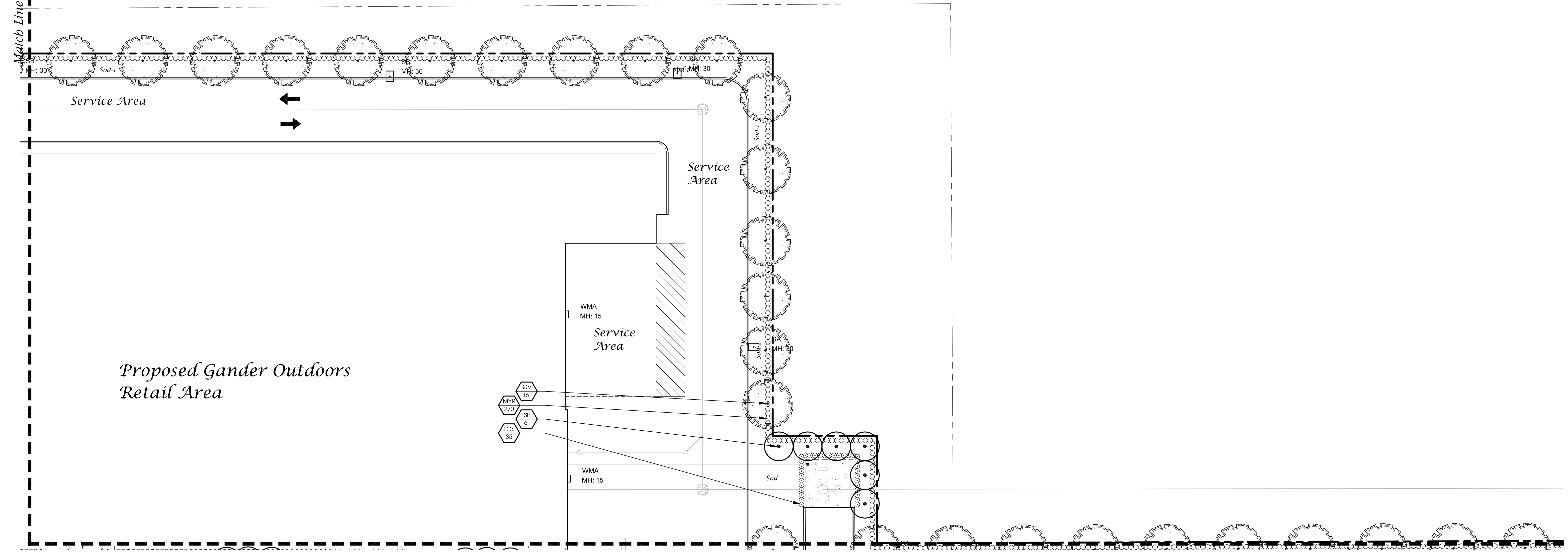

Match Line - See Sheet L-6

Camping World

South Jenkins Road
 City of Fort Pierce, Florida

City Project Number:
 18-07000003

Jeffrey W. Smith, RLA
 Florida Registration Number:
 LA 0001635

Job No. 18-0305
 Drawn By JWS
 Submittal Dates 3-19-2018
 4-27-2018

Revision Dates
 4/18 City Comments 4-27-2018

These drawings are the property of the landscape architect and are not to be used for other projects except by written permission from the landscape architect. Report any discrepancies immediately to the landscape architect.

L-6 8
 Sheet of

Match Line - See Sheet L-5

Match Line - See Sheet L-4

Match Line - See Sheet L-7

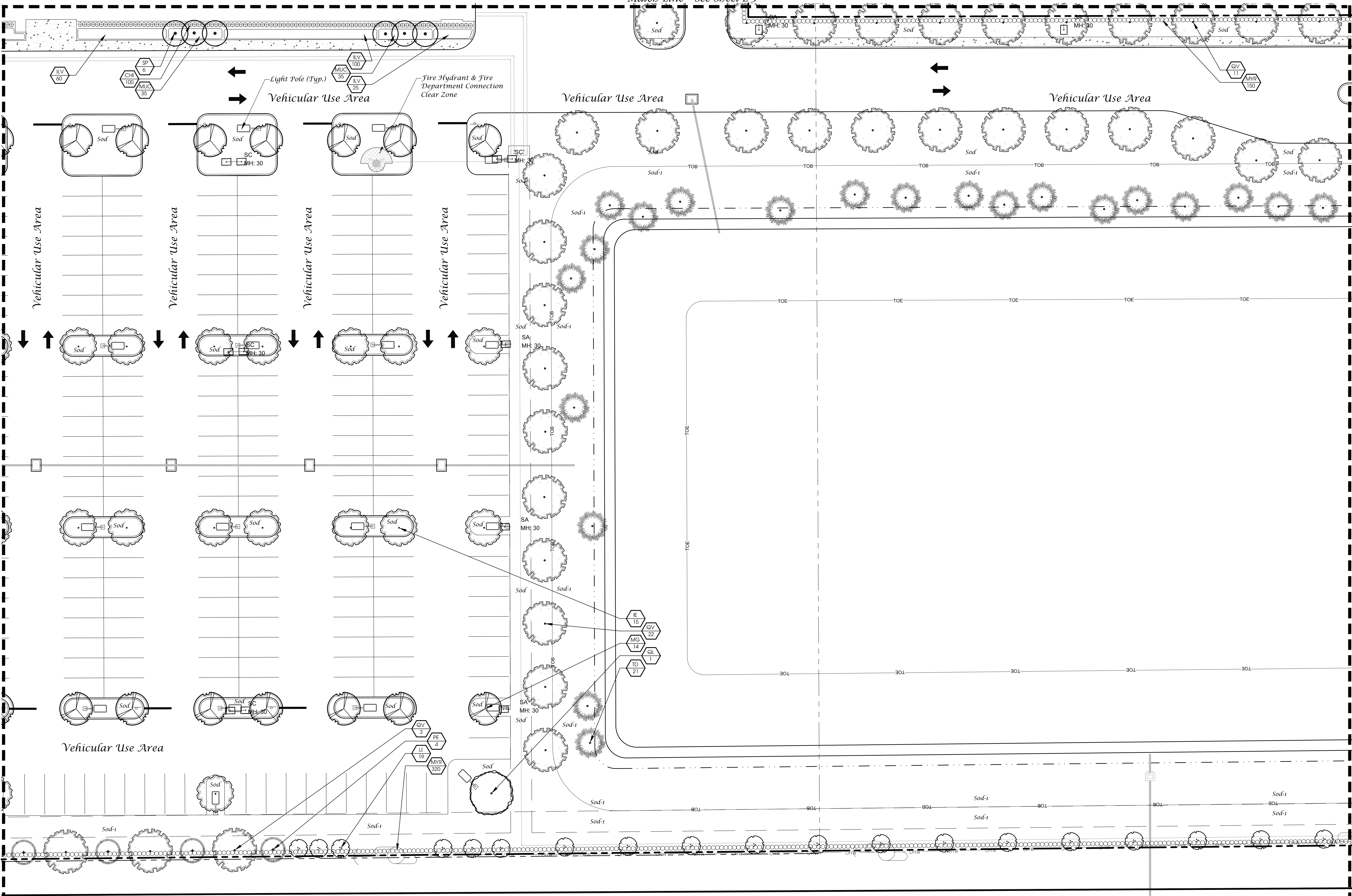

Landscape Plan

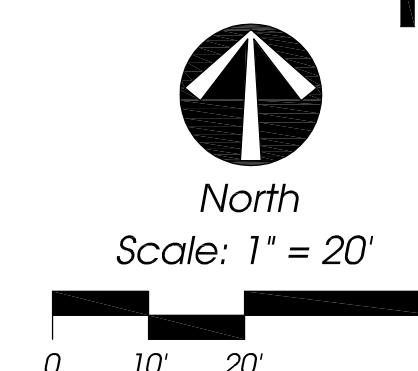

Camping World
 South Jenkins Road
 City of Fort Pierce, Florida

City Project Number:
 18-0700003

Jeffrey W. Smith, RLA
 Florida Registration Number:
 LA 0001635

Job No. 18-0305
 Drawn By JWS
 Submittal Dates 3-19-2018
 4-27-2018

Revision Dates
 4/18 City Comments 4-27-2018

These drawings are the property of the landscape architect and are not to be used for other projects except by written permission from the landscape architect. Report any discrepancies immediately to the landscape architect.

L-7 8
 Sheet of

Match Line - See Sheet L-6

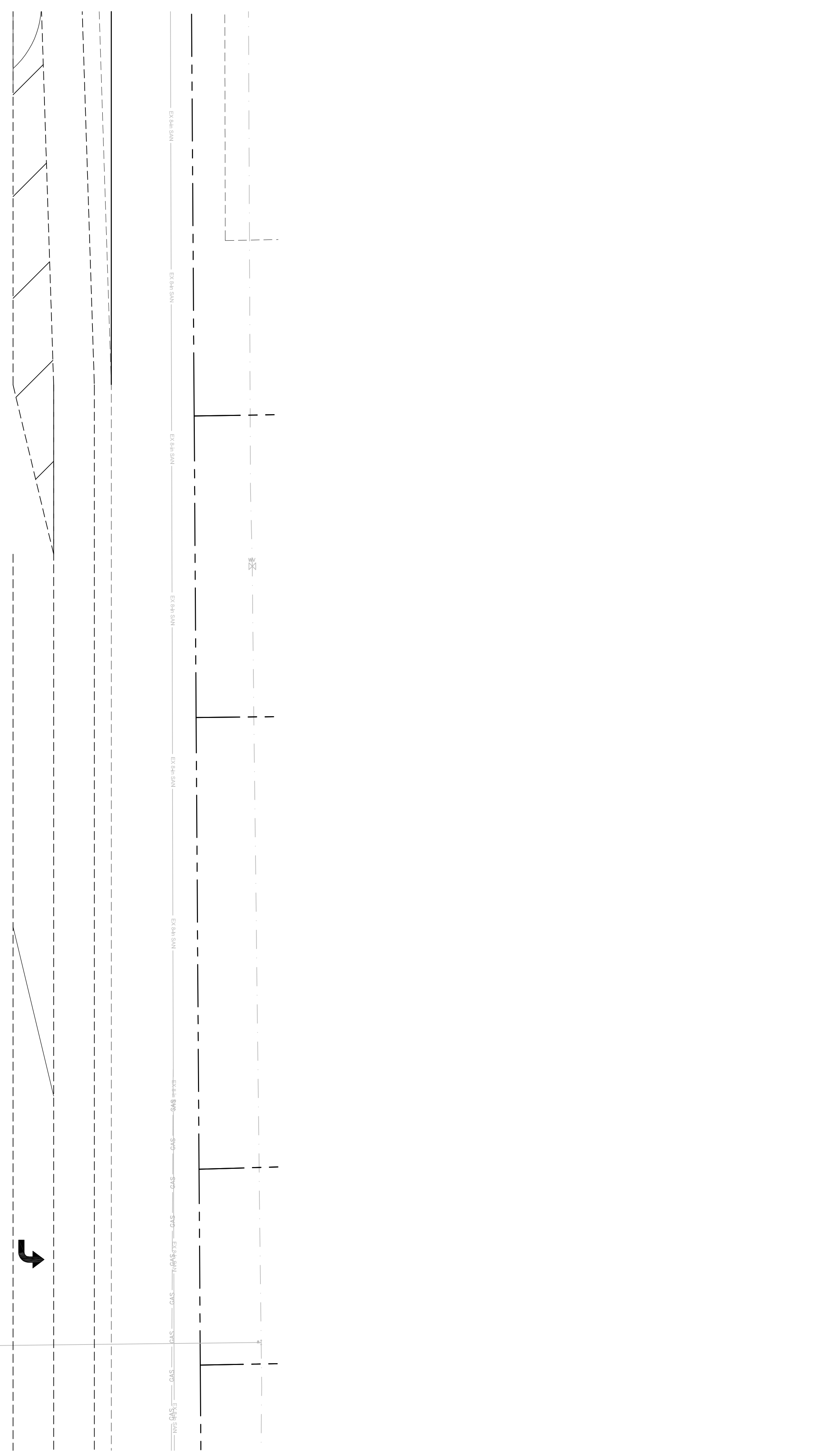
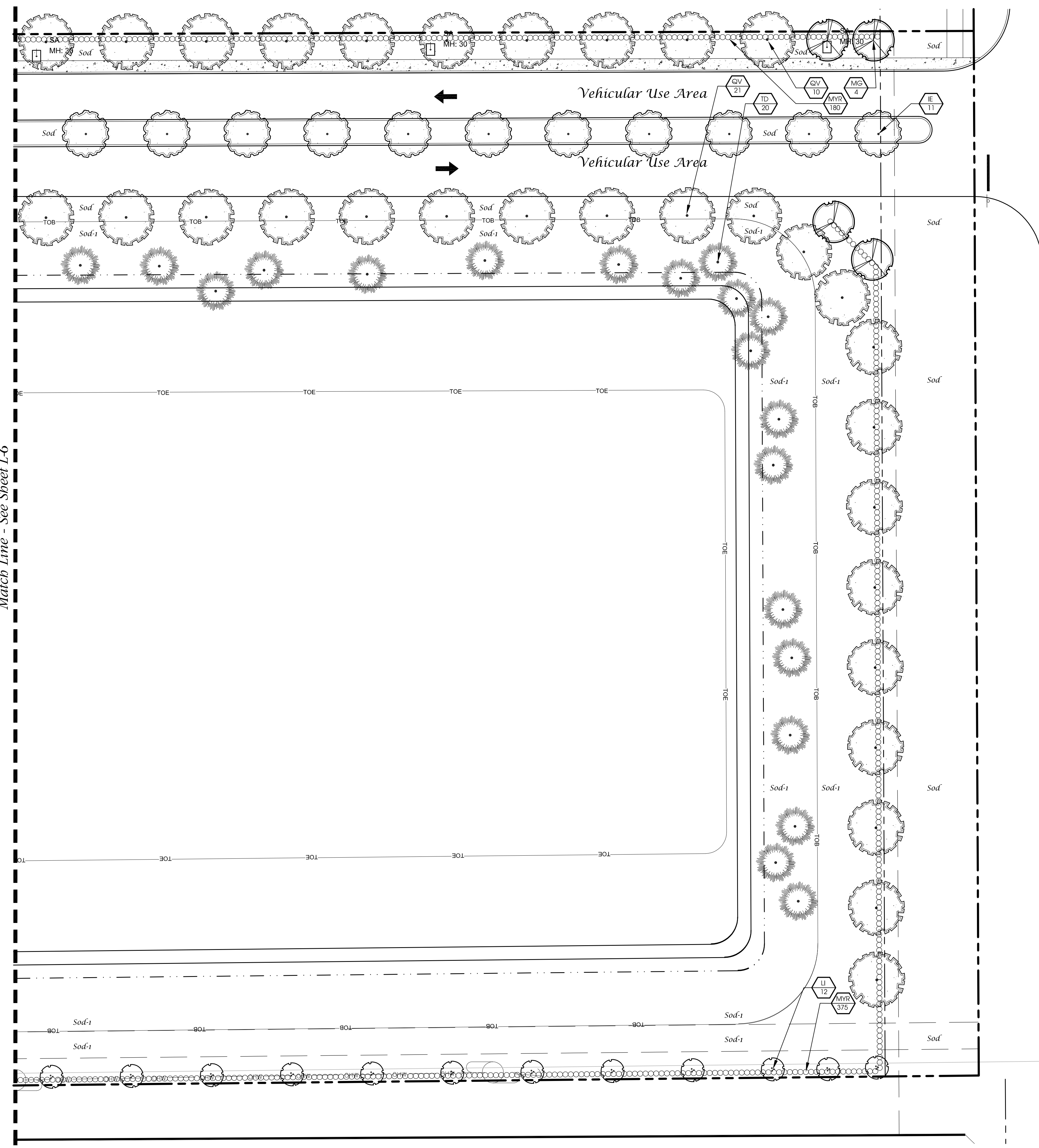

Landscape Plan

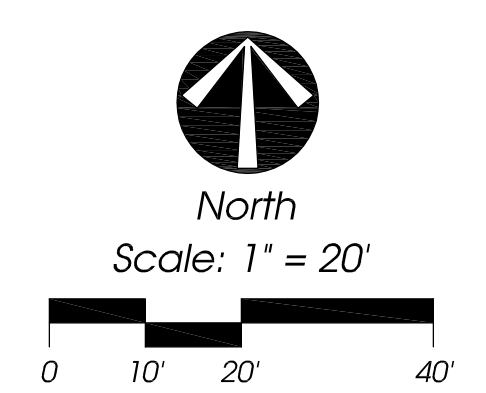

Landscape Specifications

- All tree and plant material to be Florida No. 1 or better, as classified in "Grades and Standards for Nursery Plants", Part I and Part II, State of Florida, Dept. of Agriculture, Tallahassee. All plants not listed in "Grades and Standards for Nursery Plants" shall conform to a Florida No. 1, as to: (1) health and vitality, (2) condition of foliage, (3) root system, (4) freedom from pest or mechanical damage, (5) heavily branched and densely foliated according to the accepted normal shape of the species.
- Underpinning or substitution of one species or cultivar for another species is a breach of contract and will be "Rejected" at the time of final landscape inspection unless approved by Landscape Architect.
- Project Warranty: All plant material shall be warranted for a period of one (1) year after date of substantial completion against defects, including death and unsatisfactory growth, except for defects resulting from abuse or damage by owners or unusual phenomena or incidents which are beyond the contractor's control.
- Any and all conditions which the contractor feels will be detrimental to the success of the planting shall be brought to the owner or representative's attention.
- The contractor shall verify the location of underground utilities prior to commencing work on any project area.
- Mulch planting areas with 2" layer of Metaleuca, Eucalyptus, or Enviro-mulch. Cypress Mulch is NOT ACCEPTABLE. Planting beds to receive mulch throughout entire bed area.
- All plants to be set to ultimate grade. No filling will be permitted around trunks or stems. Mulch to be kept a minimum of 2" away from trunks and stems.
- Planting trees and shrubs: Excavate hole per planting detail. When plant is set, place additional backfill consisting of a 50% mixture of Peat humus and natural soil around the base and sides of ball, and work each layer to settle backfill and eliminate voids and air pockets. When excavation is approximately 2/3 full, water thoroughly before placing remainder of backfill. Water again after placing final layer of backfill and before installing mulch.
- Guy and stake trees in 3 directions with galvanized wires, through flexible hose chafing guards, with wooden stake anchors immediately after planting. (See Detail)
- Trees and shrubs shall be fertilized with a complete natural organic fertilizer with a ratio of approximately 3:0:2 or 3:0:3 (e.g. one labeled 12-0-8). Similar analysis such as 16-0-8 (4:0:2) can also be used. Fertilizers that are slow release, controlled release, sulphur coated or with nitrogen as IBDU or ureaformaldehyde have extended release period. Thirty to fifty percent of the nitrogen should be water insoluble or slow release.

Palms should receive a complete granular fertilizer formulated for palms ("Palm Special") at a rate of 5 to 8 lbs. per palm.

Agriform 20-0-5 twenty-one gram planting tablets may be substituted for granular fertilizer. If utilized, the following rates shall be utilized: Position plant in hole. Backfill halfway up the rootball. Place tablet(s) beside rootball about 1" from root tips. Do not place tablet(s) in bottom of hole.

- 1 Gallon 1 Tablet
- 3 Gallon 2 Tablets
- 25 Gallon & B&B Trees 2 per 1" caliper

- All planting areas and sod to be irrigated to provide 100% coverage. Shop drawings to be submitted by the irrigation contractor for approval prior to installation.
- Maintain trees, shrubs, and other plants by watering, cultivating, and weeding as required for healthy growth. Restore planting saucers and mulch. Tighten and repair stake and guying and reset trees and shrubs to proper grade or vertical position as required. Spray as necessary to keep trees and shrubs free of insects and disease. The contractor shall begin maintenance immediately after planting and shall continue maintenance through final acceptance when Certificate of Occupancy is issued to the General Contractor by City and project is released by the General Contractor to Client.
- Prune trees and shrubs only to remove damaged branches as directed by the Landscape Architect.
- Planting Lawns: Provide clean, strongly rooted, uniformly sized strips of Stenotaphrum secundatum FlorTurf (unless otherwise noted), machine stripped not more than 24 hours prior to laying. Grade and roll prepared lawn surface. Water thoroughly but not to create muddy soil conditions. Lay sod strips with tight joints, roll or tamp lightly, and water thoroughly.
- Maintain positive drainage, no planting is to block drainage.
- Drainage Testing

- Prior to planting of trees, palms, and specimen material, each planting pit shall be tested in the following manner to verify adequate drainage.
- Dig each planting pit to the minimum specified size.
 - Fill the planting pit with (12") twelve inches of water. If the water level in the planting pit drops (4") four or more inches within (4) four hours, the drainage is sufficient and a drainage channel is not required. If the water level drops less than (4") four inches within the (4) four hour period, the drainage is inadequate and a drainage channel is required.
 - When a drainage channel is required, the drainage channel must extend down through the non porous soil and into porous soil. (See Drainage Testing Detail)
 - Discard all material removed from the drainage channel.
 - When backfilling the planting pit, add coarse gravel to the drainage channel. Also, care must be taken to keep the consistency of the soil mix the same throughout the planting pit.

- NOTES:
- Contractor to include drainage testing for all trees and palms in bid. If drainage is inadequate, the soil specification in Item #8 above shall be revised for site conditions. Contractor shall notify the Owner and Landscape Architect of poor drainage conditions in writing and written direction will be provided to the contractor of appropriate soil mixture specification to be used.
 - All fertilizers shall meet the City of Port St. Lucie's fertilizer ordinance.

Plant List

| QTY | SYM | SPECIES | COMMON NAME/DESCRIPTION | SIZE | SPACING | REMARKS |
|---|------|--------------------------------|-------------------------|-----------------------|---------|-----------------------------|
| CANOPY / ORNAMENTAL TREES | | | | | | |
| 40 | IC* | ILEX CASSINE | DAHOON HOLLY | 12' x 5', 2.5" D.B.H. | A.S. | FULL CANOPY, 5' C.T. MIN. |
| 44 | IE* | ILEX X ATTENUATA 'EAGLESTON' | EAGLESTON HOLLY | 12' x 5', 2.5" D.B.H. | A.S. | FULL CANOPY, 5' C.T. MIN. |
| 31 | LI | LAGERSTROEMIA INDICA 'NATCHEZ' | CREPE MYRTLE 'WHITE' | 12' x 5', 2.5" D.B.H. | A.S. | FULL CANOPY, 5' C.T. MIN. |
| 26 | MG* | MAGNOLIA GRANDIFLORA | D D BLANCHARD MAGNOLIA | 12' x 5', 2.5" D.B.H. | A.S. | FULL CANOPY, 2.5' C.T. MIN. |
| 34 | PE* | PINUS ELLIOTTI | SLASH PINE | 12' x 5', 2.5" D.B.H. | A.S. | FULL CANOPY, 5' C.T. MIN. |
| 10 | QL* | QUERCUS LAURIFOLIA | LAUREL OAK | 12' x 5', 2.5" D.B.H. | A.S. | FULL CANOPY, 5' C.T. MIN. |
| 134 | QV* | QUERCUS VIRGINIANA | LIVE OAK | 12' x 5', 2.5" D.B.H. | A.S. | FULL CANOPY, 5' C.T. MIN. |
| 41 | TD* | TAXODIUM DISTICHUM | BALD CYPRESS | 12' x 5', 2.5" D.B.H. | A.S. | FULL CANOPY, 5' C.T. MIN. |
| PALMS | | | | | | |
| 20 | SP* | SABAL PALMETTO | SABAL PALM | 12' C.T. | A.S. | SLICK TRUNKS |
| SHRUBS / GROUNDCOVERS | | | | | | |
| 190 | CHI* | CHRYSOBALANUS ICACO | COCOPALM | #3, 2' x 2' | 2' O.C. | FULL & THICK |
| 35 | FOS* | FORESTIERA SEGREGATA | FLORIDA PRIVET | #3, 2' x 2' | 2' O.C. | FULL & THICK |
| 300 | ILV* | ILEX VOMITORIA | DWARF YAUPON HOLLY | #3, 12" x 12" | 2' O.C. | FULL & THICK |
| 150 | MUC* | MUHLENBERGIA CAPILARIS | MUHL GRASS | #3, 2' x 2' | 2' O.C. | FULL & THICK |
| 2,200 | MYR* | MYRICANTHES FRAGRANS | SIMPSON STOPPER | #3, 2' x 2' | 2' O.C. | FULL & THICK |
| SOD-1 | | | | | | |
| SOD | | | | | | |
| * = Florida Native | | | | | | |
| NOTE: D.B.H. IS MEASURED 4.5" ABOVE GRADE | | | | | | |

Landscape Data

Vehicular Use Area Landscaping Adjacent to R.O.W. (East Buffer) 391' Sec. 22-187(4)
Trees Required = 10' Wide Landscape Strip with 1 Tree/300 s.f.
391 l.f. x 10' = 3,910 s.f. / 300 = 13 Trees
Provided = 13 Trees

Shrubs Required = Continuous Hedge @ 2' o.c.
391 l.f. / 2' o.c. = 196 Shrubs
Provided = 196 Shrubs

Vehicular Use Area Landscaping to Adjacent Property (South Buffer) 1,596' Sec. 22-187(6)
Trees Required = 10' Wide Landscape Strip with 1 Tree/200 s.f.
850 l.f. x 10' = 8,500 s.f. / 200 = 43 Trees
Provided = 43 Trees

Trees Required = 10' Wide Landscape Strip with 1 Tree/300 s.f.
746 l.f. x 10' = 7,460 s.f. / 300 = 25 Trees
Provided = 25 Trees

Total Trees Required = 68
Total Trees Provided = 68

Shrubs Required = Continuous Hedge @ 2' o.c.
1,596 l.f. / 2' o.c. = 798 Shrubs
Provided = 798 Shrubs

Vehicular Use Area Landscaping to Adjacent Property (West Buffer) 1,188' Sec. 22-187(6)

Trees Required = 10' Wide Landscape Strip with 1 Tree/300 s.f.
1,188 l.f. x 10' = 11,880 s.f. / 300 = 40 Trees
Provided = 40 Trees Relocate to North, South & East Buffers

Shrubs Required = No shrubs required unless against residential property.
Provided = 0 Shrubs

Vehicular Use Area Landscaping to Adjacent Property (North Buffer) 585' Sec. 22-187(6)
Trees Required = 10' Wide Landscape Strip with 1 Tree/200 s.f.
585 l.f. x 10' = 5,850 s.f. / 200 = 30 Trees
Provided = 30 Trees

Shrubs Required = Continuous Hedge @ 2' o.c.
585 l.f. / 2' o.c. = 293 Shrubs
Provided = 293 Shrubs

Vehicular Use Area Landscaping to Adjacent Property (North East Buffer) 1,818' Sec. 22-187(6)
Trees Required = 10' Wide Landscape Strip with 1 Tree/300 s.f.
1,818 l.f. x 10' = 18,180 s.f. / 300 = 61 Trees
Provided = 61 Trees

Shrubs Required = Continuous Hedge @ 2' o.c.
1,818 l.f. / 2' o.c. = 909 Shrubs
Provided = 909 Shrubs

Interior Vehicular Use Area

Sec. 22-187(7)
Required = 1 s.f. of interior landscaping per 15 s.f. of vehicular use area (225,158 s.f./15 = 15,011 s.f.)
Landscape Area Provided = 16,611 s.f.
Trees Required = 1 Tree/100 s.f. of interior landscape area
225,158 s.f./15 = 15,011 s.f. / 100 = 150 Trees
Trees Provided = 150

Maximum Use of Palm Trees

Sec. 22-187(1)(c)
Required = Fifty (50) percent of the required trees shall be species other than palm trees
Total Trees Required = 362 Trees
Maximum Palms Allowed = 191 (326 / 2 = 191)
Total Palms Provided = 20 (06%)

Total Trees Required = 362 Trees
Total Trees Provided = 366 Trees
360 Trees + 20 Palms @ 3:1 = 6 Trees = 366 Trees

Total Trees Required = 362 Trees
Total Native Trees Provided = 329 (91%)

Total Palms Required = 0
Total Native Palms Provided = 20 (100%)

Total Shrubs Required = 2,875
Total Native Shrubs Provided = 2,875 (100%)

Landscape Details

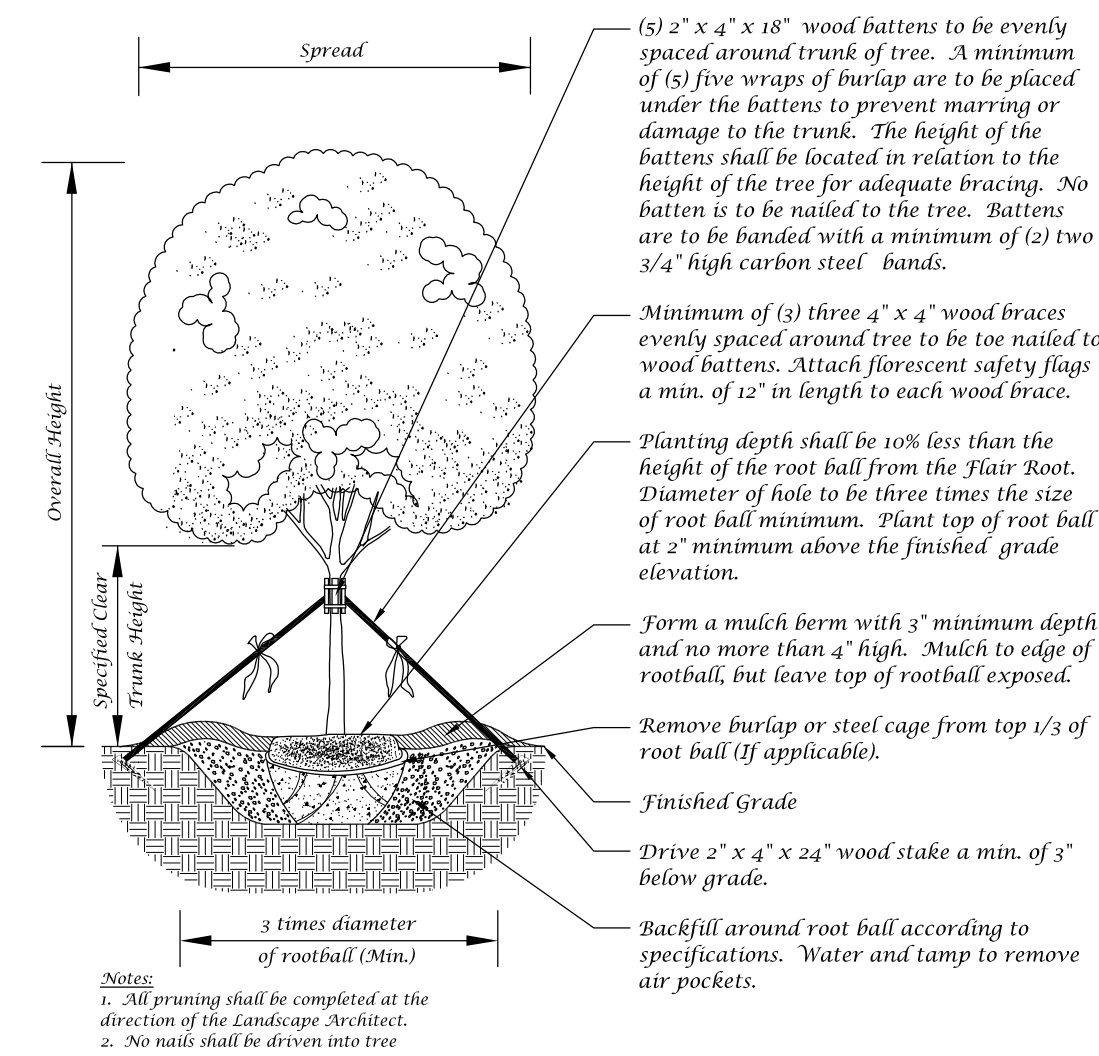

Large Tree Planting Detail (5" Caliper or Greater)

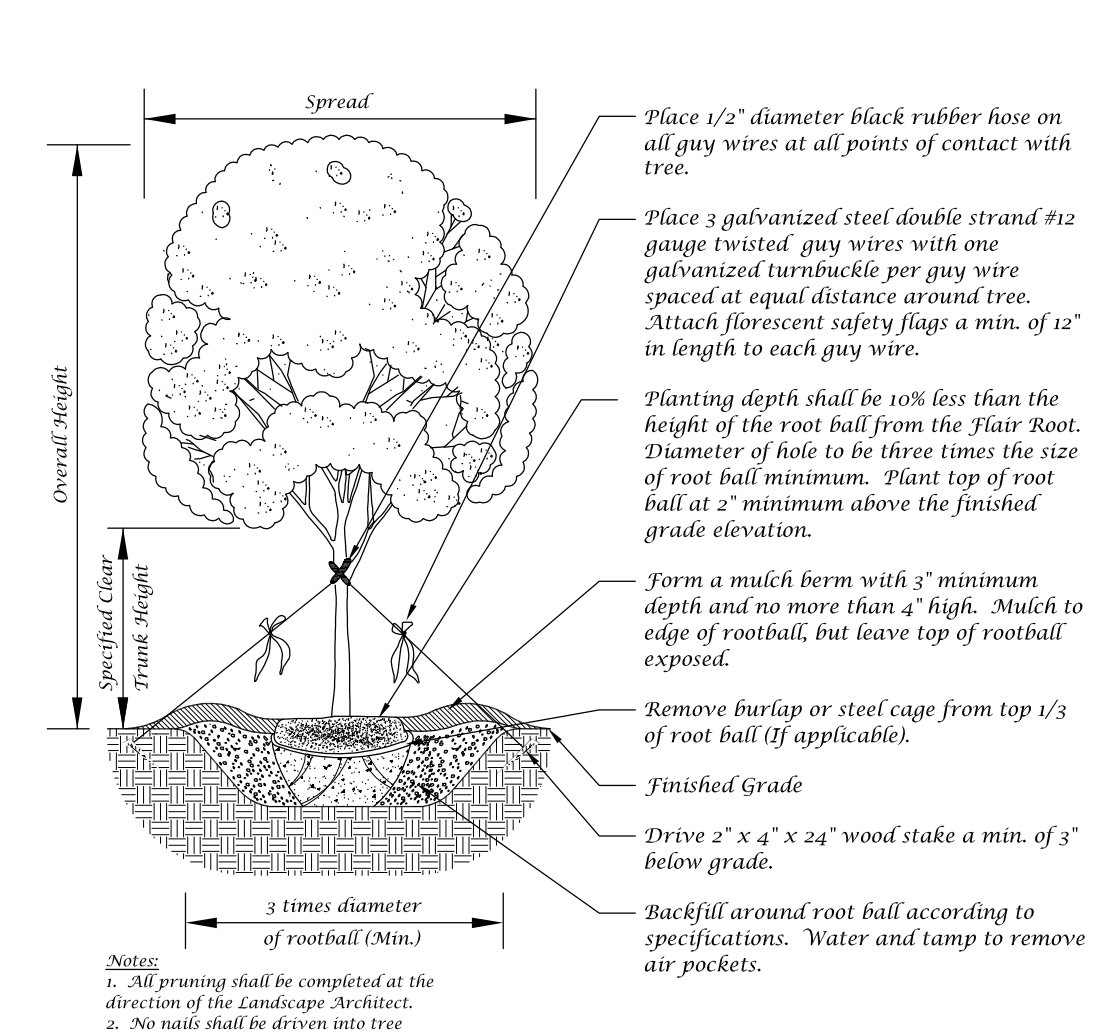

Tree Planting Detail

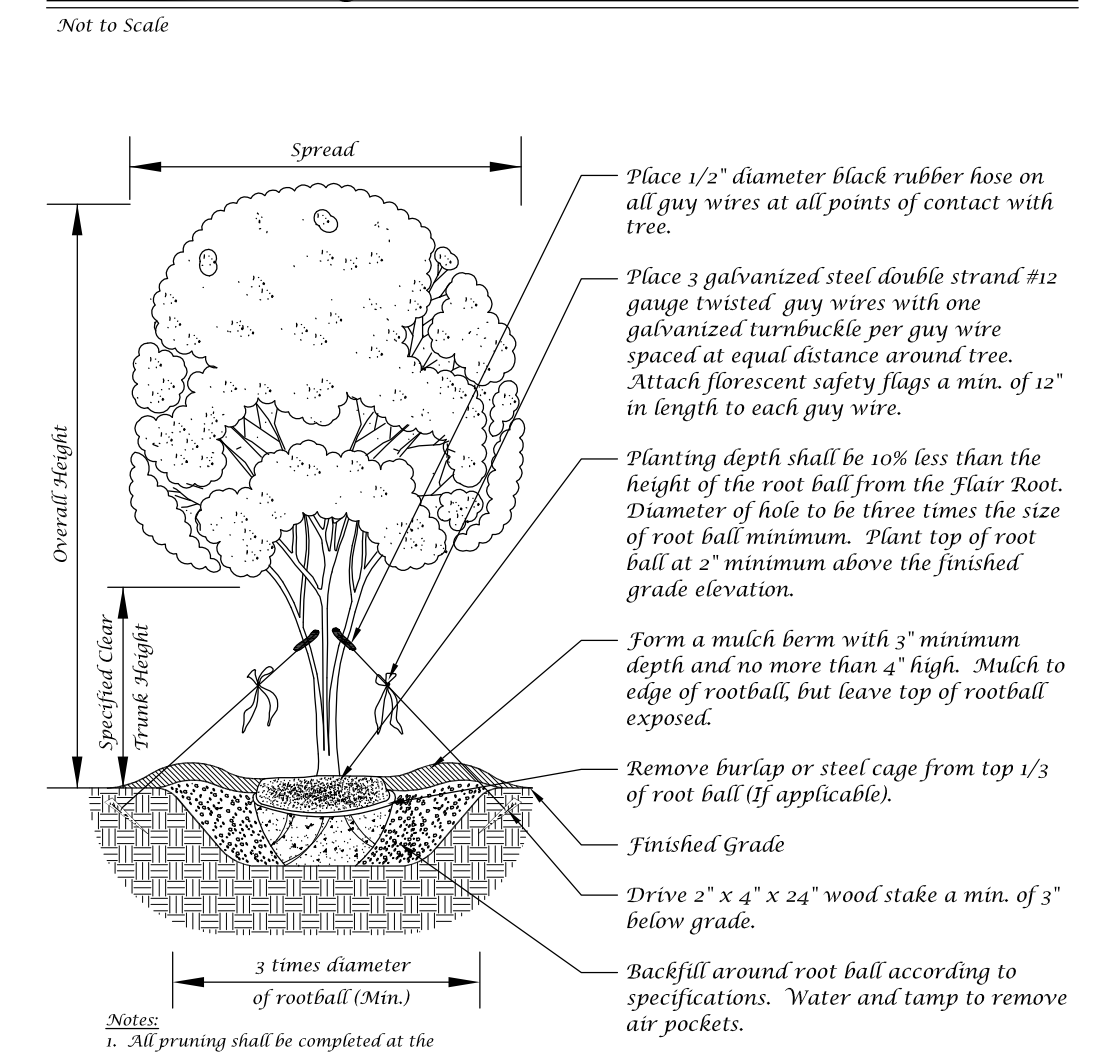

Multi-Trunk Tree Planting Detail

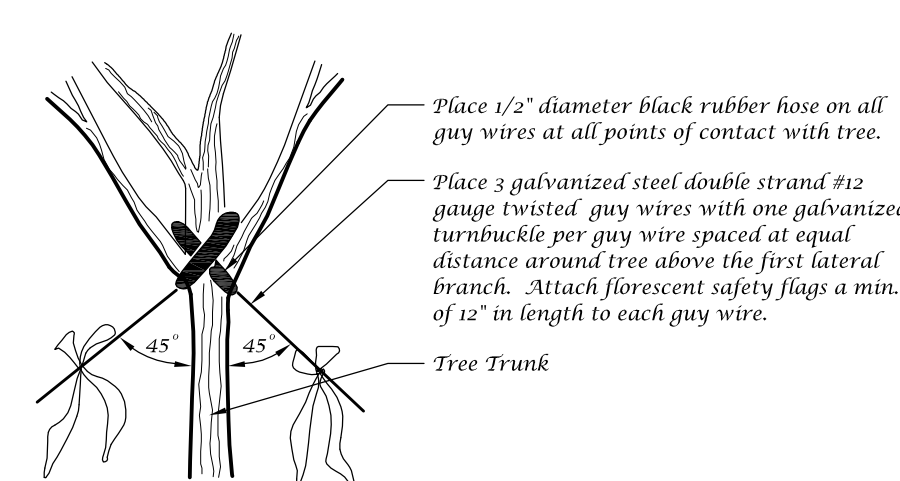
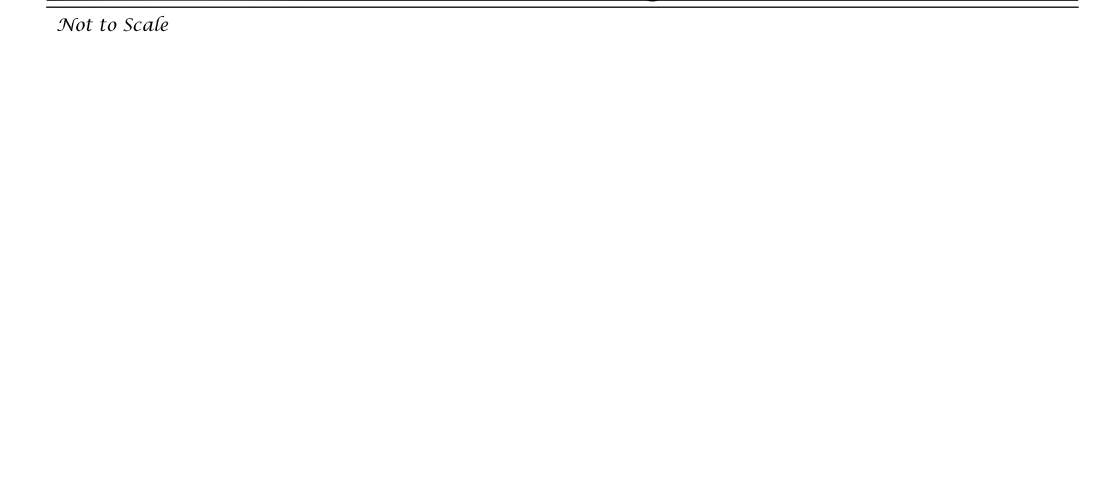

Guy Wire Attachment Detail

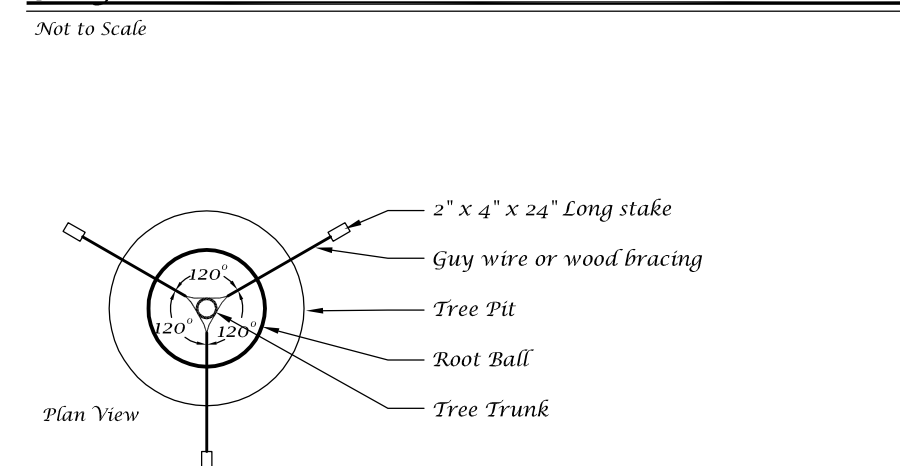

Staking Detail

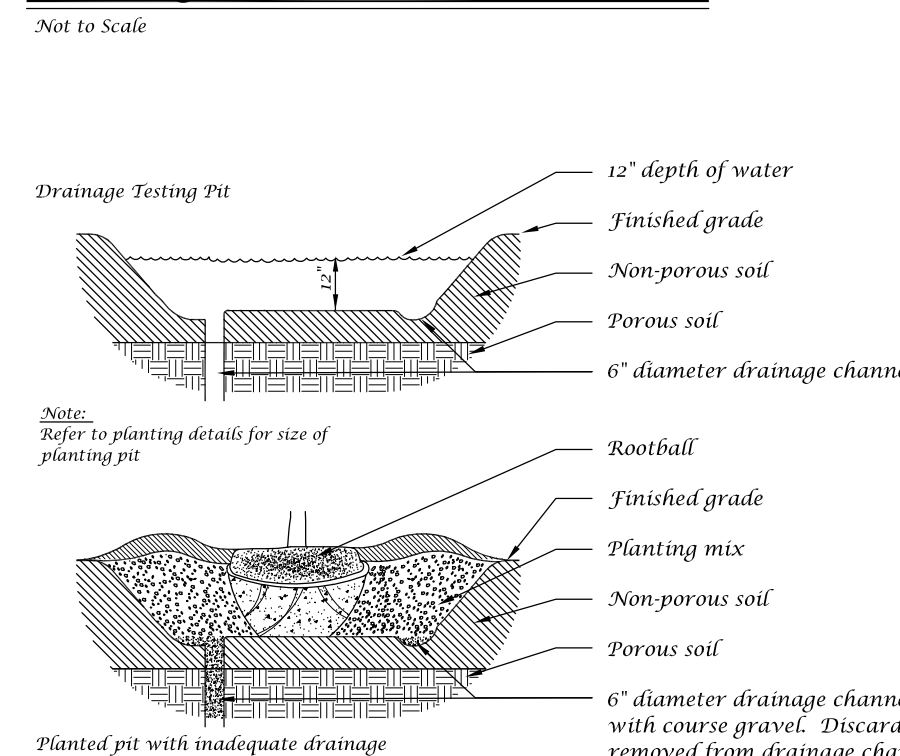

Drainage Testing Detail

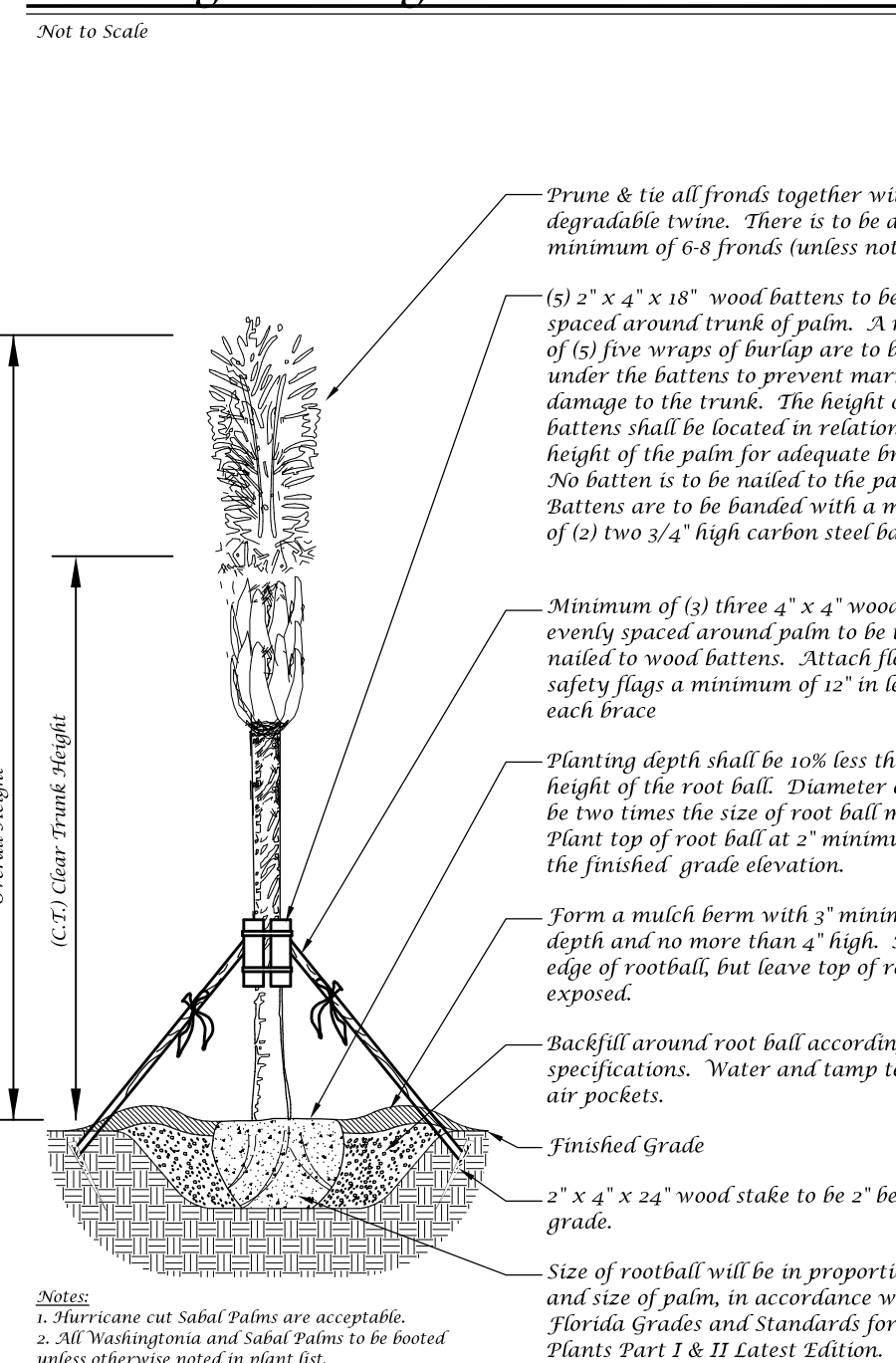

Palm Planting Detail

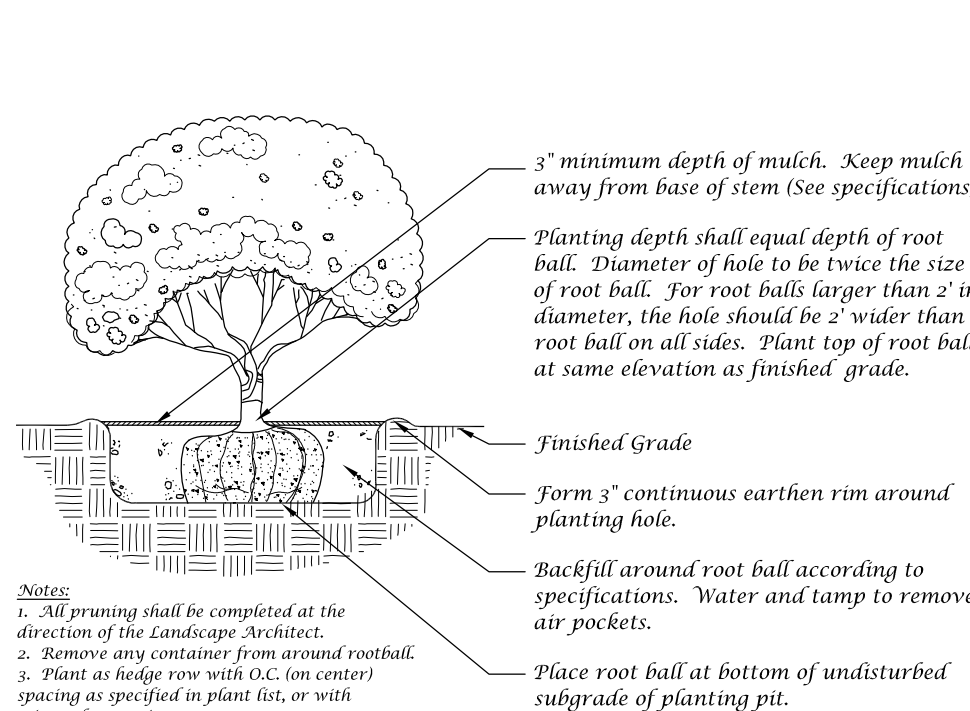
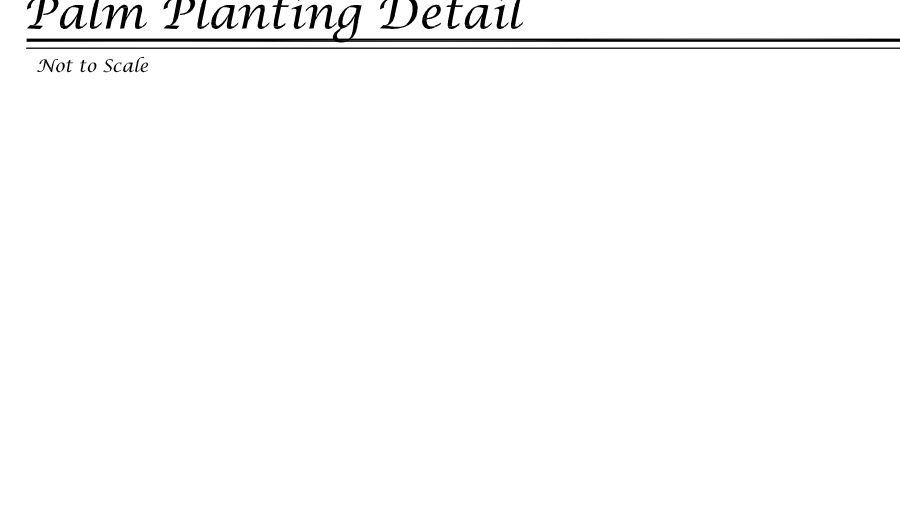

Shrub Detail

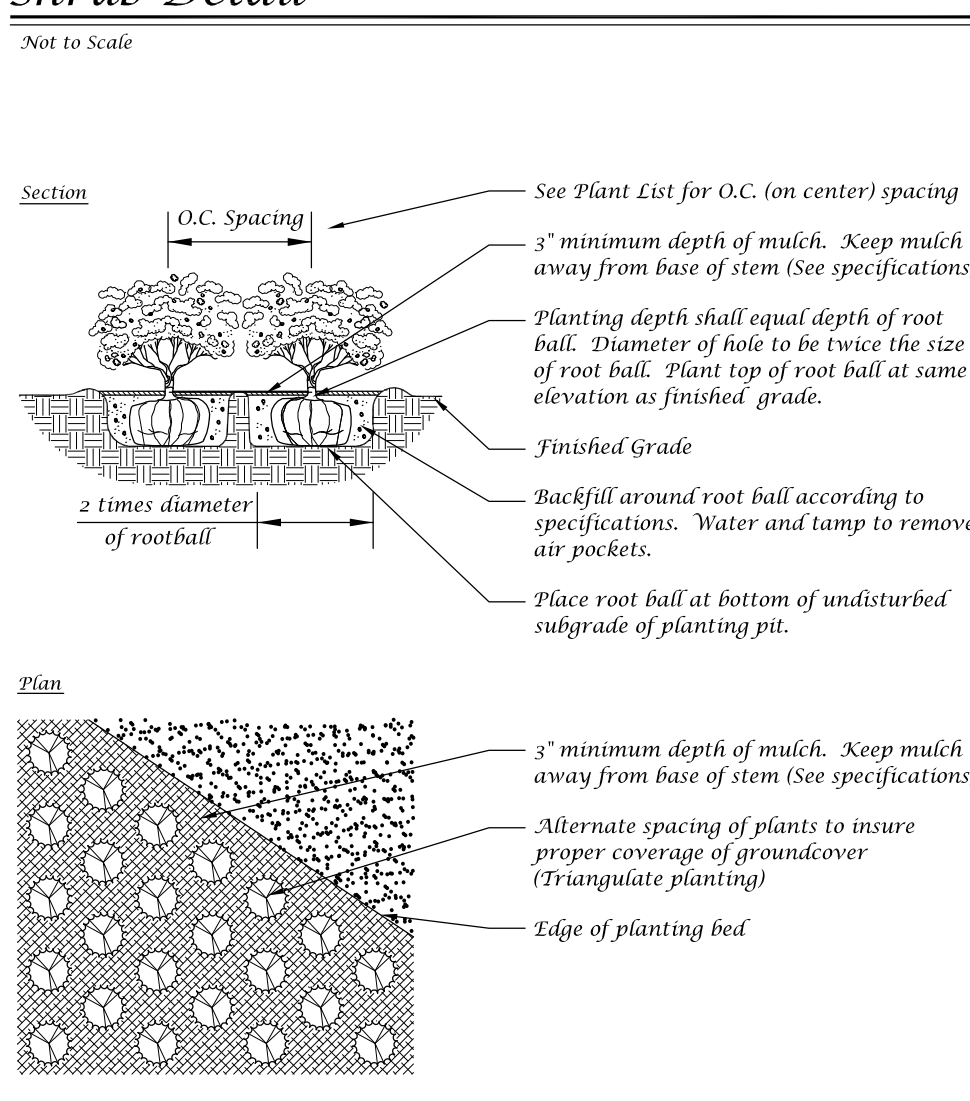

Ground Cover Detail

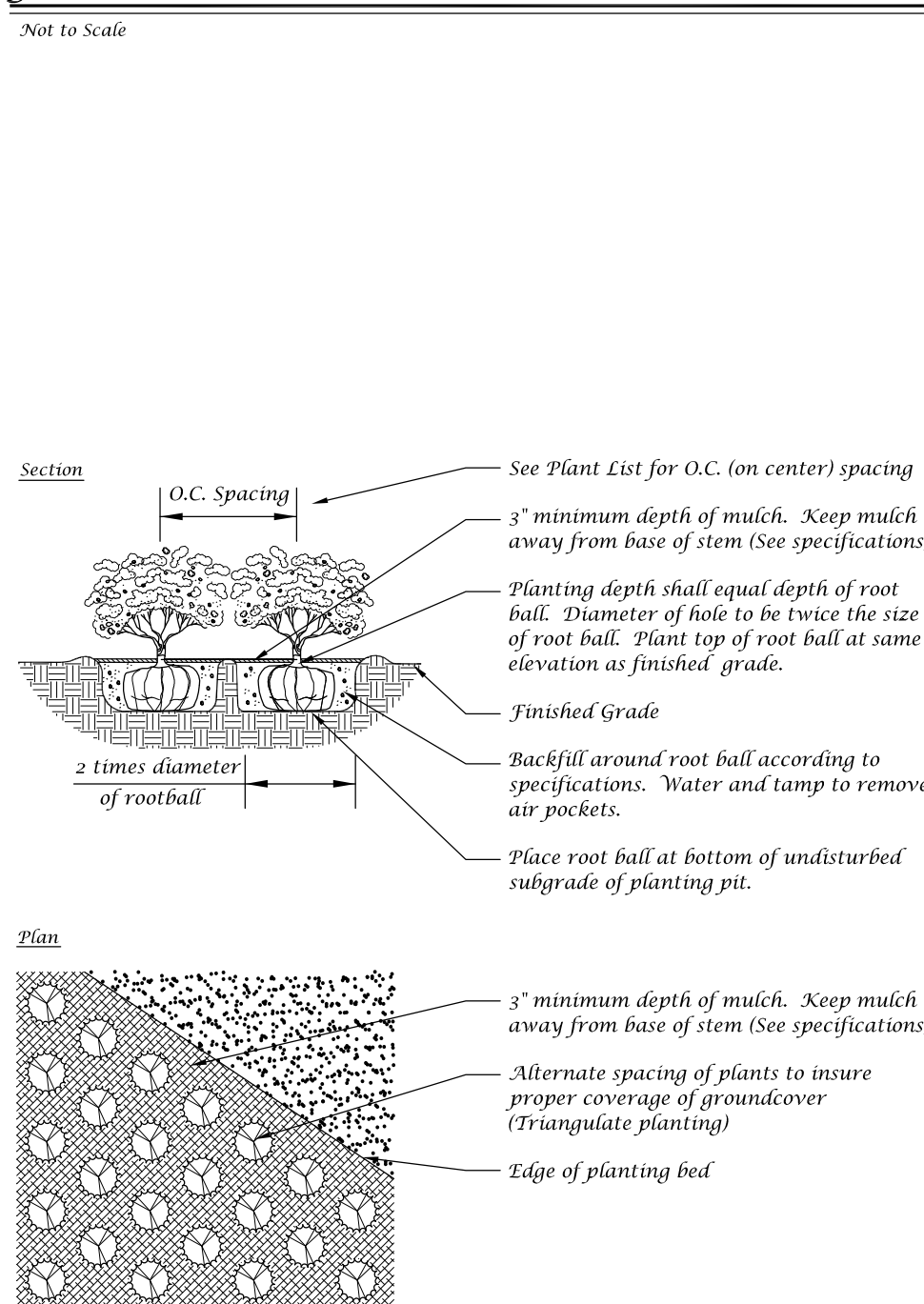

Ground Cover Detail

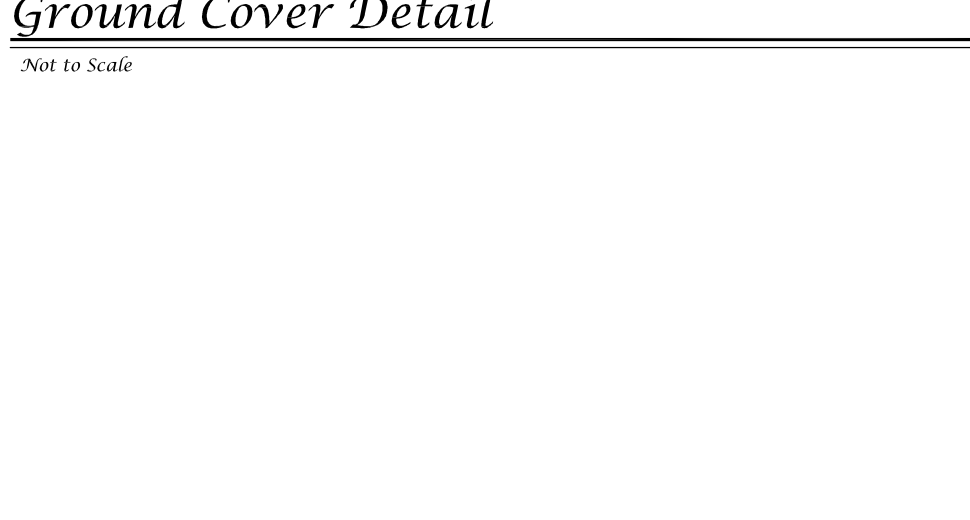

Conceptual Design Group, Inc.
Landscape Architecture - Site Planning
900 East Ocean Boulevard, Suite 130D
Stuart, Florida 34994
(772) 344-2340
LC: 26000198

Camping World
South Jenkins Road
City of Fort Pierce, Florida

City Project Number: 18-0700003

Jeffrey W. Smith, RLA
Florida Registration Number: LA 0001635

Job No. 18-0305
Drawn By JWS
Submittal Dates 3-19-2018
4-27-2018

Revision Dates 4/18 City Comments 4-27-2018

These drawings are the property of the landscape architect and are not to be used for other projects except by written permission from the landscape architect. Report any discrepancies immediately to the landscape architect.

Landscape Plan