

Property Identification

Site Address: 604 W MIDWAY RD
Parcel ID: 3403-243-0001-000-0
Account #: 38747
Map ID: 34/03N
Use Type: 1900
Zoning: CN
City/County: Fort Pierce

Ownership

604 Midway LLC
7745 Dawson CT
Lake Worth, FL 33467

Legal Description

3 36 40 BEG 1360 FT E OF CENTER OF OLEANDER AV AND MIDWAY, TH RUN N 670 FT, TH E 245 FT, TH S 670 FT, TH W 245 FT TO POB-LESS MIDWAY RD R/W AND LESS TO SLC AS IN OR 761-1911 AND LESS FOR ADDL RD R/W MPDAF: FROM W 1/4 COR OF SEC, TH N 00 11 02 W 48.16 FT, TH S 89 42 45 E 1308.27 FT, TH N 00 17 15 E 40 FT TO POB; TH CONT N 00 17 15 E 15.05 FT, TH N 89 00 38 E 25.24 FT, TH S 89 40 58 E 219.89 FT, TH S 00 17 15 W 15.50 FT, TH N 89 42 45 W 245.13 FT TO POB- (3.53 AC - 153,767 SF) (OR 3799-1231)

Current Values

Just/Market Value: \$987,700
Assessed Value: \$987,700
Exemptions: \$0
Taxable Value: \$987,700
Taxes for this parcel: SLC Tax Collector's Office [☑](#)
Download TRIM for this parcel: [Download PDF](#) [☑](#)



Total Areas

Finished/Under Air (SF): 6,002
Gross Area (SF): 6,577
Land Size (acres): 3.53
Land Size (SF): 153,767

Sale History

Date:	Oct 9, 2015
Book/Page:	3799 / 1231
Sale Code:	0111
Deed:	WD
Grantor:	Port St Lucie Ventures Inc
Price:	\$0
Date:	Jun 23, 1997
Book/Page:	1084 / 1740
Sale Code:	XX04
Deed:	DE
Grantor:	Port St Lucie Ventures Inc
Price:	\$62,500
Date:	Jun 23, 1997
Book/Page:	1084 / 1738
Sale Code:	XX04
Deed:	WD
Grantor:	

Price: \$62,500

Building Information (1 of 1)

Finished Area: 6,002 SF

Gross Total Area: 6,577 SF

Exterior Data

View:
Building Type: LROF
Grade: Y_B
Story Height: 1 Story

Roof Cover: Enam Metal
Year Built: 1998
Effective Year: 1998
No. Units: 2

Roof Structure: Hip
Frame:
Primary Wall: CB Stucco
Secondary Wall:

Interior Data

Bedrooms: 0
Full Baths: 0
Half Baths: 0
A/C %: 100%

Electric: MAXIMUM
Heat Type: FredHotAir
Heat Fuel: ELEC
Heated %: 100%

Primary Int Wall:
Avg Hgt/Floor: 0
Primary Floors: Tile-Quarry
Sprinkled %: 100%

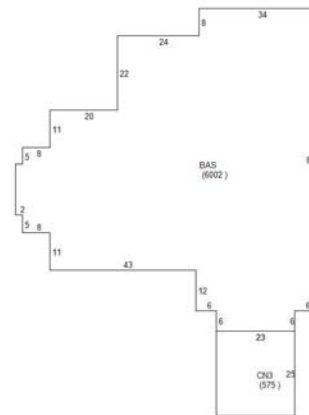

Special Features and Yard Items

Type:	CEMENT CURB
Quantity:	1
Units:	2270
Year Built:	1998
Type:	SINGLE LIGHT
Quantity:	1
Units:	4
Year Built:	1998
Type:	ASP2 LOW
Quantity:	1
Units:	17120
Year Built:	1998
Type:	WOOD FEN 6'
Quantity:	1
Units:	43
Year Built:	1998

Current Year Values

Current Values Breakdown

Building:	\$641,700
Land:	\$346,000
Just/Market:	\$987,700
Ag Credit:	\$0
Save Our Homes or 10% Cap:	\$0
Assessed:	\$987,700
Exemption(s):	\$0
Taxable:	\$987,700

Current Year Exemption Value Breakdown

Current Year Special Assessment Breakdown

Start Year	AssessCode	Units	Description	Amount
2009	0041	19.3	Fort Pierce Stormwater Charge	\$1,042.20
Start Year	AssessCode	Units	Description	Amount
2013	0054	3.62	North St. Lucie Water Management District	\$59.73

This does not necessarily represent the total Special Assessments that could be charged against this property. The total amount charged for special assessments is reflected on the most current tax statement and information is available with the SLC Tax Collector's Office .

Historical Values

Permits

Number:	C97-070418
Issue Date:	Jul 24, 1997
Description:	Demolition
Amount:	\$2,200
Fee:	\$2,200
Number:	C97-080269
Issue Date:	Sep 24, 1997
Description:	Commercial New Construction
Amount:	\$561,935
Fee:	\$561,935
Number:	C98-030197
Issue Date:	Mar 10, 1998
Description:	Alterations/Remodeling
Amount:	\$2,450
Fee:	\$2,450
Number:	0800001805
Issue Date:	Nov 26, 2008
Description:	Roof
Amount:	\$18,000
Fee:	\$175

Notice: This does not necessarily represent all the permits for this property.
Click the following link to check for additional permit data in Fort Pierce

