

**SITE BENCH MARK
IN 1988 NAVD**

LEGEND	
$x25.1$	EXISTING GRADE ELEVATION
HP	HIGH POINT
$\frac{1}{2}$ CURB 26.10 23.75 9/2 CURB	PROPOSED ELEVATION
\rightarrow	RUNOFF FLOW DIRECTION
	FDOT MITERED END SECTION
\circ 22.0	PIPE INVERT
ACP	ALUMINUM CORRUGATED PIPE

LEGEND	
	TEE
	45° BEND
	90° ELBOW
	F.H. FIRE HYDRANT
	GATE VALVE
	BACKFLOW PREVENTER
	SERVICE CLEAN OUT
	METER BOX
	EXIST. 12" WATER MAIN
	EXIST. 8" FORCE MAIN
	CATCH BASIN
	GAS MAIN

STORMWATER STATEMENT:
PROPOSED STORMWATER DRAINAGE SYSTEM WILL CONSIST OF DETENTION AREA, CULVERTS AND A CONTROL STRUCTURE & MUST COMPLY WITH CITY OF PIERCE CH 17&22

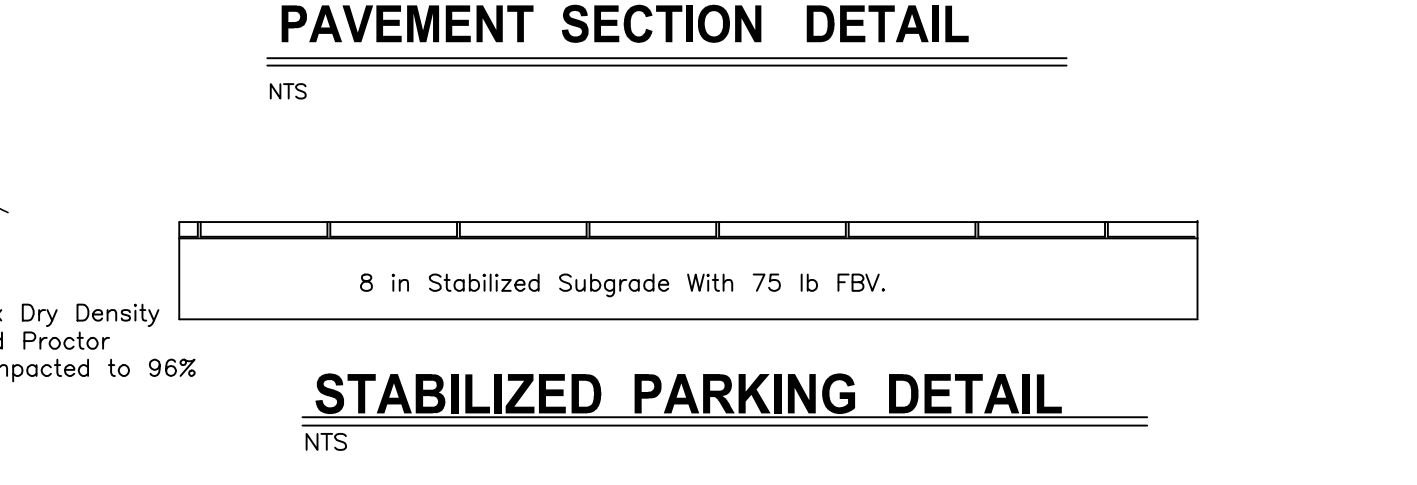
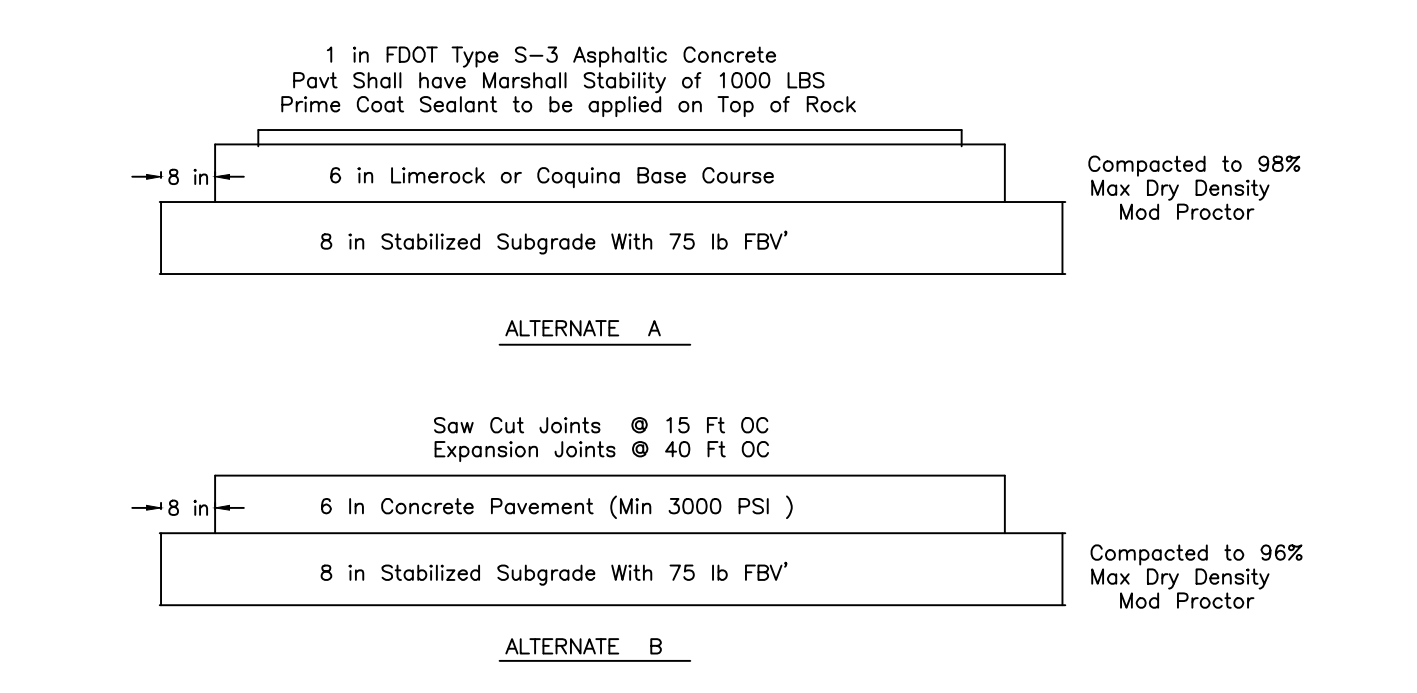
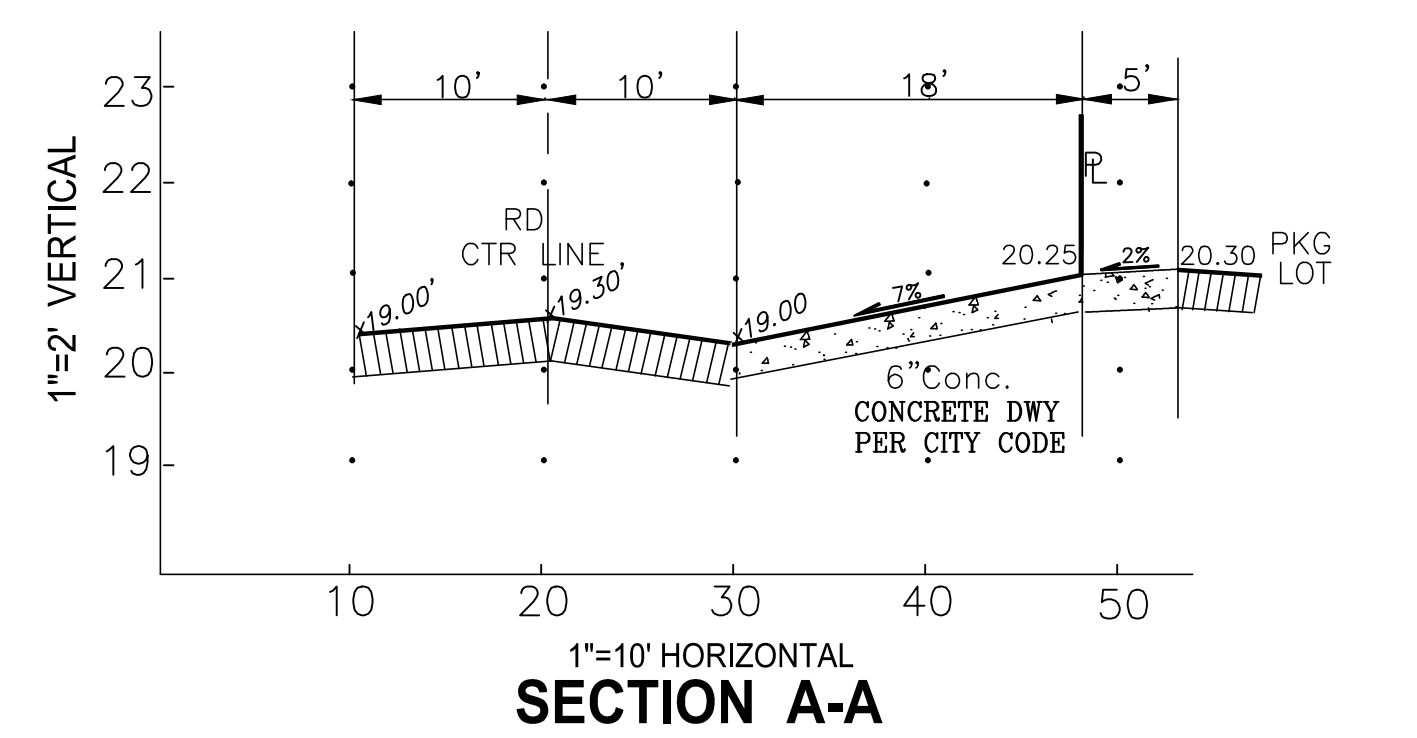

SCALE 1" = 20'

ABRAHAM CHABAB, PE
FL. LIC# 47165

<p>ABRAHAM CHABAB, Inc. FL. BOARD OF PROF. ENG. AUTH.#26790</p> <p>5428 NW EDGEWATER AVE PORT ST. LUCIE FL 34983 Email: agchabab1@msn.com 772 878-5079/475-6630 Fax 772 785-8291</p>	<p>FRESH WIND FRESH FIRE CHURCH</p> <p>PAVING & DRAINAGE PLAN</p>	DESIGNED BY AC	REVISIONS	DATE
		DRAWN BY AC		
		DATE Aug. 30/17		
		SHEET 1 OF 1		