

Michelle Franklin, CFA -- Saint Lucie County Property Appraiser -- All rights reserved.

**Property Identification**

Site Address: 711 S INDIAN RIVER DR  
 Sec/Town/Range: 10/35S/40E  
 Map ID: 24/10H  
 Zoning: R4

Parcel ID: 2410-810-0021-000-5  
 Account #: 23913  
 Use Type: 0100  
 Jurisdiction: Fort Pierce

**Ownership**

Philip C Gates Jr  
 313 Orange Ave  
 Fort Pierce, FL 34950

**Legal Description**

ANDREWS AND RICHARDS S/D LOT 9 EOF S 2 ST (12) (MAP 24/10H)  
 (OR 219-1407; 3235-2901)

**Current Values**

Just/Market Value: \$178,600  
 Assessed Value: \$107,151  
 Exemptions: \$50,000  
 Taxable Value: \$57,151

Taxes for this parcel: SLC Tax Collector's Office   
 Download TRIM for this parcel: Download PDF



**Total Areas**

Finished/Under Air (SF): 2,324  
 Gross Area (SF): 3,308  
 Land Size (acres): 0.54  
 Land Size (SF): 23,543

**Sale History**

Date	Book/Page	Sale Code	Deed	Grantor	Price
Jan 4, 2010	3235 / 2901	0130	QC	Gates, Sonja M	\$100
Sep 1, 1973	0219 / 1407	XX00	CV		\$26,800

**Building Information (1 of 2)**

Finished Area: 2,324 SF  
 Gross Total Area: 2,868 SF

**Exterior Data**

View:	Roof Cover: Dim Shingle	Roof Structure: Hip
Building Type: HB	Year Built: 1910	Frame:
Grade: B	Effective Year: 1970	Primary Wall: Alum Siding
Story Height: 2 Story	No. Units: 1	Secondary Wall:

**Interior Data**

Bedrooms: 4	Electric: MAXIMUM	Primary Int Wall:
Full Baths: 2	Heat Type: FrcdHotAir	Avg Hgt/Floor: 0
Half Baths: 1	Heat Fuel: ELEC	Primary Floors: Hardwood
A/C %: 100%	Heated %: 100%	Sprinkled %: N/A%

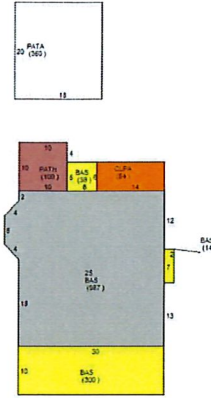

**Sketch Area Legend**

Sub Area	Description	Area	Fin. Area	Perimeter
2S	ONE FULL STORY OVER BASE (TOTAL 2 FLOORS)	987	987	126
BAS	BASE AREA	1337	1337	248
CLPA	Closed Porch Average	84	0	40
PATA	Patio Average (Plain Slab)	360	0	76
PATH	Patio High (Flooring over Slab-Tile,Pavers,etc)	100	0	40

**Building Information (2 of 2)**

Finished Area: 0 SF

Gross Total Area: 440 SF

**Exterior Data**

View:  
 Building Type: DGAR  
 Grade: DG  
 Story Height: 1 Story

Roof Cover: Dim Shingle  
 Year Built: 1910  
 Effective Year: 1965  
 No. Units: 0

Roof Structure: Hip  
 Frame:  
 Primary Wall: Wd Shingle  
 Secondary Wall:

**Interior Data**

Bedrooms: 0  
 Full Baths: 0  
 Half Baths: 0  
 A/C %: 0%

Electric: MINIMUM  
 Heat Type:  
 Heat Fuel:  
 Heated %: N/A%

Primary Int Wall:  
 Avg Hgt/Floor: 0  
 Primary Floors: CONC GRD  
 Sprinkled %: 0%

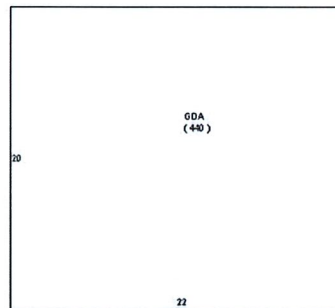

**Sketch Area Legend**

Sub Area	Description	Area	Fin. Area	Perimeter
GDA	Garage Detached Average	440	0	84

**Special Features and Yard Items**

Type	Qty	Units	Year Blt
CHAINLINK 4'	1	225	1999

**Current Year Values**

Current Values Breakdown		Current Year Exemption Value Breakdown				
		Tax Year	Grant Year	Code	Description	Amount
Building:	\$77,900					
Land:	\$100,700	2017	1999	0500	Homestead Exemption	\$25,000
Just/Market:	\$178,600	2017	2008	0550	Homestead Exemption over \$50,000	\$25,000
Ag Credit:	\$0					
Save Our Homes or 10% Cap:	\$71,449					
Assessed:	\$107,151					
Exemption(s):	\$50,000					
Taxable:	\$57,151					

**Current Year Special Assessment Breakdown**

Start Year	AssessCode	Units	Description	Amount
1999	0041	1	Fort Pierce Stormwater Charge	\$54.00

This does not necessarily represent the total Special Assessments that could be charged against this property. The total amount charged for special assessments is reflected on the most current tax statement and information is available with the SLC Tax Collector's Office .

**Historical Values**

Year	Just/Market	Assessed	Exemptions	Taxable
2017	\$178,600	\$107,151	\$50,000	\$57,151
2016	\$161,700	\$104,948	\$50,000	\$54,948
2015	\$175,500	\$104,219	\$50,000	\$54,219

**Permits**

Number	Issue Date	Description	Amount	Fee
F00-000401	Mar 29, 2000	Roof	\$5,685	\$0
BP10-2405	Jan 19, 2011	Alterations/Remodeling	\$4,000	\$80

Notice: This does not necessarily represent all the permits for this property.

Click the following link to check for additional permit data in Fort Pierce

This information is believed to be correct at this time but it is subject to change and is not warranted.

© Copyright 2017 Saint Lucie County Property Appraiser. All rights reserved.