

Michelle Franklin, CFA -- Saint Lucie County Property Appraiser -- All rights reserved.

Property Identification

Site Address: 720 CITRUS AVE
 Sec/Town/Range: 10/35S/40E
 Map ID: 24/10S
 Zoning: OFFICE COM

Parcel ID: 2410-706-0088-000-2
 Account #: 23621
 Use Type: 0100
 Jurisdiction: Fort Pierce

Ownership

Valerie Ryan
 PO Box 3514
 Fort Pierce, FL 34948

Legal Description

PARKWAY PLACE LOT 91 (MAP 24/10E) (OR 2682-1726)

Current Values

Just/Market Value: \$23,200
 Assessed Value: \$22,264
 Exemptions: \$0
 Taxable Value: \$22,264

Taxes for this parcel: SLC Tax Collector's Office
 Download TRIM for this parcel: [Download PDF](#)



Total Areas

Finished/Under Air (SF): 1,274
 Gross Area (SF): 1,310
 Land Size (acres): 0.15
 Land Size (SF): 6,450

Sale History

Date	Book/Page	Sale Code	Deed	Grantor	Price
Sep 28, 2006	2682 / 1726	XX00	WD	Thomas, Maybel A	\$110,000
Sep 20, 1994	0921 / 1656	XX00	WD	Charles J Neitz	\$17,500
Feb 4, 1991	0725 / 2570	XX01	QC		\$100

Building Information (1 of 1)

Finished Area: 1,274 SF
 Gross Total Area: 1,310 SF

Exterior Data

View:	Roof Cover: Dim Shingle	Roof Structure: Gable
Building Type: HD	Year Built: 1940	Frame:
Grade: D	Effective Year: 1965	Primary Wall: Abs Shingle
Story Height: 1 Story	No. Units: 1	Secondary Wall:

Interior Data

Bedrooms: 2	Electric: MAXIMUM	Primary Int Wall:
Full Baths: 1	Heat Type:	Avg Hgt/Floor: 0
Half Baths: 1	Heat Fuel:	Primary Floors: Sing Pine
A/C %: 0%	Heated %: 0%	Sprinkled %: N/A%

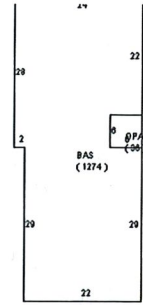

Sketch Area Legend

Sub Area	Description	Area	Fin. Area	Perimeter
BAS	BASE AREA	1274	1274	174
OPAA	Open Porch Attached Average	36	0	24

Special Features and Yard Items

Type	Qty	Units	Year Blt
CHAINLINK 4'	1	220	1995

Current Year Values

Current Values Breakdown

Building:	\$18,500
Land:	\$4,700
Just/Market:	\$23,200
Ag Credit:	\$0
Save Our Homes or 10% Cap:	\$936
Assessed:	\$22,264
Exemption(s):	\$0
Taxable:	\$22,264

Current Year Exemption Value Breakdown

Tax Year	Grant Year	Code	Description	Amount
----------	------------	------	-------------	--------

Current Year Special Assessment Breakdown

Start Year	AssessCode	Units	Description	Amount
1999	0041	1	Fort Pierce Stormwater Charge	\$54.00

This does not necessarily represent the total Special Assessments that could be charged against this property. The total amount charged for special assessments is reflected on the most current tax statement and information is available with the SLC Tax Collector's Office

Historical Values

Year	Just/Market	Assessed	Exemptions	Taxable
2017	\$23,200	\$22,264	\$0	\$22,264
2016	\$20,800	\$20,240	\$0	\$20,240
2015	\$18,400	\$18,400	\$0	\$18,400

Permits

Number	Issue Date	Description	Amount	Fee
RF20051235	Mar 17, 2005	Roof	\$2,200	\$75

Notice: This does not necessarily represent all the permits for this property.
Click the following link to check for additional permit data in Fort Pierce

This information is believed to be correct at this time but it is subject to change and is not warranted.
© Copyright 2018 Saint Lucie County Property Appraiser. All rights reserved.