

Michelle Franklin, CFA -- Saint Lucie County Property Appraiser -- All rights reserved.

Property Identification

Site Address: 100 S 2nd ST
 Sec/Town/Range: 10/35S/40E
 Map ID: 24/10N
 Zoning: C4

Parcel ID: 2410-503-0108-000-6
 Account #: 23085
 Use Type: 1700
 Jurisdiction: Fort Pierce

Ownership

Galleria at Downtown Fort Pierce LLC
 1239 Alton Rd
 Miami Beach, FL 33139

Legal Description

AARON LEE'S MAP OF FORT PIERCE BLK K W 125 FT OF LOT 1 AND A LOT 28 FT BY 111 FT IN NW COR OF LOT2 (MAP 24/10B) (OR 3611-358)

Current Values

Just/Market Value: \$721,600
 Assessed Value: \$655,094
 Exemptions: \$0
 Taxable Value: \$655,094

Taxes for this parcel: SLC Tax Collector's Office
 Download TRIM for this parcel: [Download PDF](#)



Total Areas

Finished/Under Air (SF): 15,274
 Gross Area (SF): 15,610
 Land Size (acres): 0.21
 Land Size (SF): 9,358

Sale History

Date	Book/Page	Sale Code	Deed	Grantor	Price
Mar 4, 2014	3611 / 0358	0312	SP	Harbor Federal Savings + Loan	\$655,000
Jan 1, 1900					\$0

Building Information (1 of 1)

Finished Area: 15,274 SF

Gross Total Area: 15,610 SF

Exterior Data

View:
 Building Type: BANK
 Grade: Y_D
 Story Height: 2 Story

Roof Cover: Tar & Gravel
 Year Built: 1957
 Effective Year: 1965
 No. Units: 10

Roof Structure: BarJst/Rigid Frame:
 Primary Wall: CB Stucco
 Secondary Wall:

Interior Data

Bedrooms: 0
 Full Baths: 0
 Half Baths: 0
 A/C %: 100%

Electric: MAXIMUM
 Heat Type: FredHotAir
 Heat Fuel: ELEC
 Heated %: 100%

Primary Int Wall:
 Avg Hgt/Floor: 0
 Primary Floors: Carpet
 Sprinkled %: 100%

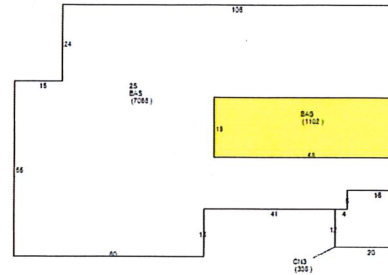

Sketch Area Legend

Sub Area	Description	Area	Fin. Area	Perimeter
2S	ONE FULL STORY OVER BASE (TOTAL 2 FLOORS)	7086	7086	516
BAS	BASE AREA	8188	8188	670
CN3	CANOPY	336	0	76

Special Features and Yard Items

Type	Qty	Units	Year Blt
ELEVATOR	1	3700	1950
VAULT HIGH Q	1	432	1950
CONCRETE LOW	1	2820	2010

Current Year Values

Current Values Breakdown		Current Year Exemption Value Breakdown				
		Tax Year	Grant Year	Code	Description	Amount
Building:	\$585,900					
Land:	\$135,700					
Just/Market:	\$721,600					
Ag Credit:	\$0					
Save Our Homes or 10% Cap:	\$66,506					
Assessed:	\$655,094					
Exemption(s):	\$0					
Taxable:	\$655,094					

Current Year Special Assessment Breakdown

Start Year	AssessCode	Units	Description	Amount
2017	0041	4.9	Fort Pierce Stormwater Charge	\$264.60

This does not necessarily represent the total Special Assessments that could be charged against this property. The total amount charged for special assessments is reflected on the most current tax statement and information is available with the SLC Tax Collector's Office

Historical Values

Year	Just/Market	Assessed	Exemptions	Taxable
2017	\$721,600	\$655,094	\$0	\$655,094
2016	\$733,800	\$595,540	\$0	\$595,540
2015	\$541,400	\$541,400	\$0	\$541,400

Permits

Number	Issue Date	Description	Amount	Fee
F00-000230	Mar 24, 2000	Alterations/Remodeling	\$5,000	\$0
F00-000230A	Mar 24, 2000	Heat and Air Conditioning	\$0	\$0
F00-000547	May 12, 2000	Alterations/Remodeling	\$10,000	\$0
F89000653R	Jun 1, 1989	Roof	\$2,000	\$2,000
F96-001429	Dec 9, 1996	Roof	\$4,800	\$4,800
F99-001143	Sep 27, 1999	Alterations/Remodeling	\$260,000	\$260,000
F99-01143A	Sep 27, 1999	Heat and Air Conditioning	\$0	\$0
MC2002-137	Dec 12, 2002	Air Conditioning Only	\$2,150	\$75
MC2003411	Nov 10, 2003	Air Conditioning Only	\$4,860	\$75
MC200438	Feb 9, 2004	Air Conditioning Only	\$1,983	\$75
MC200693	Apr 27, 2006	Air Conditioning Only	\$4,527	\$75
RF20051719	Apr 22, 2005	Roof	\$4,000	\$50
BP-100192	Feb 3, 2010	Air Conditioning Only	\$19,000	\$157
BP09-1391	Sep 11, 2009	Awning/Shutters	\$500	\$62
BP09-1402	Sep 14, 2009	Alterations/Remodeling	\$0	\$174
BP09-1403	Sep 14, 2009	Alterations/Remodeling	\$2,300	\$100
BP09-1405	Sep 14, 2009	Alterations/Remodeling	\$2,300	\$100
BP03-5159	Feb 5, 2014	Air Conditioning Only	\$4,860	\$135
BP04-6128	Feb 5, 2014	Air Conditioning Only	\$1,983	\$135
BP06-23455	Feb 5, 2014	Air Conditioning Only	\$0	\$135
BP10-0192	Feb 5, 2014	Air Conditioning Only	\$19,000	\$257
BP99-0290	Feb 5, 2014	Air Conditioning Only	\$2,408	\$135
BP99-0308	Feb 11, 2014	Electric	\$680	\$129
BP14-1287	May 16, 2014	Demolition	\$3,150	\$608
BP14-1287	Aug 1, 2014	Electric	\$3,150	\$75
P14-1287	Aug 1, 2014	Demolition	\$3,150	\$308
BP14-1287	Nov 14, 2014	Demolition	\$3,150	\$355
BP15-1443	Jul 8, 2015	Fence	\$250	\$162
BP15-0908	May 13, 2015	Site Work	\$19,000	\$226
BP15-0908	Nov 17, 2015	Site Work	\$19,000	\$246
BP14-2983	Jan 22, 2015	Alterations/Remodeling	\$55,000	\$1,221
BP16-1454	May 16, 2016	Fence	\$200	\$0
BP16-3022	Dec 19, 2016	Interior Office Buildout	\$1,131	\$0
BP16-2653	Sep 29, 2016	Air Conditioning Only	\$11,400	\$0
BP16-3292	Dec 20, 2016	Plumbing	\$8,000	\$0
BP16-3293	Dec 20, 2016	Plumbing	\$8,000	\$0
BP16-3294	Dec 20, 2016	Plumbing	\$8,000	\$0
BP16-3330	Dec 22, 2016	Electric	\$1,000	\$0
BP17-2936	Dec 1, 2017		\$104,700	\$0

Notice: This does not necessarily represent all the permits for this property.

Click the following link to check for additional permit data in Fort Pierce

This information is believed to be correct at this time but it is subject to change and is not warranted.

© Copyright 2018 Saint Lucie County Property Appraiser. All rights reserved.