

Michelle Franklin, CFA -- Saint Lucie County Property Appraiser -- All rights reserved.

Property Identification

Site Address: 5 Avenue A
 Sec/Town/Range: 10/35S/40E
 Map ID: 24/10N
 Zoning: C-4 - FP

Parcel ID: 2410-503-0041-030-7
 Account #: 23051
 Use Type: 8900
 Jurisdiction: Fort Pierce

Ownership

Ft Pierce City Of
 PO Box 1480
 Fort Pierce, FL 34954

Legal Description

AARON LEE'S MAP OF FORT PIERCE 10 35 40 COMM AT C/L INT OF N 2ND ST AND ORANGE AV RUN N 20 DEG 01 MIN 58 SEC W ALG C/L OF N 2ND AV 431.70 FT TO INT WITH EXT OF SLY R/W AV C, TH N 70 DEG 01 MIN 00 SEC E ALG SD SLY R/W 537.03 FT TO ELY R/W INDIAN RIVER DR AND POB, TH RUN N 20 DEG 00 DEG 57 MIN W ALG SD R/W 202.34 FT, TH S 78 DEG 27 MIN 08 SEC W 84.79 FT, TH N 14 DEG 54 MIN 14 SEC E 60.87 FT, TH N 75 DEG 05 MIN 46 SEC W 5 FT, TH N 06 DEG 45 MIN 22 SEC W 55 FT, TH N 69 DEG 59 MIN 03 SEC E 24 FT, TH N 20 DEG 00 MIN 57 SEC W 116.67 FT, TH N 69 DEG 59 MIN 03 SEC E 50.67 FT, TH N 19 DEG 46 MIN 27 SEC W 120.05 FT, TH S 72 DEG 49 MIN 48 SEC W 19.10 FT, TH N 20 DEG 00 MIN 35 SEC W 35.64 FT, TH S 69 DEG 59 MIN 03 SEC W 32.10 FT, TH N 20 DEG 00 MIN 57 SEC W 213.95 FT, TH N 19 DEG 46 MIN 23 SEC E 32.33 FT, TH S 20 DEG 01 MIN 36 SEC E 41.30 FT, TH N 69 DEG 59 MIN 03 SEC E 568.73 FT, TH S 74 DEG 57 MIN 04 SEC E 438.78 FT, TH S 18 DEG 23 MIN 57 SEC E 73.29 FT, TH N 70 DEG 23 MIN 03 SEC E 72.70 FT, TH S 15 DEG 32 MIN 53 SEC E 617.50 FT, TH S 74 DEG 27 MIN 07 SEC W 475 FT, TH N 15 DEG 32 MIN 53 SEC W 11.75 FT, TH S 74 DEG 27 MIN 07 SEC W 125 FT, TH N 15 DEG 32 MIN 53 SEC W 15.17 FT, TH N 74 DEG 27 MIN 07 SEC E 125 FT, TH N 15 DEG 32 MIN 53 SEC W 189 FT, TH S 74 DEG 27 MIN 07 SEC W 125 FT, TH S 15 DEG 32 MIN 53 SEC E 111.13 FT, TH S 70 DEG 01 MIN 00 SEC W 392.21 FT TO POB (17.55 AC) (OR 755-270)



Total Areas

Finished/Under Air (SF): 8,639
 Gross Area (SF): 15,435
 Land Size (acres): 7.44
 Land Size (SF): 323,951

Current Values

Just/Market Value: \$4,200,000
 Assessed Value: \$4,200,000
 Exemptions: \$4,200,000
 Taxable Value: \$0

Taxes for this parcel: SLC Tax Collector's Office
 Download TRIM for this parcel: Download PDF

Sale History

| Date | Book/Page | Sale Code | Deed | Grantor | Price |
|-------------|-----------|-----------|------|---------|-------|
| Jan 1, 1900 | | | | | \$0 |

Building Information (1 of 3)

Finished Area: 1,836 SF
 Gross Total Area: 6,150 SF

Exterior Data

| | | |
|-----------------------|-----------------------|---------------------------|
| View: | Roof Cover: Roll Comp | Roof Structure: Gable |
| Building Type: REST | Year Built: 1954 | Frame: |
| Grade: Y_D | Effective Year: 1910 | Primary Wall: Wood/Sheath |
| Story Height: 1 Story | No. Units: 1 | Secondary Wall: |

Interior Data

Half Baths: 0
A/C %: 100%

Heat Fuel: ELEC
Heated %: 100%

Primary Floors: Hardwood
Sprinkled %: 0%

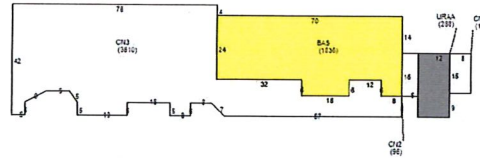

Sketch Area Legend

| Sub Area | Description | Area | Fin. Area | Perimeter |
|----------|-------------------------------|------|-----------|-----------|
| BAS | BASE AREA | 1836 | 1836 | 212 |
| CN1 | CANOPY | 120 | 0 | 46 |
| CN2 | CANOPY | 96 | 0 | 44 |
| CN3 | CANOPY | 3810 | 0 | 422 |
| URAA | Utility Room Attached Average | 288 | 0 | 72 |

Building Information (2 of 3)

Finished Area: 1,280 SF
Gross Total Area: 2,640 SF

Exterior Data

View:
Building Type: UT4
Grade: Y_C
Story Height: 1 Story

Roof Cover: Clay Tile
Year Built: 2008
Effective Year: 2008
No. Units: 1

Roof Structure: Hip
Frame:
Primary Wall: CB Stucco
Secondary Wall:

Interior Data

Bedrooms: 0
Full Baths: 0
Half Baths: 0
A/C %: 0%

Electric: MAXIMUM
Heat Type:
Heat Fuel:
Heated %: 0%

Primary Int Wall:
Avg Hgt/Floor: 0
Primary Floors: CONC GRD
Sprinkled %: 100%

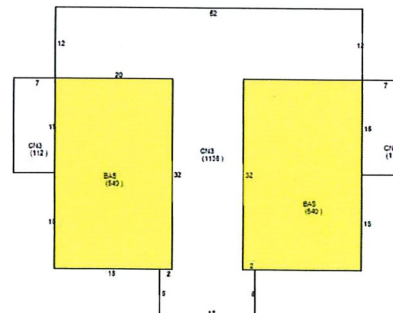

Sketch Area Legend

| Sub Area | Description | Area | Fin. Area | Perimeter |
|----------|-------------|------|-----------|-----------|
| BAS | BASE AREA | 1280 | 1280 | 208 |
| CN3 | CANOPY | 1360 | 0 | 308 |

Building Information (3 of 3)

Finished Area: 5,523 SF

Gross Total Area: 6,645 SF

Exterior Data

| | | |
|-----------------------|----------------------|---------------------------|
| View: | Roof Cover: Metal | Roof Structure: Hip |
| Building Type: HROF | Year Built: 1991 | Frame: |
| Grade: Y_A | Effective Year: 1991 | Primary Wall: Wood/Sheath |
| Story Height: 1 Story | No. Units: 2 | Secondary Wall: |

Interior Data

| | | |
|---------------|-----------------------|------------------------|
| Bedrooms: 0 | Electric: MAXIMUM | Primary Int Wall: |
| Full Baths: 0 | Heat Type: FredHotAir | Avg Hgt/Floor: 0 |
| Half Baths: 0 | Heat Fuel: ELEC | Primary Floors: Carpet |
| A/C %: 100% | Heated %: 100% | Sprinkled %: 0% |

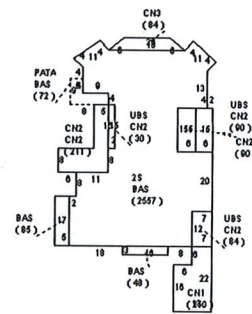

Sketch Area Legend

| Sub Area | Description | Area | Fin. Area | Perimeter |
|----------|---|------|-----------|-----------|
| 2S | ONE FULL STORY OVER BASE (TOTAL 2 FLOORS) | 2557 | 2557 | 282 |
| BAS | BASE AREA | 2762 | 2762 | 408 |
| CN1 | CANOPY | 250 | 0 | 70 |
| CN2 | CANOPY | 716 | 0 | 316 |
| CN3 | CANOPY | 84 | 0 | 55 |
| PATA | Patio Average (Plain Slab) | 72 | 0 | 44 |
| UBS | UPPER BASE AREA/+1 | 204 | 204 | 114 |

Special Features and Yard Items

| Type | Qty | Units | Year Blt |
|--------------|-----|-------|----------|
| ASP2 LOW | 1 | 22875 | 1950 |
| CONCRETE LOW | 1 | 1800 | 1950 |
| BOARDWALK | 1 | 3242 | 1991 |
| CONCRET HIGH | 1 | 320 | 2003 |
| WOOD FEN 6' | 1 | 72 | 2003 |
| WOOD DECK | 1 | 286 | 2003 |
| CONCRETE LOW | 1 | 476 | 2003 |
| COM POOL LOW | 1 | 30 | 2004 |

ASP2 LOW
CONC-SRV STA

1 15600 2008
1 1392 2009

Current Year Values

| Current Values Breakdown | | Current Year Exemption Value Breakdown | | | | |
|----------------------------|-------------|--|------------|------|-------------------|-------------|
| | | Tax Year | Grant Year | Code | Description | Amount |
| Building: | \$444,000 | | | | | |
| Land: | \$3,756,000 | 2018 | | 8000 | City of Ft Pierce | \$4,200,000 |
| Just/Market: | \$4,200,000 | | | | | |
| Ag Credit: | \$0 | | | | | |
| Save Our Homes or 10% Cap: | \$0 | | | | | |
| Assessed: | \$4,200,000 | | | | | |
| Exemption(s): | \$4,200,000 | | | | | |
| Taxable: | \$0 | | | | | |

Current Year Special Assessment Breakdown

| Start Year | AssessCode | Units | Description | Amount |
|------------|------------|-------|-------------------------------|------------|
| 2016 | 0041 | 27.6 | Fort Pierce Stormwater Charge | \$1,490.40 |

This does not necessarily represent the total Special Assessments that could be charged against this property. The total amount charged for special assessments is reflected on the most current tax statement and information is available with the SLC Tax Collector's Office .

Historical Values

| Year | Just/Market | Assessed | Exemptions | Taxable |
|------|-------------|-------------|-------------|---------|
| 2018 | \$4,200,000 | \$4,200,000 | \$4,200,000 | \$0 |
| 2017 | \$4,201,300 | \$4,201,300 | \$4,201,300 | \$0 |
| 2016 | \$4,206,700 | \$4,206,700 | \$4,206,700 | \$0 |

Permits

| Number | Issue Date | Description | Amount | Fee |
|-------------|--------------|------------------------------------|-------------|-------------|
| F00-0001041 | Sep 21, 2000 | Alterations/Remodeling | \$500 | \$0 |
| F01-001306 | Oct 2, 2001 | Fence | \$1,320 | \$0 |
| F87000605E | Oct 1, 1987 | Additions to existing construction | \$100 | \$100 |
| F88000060D | Jan 1, 1988 | Demolition | \$100 | \$100 |
| F88000407D | Apr 1, 1988 | Demolition | \$100 | \$100 |
| F89000272E | Mar 1, 1989 | Additions to existing construction | \$1,000 | \$1,000 |
| F89000725G | Jul 1, 1989 | Additions to existing construction | \$50,000 | \$50,000 |
| F900000456 | Jun 13, 1990 | Alterations/Remodeling | \$12,000 | \$12,000 |
| F900000564 | Oct 3, 1990 | Commercial New Construction | \$100,000 | \$100,000 |
| F91000210 | Apr 17, 1991 | Commercial New Construction | \$325,000 | \$325,000 |
| F91-000210 | May 24, 1991 | Heat and Air Conditioning | \$14,000 | \$14,000 |
| F920000032 | Feb 21, 1992 | Dock | \$3,000 | \$3,000 |
| F920000033 | Feb 21, 1992 | Dock | \$10,000 | \$10,000 |
| F920001120 | Sep 16, 1992 | Fence | \$2,500 | \$2,500 |
| F94-000164 | Feb 17, 1994 | Dock | \$3,000 | \$3,000 |
| F97-000628 | Jul 1, 1997 | Additions to existing construction | \$3,080 | \$3,080 |
| F97-000629 | Jul 1, 1997 | Additions to existing construction | \$484 | \$484 |
| F97-000843 | Aug 19, 1997 | Dock | \$653,000 | \$653,000 |
| F98-001398 | Jan 15, 1998 | Alterations/Remodeling | \$4,000 | \$4,000 |
| F98-000587 | May 8, 1998 | Slab | \$350,000 | \$350,000 |
| F98-000450 | Aug 13, 1998 | Alterations/Remodeling | \$1,400,000 | \$1,400,000 |
| F98-001094 | Aug 26, 1998 | Heat and Air Conditioning | \$0 | \$0 |
| F98-001289 | Oct 16, 1998 | Slab | \$7,500 | \$7,500 |
| F98-001449 | Nov 24, 1998 | Additions to existing construction | \$35,000 | \$0 |
| F98-001439 | Nov 25, 1998 | Alterations/Remodeling | \$3,500 | \$3,500 |

| | | | | |
|--------------|--------------|------------------------------------|-------------|-----------|
| F01-00001306 | Oct 2, 2001 | existing construction | | |
| CA2002-7 | Nov 5, 2002 | Fence | \$1,320 | \$75 |
| | | Additions to existing construction | \$60,000 | \$862 |
| DI2002-14 | Oct 8, 2002 | Demolition | \$0 | \$100 |
| FE2003-64 | Apr 16, 2003 | Wood Fence | \$800 | \$75 |
| FSP2002-10 | May 6, 2003 | Sprinkler System | \$600 | \$75 |
| POOL2003-9 | Jun 5, 2003 | Pool | \$5,000 | \$225 |
| RF2004492 | Oct 4, 2004 | Roof | \$95,000 | \$0 |
| RF200515 | May 25, 2005 | Roof | \$8,000 | \$205 |
| 0700000899 | Jul 25, 2007 | Storm Shutters | \$28,000 | \$280 |
| 0700001201 | Aug 27, 2007 | Alterations/Remodeling | \$0 | \$50 |
| 0700001201 | Aug 27, 2007 | Unknown | \$0 | \$0 |
| 0700001358 | Dec 13, 2007 | Seawall | \$1,650,526 | \$19,056 |
| BP09-0486 | Apr 6, 2009 | Roof | \$30,000 | \$393 |
| BP14-1839 | Jun 30, 2014 | Air Conditioning Only | \$3,400 | \$162 |
| BP14-1383 | Jul 22, 2014 | Gazebo/Greenhouse | \$25,000 | \$283 |
| BP14-0936 | Jun 3, 2014 | Electric | \$2,826 | \$155 |
| BP14-1805 | Aug 27, 2014 | Dock | \$10,993 | \$114,222 |
| BP14-2751 | Dec 1, 2014 | Alterations/Remodeling | \$285,333 | \$2,975 |
| BP15-2330 | Aug 26, 2015 | Electric | \$500 | \$167 |
| BP15-1616 | Oct 13, 2015 | Air Conditioning Only | \$3,400 | \$155 |
| BP15-2857 | Oct 15, 2015 | Air Conditioning Only | \$3,382 | \$155 |
| BP17-0408 | Feb 13, 2017 | Electric | \$1,500 | \$0 |
| BP17-1162 | May 11, 2017 | Electric | \$9,300 | \$0 |
| BP18-2247 | Jul 26, 2018 | Dock | \$243,655 | \$0 |
| BP18-2247 | Jul 26, 2018 | Dock | \$243,655 | \$0 |
| BP18-2249 | Jul 26, 2018 | Fence | \$6,345 | \$0 |

Notice: This does not necessarily represent all the permits for this property.

Click the following link to check for additional permit data in Fort Pierce

This information is believed to be correct at this time but it is subject to change and is not warranted.

© Copyright 2018 Saint Lucie County Property Appraiser. All rights reserved.