

Michelle Franklin, CFA -- Saint Lucie County Property Appraiser -- All rights reserved.

Property Identification

Site Address: 2510 S A1A Parcel ID: 2413-501-0016- Account #: 24326 Sec/Town/Range:
 000-7
 Map ID: 25/18N Zoning: C3 Use Type: 1100 Jurisdiction: Fort Pierce
 18/35S/41E

Ownership

Aljen Inc
 1424 SE McArthur Blvd
 Stuart, FL 34996

Legal Description

SURFSIDE HARBOR BLK 1 LOTS 16 AND 17 (OR 1583-1769)

Current Values

Just/Market: \$39,900 Assessed: \$39,900
 Exemptions: \$0 Taxable: \$39,900

Historical Values 3-year

Year	Just/Market	Assessed	Exemptions	Taxable
2017	\$39,900	\$39,900	\$0	\$39,900
2016	\$40,000	\$40,000	\$0	\$40,000
2015	\$40,000	\$40,000	\$0	\$40,000

Sale History

Date	Book/Page	Sale Code	Deed	Grantor	Price
09-05-2002	1583 / 1769	XX01	WD	Dork Inc,	\$90,000
08-13-2002	1572 / 2153	XX01	CT	Deharder Real Estate Corp,	\$100
03-30-1993	0834 / 1852	XX01	WD	BARNETT BANK OF PALM BCH CO	\$50,000

Primary Building Information

Finished Area of this building: 1,800 SF
 Gross Area of this building: 3,000 SF

Exterior Data

View:	Roof Cover: Tar & Gravel	Roof Structure: BarJst/Rigid	Building Type: STRL
Year Built: 1982	Frame:	Grade: Y_D-	Effective Year: 1982
Primary Wall: CB Stucco	Story Height: 1 Story	No. Units: 1	Secondary Wall:

Interior Data

Bedrooms: 0	A/C %: 0%	Electric: MAXIMUM	Primary Int Wall:
Full Baths: 0	Heated %: 0%	Heat Type: FredHotAir	Avg Hgt/Floor: 0
Half Baths: 0	Sprinkled %: 0%	Heat Fuel: ELEC	Primary Floors: Tile-Ceramic

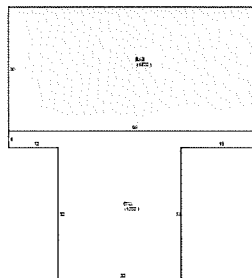

Total Areas

Finished/Under Air (SF):	1,800
Gross Area (SF):	3,000
Land Size (acres):	0.42
Land Size (SF):	18,263
Total Building Count:	1

Special Features and Yard Items

Type	Qty	Units	Year Blt
CONCRETE LOW	1	1200	1970
ASP2 LOW	1	4000	1970

This information is believed to be correct at this time but it is subject to change and is not warranted.
 © Copyright 2018 Saint Lucie County Property Appraiser. All rights reserved.