

**Property Identification**

Site Address: 1217 EASTER AVE  
Map ID: 24/09S  
Parcel ID: 2409-823-0016-000-3  
Zoning: R4  
Account #: 22911  
Use Type: 0800  
Sec/Town/Range: 09/35S/40E  
Jurisdiction: Fort Pierce

**Ownership**

Lucia H Carranza  
6715 NW Pinson Ct  
Port St Lucie, FL 34983

**Legal Description**

CRAMER'S ADDITION BLK 2 E 1/2 OFLOTS 7 AND 8 (OR 3628-216)

**Current Values**

Just/Market: \$54,300  
Exemptions: \$0  
Assessed: \$41,580  
Taxable: \$41,580

**Historical Values 3-year**

Year	Just/Market	Assessed	Exemptions	Taxable
2016	\$54,300	\$41,580	\$0	\$41,580
2015	\$37,800	\$37,800	\$0	\$37,800

**Sale History**

Date	Book/Page	Sale Code	Deed	Grantor	Price
05-05-2014	3628 / 0216	0001	WD	McEntee,John D	\$50,000
03-30-2009	3082 / 2390	0112	SP	Deutsche Bank Nat Tr Co (TR),	\$13,900
01-20-2009	3070 / 1757	0112	CT	Jones,J B	\$100

**Primary Building Information**

Finished Area of this building: 1,408 SF  
Gross Area of this building: 1,687 SF

**Exterior Data**

View:	Roof Cover: Mtl Shingles	Roof Structure: Gable	Building Type: MFH
Year Built: 1925	Frame:	Grade: MFAQ	Effective Year: 1980
Primary Wall: Wood/Sheath	Story Height: 1 Story	No. Units: 2	Secondary Wall:

**Interior Data**

Bedrooms: 0	A/C %: 0%	Electric: AVERAGE	Primary Int Wall:
Full Baths: 2	Heated %: 0%	Heat Type:	Avg Hgt/Floor: 0
Half Baths: 0	Sprinkled %: 0%	Heat Fuel:	Primary Floors: Double Pine

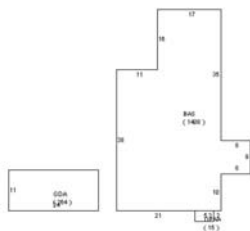

**Total Areas**

Finished/Under Air (SF):	1,408
Gross Area (SF):	1,687
Land Size (acres):	0.16
Land Size (SF):	7,088
Total Building Count:	1

**Special Features and Yard Items**

Type	Qty	Units	Year Blt
------	-----	-------	----------

This information is believed to be correct at this time but it is subject to change and is not warranted.  
© Copyright 2016 Saint Lucie County Property Appraiser. All rights reserved.