

Michelle Franklin, CFA -- Saint Lucie County Property Appraiser -- All rights reserved.

**Property Identification**

Site Address: 1908 OLEANDER BLVD Map ID: 24/15S Parcel ID: 2415-703-0164-000-5 Zoning: R1 Account #: 25057 Use Type: 0100 Sec/Town/Range: 15/35S/40E Jurisdiction: Fort Pierce

**Ownership**

Gonzalo Novas  
Luisa Novas  
7961 NW 14th ST  
Doral, FL 33126-1613

**Legal Description**

SUNRISE ESTATES BLK 14 LOT 9 (OR 3893-1)

**Current Values**

Just/Market: \$104,300 Assessed: \$84,150  
Exemptions: \$0 Taxable: \$84,150

**Historical Values 3-year**

Year	Just/Market	Assessed	Exemptions	Taxable
2018	\$104,300	\$84,150	\$0	\$84,150
2017	\$76,500	\$76,500	\$0	\$76,500
2016	\$53,600	\$46,948	\$0	\$46,948

**Sale History**

Date	Book/Page	Sale Code	Deed	Grantor	Price
06-01-2016	3893 / 0001	0112	DE	Reyes Maria	\$100
07-14-2010	3218 / 1015	0112	SP	US Bank National Assoc	\$30,000
10-23-2009	3211 / 2362	0112	CT	Hill Jr Joseph W	\$100

**Primary Building Information**

Finished Area of this building: 2,509 SF  
Gross Area of this building: 3,507 SF

**Exterior Data**

View:	Roof Cover: Tar & Gravel	Roof Structure: Flat/Shed	Building Type: HC-
Year Built: 1957	Frame:	Grade: C-	Effective Year: 1963
Primary Wall: CB Stucco	Story Height: 1 Story	No. Units: 1	Secondary Wall:

**Interior Data**

Bedrooms: 3	A/C %: 100%	Electric: MAXIMUM	Primary Int Wall:
Full Baths: 2	Heated %: 100%	Heat Type: FredHotAir	Avg Hgt/Floor: 0
Half Baths: 0	Sprinkled %: 0%	Heat Fuel: ELEC	Primary Floors: Carpet

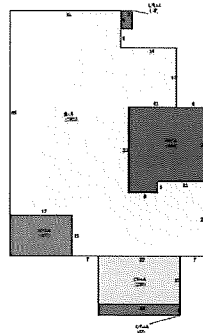

**Total Areas**

Finished/Under Air (SF):	2,509
Gross Area (SF):	3,507
Land Size (acres):	0.25
Land Size (SF):	10,846
Total Building Count:	1

**Special Features and Yard Items**

Type	Qty	Units	Year Blt
Driv-Concret	1	600	1957
CHAINLINK 4'	1	90	1999

This information is believed to be correct at this time but it is subject to change and is not warranted.  
© Copyright 2018 Saint Lucie County Property Appraiser. All rights reserved.