

Michelle Franklin, CFA -- Saint Lucie County Property Appraiser -- All rights reserved.

**Property Identification**

Site Address: 1506 Avenue I Parcel ID: 2404-812-0010-000-2 Account #: 17839 Sec/Town/Range: 04/35S/40E  
 Map ID: 24/04G Zoning: R4 Use Type: 0100 Jurisdiction: Fort Pierce

**Ownership**

Eurilla M Bain  
 1506 Avenue I  
 Fort Pierce, FL 34950

**Legal Description**

EDGEWOOD PARK BLK A LOT 10 (OR 3649-2860)

**Current Values**

Just/Market: \$17,400 Assessed: \$14,498  
 Exemptions: \$14,498 Taxable: \$0

**Historical Values 3-year**

Year	Just/Market	Assessed	Exemptions	Taxable
2017	\$17,400	\$14,498	\$14,498	\$0
2016	\$14,200	\$14,200	\$14,200	\$0
2015	\$14,200	\$14,200	\$0	\$14,200

**Sale History**

Date	Book/Page	Sale Code	Deed	Grantor	Price
11-18-2015	3811 / 2385	0001	WD	De Pineres Eduardo G	\$18,800
06-26-2014	3649 / 2860	0001	WD	Lopez,Ronnette	\$17,000
07-25-2012	3420 / 1226	0001	SP	Rent 2 Own Guys LLC,	\$29,900

**Primary Building Information**

Finished Area of this building: 1,032 SF  
 Gross Area of this building: 1,092 SF

**Exterior Data**

View: Roof Cover: Dim Shingle Roof Structure: Gable Building Type: HD-  
 Year Built: 1948 Frame: Grade: D- Effective Year: 1962  
 Primary Wall: Frm Stucco Story Height: 1 Story No. Units: 1 Secondary Wall:

**Interior Data**

Bedrooms: 3 A/C %: 0% Electric: MAXIMUM Primary Int Wall:  
 Full Baths: 1 Heated %: 0% Heat Type: FrcdHotAir Avg Hgt/Floor: 0  
 Half Baths: 0 Sprinkled %: N/A% Heat Fuel: ELEC Primary Floors: Carpet

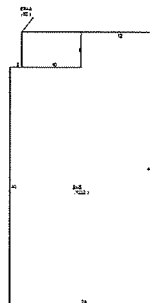

**Total Areas**

Finished/Under Air (SF):	1,032
Gross Area (SF):	1,092
Land Size (acres):	0.12
Land Size (SF):	5,220
Total Building Count:	1

**Special Features and Yard Items**

Type	Qty	Units	Year Blt
CHAINLINK 4'	1	220	1995

This information is believed to be correct at this time but it is subject to change and is not warranted.  
 © Copyright 2018 Saint Lucie County Property Appraiser. All rights reserved.