

Michelle Franklin, CFA -- Saint Lucie County Property Appraiser -- All rights reserved.

Property Identification

Site Address: 715 CITRUS AVE
 Use Type: 0100
 Parcel ID: 2410-707-0016-000-0
 Jurisdiction: Fort Pierce
 Account #: 23639
 Map ID: 24/10S
 Sec/Town/Range: 10/35S/40E
 Zoning: OFFICE COM

Ownership

Roshini Lakram
 5235 NW Jake Ct
 Port St Lucie, FL 34986

Legal Description

SADIE WHEELER'S S/D LOT 16-EX S 25 FT- (MAP 24/10E)
 (OR 1505-2243; 2186-1443)

Current Values

Just/Market: \$31,100
 Assessed: \$18,367
 Exemptions: \$0
 Taxable: \$18,367

Historical Values 3-year

Year	Just/Market	Assessed	Exemptions	Taxable
2018	\$31,100	\$18,367	\$0	\$18,367
2017	\$18,700	\$16,698	\$0	\$16,698
2016	\$16,400	\$15,180	\$0	\$15,180

Sale History

Date	Book/Page	Sale Code	Deed	Grantor	Price
03-01-2005	2186 / 1443	XX01	QC	Gobin Chan	\$10,000
03-15-2002	1505 / 2243	XX02	WD	Charlebois Rene A	\$70,000
10-28-1988	0609 / 1135	XX01	WD	Charlebois Alexina L	\$100

Primary Building Information

Finished Area of this building: 1,069 SF
 Gross Area of this building: 1,469 SF

View:
 Year Built: 1930
 Primary Wall: Wood no Sh

Roof Cover: Metal
 Frame:
 Story Height: 1 Story

Exterior Data

Roof Structure: Gable
 Grade: D
 No. Units: 1

Building Type: HD
 Effective Year: 1950
 Secondary Wall:

Bedrooms: 3
 Full Baths: 2
 Half Baths: 0

A/C %: 0%
 Heated %: 0%
 Sprinkled %: N/A%

Interior Data

Electric: MAXIMUM
 Heat Type:
 Heat Fuel:

Primary Int Wall:
 Avg Hgt/Floor: 0
 Primary Floors: Carpet

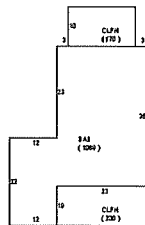

Total Areas

Finished/Under Air (SF):	1,069
Gross Area (SF):	1,469
Land Size (acres):	0.14
Land Size (SF):	6,110
Total Building Count:	1

Special Features and Yard Items

Type	Qty	Units	Year Blt
------	-----	-------	----------

This information is believed to be correct at this time but it is subject to change and is not warranted.
 © Copyright 2018 Saint Lucie County Property Appraiser. All rights reserved.