

Michelle Franklin, CFA -- Saint Lucie County Property Appraiser -- All rights reserved.

Property Identification

Site Address: 355 S OCEAN DR F-304
 Sec/Town/Range: 01/35S/40E
 Map ID: 24/01A
 Zoning: R4A

Parcel ID: 2401-522-0013-000-4
 Account #: 15100
 Use Type: 0400
 Jurisdiction: Fort Pierce

Ownership

Anne B Paglia
 Giacomo Paglia
 Chemin des Traversins 33
 1285 Avusy
 Geneva,
 SWITZERLAND

Legal Description

AVALON BEACH CLUB UNIT F-304 (OR 4065-2163)

Current Values

Just/Market Value: \$167,800
 Assessed Value: \$167,800
 Exemptions: \$0
 Taxable Value: \$167,800

Taxes for this parcel: SLC Tax Collector's Office
 Download TRIM for this parcel: [Download PDF](#)

Total Areas

Finished/Under Air (SF):
 Gross Area (SF):
 Land Size (acres):
 Land Size (SF):

Sale History

Date	Book/Page	Sale Code	Deed	Grantor	Price
Nov 16, 2017	4065 / 2163	0001	WD	Walker John D	\$265,000
Feb 1, 2011	3267 / 2449	0001	WD	Watson Lois R	\$123,500
Apr 1, 1983	0400 / 0121	XX00	CV		\$90,000

Building Information (1 of 1)

Finished Area: 1,257 SF
 Gross Total Area: 1,433 SF

Exterior Data

View:
 Building Type: X008
 Grade: X8E
 Story Height: 1 Story

Roof Cover:
 Year Built: 1982
 Effective Year: 1982
 No. Units: 1

Roof Structure:
 Frame:
 Primary Wall: CB Stucco
 Secondary Wall:

Interior Data

Bedrooms: 2
 Full Baths: 2
 Half Baths: 1

Electric:
 Heat Type:
 Heat Fuel:

Primary Int Wall:
 Avg Hgt/Floor: 0
 Primary Floors:

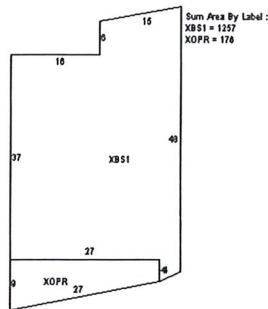

Sketch Area Legend

Sub Area	Description	Area	Fin. Area	Perimeter
XBS1	Base Floor Living Area (Value Calculated)	1257	1257	157
XOPR	Open Porch (Value Calculated)	176	0	67

Special Features and Yard Items

Type	Qty	Units	Year Blt
------	-----	-------	----------

Current Year Values

Current Values Breakdown		Current Year Exemption Value Breakdown				
		Tax Year	Grant Year	Code	Description	Amount
Building:	\$167,800					
Land:	\$0					
Just/Market:	\$167,800					
Ag Credit:	\$0					
Save Our Homes or 10% Cap:	\$0					
Assessed:	\$167,800					
Exemption(s):	\$0					
Taxable:	\$167,800					

Current Year Special Assessment Breakdown

Start Year	AssessCode	Units	Description	Amount
1999	0041	0.6	Fort Pierce Stormwater Charge	\$32.40

This does not necessarily represent the total Special Assessments that could be charged against this property. The total amount charged for special assessments is reflected on the most current tax statement and information is available with the SLC Tax Collector's Office

Historical Values

Year	Just/Market	Assessed	Exemptions	Taxable
2018	\$167,800	\$167,800	\$0	\$167,800
2017	\$129,800	\$129,800	\$0	\$129,800
2016	\$119,700	\$118,140	\$0	\$118,140

Permits

Number	Issue Date	Description	Amount	Fee
0800001152	Oct 30, 2008	Alterations/Remodeling	\$526	\$50
BP09-0568	May 12, 2009	Storm Shutters	\$2,478	\$50

Notice: This does not necessarily represent all the permits for this property. Click the following link to check for additional permit data in Fort Pierce