

Property Identification

Site Address: 608 S 6th ST Parcel ID: 2410-715-0012-000-7 Account #: 23819 Sec/Town/Range: 10/35S/40E
 Map ID: 24/10S Zoning: R4 Use Type: 0100 Jurisdiction: Fort Pierce

Ownership

Isabelle Schillo
 Thomas Schillo
 298 Ponce Deleon St
 Royal Palm Beach, FL 33411

Legal Description

WOODBINE S/D LOT 12 (MAP 24/10F)(OR 2125-2549)

Current Values

Just/Market: \$37,800 Assessed: \$28,072
 Exemptions: \$0 Taxable: \$28,072

Historical Values 3-year

Year	Just/Market	Assessed	Exemptions	Taxable
2018	\$37,800	\$28,072	\$0	\$28,072
2017	\$30,400	\$25,520	\$0	\$25,520
2016	\$23,200	\$23,200	\$0	\$23,200

Sale History

Date	Book/Page	Sale Code	Deed	Grantor	Price
11-12-2004	2125 / 2549	XX00	WD	Close Justin J	\$67,000
03-16-2004	1969 / 0964	XX00	WD	Mora Alfredo	\$50,000
11-04-1996	1044 / 1015	XX00	WD	Gorie William J	\$15,000

Primary Building Information

Finished Area of this building: 1,003 SF
 Gross Sketched Area: 1,420 SF

View:
 Year Built: 1925
 Primary Wall: Frm Stucco

Roof Cover: Dim Shingle
 Frame:
 Story Height: 1 Story

Exterior Data

Roof Structure: Flat/Shed
 Grade: D-
 No. Units: 1

Building Type: HD-
 Effective Year: 1970
 Secondary Wall:

Bedrooms: 2
 Full Baths: 1
 Half Baths: 0

A/C %: 0%
 Heated %: 0%
 Sprinkled %: 0%

Interior Data

Electric: AVERAGE
 Heat Type:
 Heat Fuel:

Primary Int Wall:
 Avg Hgt/Floor: 0
 Primary Floors: Sing Pine

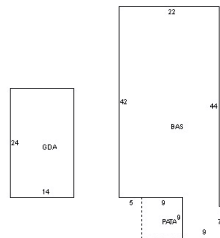

Total Areas

Finished/Under Air (SF):	1,003
Gross Sketched Area (SF):	1,420
Land Size (acres):	0.11
Land Size (SF):	4,900
Total Building Count:	1

Special Features and Yard Items

Type	Qty	Units	Year Blt
------	-----	-------	----------