

Michelle Franklin, CFA -- Saint Lucie County Property Appraiser -- All rights reserved.

**Property Identification**

Site Address: 808 DELAWARE AVE  
 Sec/Town/Range: 10/35S/40E  
 Map ID: 24/10S  
 Zoning: HistoricDi

Parcel ID: 2410-707-0008-000-1  
 Account #: 23631  
 Use Type: 1700  
 Jurisdiction: Fort Pierce

**Ownership**

Michael Joseph Menard  
 806 Delaware AVE  
 Fort Pierce, FL 34950

**Legal Description**

SADIE WHEELER'S S/D LOT 8 (MAP 24/10E)

**Current Values**

Just/Market Value: \$47,300  
 Assessed Value: \$47,300  
 Exemptions: \$0  
 Taxable Value: \$47,300

Taxes for this parcel: SLC Tax Collector's Office  
 Download TRIM for this parcel: [Download PDF](#)



**Total Areas**

Finished/Under Air (SF): 644  
 Gross Sketched Area (SF): 740  
 Land Size (acres): 0.16  
 Land Size (SF): 7,000

**Sale History**

Date	Book/Page	Sale Code	Deed	Grantor	Price
Sep 5, 2018	4180 / 0884	0001	WD	Stallings Glenn A	\$67,000
Jul 22, 2004	2025 / 0584	XX00	WD	Cook + Menard Architecture Inc	\$65,000
Jan 4, 2001	1355 / 2369	XX02	WD	Perkinson Maurice L	\$73,500
Dec 1, 1982	0392 / 0797	XX01	CV		\$0

**Building Information (1 of 1)**

Finished Area: 644 SF

Gross Sketched Area: 740 SF

**Exterior Data**

View:	Roof Cover: Enam Metal	Roof Structure: Gable
Building Type: LROF	Year Built: 1924	Frame:
Grade: Y_C	Effective Year: 1985	Primary Wall: Wood no Sh
Story Height: 1 Story	No. Units: 2	Secondary Wall:

**Interior Data**

Bedrooms: 0	Electric: MAXIMUM	Primary Int Wall:
Full Baths: 0	Heat Type: FredHotAir	Avg Hgt/Floor: 0
Half Baths: 0	Heat Fuel: ELEC	Primary Floors: Sing Pine
A/C %: 100%	Heated %: 100%	Sprinkled %: 0%

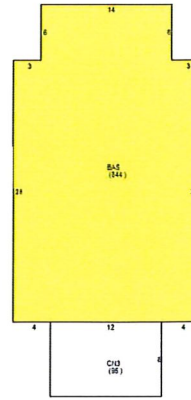

**Sketch Area Legend**

Sub Area	Description	Area	Fin. Area	Perimeter
BAS	BASE AREA	644	644	108
CN3	CANOPY	96	0	40

**Special Features and Yard Items**

Type	Qty	Units	Year Blt
CONCRETE LOW	1	1740	2001
CONCRET RAMP	1	180	2001

**Current Year Values**

Current Values Breakdown

Building:	\$22,800
Land:	\$24,500
Just/Market:	\$47,300
Ag Credit:	\$0
Save Our Homes or 10% Cap:	\$0
Assessed:	\$47,300
Exemption(s):	\$0
Taxable:	\$47,300

Current Year Exemption Value Breakdown

Tax Year	Grant Year	Code	Description	Amount
----------	------------	------	-------------	--------

Current Year Special Assessment Breakdown

Start Year	AssessCode	Units	Description	Amount
1999	0041	1	Fort Pierce Stormwater Charge	\$54.00

This does not necessarily represent the total Special Assessments that could be charged against this property. The total amount charged for special assessments is reflected on the most current tax statement and information is available with the SLC Tax Collector's Office

**Historical Values**

Year	Just/Market	Assessed	Exemptions	Taxable
2018	\$47,300	\$47,300	\$0	\$47,300
2017	\$47,200	\$47,200	\$0	\$47,200
2016	\$44,600	\$44,600	\$0	\$44,600

Number	Issue Date	Description	Amount	Fee
F00-000027	Jan 9, 2001	Demolition	\$0	\$0
F00-000028	Jan 30, 2001	Alterations/Remodeling	\$20,000	\$0
F00-000028	Jan 30, 2001	Roof	\$0	\$0
BP16-2895	Nov 16, 2016	Exterior Siding	\$1,500	\$0

Notice: This does not necessarily represent all the permits for this property.

Click the following link to check for additional permit data in Fort Pierce

---

This information is believed to be correct at this time but it is subject to change and is not warranted.  
© Copyright 2019 Saint Lucie County Property Appraiser. All rights reserved.