



APPLICATION FOR ANNEXATION

Annexation applications will require the adoption of an ordinance which will require a public meeting before the Planning Board and two public hearings before the City Commission.

Application submission shall include the following:

- **TRC (*Initial Submission):** One (1) original and (8) paper copies of the application and support documents and provide one (1) electronic copy of the application packet as described below.
- **Planning Board:** One (1) original and (16) paper copies of the application and support documents and provide one (1) electronic copy of the application packet as described below.
- **City Commission:** One (1) original and (11) paper copies of the application and support documents and provide one (1) electronic copy of the application packet as described below.

In addition to a complete application, packets shall include:

- Warranty Deed
- Current Survey (completed within the last 12 months)

1. Address: 2402 Valencia Avenue
2. Legal description of real property for which annexation is being requested:
PARADISE PARK BLK 5 LOT 15 (OR 920-301)

 Property Tax ID: 1433-701-0085-000-4
3. Size of described property: 0.19 acres
4. Project description: The property owner, Ionis M. Jefferson-Swoope would like to voluntarily be annexed into the City of Fort Pierce. The property will be annexed into the City of Fort Pierce with a Zoning designation of R-1, Low Density Residential and a Future Land Use designation of RL, Low Density Residential

5. Current St. Lucie County Future Land Use Designation: RU, Residential Urban, 5 du/ac
6. Current St. Lucie County Zoning: RS-4, Single Family, 4 du/ac
7. Is this a Historic property? No
8. Appraised value: \$72,100
9. Name of Owner(s): Ionis M. Jefferson-Swoope
 Signature of Owner(s): _____
 Mailing Address: 2402 Valencia Avenue
 City Fort Pierce State Florida Zip 34946
 Phone 772-672-1179 Fax _____

10. Name of Representative: _____

Signature of representative: W. Jefferson Awoope

Mailing Address: PO 2402 Valencia Ave

City) Fort Pierce State FL Zip 34946

Phone (772) 672-1179 Fax _____

E-mail: Honeydrop3199@gmail.com

INTAKE MEETINGS ARE REQUIRED FOR ALL SUBMITTALS. CALL (772) 467-3729

OFFICE USE:		
DATE RECEIVED: _____	Signed: _____	
File Number: _____	Check No: _____	Receipt No: _____
TRC Review: _____	Planning Board Review: _____	City Commission: _____
Ordinance No: _____	Date Approved: _____	

Michelle Franklin, CFA -- Saint Lucie County Property Appraiser -- All rights reserved.

Property Identification

Site Address: 2402 VALENCIA AVE
 Sec/Town/Range: 33/34S/40E
 Map ID: 14/33S
 Zoning: RS-4 Count

Parcel ID: 1433-701-0085-000-4
 Account #: 11663
 Use Type: 0100
 Jurisdiction: Saint Lucie County

Ownership

Ionis M Jefferson-Swoope
 2300 VALENCIA AVE
 Fort Pierce, FL 34946

Legal Description

PARADISE PARK BLK 5 LOT 15 (OR 920-301)

Current Values

Just/Market Value: \$85,800
 Assessed Value: \$85,800
 Exemptions: \$0
 Taxable Value: \$85,800



Total Areas

Finished/Under Air (SF): 1,158
 Gross Sketched Area (SF): 1,562
 Land Size (acres): 0.19
 Land Size (SF): 8,100

Property taxes are subject to change upon change of ownership.

- Past taxes are not a reliable projection of future taxes.
- The sale of a property will prompt the removal of all exemptions, assessment caps, and special classifications.

Taxes for this parcel: SLC Tax Collector's Office
 Download TRIM for this parcel: [Download PDF](#)

Sale History

Date	Book/Page	Sale Code	Deed	Grantor	Price
Sep 9, 1994	0920 / 0301	XX01	WD	Lee Gloria J P	\$63,000
Dec 15, 1992	0821 / 2416	XX00	WD	John H Parker	\$3,000
Jul 1, 1987	0551 / 2847	XX00	CV		\$2,700
Nov 1, 1981	0393 / 0491	XX00	CV		\$2,400
Sep 1, 1981	0362 / 2898	XX01	CV		\$0

Building Information (1 of 1)

Finished Area: 1,158 SF

Gross Sketched Area: 1,562 SF

Exterior Data

View:	Roof Cover: Dim Shingle	Roof Structure: Gable
Building Type: HC-	Year Built: 1993	Frame:
Grade: C-	Effective Year: 1993	Primary Wall: CB Stucco
Story Height: 1 Story	No. Units: 1	Secondary Wall:

Interior Data

Bedrooms: 3	Electric: MAXIMUM	Primary Int Wall:
Full Baths: 2	Heat Type: FredHotAir	Avg Hgt/Floor: 0
Half Baths: 0	Heat Fuel: ELEC	Primary Floors: Carpet
A/C %: 100%	Heated %: 100%	Sprinkled %: 0%

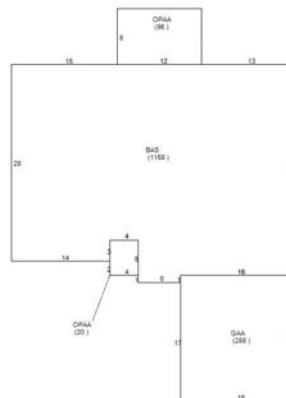

Sketch Area Legend

Sub Area	Description	Area	Fin. Area	Perimeter
BAS	BASE AREA	1158	1158	148
GAA	Garage Attached Average	288	0	68
OPAA	Open Porch Attached Average	116	0	58

Special Features and Yard Items

Type	Qty	Units	Year Blt
------	-----	-------	----------

Current Year Values

Current Values Breakdown

Building:	\$78,500
Land:	\$7,300
Just/Market:	\$85,800
Ag Credit:	\$0
Save Our Homes or 10% Cap:	\$0
Assessed:	\$85,800
Exemption(s):	\$0
Taxable:	\$85,800

Current Year Exemption Value Breakdown

Tax Year	Grant Year	Code	Description	Amount
----------	------------	------	-------------	--------

Current Year Special Assessment Breakdown

Start Year	AssessCode	Units	Description	Amount
2009	2009	12	County Solid Waste	\$276.14
2010	9010	1	Paradise Park Street Light Paradise Park Street Li	\$26.46

This does not necessarily represent the total Special Assessments that could be charged against this property. The total amount charged for special assessments is reflected on the most current tax statement and information is available with the SLC Tax Collector's Office .

Historical Values

Year	Just/Market	Assessed	Exemptions	Taxable
2019	\$85,800	\$85,800	\$0	\$85,800
2018	\$75,900	\$46,289	\$25,000	\$21,289
2017	\$72,100	\$45,337	\$25,000	\$20,337

Permits

Number	Issue Date	Description	Amount	Fee
C93-00980	Mar 2, 1993	Residential New Construction	\$58,338	\$58,338

Notice: This does not necessarily represent all the permits for this property.

[Click the following link to check for additional permit data in Saint Lucie County](#)

All information is believed to be correct at this time, but is subject to change and is provided without any warranty.
© Copyright 2019 Saint Lucie County Property Appraiser. All rights reserved.