



RECEIVED

JUL 30 2019

COA# 19-52

Bldg. Permit # \_\_\_\_\_

**Certificate of Appropriateness Application**

CITY OF FORT PIERCE  
PLANNING & ZONING

**Building & Site Information**

Address of the Site: 100 S 2<sup>ND</sup> STREET, FORT PIERCE, FL 34950

Parcel ID #: \_\_\_\_\_

Type of Designation:  Contributing  Non-contributing Site within the  Historic District

Individually Designated Site, City Commission Resolution No. \_\_\_\_\_

**Property Owner/ Applicant Information**

Property Owner(s)  
Name(s): GALLERIA of PIERCE Harbor  
Mailing Address: 100 S 2<sup>ND</sup> Street FORT PIERCE FL 34950  
Phone Number(s): 954-670-7173 Email: SIGNATURESNL@AOL.COM

Applicant  
Name(s): \_\_\_\_\_  
Mailing Address: \_\_\_\_\_  
Phone Number(s): \_\_\_\_\_ Email: \_\_\_\_\_

Representative  
Name(s): JOE ZITO  
Mailing Address: 118 S US 1 FORT PIERCE, FL 34950  
Phone Number(s): 772-390-1113 Email: SIGNATURESNL@AOL.COM

*Property Owner(s) Acknowledgements:- This application will not be considered complete without the signature of all property owners of record, which shall serve as an acknowledgement of the submission of this application. The property owner's signature below shall also authorize the Applicant (if other than the property owner) and/or Representative to act in his/her behalf for the purposes of seeking approval for the application described herein. The undersigned consents to inspection and photographing of the subject property by the Historic Preservation staff for purposes of consideration of this Application and/or presentation to the Historic Preservation Board.*

I / We, Gus Gutierrez as Owner(s) of the subject property do hereby authorize the filing of this application on my/our behalf.

  
Signature of Owner

7-30-19  
Date

**Description of Requested Work**

Please indicate the type of work requested:

- Fence
- Shed
- Door(s)
- Roof
- Window(s)
- Signage
- Shutter(s)
- Porch
- Rehabilitation
- New Construction
- Demolition
- Relocation

Site Improvements (describe) Adding 9" BLACK DIMENSIONAL letters  
 Other (describe) by BARBER POLE Logo ABOVE WINDOWS @ OFFICE SPACE BUSINESS

Please provide a detailed description of the proposed work to be performed:  
LETTERS ARE FABRICATED FROM Gemini Sign Company  
LETTERS AND 1" THICK IN DIMENSION  
~~BARBER POLE TO~~

Have other alterations been made to the site within the last 12 months?  No  Yes, INDEX WALL

Will the proposed work require a Zoning Variance?  No  Yes, Code Section(s): \_\_\_\_\_

**Application Requirements**

- \$10.00 Application fee
- Site Plan with dimensions.
- Architectural Drawings:
  - Drawings should show all current and proposed floor plans and elevations, fences, walls, and any other landscape features.
  - Drawings should indicate materials to be used.
- Photos - One (1) color photograph of the main façade of the site and photographs of any areas affected by the proposed project.
- Material(s) specifications and/or sample(s)
- Color samples.
- Demolition – Plans for what will be taking the demolished structure's place should be submitted.

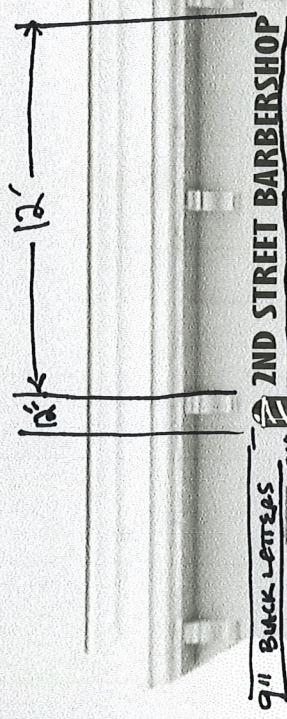

2ND STREET BARBERSHOP

Graphic in window  
→  
Graphic in window  
space

3/4" - 1/2" LEGS  
RED  
WHITE  
DARK

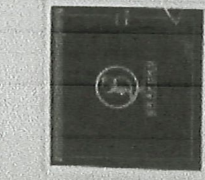
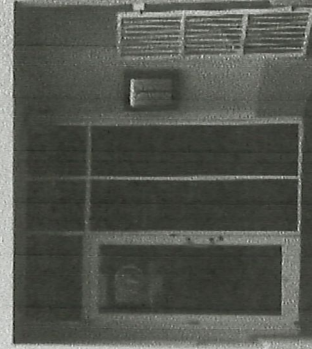

2ND STREET BARBERSHOP

108

