



Bldg. Permit # _____

COA# 19-53

Certificate of Appropriateness Application

Building & Site Information

Address of the Site: 239 S INDIAN RIVER PR,

Parcel ID #: _____

Type of Designation: Contributing Non-contributing Site within the Downtown Historic District

Individually Designated Site, City Commission Resolution No. _____

Property Owner/ Applicant Information

Property Owner(s)

Name(s): BOSTON HOUSE OF FT. PIERCE LLC,

Mailing Address: 4560 S 25TH ST Ft. Pierce FL 34981

Phone Number(s): 678-517-7493 Email: shellynjohn90@gmail.com

Applicant

Name(s): MARTIN MOHR / PRESIDENT OF THE LLC

Mailing Address: 4560 S 25TH ST, FT PIERCE FL 34981

Phone Number(s): 678-517-7493 Email: SHOLLYNJOHN90@GMAIL.COM

Representative

Name(s): MIKEMENARD w/ ARCHITECTONIC INC

Mailing Address: 806 DELAWARE AVE FT PIERCE FL 34958

Phone Number(s): 772 460 7751 Email: M.MENARD@ARCHITECTONIC.INC.COM

Property Owner(s) Acknowledgements:- This application will not be considered complete without the signature of all property owners of record, which shall serve as an acknowledgement of the submission of this application. The property owner's signature below shall also authorize the Applicant (if other than the property owner) and/or Representative to act in his/her behalf for the purposes of seeking approval for the application described herein. The undersigned consents to inspection and photographing of the subject property by the Historic Preservation staff for purposes of consideration of this Application and/or presentation to the Historic Preservation Board.

I/ We, Martin Mohr as Owner(s) of the subject property do hereby authorize the filing of this application on my/our behalf.

Martin Mohr

Signature of Owner

08/08/2019

Date

Description of Requested Work

Please indicate the type of work requested:

Fence

Shed

Door(s)

Roof **DORMER**

Window(s)

Signage

Shutter(s)

~~Porch~~ **COURTYARD**

Rehabilitation

New Construction

Demolition

Relocation

Site Improvements (describe) PAVER COURTYARD / RAILING / LANDSCAPING

Other (describe) MODIFICATION TO WINDOW & ADD DORMER

Please provide a detailed description of the proposed work to be performed:

CHANGE 3RD FLOOR FRONT WINDOWS / ADD DORMER TO
NORTH SIDE OF ROOF / CONSTRUCT PAVER COURTYARD

Have other alterations been made to the site within the last 12 months? No Yes, _____

Will the proposed work require a Zoning Variance? No Yes, Code Section(s): _____

Application Requirements

\$10.00 Application fee

Site Plan with dimensions.

Architectural Drawings:

- Drawings should show all current and proposed floor plans and elevations, fences, walls, and any other landscape features.
- Drawings should indicate materials to be used.

Photos - One (1) color photograph of the main façade of the site and photographs of any areas affected by the proposed project.

Material(s) specifications and/or sample(s)

Color samples.

Demolition - Plans for what will be taking the demolished structure's place should be submitted.







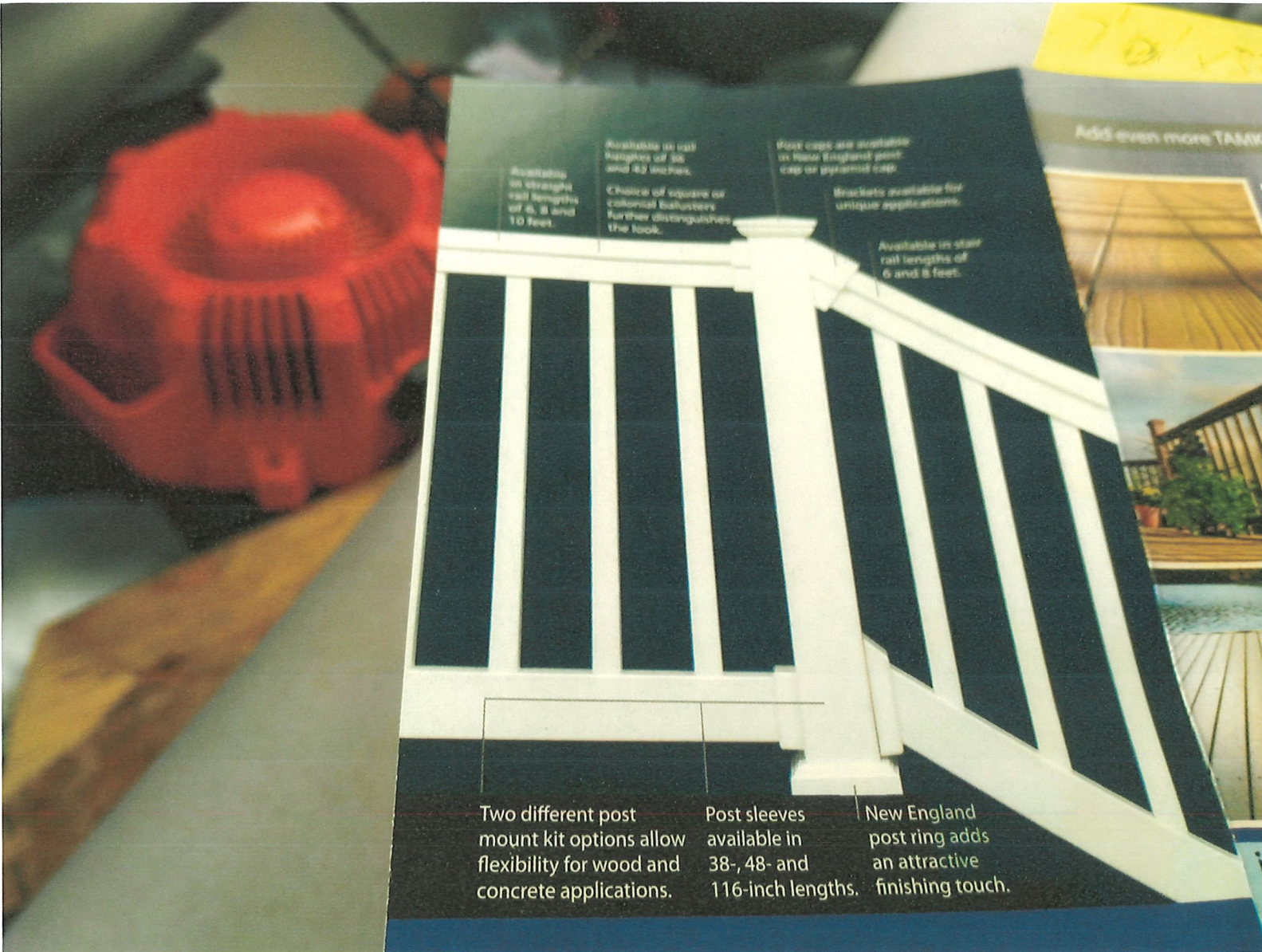

Available in straight rail lengths of 6, 8 and 10 feet.

Available in rail heights of 36 and 42 inches.

Choice of square or colonial balusters further distinguishes the look.

Post caps are available in New England post cap or pyramid cap.

Brackets available for unique applications.

Available in stair rail lengths of 6 and 8 feet.

Add even more TASK



Two different post mount kit options allow flexibility for wood and concrete applications.

Post sleeves available in 38-, 48- and 116-inch lengths.

New England post ring adds an attractive finishing touch.



DEPARTMENT OF REGULATORY AND ECONOMIC RESOURCES (RER)
BOARD AND CODE ADMINISTRATION DIVISION

NOTICE OF ACCEPTANCE (NOA)

MIAMI-DADE COUNTY
PRODUCT CONTROL SECTION
11805 SW 26 Street, Room 208
T (786) 315-2590 F (786) 315-2599
www.miamidade.gov/economy

PGT Industries, Inc.
1070 Technology Drive
North Venice, FL 34275

SCOPE:

This NOA is being issued under the applicable rules and regulations governing the use of construction materials. The documentation submitted has been reviewed and accepted by Miami-Dade County RER - Product Control Section to be used in Miami Dade County and other areas where allowed by the Authority Having Jurisdiction (AHJ).

This NOA shall not be valid after the expiration date stated below. The Miami-Dade County Product Control Section (In Miami Dade County) and/or the AHJ (in areas other than Miami Dade County) reserve the right to have this product or material tested for quality assurance purposes. If this product or material fails to perform in the accepted manner, the manufacturer will incur the expense of such testing and the AHJ may immediately revoke, modify, or suspend the use of such product or material within their jurisdiction. RER reserves the right to revoke this acceptance, if it is determined by Miami-Dade County Product Control Section that this product or material fails to meet the requirements of the applicable building code.

This product is approved as described herein, and has been designed to comply with the Florida Building Code, including the High Velocity Hurricane Zone.

DESCRIPTION: Series "SH-5500" PVC Single Hung Window – L.M.I.

APPROVAL DOCUMENT: Drawing No. MD-SH5500-01 titled "Single Hung Window Installation - LM", sheets 1 through 13 of 13, dated 05/15/15, with revision B dated 06/06/17, prepared by manufacturer, signed and sealed by Anthony Lynn Miller, P.E., bearing the Miami-Dade County Product Control Revision stamp with the Notice of Acceptance number and expiration date by the Miami-Dade County Product Control Section.

MISSILE IMPACT RATING: Large and Small Missile Impact Resistant

LABELING: Each unit shall bear a permanent label with the manufacturer's name or logo, city, state, model/series, and following statement: "Miami-Dade County Product Control Approved", unless otherwise noted herein.

RENEWAL of this NOA shall be considered after a renewal application has been filed and there has been no change in the applicable building code negatively affecting the performance of this product.

TERMINATION of this NOA will occur after the expiration date or if there has been a revision or change in the materials, use, and/or manufacture of the product or process. Misuse of this NOA as an endorsement of any product, for sales, advertising or any other purposes shall automatically terminate this NOA. Failure to comply with any section of this NOA shall be cause for termination and removal of NOA.

ADVERTISEMENT: The NOA number preceded by the words Miami-Dade County, Florida, and followed by the expiration date may be displayed in advertising literature. If any portion of the NOA is displayed, then it shall be done in its entirety.

INSPECTION: A copy of this entire NOA shall be provided to the user by the manufacturer or its distributors and shall be available for inspection at the job site at the request of the Building Official.

This NOA revises NOA# 16-0714.03 and consists of this page 1 and evidence pages E-1 and E-2, as well as approval document mentioned above.

The submitted documentation was reviewed by Manuel Perez, P.E.



MP
11/20/17

NOA No. 17-0630.05
Expiration Date: July 30, 2020
Approval Date: November 30, 2017
Page 1

PGT Industries, Inc.

NOTICE OF ACCEPTANCE: EVIDENCE SUBMITTED

A. DRAWINGS

1. Manufacturer's die drawings and sections.
(Submitted under previous NOA No. 15-0519.05)
2. Drawing No. **MD-SH5500-01** titled "Single Hung Window Installation - LM", sheets 1 through 13 of 13, dated 05/15/15, with revision B dated 06/06/17, prepared by manufacturer, signed and sealed by Anthony Lynn Miller, P.E.

B. TESTS

1. Test reports on: 1) Uniform Static Air Pressure Test, Loading per FBC, TAS 202-94
2) Large Missile Impact Test per FBC, TAS 201-94
3) Cyclic Wind Pressure Loading per FBC, TAS 203-94
along with marked-up drawings and installation diagram of a PVC sliding glass door, a PVC fixed window and an aluminum sliding glass door, using: Kodispace 4SG TPS spacer system, Duraseal® spacer system, Super Spacer® NXT™ spacer system and XL Edge™ spacer system at insulated glass, prepared by Fenestration Testing Laboratory, Inc., Test Reports No. **FTL-8717**, **FTL-8968** and **FTL-8970**, dated 11/16/15, 06/07/16 and 06/02/16 respectively, all signed and sealed by Idalmis Ortega, P.E.
(Submitted under previous NOA No. 16-0714.03)
2. Test reports on: 1) Air Infiltration Test, per FBC, TAS 202-94
2) Uniform Static Air Pressure Test, Loading per FBC TAS 202-94
3) Water Resistance Test, per FBC, TAS 202-94
4) Forced Entry Test, per FBC 2411.3.2.1, and TAS 202-94
5) Large Missile Impact Test per FBC, TAS 201-94
6) Cyclic Wind Pressure Loading per FBC, TAS 203-94
along with marked-up drawings and installation diagram of a series 5500 PVC single hung window, prepared by Fenestration Testing Laboratory, Inc., Test Report No. **FTL-7964**, dated 11/15/14, signed and sealed by Idalmis Ortega, P.E.
(Submitted under NOA No. 15-0519.05)
3. Test reports on: 1) Uniform Static Air Pressure Test, Loading per FBC TAS 202-94
2) Large Missile Impact Test per FBC, TAS 201-94
3) Cyclic Wind Pressure Loading per FBC, TAS 203-94
along with marked-up drawings and installation diagram of a series 5500 PVC single hung window, prepared by Fenestration Testing Laboratory, Inc., Test Report No. **FTL-7966**, dated 08/21/14, signed and sealed by Idalmis Ortega, P.E.
(Submitted under NOA No. 15-0519.05)

C. CALCULATIONS

1. Anchor verification calculations and structural analysis, complying with **FBC 5th Edition (2014)**, dated 05/15/15 and 08/29/17, prepared by manufacturer, signed and sealed by Anthony Lynn Miller, P.E. *(Submitted under NOA No. 15-0519.05)*

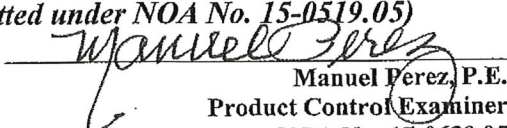
Manuel Perez, P.E.
Product Control Examiner
NOA No. 17-0630.05
Expiration Date: July 30, 2020
Approval Date: November 30, 2017

PGT Industries, Inc.

NOTICE OF ACCEPTANCE: EVIDENCE SUBMITTED

C. CALCULATIONS (CONTINUED)

2. Glazing complies with ASTM E1300-09

D. QUALITY ASSURANCE

1. Miami-Dade Department of Regulatory and Economic Resources (RER).

E. MATERIAL CERTIFICATIONS (CONTINUED)

1. Notice of Acceptance No. 16-1117.01 issued to Kuraray America, Inc. for their "Trosifol® Ultraclear, Clear and Color PVB Glass Interlayers" dated 01/19/17, expiring on 07/08/19.
2. Notice of Acceptance No. 14-0916.11 issued to Kuraray America, Inc. for their "SentryGlas® (Clear and White) Glass Interlayers" dated 06/25/15, expiring on 07/04/18.
3. Notice of Acceptance No. 16-0712.03 issued to ENERGI Fenestration Solutions USA for their "White Rigid PVC Exterior Extrusions for Windows and Doors" dated 08/10/17, expiring on 02/28/18.
4. Notice of Acceptance No. 16-0712.04 issued to ENERGI Fenestration Solutions USA, Inc. for their "Bronze and Lighter Shades of Cap Coated White Rigid PVC Exterior Extrusions for Windows and Doors" dated 09/15/16, expiring on 04/16/20.
5. Notice of Acceptance No. 16-0712.05 issued to ENERGI Fenestration Solutions USA, Inc. for their "Performance Core Rigid PVC Exterior Extrusions for Windows and Doors" dated 09/15/16, expiring on 04/16/20.

F. STATEMENTS

1. Statement letter of conformance, complying with FBC 5th Edition (2014) and FBC 6th Edition (2017), dated June 22, 2017, issued by manufacturer, signed and sealed by Anthony Lynn Miller, P.E.
2. Statement letter of no financial interest, dated June 22, 2017, issued by manufacturer, signed and sealed by Anthony Lynn Miller, P.E.
3. Proposal issued by Product Control, dated 6/26/14 and revised on 8/19/14, signed by Jaime Gascon, P.E. Supervisor, Product Control Section.
(Submitted under NOA No. 15-0519.05)
4. Proposal No. 16-0125 issued by the Product Control Section, dated March 09, 2016, signed by Ishaq Chanda, P.E.
(Submitted under previous NOA No. 16-0714.03)

G. OTHERS

1. Notice of Acceptance No. 16-0714.03, issued to PGT Industries, Inc. for their Series "5500" PVC Single Hung Window - L.M.I. approved on 08/18/16 and expiring on 07/30/20.

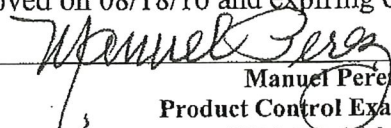
Manuel Perez, P.E.
Product Control Examiner
NOA No. 17-0630.05
Expiration Date: July 30, 2020
Approval Date: November 30, 2017

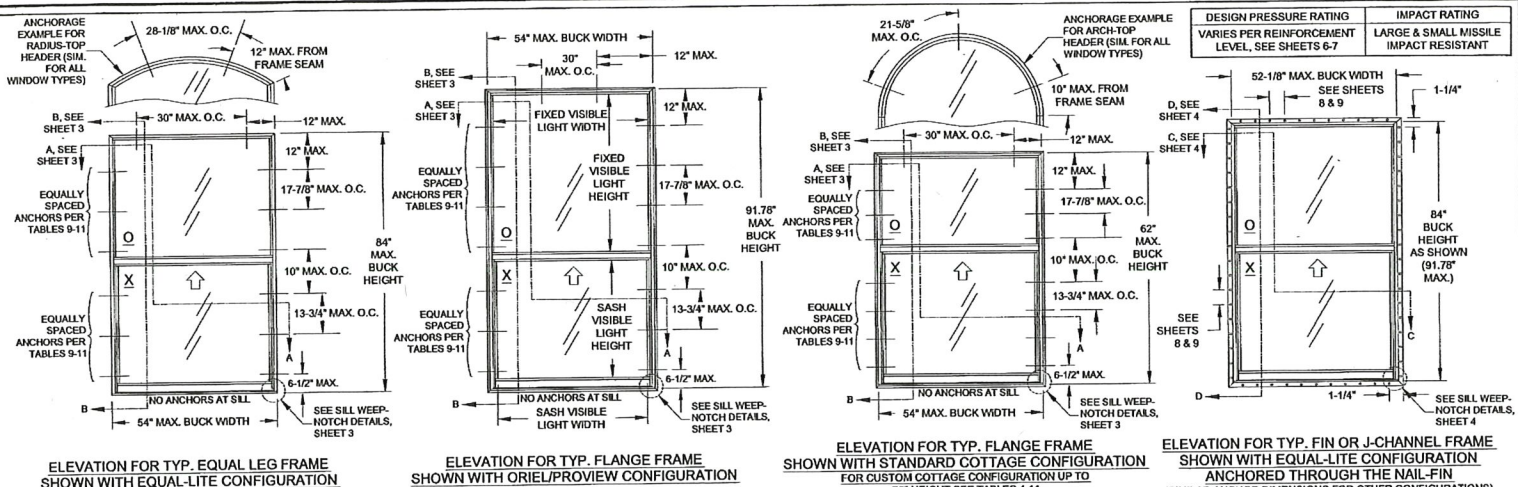

DESIGN PRESSURE RATING	IMPACT RATING
VARIABLES PER REINFORCEMENT LEVEL, SEE SHEETS 6-7	LARGE & SMALL MISSILE IMPACT RESISTANT

GENERAL NOTES: SERIES 5500 IMPACT RESISTANT SINGLE HUNG WINDOW

- THIS PRODUCT HAS BEEN DESIGNED & TESTED TO COMPLY WITH THE REQUIREMENTS OF THE FLORIDA BUILDING CODE, INCLUDING THE HIGH VELOCITY HURRICANE ZONE (HVHZ).
- SHUTTERS ARE NOT REQUIRED WHEN USED IN WIND-BORNE DEBRIS REGIONS. FOR INSULATED GLASS INSTALLATIONS ABOVE 30" IN THE HVHZ, THE OUTBOARD LITE (CAP) MUST TEMPERED.
- FOR MASONRY APPLICATIONS IN MIAMI-DADE COUNTY, USE ONLY MIAMI-DADE COUNTY APPROVED MASONRY ANCHORS. MATERIALS USED FOR ANCHOR EVALUATIONS WERE SOUTHERN PINE, ASTM C90 CONCRETE MASONRY UNITS AND CONCRETE WITH MIN. KSI PER ANCHOR TYPE.
- ALL WOOD BUCKS LESS THAN 1-1/2" THICK ARE TO BE CONSIDERED 1X INSTALLATIONS. 1X WOOD BUCKS ARE OPTIONAL IF UNIT IS INSTALLED DIRECTLY TO SUBSTRATE. WOOD BUCK DESIGN DEPICTED AS 2X ARE 1-1/2" THICK OR GREATER. 1X AND 2X BUCKS (WHEN USED) SHALL BE DESIGNED AND SECURED TO PROPERLY TRANSFER LOADS TO THE SUBSTRATE. WOOD BUCK DESIGN AND INSTALLATION IS THE RESPONSIBILITY OF THE ENGINEER, (EOR) OR ARCHITECT OF RECORD, (AOR).
- ANCHOR EMBEDMENT TO BASE MATERIAL SHALL BE BEYOND WALL DRESSING OR STUCCO. USE ANCHORS OF SUFFICIENT LENGTH TO ACHIEVE REQUIRED MIN. EMBEDMENT. INST. ANCHORS SHOULD BE SEALED. OVERALL SEALING/FLASHING STRATEGY FOR WATER RESISTANCE OF INSTALLATION SHALL BE DONE BY OTHERS AND IS BEYOND THE SCOPE OF THESE INSTRUCTIONS.
- 1/4" MAX. SHIMS ARE REQUIRED AT EACH ANCHOR LOCATION WHERE THE PRODUCT IS NOT FLUSH TO THE SUBSTRATE. USE SHIMS CAPABLE OF TRANSFERRING APPLIED LOADS.
- DESIGN PRESSURES:
 - NEGATIVE DESIGN LOADS BASED ON STRUCTURAL & CYCLE TESTING AND GLASS PER ASTM E1300.
 - POSITIVE DESIGN LOADS BASED ON WATER TEST PRESSURE, STRUCTURAL & CYCLE TESTING AND GLASS PER ASTM E1300.
 - DESIGN LOADS ARE BASED ON ALLOWABLE STRESS DESIGN, ASD.
- THE ANCHORAGE METHODS SHOWN HAVE BEEN DESIGNED TO RESIST THE WINDLOADS CORRESPONDING TO THE REQUIRED DESIGN PRESSURE. THE 33-1/3% STRESS INCREASE HAS NOT BEEN USED IN THE DESIGN OF THIS PRODUCT. THE 1.6 LOAD DURATION FACTOR WAS USED FOR THE EVALUATION OF ANCHORS INTO WOOD. ANCHORS THAT COME INTO CONTACT WITH OTHER DISSIMILAR MATERIALS SHALL MEET THE REQUIREMENTS OF THE FLORIDA BUILDING CODE FOR CORROSION RESISTANCE.
- METAL SUBSTRATE TO MEET MIN. STRENGTH AND THICKNESS REQUIREMENTS PER CURRENT FLORIDA BUILDING CODE AND TO BE REVIEWED BY THE AUTHORITY HAVING JURISDICTION.
- REFERENCES: TEST REPORTS FTL-7964 & 7966; ELCO ULTRACON NOA; ELCO CRETEFLEX NOA; ELCO AGGRE-GATOR NOA; ENERGI WINDOW AND DOOR PROFILES, LTD WHITE & BRONZE/LIGHTER SHADES OF CAP COATED PVC EXTRUSION NOA'S; NATIONAL DESIGN SPECIFICATION FOR WOOD CONSTRUCTION, ANSIF&PA NDS & ALUMINUM DESIGN MANUAL.
- APPLICABLE EGRESS REQUIREMENTS TO BE REVIEWED BY BUILDING OFFICIAL.

GENERAL NOTES:

GENERAL NOTES.....	1
ELEVATIONS.....	1
FRAME, GLASS & ANCHOR OPTIONS.....	2
INSTALLATION, FLANGE & EQUAL LEG/BOX.....	3
INSTALLATION, INTEGRAL FIN & J-CHANNEL.....	4
GLAZING DETAILS.....	5
DESIGN PRESSURES.....	6-7
ANCHOR QUANTITIES.....	8-10
EXTRUSION PROFILES.....	11
ASSEMBLY & PARTS LIST.....	12-13

CODES / STANDARDS USED:

- 2017 FLORIDA BUILDING CODE (FBC), 6TH EDITION
- 2014 FLORIDA BUILDING CODE (FBC), 5TH EDITION
- ASTM E1300-09
- ANSIF&PA NDS-2015 FOR WOOD CONSTRUCTION
- ALUMINUM DESIGN MANUAL, ADM-2015
- AISI S100-12
- AISC 360-10

PRODUCT REVISED as complying with the Florida Building Code
 Acceptance No. 17-0630-05
 Expiration Date: July 30, 2020
 By: *Manuel D. [Signature]*
 Miami Dade Product Control

USER INSTRUCTIONS:

- DETERMINE THE SITE SPECIFIC WINDOW OPENING'S DESIGN PRESSURE REQUIREMENT FROM ASCE 7.
- DETERMINE THE MOST SUITABLE ANCHOR GROUP FROM TABLES 2 OR 3 ACCORDING TO THE INSTALLATION CONDITIONS.
- KNOWING YOUR GLAZING OPTION (TABLE 1), WINDOW CONFIGURATION AND SIZE, DETERMINE YOUR WINDOWS DESIGN PRESSURE FROM TABLES 4-8. IT MUST EQUAL OR EXCEED THE DESIGN PRESSURE REQUIREMENT FOR THE WINDOW OPENING OBTAINED IN STEP 1.
- DETERMINE THE ANCHOR QUANTITY FROM TABLES 9-11. VERIFY THE ANCHOR/SUBSTRATE WILL MEET REQUIREMENTS FOR YOUR OPENING'S CONDITION FROM TABLES 2 OR 3, AND THAT ALL MIN. REQUIREMENTS FROM THIS SHEET-SET ARE MET.
- INSTALL AS PER SHEET 3 FOR THRU-FRAME INSTALLATION OR SHEET 4 FOR INTEGRAL FIN INSTALLATION.

NOTE-DESIGN PRESSURE RATING DETERMINATION IS THE SAME PROCESS FOR ALL FRAME TYPES (J-CHANNEL, FLANGE, INTEGRAL FIN OR EQUAL LEG/BOX).

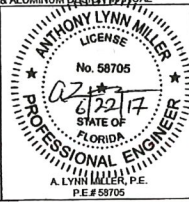

Revision: UPDATED TO FBC 2017. - JR - 06/06/17

Description: GENERAL NOTES & ELEVATION

Drawn By: J ROSOWSKI

Date: 05/15/15

Series/Model: SH-5500	Scale: NTS	Sheet: 1 OF 13	Drawing No.: MD-SH5500-01	Rev: B
-----------------------	------------	----------------	---------------------------	--------

TABLE 1: ALLOWABLE GLASS TYPES

Glass Type	Description (Listed from Exterior to Interior)	Design Pressure	
		Table #	Sheet #
5	7/8" Laminated I.G.: 1/8" A Exterior Cap + 7/16" Air Space + 5/16" Laminated; (2) Lites of 1/8" A Glass with .090" PVB Interlayer	4, 5	6
6	7/8" Laminated I.G.: 1/8" T Exterior Cap + 7/16" Air Space + 5/16" Laminated; (2) Lites of 1/8" A Glass with .090" PVB Interlayer	4, 6	6
7	7/8" Laminated I.G.: 3/16" A Exterior Cap + 3/8" Air Space + 5/16" Laminated; (2) Lites of 1/8" A Glass with .090" PVB Interlayer	4, 6	6
8	7/8" Laminated I.G.: 3/16" T Exterior Cap + 3/8" Air Space + 5/16" Laminated; (2) Lites of 1/8" A Glass with .090" PVB Interlayer	4, 6	6
9	7/8" Laminated I.G.: 1/8" A Exterior Cap + 7/16" Air Space + 5/16" Laminated; (2) Lites of 1/8" H Glass with .090" SG Interlayer	7	7
10	7/8" Laminated I.G.: 1/8" T Exterior Cap + 7/16" Air Space + 5/16" Laminated; (2) Lites of 1/8" H Glass with .090" SG Interlayer	7	7
11	7/8" Laminated I.G.: 3/16" A Exterior Cap + 3/8" Air Space + 5/16" Laminated; (2) Lites of 1/8" H Glass with .090" SG Interlayer	7	7
12	7/8" Laminated I.G.: 3/16" T Exterior Cap + 3/8" Air Space + 5/16" Laminated; (2) Lites of 1/8" H Glass with .090" SG Interlayer	7	7
13	7/8" Laminated I.G.: 1/8" A Exterior Cap + 5/16" Air Space + 7/16" Laminated; (2) Lites of 3/16" A Glass with .090" SG Interlayer	8	7
14	7/8" Laminated I.G.: 1/8" T Exterior Cap + 5/16" Air Space + 7/16" Laminated; (2) Lites of 3/16" A Glass with .090" SG Interlayer	8	7
15	7/8" Laminated I.G.: 3/16" A Exterior Cap + 1/4" Air Space + 7/16" Laminated; (2) Lites of 3/16" A Glass with .090" SG Interlayer	7	7
16	7/8" Laminated I.G.: 3/16" T Exterior Cap + 1/4" Air Space + 7/16" Laminated; (2) Lites of 3/16" A Glass with .090" SG Interlayer	7	7

TABLE 2: ALLOWABLE ANCHORS THROUGH THE FRAME

Group	Anchor	Substrate	Min. Edge Distance	Min. Embedment*
A	#10 SMS (steel, 18-8 S.S. or 410 S.S.)	P.T. Southern Pine (SG=0.55)	7/16"	1-3/8"
		Steel, A36*	3/8"	0.050"
		Steel Stud, A653 Gr. 33*	3/8"	0.0451" (18 Ga.)
		Aluminum, 6063-T5*	3/8"	0.050"
A	3/16" steel Ultracon	P.T. Southern Pine (SG=0.55)	7/16"	1-3/8"
		Concrete (min. 2.85 ksi)	1"	1-3/8"
		Ungrouted CMU, (ASTM C-90)	2-1/2"	1-1/4"
		P.T. Southern Pine (SG=0.55)	9/16"	1-3/8"
B	#12 SMS (steel, 18-8 S.S. or 410 S.S.)	P.T. Southern Pine (SG=0.55)	3/8"	0.050"
		Steel, A36*	3/8"	0.0451" (18 Ga.)
		Steel Stud, A653 Gr. 33*	3/8"	0.063"
		Aluminum, 6063-T5*	3/8"	0.050"
C	1/4" steel Ultracon	P.T. Southern Pine (SG=0.55)	1"	1-3/8"
		Concrete (min. 2.85 ksi)	1"	1-3/4"
		Ungrouted CMU, (ASTM C-90)	2-1/2"	1-1/4"
		P.T. Southern Pine (SG=0.55)	1"	1-3/8"
D	1/4" steel Creteflex	P.T. Southern Pine (SG=0.55)	1"	1-3/8"
		Concrete (min. 2.85 ksi)	1"	1-3/4"
		Ungrouted CMU, (ASTM C-90)	2-1/2"	1-1/4"
		P.T. Southern Pine (SG=0.55)	1"	1-3/8"
D	1/4" steel Aggre-Gator	P.T. Southern Pine (SG=0.55)	1"	1-3/8"
		Concrete (min. 2.85 ksi)	1"	1-3/4"
		Ungrouted CMU, (ASTM C-90)	2-1/2"	1-1/4"
		P.T. Southern Pine (SG=0.55)	2"	2"

GLASS TYPES 5, 7, 9, 11, 13 & 15 MAY NOT BE USED IN THE HVHZ ABOVE 30'.

* MIN. OF 3 THREADS BEYOND THE METAL SUBSTRATE.
* UNGROUTED CMU VALUES MAY BE USED FOR GROUTED CMU APPLICATIONS.

Frame Types (see Fig B)	Glass Options (see Table 1)	Frame Config. (see Fig A)	Frame Shapes (see Fig C)	Installation Options that may be used
Flange (#2)	5 - 16	Equal-Lite, Oriel/Proview & Cottage	Square/Rect., Arch-Top & Radius-Top	Through the frame of the window.....into 2X Wood Frame/Buckstrip - sheet 3, option 1into Concrete/CMU - sheet 3, option 2through 1X Buckstrip into Concrete/CMU - sheet 3, option 3into Metal - sheet 3, option 4
			Square/Rect., Arch-Top & Radius-Top	Through the frame of the window.....into 2X Wood Frame/Buckstrip - sheet 3, option 1into Concrete/CMU - sheet 3, option 2through 1X Buckstrip into Concrete/CMU - sheet 3, option 3into Metal - sheet 3, option 4
Box / Equal-Leg (#4)	5 - 16	Equal-Lite, Oriel/Proview & Cottage	Square/Rect., Arch-Top & Radius-Top	Through the frame of the window.....into 2X Wood Frame/Buckstrip - sheet 4, option 5into Metal - sheet 4, option 7through 1X Buckstrip into Concrete/CMU - sheet 4, option 6into Metal - sheet 4, option 8
			Square/Rect., Arch-Top & Radius-Top	Through the frame of the window.....into 2X Wood Frame/Buckstrip - sheet 4, option 5into Metal - sheet 4, option 7through 1X Buckstrip into Concrete/CMU - sheet 4, option 6into Metal - sheet 4, option 8
J-Channel (#1)	5 - 8	Equal-Lite, Oriel/Proview & Cottage	Square/Rect., Arch-Top & Radius-Top	Through the frame of the window.....into 2X Wood Frame/Buckstrip - sheet 4, option 5into Metal - sheet 4, option 7through 1X Buckstrip into Concrete/CMU - sheet 4, option 6into Metal - sheet 4, option 8
			Square/Rect., Arch-Top & Radius-Top	Through the frame of the window.....into 2X Wood Frame/Buckstrip - sheet 4, option 5into Metal - sheet 4, option 7through 1X Buckstrip into Concrete/CMU - sheet 4, option 6into Metal - sheet 4, option 8
Integral Fin (#3)	5 - 8	Equal-Lite, Oriel/Proview & Cottage	Square/Rect., Arch-Top & Radius-Top	Through the frame of the window.....into 2X Wood Frame/Buckstrip - sheet 4, option 5into Metal - sheet 4, option 7through 1X Buckstrip into Concrete/CMU - sheet 4, option 6into Metal - sheet 4, option 8
			Square/Rect., Arch-Top & Radius-Top	Through the frame of the window.....into 2X Wood Frame/Buckstrip - sheet 4, option 5into Metal - sheet 4, option 7through 1X Buckstrip into Concrete/CMU - sheet 4, option 6into Metal - sheet 4, option 8

FIGURE A: FRAME CONFIGURATIONS

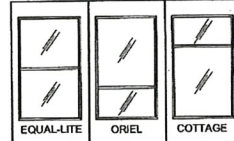

FIGURE B: FRAME TYPES

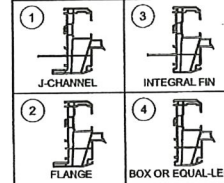
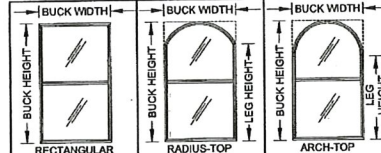

FIGURE C: FRAME SHAPES



WINDOW SHAPES AS ABOVE OR SIMILAR ARE APPROVED. SHAPES MAY BE USED BY INSCRIBING THE SHAPE IN A BLOCK AND OBTAINING DESIGN PRESSURES AND ANCHORAGE FOR THAT BLOCK SIZE FROM THE TABLES ON SHEETS 6-10.

"A" = ANNEALED
"H" = HEAT STRENGTHENED
"T" = TEMPERED
"PVB" = .090" TROSIFOL® PVB BY KURARAY AMERICA, INC.
"SG" = .090" SENTRYGLAS® INTERLAYER BY KURARAY AMERICA, INC.

Material	Min. F _y	Min. F _u
Steel Screw	92 ksi	120 ksi
18-8 Screw	60 ksi	95 ksi
410 Screw	90 ksi	110 ksi
Elco Aggre-Gator®	57 ksi	96 ksi
Elco UltraCon®	155 ksi	177 ksi
410 SS Elco CreteFlex®	127.4 ksi	189.7 ksi
6063-T5 Aluminum	16 ksi	22 ksi
A36 Steel	36 ksi	58 ksi
Gr. 33 Steel Stud	33 ksi	45 ksi

TABLE 3: ALLOWABLE ANCHORS THROUGH THE INTEGRAL FIN

Group	Anchor	Substrate	Min. Edge Distance	Min. Embedment*
E	2-1/2" x .131" Common Nail	P.T. Southern Pine (SG=.55)	3/8"	2-7/16"
	2-1/2" Ring-shank Roofing Nail	P.T. Southern Pine (SG=.55)	3/8"	2-7/16"
F	#10 Trusshead SMS (steel, 18-8 S.S. or 410 S.S.)	P.T. Southern Pine (SG=.55)	1/2"	1-3/8"
		Aluminum, 6063-T5*	3/8"	0.050"
		Steel Stud, Gr. 33*	3/8"	0.0451" (18 Ga.)
		Steel, A36*	3/8"	0.050"
F	#12 SMS (steel, 18-8 S.S. or 410 S.S.)	P.T. Southern Pine (SG=.55)	9/16"	1-3/8"
		Aluminum, 6063-T5*	3/8"	0.063"
		Steel Stud, Gr. 33*	3/8"	0.050"
		Steel, A36*	3/8"	0.050"

* MIN. OF 3 THREADS BEYOND THE METAL SUBSTRATE.

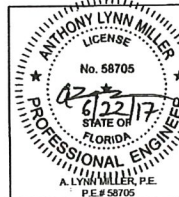

Revision: ANCHORS RE-GROUPED. - JR - 06/06/17

Description: GLASS/ANCHORS/FRAE OPTIONS
 Title: SINGLE HUNG WINDOW INSTALLATION - LM
 Series/Model: SH-5500
 Scale: NTS
 Sheet: 2 OF 13
 Drawing No.: MD-SH5500-01
 Date: 05/15/15
 Drawn By: J ROSOWSKI
 Rvc: B

PRODUCT REVISED as complying with the Florida Building Code Acceptance No. 17-0630.05 Issuance Date: July 30, 2020 By: Manuel Diaz Miami Trade Product Control

INSTALLATION DETAILS FOR FLANGE & EQUAL-LEG/BOX FRAMES

INSTALLATION OPTION 1
ANCHORED THROUGH FRAME INTO 2X WOOD FRAME OR BUCKSTRIP. SEE NOTE 2, THIS SHEET.

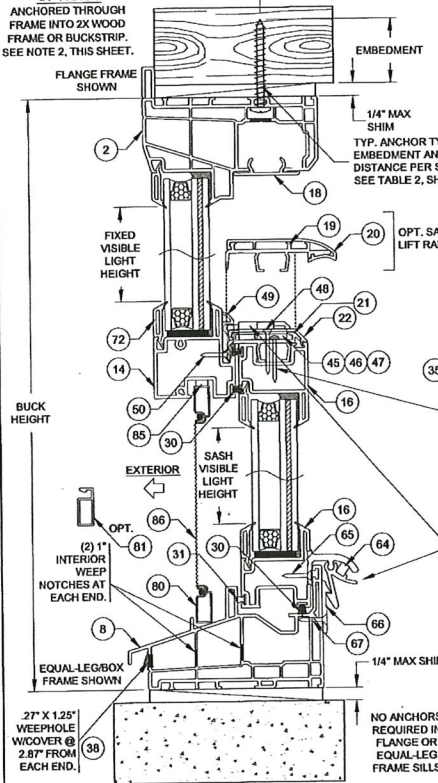

VERTICAL SECTION B-B

INSTALLATION OPTION 2
ANCHORED THROUGH FRAME DIRECTLY INTO CONCRETE/CMU.

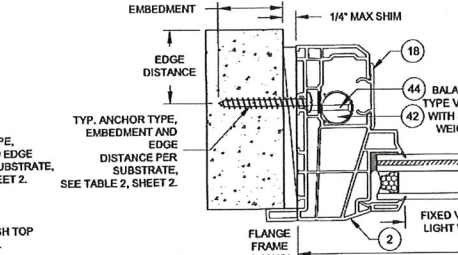

INSTALLATION OPTION 3
ANCHORED THROUGH FRAME AND 1X BUCKSTRIP INTO CONCRETE/CMU. SEE NOTE 2, THIS SHEET.

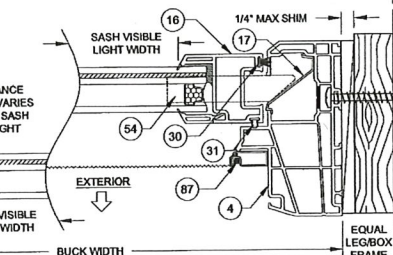

HORIZONTAL SECTION A-A

NOTES:

- 1) USE ONLY SUBSTRATE-APPROPRIATE ANCHORS LISTED ON TABLE 2, SHEET 2. FOLLOW EMBEDMENT AND EDGE DISTANCE LIMITS. ANY INSTALLATION OPTION SHOWN MAY BE USED ON ANY SIDE OF THE WINDOW.
- 2) MASONRY ANCHORS MAY BE USED INTO WOOD AS PER TABLE 2, SHEET 2. ALL WOOD BUCKS LESS THAN 1-1/2" THICK ARE TO BE CONSIDERED 1X INSTALLATIONS. 1X WOOD BUCKS ARE OPTIONAL IF UNIT IS INSTALLED DIRECTLY TO SUBSTRATE. WOOD BUCKS DEPICTED AS 2X ARE 1-1/2" THICK OR GREATER. 1X AND 2X BUCKS (WHEN USED) SHALL BE DESIGNED TO PROPERLY TRANSFER LOADS TO THE STRUCTURE. WOOD BUCK DESIGN AND INSTALLATION IS THE RESPONSIBILITY OF THE ENGINEER OR ARCHITECT OF RECORD.
- 3) VISIBLE LIGHT WIDTH OR HEIGHT (ALSO REFERRED TO AS DAYLIGHT OPENING) IS MEASURED FROM BEADING TO BEADING.

DADE APPROVED MULLION, FBC COMPLIANT ALUMINUM/STEEL FRAMING OR STEEL STUD. MAY BE VERTICAL OR HORIZONTAL. SEE SUBSTRATE PROPERTIES, TABLE 2, SHEET 2.

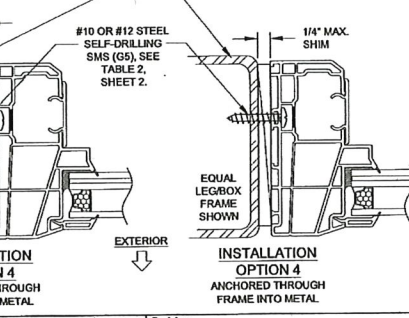

INSTALLATION OPTION 4
ANCHORED THROUGH FRAME INTO METAL

VISIBLE LIGHT FORMULAS

WIDTH
@ SASH: BUCK WIDTH - 6-1/2"
@ FIXED LITE: BUCK WIDTH - 4-3/8"

HEIGHT (EQUAL-LITE)
BUCK HEIGHT/2 - 3-15/16"

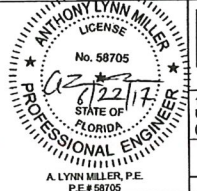

Description: FLANGE & EQUAL-LEG/BOX FRAMES		Drawn By: J ROSOWSKI	
Title: SINGLE HUNG WINDOW INSTALLATION - LM		Date: 05/15/15	
Series/Model: SH-5500	Scale: NTS	Sheet: 3 OF 13	Drawing No. MD-SH5500-01
			Rev: B

PRODUCT REVISED as complying with the Florida Building Code Acceptance No. 17-0630-05 Expiration Date 10/19/30/2020 By *Manuel J...*

INSTALLATION DETAILS FOR INTEGRAL FIN & J-CHANNEL FRAMES

INSTALLATION OPTION 5
 ANCHORED THROUGH INTEGRAL FIN INTO 2X WOOD FRAME OR BUCK-STRIP. SEE NOTE 2, THIS SHEET.

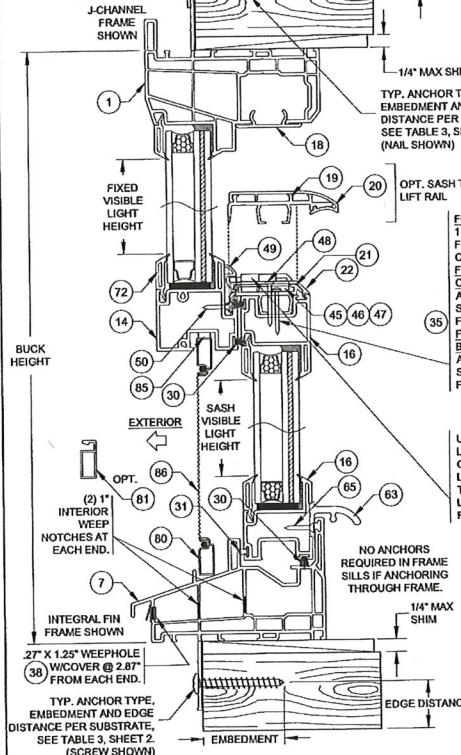

INSTALLATION OPTION 5
 ANCHORED THROUGH INTEGRAL FIN INTO 2X WOOD FRAME OR BUCK-STRIP. SEE NOTE 2, THIS SHEET.

VERTICAL SECTION D-D

TYP. ANCHOR TYPE, EMBEDMENT AND EDGE DISTANCE PER SUBSTRATE. SEE TABLE 2, SHEET 2. (SCREW SHOWN)

TYP. ANCHOR TYPE, EMBEDMENT AND EDGE DISTANCE PER SUBSTRATE. SEE TABLE 3, SHEET 2. (NAIL SHOWN)

FOR ALL WINDOWS:
 1) ANCHOR @ 3.5\"/>

USE EITHER LATCH (SHOWN) OR BOTTOM LOCK (SHEET 3). TESTED UNIT LOCATION: 6'-8\"/>

NO ANCHORS REQUIRED IN FRAME SILLS IF ANCHORING THROUGH FRAME.

VISIBLE LIGHT FORMULAS

WIDTH
 @ SASH: BUCK WIDTH - 6-1/2\"/>

HEIGHT (EQUAL-LITE)
 BUCK HEIGHT/2 - 3-15/16\"/>

INSTALLATION OPTION 6
 ANCHORED THROUGH FRAME INTO 2X WOOD FRAME OR BUCKSTRIP. SEE NOTE 2, THIS SHEET.

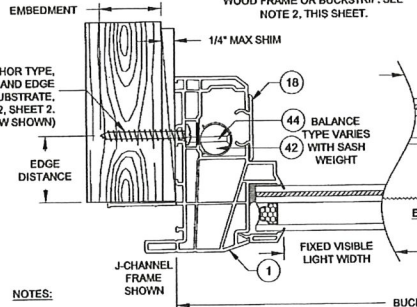

INSTALLATION OPTION 5
 ANCHORED THROUGH INTEGRAL FIN INTO 2X WOOD FRAME OR BUCKSTRIP. SEE NOTE 2, THIS SHEET.

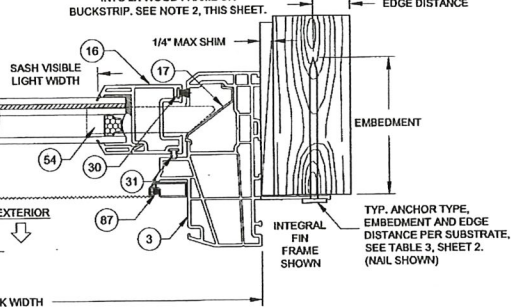

HORIZONTAL SECTION C-C

DADE APPROVED MULLION, FBC COMPLIANT ALUMINUM/STEEL FRAMING OR STEEL STUD. MAY BE VERTICAL OR HORIZONTAL. SEE SUBSTRATE PROPERTIES, TABLES 2 & 3, SHEET 2.

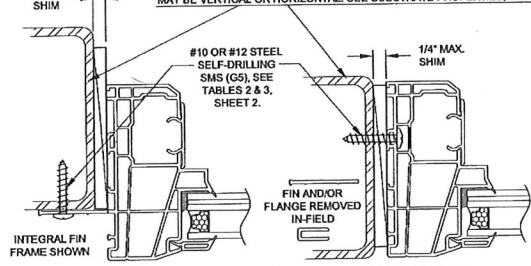

INSTALLATION OPTION 7
 ANCHORED THROUGH INTEGRAL FIN INTO METAL

INSTALLATION OPTION 8
 ANCHORED THROUGH FRAME INTO METAL (INTEGRAL FIN FLANGE REMOVED)

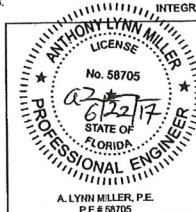

PGI
 1070 TECHNOLOGY DRIVE
 N. VENICE, FL 34275
 (941) 480-1600
 COPYRIGHT © 2017
 PGT INDUSTRIES, INC.
 ALL RIGHTS RESERVED
 CERT. OF AUTH. #29296

Revision:		Description: J-CHANNEL & INTEGRAL FIN FRAMES		Drawn By: J ROSOWSKI	
Title: SINGLE HUNG WINDOW INSTALLATION - LM		Date: 05/15/15		By: <i>Manuel Diaz</i> Miami Trade Product Control	
Series/Model: SH-5500	Scale: NTS	Sheet: 4 OF 13	Drawing No. MD-SH5500-01	Rev: B	

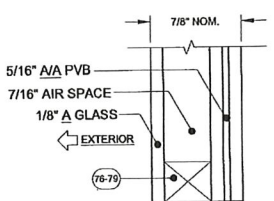

GLASS TYPE 5

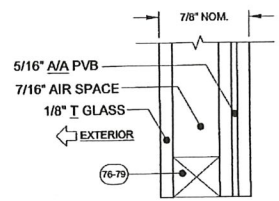

GLASS TYPE 6

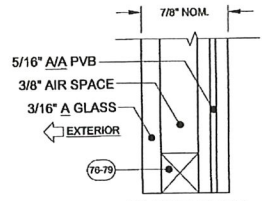

GLASS TYPE 7

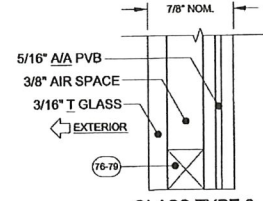

GLASS TYPE 8

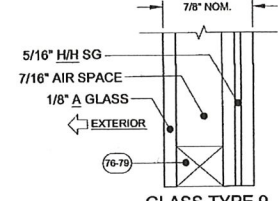

GLASS TYPE 9

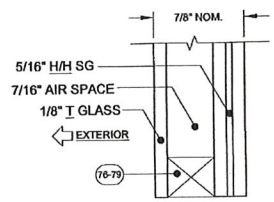

GLASS TYPE 10

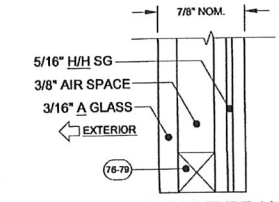

GLASS TYPE 11

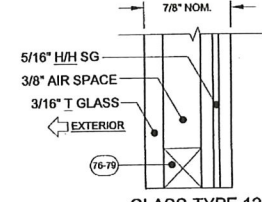

GLASS TYPE 12

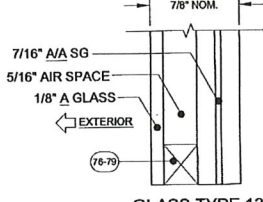

GLASS TYPE 13

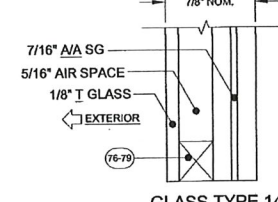

GLASS TYPE 14

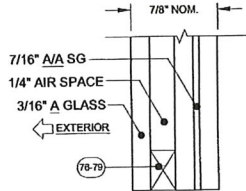

GLASS TYPE 15

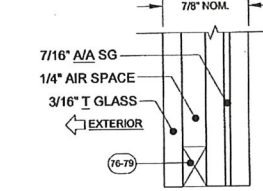

GLASS TYPE 16

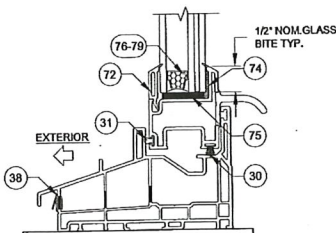

TYP. GLAZING DETAIL

- GLASS TYPES 9 THROUGH 16 MAY NOT BE USED WITH J-CHANNEL OR INTEGRAL FIN FRAMES
- GLASS TYPES 5, 7, 9, 11, 13 & 15 MAY NOT BE USED IN THE HVHZ ABOVE 30°.

GLAZING NOTES:
 A = ANNEALED
 H = HEAT STRENGTHENED
 T = TEMPERED
 PVB = .090" TROSIFOL® PVB BY KURARAY AMERICA, INC.
 SG = .090" SENTRYGLAS® BY KURARAY AMERICA, INC.
 FOR LAMINATED GLAZING COMPONENTS, SEE TABLE 1, SHEET 2.

PRODUCT REVISED as complying with the Florida Building Code Acceptance No. 17-0630.05 Expiration Date 11/15/2020
 By: *Manuel J. Rosowski*
 Miraflores Product Control

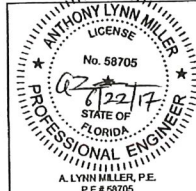

PGI
 1070 TECHNOLOGY DRIVE
 N. VENICE, FL 34275
 (841) 480-1600
 COPYRIGHT © 2017
 PGI INDUSTRIES, INC.
 ALL RIGHTS RESERVED
 CERT. OF AUTH. #29296

Revision:		Drawn By: J ROSOWSKI	
Description: GLAZING DETAILS		Date: 05/15/15	
Title: SINGLE HUNG WINDOW INSTALLATION - LM		Rev: B	
Series/Model: SH-5500	Scale: NTS	Sheet: 5 OF 13	Drawing No. MD-SH5500-01

Glass Type #	Design Pressure, lbs/ft ²
5, 6, 7 & 8	+/- 50.0
Reinf. Level	R1
	For all window & sash sizes

SEE TABLE 9, SHEET 8 FOR ANCHOR GROUP AND QUANTITY.

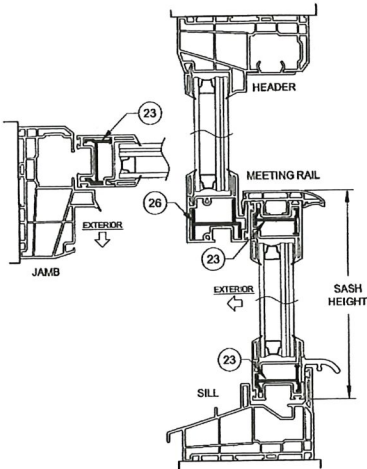

SECTION DETAIL FOR WINDOWS WITH LEVEL R1 REINFORCEMENT & GLASS TYPES 5, 6, 7 & 8 (REINFORCEMENTS SHOWN IN FIGURES ABOVE APPLY TO ALL FRAME TYPES & CONFIGURATIONS)

Glass Type #	Reinf. Level	Bottom Sash Description for glass Range (S) Window Height Shown	Sash Height Range (in)	Design Pressure, lbs/ft ²
				Window Buck Width (in)
				up to 48
				52.125
23.5	R2	Equalite	11.304	+65.0 -70.0 +65.0 -70.0
		Standard Cottage	14.517 - 15.870	+65.0 -70.0 +65.0 -70.0
28	R2	Equalite	11.583 - 14.516	+65.0 -70.0 +65.0 -70.0
		Standard Prowler	11.377 - 11.552	+65.0 -70.0 +65.0 -70.0
		Talrest	23.517 - 25.208	+65.0 -70.0 +65.0 -70.0
		Standard Cottage	20.868 - 23.516	+65.0 -70.0 +65.0 -70.0
37.375	R2	Equalite	17.517 - 20.867	+65.0 -70.0 +65.0 -70.0
		Standard Prowler	14.517 - 17.516	+65.0 -70.0 +65.0 -70.0
		Shotfast	11.377 - 14.516	+65.0 -70.0 +65.0 -70.0
		Talrest	27.583 - 31.011	+65.0 -70.0 +65.0 -70.0
44	R2	Custom Size	20.517 - 27.582	+65.0 -70.0 +65.0 -70.0
		Standard Cottage	23.517 - 26.516	+65.0 -70.0 +65.0 -70.0
		Equalite	20.517 - 23.516	+65.0 -70.0 +65.0 -70.0
		Standard Prowler	17.517 - 20.516	+65.0 -70.0 +65.0 -70.0
46	R2	Custom Size	14.517 - 17.516	+65.0 -70.0 +65.0 -70.0
		Standard Prowler	12.517 - 14.516	+65.0 -70.0 +65.0 -70.0
		Shotfast	11.377 - 12.516	+65.0 -70.0 +65.0 -70.0
		Talrest	31.283 - 35.011	+65.0 -70.0 +65.0 -70.0
49.025	R2	Standard Cottage	26.517 - 31.592	+65.0 -70.0 +65.0 -70.0
		Equalite	20.517 - 26.516	+65.0 -70.0 +65.0 -70.0
		Standard Prowler	17.517 - 20.516	+65.0 -70.0 +65.0 -70.0
		Custom Size	20.517 - 23.516	+65.0 -70.0 +65.0 -70.0
52	R2	Custom Size	12.517 - 14.516	+65.0 -70.0 +65.0 -70.0
		Standard Prowler	11.377 - 12.516	+65.0 -70.0 +65.0 -70.0
		Shotfast	11.377 - 12.516	+65.0 -70.0 +65.0 -70.0
		Talrest	33.208 - 37.520	+65.0 -70.0 +65.0 -70.0
62	R2	Standard Cottage	26.517 - 33.207	+65.0 -70.0 +65.0 -70.0
		Equalite	23.517 - 28.516	+65.0 -70.0 +65.0 -70.0
		Custom Size	20.517 - 23.516	+65.0 -70.0 +65.0 -70.0
		Standard Prowler	17.517 - 20.516	+65.0 -70.0 +65.0 -70.0
75	R2	Custom Size	13.017 - 14.516	+65.0 -70.0 +65.0 -70.0
		Standard Prowler	11.864 - 13.016	+65.0 -70.0 +65.0 -70.0
		Shotfast	11.864 - 13.016	+65.0 -70.0 +65.0 -70.0
		Talrest	38.517 - 41.844	+65.0 -70.0 +65.0 -70.0
84	R2	Custom Size	38.517 - 39.516	+65.0 -70.0 +65.0 -70.0
		Equalite	35.517 - 38.516	+65.0 -70.0 +65.0 -70.0
		Standard Prowler	22.517 - 32.516	+65.0 -70.0 +65.0 -70.0
		Custom Size	28.517 - 28.516	+65.0 -70.0 +65.0 -70.0
81.78	R2	Standard Prowler	25.017 - 28.516	+65.0 -70.0 +65.0 -70.0
		Shotfast	25.017 - 28.516	+65.0 -70.0 +65.0 -70.0
		Equalite	38.517 - 41.844	+65.0 -70.0 +65.0 -70.0
		Custom Size	35.517 - 38.516	+65.0 -70.0 +65.0 -70.0
81.78	R2	Standard Prowler	33.817 - 35.516	+65.0 -70.0 +65.0 -70.0
		Talrest	** - 41.844	+65.0 -70.0 +65.0 -70.0

SEE TABLE 10, SHEET 9 FOR ANCHOR GROUP AND QUANTITY.
** MIN. SASH HEIGHT = WINDOW BUCK HEIGHT - 50.136

Glass Type #	Design Pressure, lbs/ft ²
5, 6, 7 & 8	+65.0 / -70.0
Reinf. Level	R2
	For all window and sash sizes

SEE TABLE 10, SHEET 9 FOR ANCHOR GROUP AND QUANTITY.

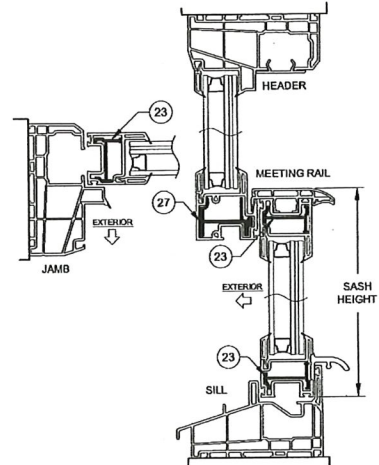

SECTION DETAIL FOR WINDOWS WITH LEVEL R2 REINFORCEMENT & GLASS TYPES 5, 6, 7 & 8 (REINFORCEMENTS SHOWN IN FIGURES ABOVE APPLY TO ALL FRAME TYPES & CONFIGURATIONS)

PRODUCT REVISED as complying with the Florida Building Code Acceptance No. 17-0630.05 Expiration Date July 30, 2020 By *Manuel J. J...* Miami Dade Product Control

- NOTES:
- 1) USE THESE TABLES FOR ALL WINDOWS INSTALLED THROUGH THE FRAME OR INTEGRAL FIN.
 - 2) FRAME DIMENSIONS ARE BUCK. SASH HEIGHT IS AS PER THE FIGURE.
 - 3) FOR SIZES NOT SHOWN, ROUND UP TO THE NEXT AVAILABLE WIDTH OR HEIGHT DIMENSION SHOWN ON THE TABLE.



PGI
1070 TECHNOLOGY DRIVE
N. VENICE, FL 34276
(941)-480-1800
COPYRIGHT © 2017
PGI INDUSTRIES, INC.
ALL RIGHTS RESERVED
CERT. OF AUTH. #20206

Revision:	Drawn By: J ROSOWSKI
Description: DESIGN PRESSURE TABLES	Date: 05/15/15
Title: SINGLE HUNG WINDOW INSTALLATION - LM	Rev: B
Series/Model: SH-5500	Scale: NTS
Sheet: 6 OF 13	Drawing No. MD-SH5500-01

Glass Type 8-12, 18 & 16 Rainfall Level 3	Bottom Sash Description for given Range of Window Height (ft)	Sash Height Range (ft)	Design Pressure, lb/ft ²							
			Window Buck Width (in)							
			18	24	30	36	42	48	54	
23.5	Equal-Itie	11.304	+70.0	+110.0	+70.0	+110.0	+70.0	+110.0	+70.0	+110.0
	Standard Cottage	14.517-15.870	+70.0	+110.0	+70.0	+110.0	+70.0	+110.0	+70.0	+110.0
	Equal-Itie	11.304	+70.0	+110.0	+70.0	+110.0	+70.0	+110.0	+70.0	+110.0
28	Equal-Itie	11.304	+70.0	+110.0	+70.0	+110.0	+70.0	+110.0	+70.0	+110.0
	Standard Cottage	14.517-15.870	+70.0	+110.0	+70.0	+110.0	+70.0	+110.0	+70.0	+110.0
	Equal-Itie	11.304	+70.0	+110.0	+70.0	+110.0	+70.0	+110.0	+70.0	+110.0
37.375	Equal-Itie	17.517-20.266	+70.0	+110.0	+70.0	+110.0	+70.0	+110.0	+70.0	+110.0
	Standard Cottage	20.266-23.516	+70.0	+110.0	+70.0	+110.0	+70.0	+110.0	+70.0	+110.0
	Equal-Itie	17.517-20.266	+70.0	+110.0	+70.0	+110.0	+70.0	+110.0	+70.0	+110.0
44	Equal-Itie	17.517-20.266	+70.0	+110.0	+70.0	+110.0	+70.0	+110.0	+70.0	+110.0
	Standard Cottage	20.266-23.516	+70.0	+110.0	+70.0	+110.0	+70.0	+110.0	+70.0	+110.0
	Equal-Itie	17.517-20.266	+70.0	+110.0	+70.0	+110.0	+70.0	+110.0	+70.0	+110.0
48	Equal-Itie	17.517-20.266	+70.0	+110.0	+70.0	+110.0	+70.0	+110.0	+70.0	+110.0
	Standard Cottage	20.266-23.516	+70.0	+110.0	+70.0	+110.0	+70.0	+110.0	+70.0	+110.0
	Equal-Itie	17.517-20.266	+70.0	+110.0	+70.0	+110.0	+70.0	+110.0	+70.0	+110.0
48.25	Equal-Itie	17.517-20.266	+70.0	+110.0	+70.0	+110.0	+70.0	+110.0	+70.0	+110.0
	Standard Cottage	20.266-23.516	+70.0	+110.0	+70.0	+110.0	+70.0	+110.0	+70.0	+110.0
	Equal-Itie	17.517-20.266	+70.0	+110.0	+70.0	+110.0	+70.0	+110.0	+70.0	+110.0
62	Equal-Itie	17.517-20.266	+70.0	+110.0	+70.0	+110.0	+70.0	+110.0	+70.0	+110.0
	Standard Cottage	20.266-23.516	+70.0	+110.0	+70.0	+110.0	+70.0	+110.0	+70.0	+110.0
	Equal-Itie	17.517-20.266	+70.0	+110.0	+70.0	+110.0	+70.0	+110.0	+70.0	+110.0
75	Equal-Itie	17.517-20.266	+70.0	+110.0	+70.0	+110.0	+70.0	+110.0	+70.0	+110.0
	Standard Cottage	20.266-23.516	+70.0	+110.0	+70.0	+110.0	+70.0	+110.0	+70.0	+110.0
	Equal-Itie	17.517-20.266	+70.0	+110.0	+70.0	+110.0	+70.0	+110.0	+70.0	+110.0
84	Equal-Itie	17.517-20.266	+70.0	+110.0	+70.0	+110.0	+70.0	+110.0	+70.0	+110.0
	Standard Cottage	20.266-23.516	+70.0	+110.0	+70.0	+110.0	+70.0	+110.0	+70.0	+110.0
	Equal-Itie	17.517-20.266	+70.0	+110.0	+70.0	+110.0	+70.0	+110.0	+70.0	+110.0

Glass Type 12 & 14 Rainfall Level 3	Bottom Sash Description for given Range of Window Height (ft)	Sash Height Range (ft)	Design Pressure, lb/ft ²											
			Window Buck Width (in)											
			18	24	30	36	42	48	54	60	66			
23.5	Equal-Itie	11.304	+70.0	+110.0	+70.0	+110.0	+70.0	+110.0	+70.0	+110.0	+70.0	+110.0	+70.0	+110.0
	Standard Cottage	14.517-15.870	+70.0	+110.0	+70.0	+110.0	+70.0	+110.0	+70.0	+110.0	+70.0	+110.0	+70.0	+110.0
	Equal-Itie	11.304	+70.0	+110.0	+70.0	+110.0	+70.0	+110.0	+70.0	+110.0	+70.0	+110.0	+70.0	+110.0
28	Equal-Itie	11.304	+70.0	+110.0	+70.0	+110.0	+70.0	+110.0	+70.0	+110.0	+70.0	+110.0	+70.0	+110.0
	Standard Cottage	14.517-15.870	+70.0	+110.0	+70.0	+110.0	+70.0	+110.0	+70.0	+110.0	+70.0	+110.0	+70.0	+110.0
	Equal-Itie	11.304	+70.0	+110.0	+70.0	+110.0	+70.0	+110.0	+70.0	+110.0	+70.0	+110.0	+70.0	+110.0
37.375	Equal-Itie	17.517-20.266	+70.0	+110.0	+70.0	+110.0	+70.0	+110.0	+70.0	+110.0	+70.0	+110.0	+70.0	+110.0
	Standard Cottage	20.266-23.516	+70.0	+110.0	+70.0	+110.0	+70.0	+110.0	+70.0	+110.0	+70.0	+110.0	+70.0	+110.0
	Equal-Itie	17.517-20.266	+70.0	+110.0	+70.0	+110.0	+70.0	+110.0	+70.0	+110.0	+70.0	+110.0	+70.0	+110.0
44	Equal-Itie	17.517-20.266	+70.0	+110.0	+70.0	+110.0	+70.0	+110.0	+70.0	+110.0	+70.0	+110.0	+70.0	+110.0
	Standard Cottage	20.266-23.516	+70.0	+110.0	+70.0	+110.0	+70.0	+110.0	+70.0	+110.0	+70.0	+110.0	+70.0	+110.0
	Equal-Itie	17.517-20.266	+70.0	+110.0	+70.0	+110.0	+70.0	+110.0	+70.0	+110.0	+70.0	+110.0	+70.0	+110.0
48	Equal-Itie	17.517-20.266	+70.0	+110.0	+70.0	+110.0	+70.0	+110.0	+70.0	+110.0	+70.0	+110.0	+70.0	+110.0
	Standard Cottage	20.266-23.516	+70.0	+110.0	+70.0	+110.0	+70.0	+110.0	+70.0	+110.0	+70.0	+110.0	+70.0	+110.0
	Equal-Itie	17.517-20.266	+70.0	+110.0	+70.0	+110.0	+70.0	+110.0	+70.0	+110.0	+70.0	+110.0	+70.0	+110.0
48.25	Equal-Itie	17.517-20.266	+70.0	+110.0	+70.0	+110.0	+70.0	+110.0	+70.0	+110.0	+70.0	+110.0	+70.0	+110.0
	Standard Cottage	20.266-23.516	+70.0	+110.0	+70.0	+110.0	+70.0	+110.0	+70.0	+110.0	+70.0	+110.0	+70.0	+110.0
	Equal-Itie	17.517-20.266	+70.0	+110.0	+70.0	+110.0	+70.0	+110.0	+70.0	+110.0	+70.0	+110.0	+70.0	+110.0
62	Equal-Itie	17.517-20.266	+70.0	+110.0	+70.0	+110.0	+70.0	+110.0	+70.0	+110.0	+70.0	+110.0	+70.0	+110.0
	Standard Cottage	20.266-23.516	+70.0	+110.0	+70.0	+110.0	+70.0	+110.0	+70.0	+110.0	+70.0	+110.0	+70.0	+110.0
	Equal-Itie	17.517-20.266	+70.0	+110.0	+70.0	+110.0	+70.0	+110.0	+70.0	+110.0	+70.0	+110.0	+70.0	+110.0
75	Equal-Itie	17.517-20.266	+70.0	+110.0	+70.0	+110.0	+70.0	+110.0	+70.0	+110.0	+70.0	+110.0	+70.0	+110.0
	Standard Cottage	20.266-23.516	+70.0	+110.0	+70.0	+110.0	+70.0	+110.0	+70.0	+110.0	+70.0	+110.0	+70.0	+110.0
	Equal-Itie	17.517-20.266	+70.0	+110.0	+70.0	+110.0	+70.0	+110.0	+70.0	+110.0	+70.0	+110.0	+70.0	+110.0
84	Equal-Itie	17.517-20.266	+70.0	+110.0	+70.0	+110.0	+70.0	+110.0	+70.0	+110.0	+70.0	+110.0	+70.0	+110.0
	Standard Cottage	20.266-23.516	+70.0	+110.0	+70.0	+110.0	+70.0	+110.0	+70.0	+110.0	+70.0	+110.0	+70.0	+110.0
	Equal-Itie	17.517-20.266	+70.0	+110.0	+70.0	+110.0	+70.0	+110.0	+70.0	+110.0	+70.0	+110.0	+70.0	+110.0

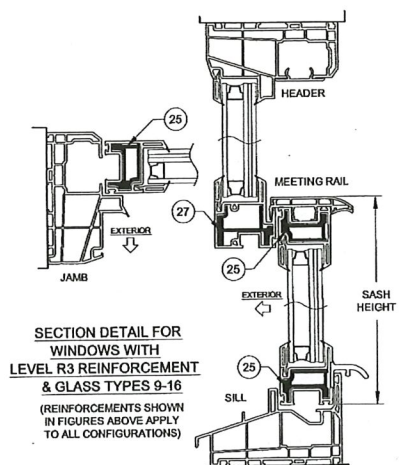

SECTION DETAIL FOR
WINDOWS WITH
LEVEL R3 REINFORCEMENT
& GLASS TYPES 9-16
(REINFORCEMENTS SHOWN
IN FIGURES ABOVE APPLY
TO ALL CONFIGURATIONS)

SEE TABLE 11, SHEET 10 FOR ANCHOR GROUP AND QUANTITY.
** MIN. SASH HEIGHT = WINDOW BUCK HEIGHT - 50.136

SEE TABLE 11, SHEET 10 FOR ANCHOR GROUP AND QUANTITY.
** MIN. SASH HEIGHT = WINDOW BUCK HEIGHT - 50.136

- NOTES:
- 1) USE THESE TABLES FOR ALL WINDOWS INSTALLED THROUGH THE FRAME.
 - 2) FRAME DIMENSIONS ARE BUCK. SASH HEIGHT IS AS PER THE FIGURE.
 - 3) FOR SIZES NOT SHOWN, ROUND UP TO THE NEXT AVAILABLE WIDTH OR HEIGHT DIMENSION SHOWN ON THE TABLE.

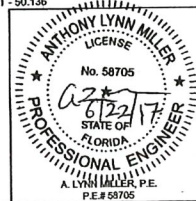

Revision:

Description: DESIGN PRESSURE TABLES

Title: SINGLE HUNG WINDOW INSTALLATION - LM

Series/Model: SH-5500

Scale: NTS

Sheet: 7 OF 13

Drawing No. MD-SH5500-01

Rev: B

Date: 05/15/15

Drawn By: J ROSOWSKI

Product Revised as complying with the Florida Building Code Acceptance No. 17-0630.05 Expiration Date July 30, 2020 By: Manuel Lopez Miami Dade Product Control

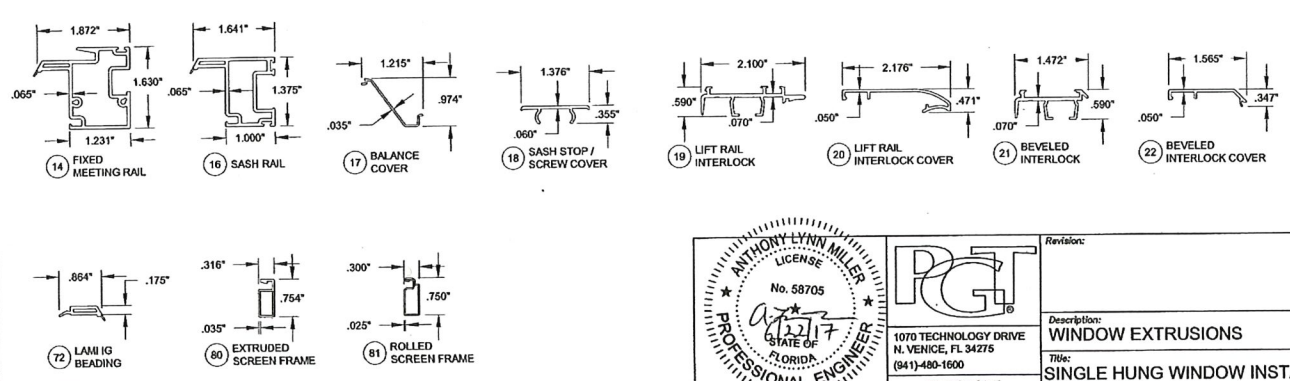
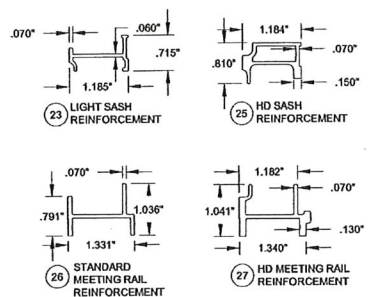
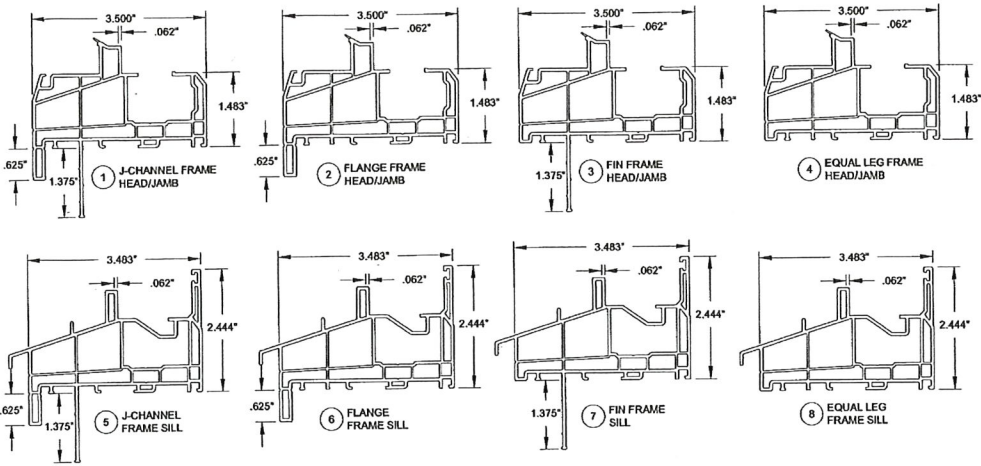

PRODUCT REVISED
 as complying with the Florida
 Building Code
 Acceptance No. 17-0630-05
 Expiration Date July 30, 2020
 By Manuel Jero
 Miami Dade Product Control

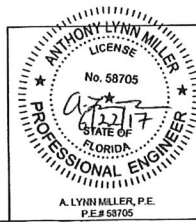

PGT
 1070 TECHNOLOGY DRIVE
 N. VENICE, FL 34275
 (941) 480-1600
 COPYRIGHT © 2017
 PGT HOLDINGS, INC.
 ALL RIGHTS RESERVED
 CERT. OF AUTH. #29206

Revision:		Description: WINDOW EXTRUSIONS		Drawn By: J ROSOWSKI	
Title: SINGLE HUNG WINDOW INSTALLATION - LM		Date: 05/15/15		Rev: B	
Series/Model: SH-5500	Scale: NTS	Sheet: 11 OF 13	Drawing No. MD-SH5500-01		

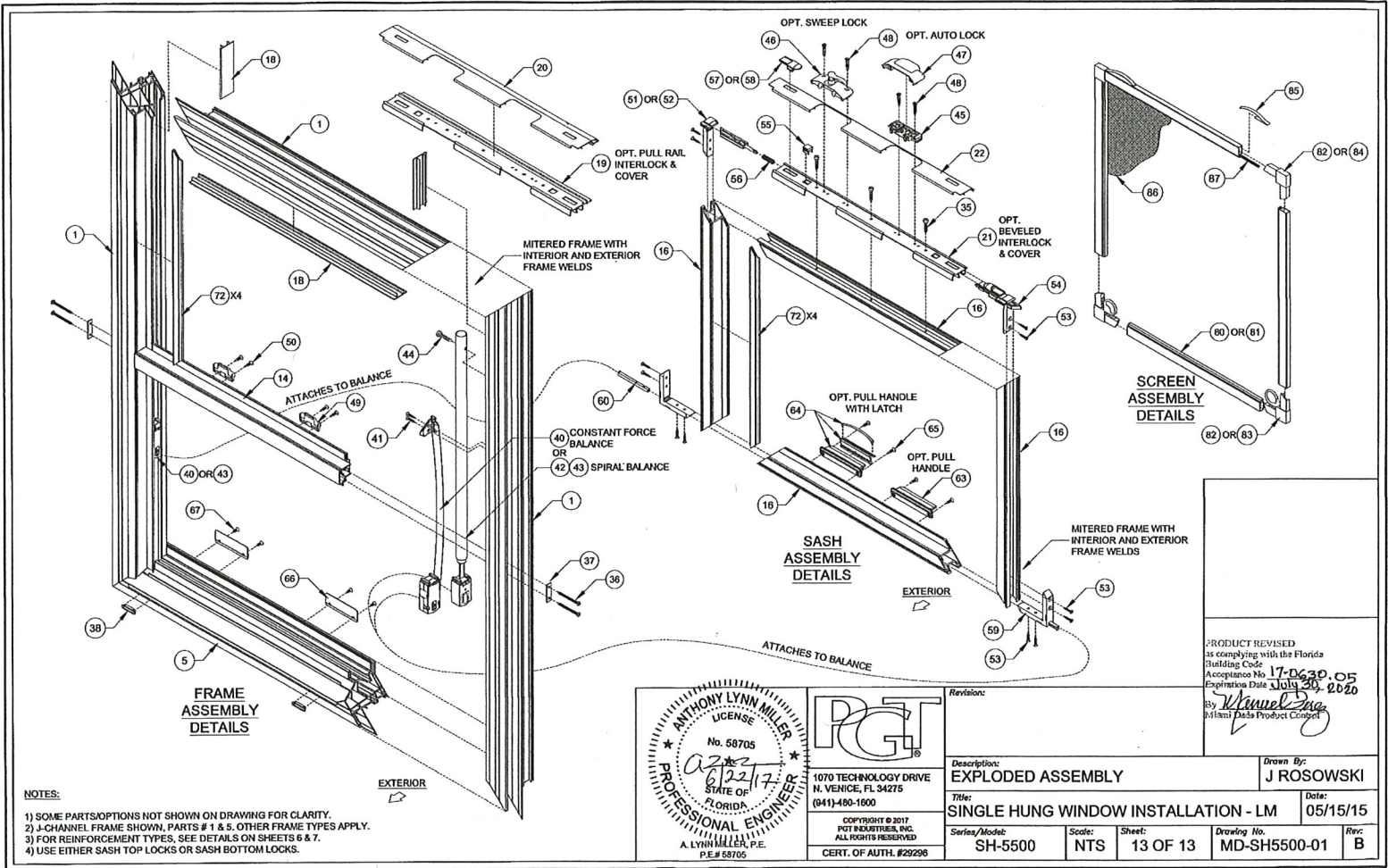

- NOTES:**
- 1) SOME PARTS/OPTIONS NOT SHOWN ON DRAWING FOR CLARITY.
 - 2) J-CHANNEL FRAME SHOWN, PARTS # 1 & 5. OTHER FRAME TYPES APPLY.
 - 3) FOR REINFORCEMENT TYPES, SEE DETAILS ON SHEETS 6 & 7.
 - 4) USE EITHER SASH TOP LOCKS OR SASH BOTTOM LOCKS.

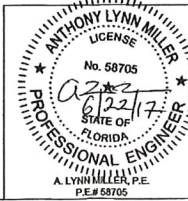

PGT
 1070 TECHNOLOGY DRIVE
 N. VENICE, FL 34275
 (941)-480-1600
 COPYRIGHT © 2017
 PGT INDUSTRIES, INC.
 ALL RIGHTS RESERVED
 CERT. OF AUTH. #29296

Revision:		Description:		Drawn By:	
		EXPLODED ASSEMBLY		J ROSOWSKI	
Title:		Date:			
SINGLE HUNG WINDOW INSTALLATION - LM		05/15/15			
Series/Model:	Scale:	Sheet:	Drawing No.	Rev:	
SH-5500	NTS	13 OF 13	MD-SH5500-01	B	

PRODUCT REVISED
 in compliance with the Florida
 Statute Code
 Acceptance No. 17-0639.05
 Expiration Date July 30, 2020
 By: *Manuel M...*
 Miami Data Product Control

TABLE 12:

#	Part #	Description	Material
1	620101	Single Hung Frame Head & Jambs - J-Channel	PVC
2	620102	Single Hung Frame Head & Jambs - Flange	PVC
3	620103	Single Hung Frame Head & Jambs - Fin	PVC
4	620104	Single Hung Frame Head & Jambs - Equal Leg/Box	PVC
5	620105	SH/DH Frame Sill - J-Channel	PVC
6	620106	SH/DH Frame Sill - Flange	PVC
7	620107	SH/DH Frame Sill - Fin	PVC
8	620108	SH/DH Frame Sill - Equal Leg/Box	PVC
14	620131	Fixed Meeting Rail	PVC
16	620129	Sash Rail (Sides, Top & Bottom)	PVC
17	620134	Balance Cover	PVC
18	620133	Sash Stop/Screw Cover	PVC
19	620156	Pull Rail Interlock	6005 T5 AI
20	620144	Pull Rail Interlock Cover	PVC
21	620157	Beveled Interlock	6005 T5 AI
22	620145	Beveled Interlock Cover	PVC
23	620150	Light Sash Reinforcement	6063 T6 AI
25	620152	HD Sash Reinforcement	6063 T6 AI
26	620153	Standard Meeting Rail Reinforcement	6005 T5 AI
27	620154	HD Meeting Rail Reinforcement	6005 T5 AI
30	61644	Weatherstrip, .187" x .270" Fin Pile	
31	6Q300	Weatherstrip, .190" x .300" Foam Bulb	Flex PVC
32	61719	Weatherstrip, .187" x .220" PolyPile	
33	61825	Weatherstrip Plug, 220° Finseal	
35	78X1MTTT	#8 x 1" Ph. PH SDS (Interlock Mounting Screw)	
38	78X3THPX	#8 x 3/4" Ph. PH SMS (Meeting Rail Screw)	410 SS
37	71668SP	Meeting Rail Screw Support Plate	6063 T6 AI
38	720210	Weep Hole Cover	PVC
40	720XXXX	Constant Force Balance	
41		#8 x 3/4" Ph. FH SMS (Con. Force Balance Screw)	SS
42		Spiral Balance	
43	720205	Spiral Balance Shoe	Nylon
44	78X114FPAX	#8 x 1-1/4" Ph. FH SMS (Spiral Balance Screw)	410 SS

TABLE 12, CONT.:

#	Part #	Description	Material
45	720197	Auto Lock Mechanism	C Steel
46	720198&9	Sweep Lock	Cast Zinc
47	720195&6	Auto Lock Cover Assembly	Cast Zinc
48	76X1180PTX	#6 x 1-1/8" Ph. FH SDS (Auto and Sweep Lock Screw)	SS
49	720200	Auto and Sweep Lock Keeper	Cast Zinc
50	776X34PPA	#6 x 3/4" Ph. PH SDS (Keeper Screw)	SS
51	420181 L/R	Beveled Tilt Latch Corner Key	PVC
52	420182 L/R	Pull Rail Tilt Latch Corner Key	PVC
53	7634PHFL	#6 x 3/4" Ph. FH SDS (Corner Key Screw)	SS
54	420183	Tilt Latch	PVC
55	420184	Tilt Latch Retainer	PVC
56	720207	1" Tilt Latch Spring	SS
57	420186	Plastic Tilt Latch Finger Pull	PVC
58	720192	Metal Tilt Latch Finger Pull	Cast Zinc
59	420180	Pivot Bar Corner Key	PVC
60	720206	Pivot Bar	SS
63	720191	Sash Pull Handle	Cast Zinc
64	720194	Sash Pull Handle With Latch Assembly	Cast Zinc
65	7834FPT	#8 x 3/4" Ph. FH SDS (Pull Handle Screw)	SS
66	420188	Bottom Latch Strike Plate	Cast Zinc
67	77858B	#8 x 5/8" Ph. FH SMS (Strike Plate Screw)	SS
72	720135	Lami I.G. Bead	PVC
74		Backbedding, GE 7700 or Dow 791	Silicone
75	71646N	Setting Block (7/8" x 1" x 1/8"), 85 +/- 5 duro.	EPDM
80	61012	Extruded Screen Frame	Alum
81	61011	Roll-Formed Screen Frame	Alum
82	7CKGLB21	Screen Corner Key for Extruded Frame X4	PVC
83	47042	Screen Corner Key with Pull Ring X2	PVC
84	47041	Screen Corner Key without Pull Ring X2	PVC
85	7CASPM	Tension Spring	SS
86	61816C48	Screen Cloth	Fiberglass
87	61835/61814	.140" Screen Spline (Machine/Hand Rolled)	Vinyl

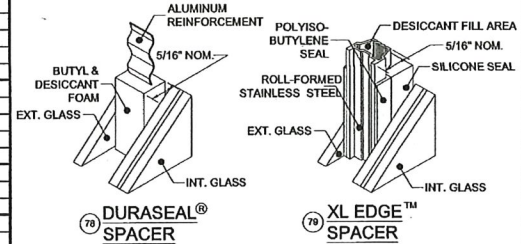
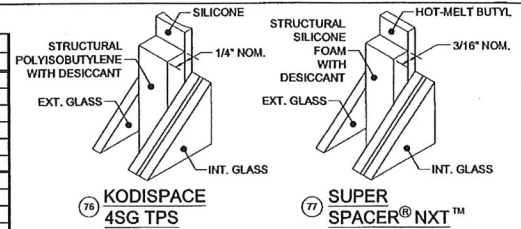

Part #	Description	Material
76	Kommerling 4SG TPS Spacer System	See this Sheet for Materials
77	Quanex Super Spacer nXT with Hot Melt Butyl	
78	Quanex Duraseal Spacer	
79	Cardinal XL Edge Spacer	

REFERENCE TEST REPORTS: FTL-8717, 8968 & 8970

NOTES:

- 1) PVC BY ENERGI WINDOW AND DOOR PROFILES, LTD. TO BE LABELED FOR AAMA EXTRUDER CODE.
- 2) ITEMS # 9-13, 15, 24, 28, 34, 39, 61, 62, 66-71, & 73 ARE NOT USED AND ARE NOT PART OF THIS APPROVAL.

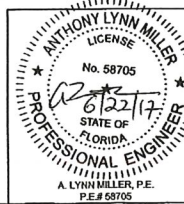

PGT
1070 TECHNOLOGY DRIVE
N. VENICE, FL 34275
(941)-480-1600
COPYRIGHT © 2017
PGT INDUSTRIES, INC.
ALL RIGHTS RESERVED
CERT. OF AUTH. #29296

Revision:

Description: **BILL OF MATERIAL (BOM)**

Title: **SINGLE HUNG WINDOW INSTALLATION - LM**

Series/Model: **SH-5500** Scale: **NTS** Sheet: **12 OF 13** Drawing No. **MD-SH5500-01** Rev: **B**

Drawn By: **J ROSOWSKI** Date: **05/15/15**

PRODUCT REVISED as complying with the Florida Building Code Acceptance No. **17-0630.05** Expiration Date **July 30, 2020**
By *Manuel Diaz*
Miami Dade Product Control