



Bldg. Permit # _____

COA# 19-62

Certificate of Appropriateness Application

Building & Site Information

Address of the Site: 410 N. 2nd St

Parcel ID #: 2403-705-0113-000-2

Type of Designation: Contributing Non-contributing Site within the Edgartown Historic District

Individually Designated Site, City Commission Resolution No. _____

Property Owner/ Applicant Information

Property Owner(s)

Name(s): Douglas and Linda Granfield

Mailing Address: 1017 S. 7th St Fort Pierce FL 34950

Phone Number(s): 603-608-7397 Email: granfieldL@gmail.com
603-608-7446

Applicant

Name(s): Douglas Granfield

Mailing Address: Same as above

Phone Number(s): 603 608 7446 Email: _____

Representative

Name(s): Michael Menard - Architectonic Inc

Mailing Address: 804 Delaware Ave Ft. Pierce, FL 34950

Phone Number(s): 772-460-7751 Email: architectonicinc.com

Property Owner(s) Acknowledgements:- This application will not be considered complete without the signature of all property owners of record, which shall serve as an acknowledgement of the submission of this application. The property owner's signature below shall also authorize the Applicant (if other than the property owner) and/or Representative to act in his/her behalf for the purposes of seeking approval for the application described herein. The undersigned consents to inspection and photographing of the subject property by the Historic Preservation staff for purposes of consideration of this Application and/or presentation to the Historic Preservation Board.

I / We, Douglas and Linda Granfield as Owner(s) of the subject property do hereby authorize the filing of this application on my/our behalf.

Douglas Granfield
Signature of Owner
Linda Granfield

9/23/19
Date

Description of Requested Work

Please indicate the type of work requested:

- Fence
- Shed GARAGE
- Door(s)
- Roof
- Window(s)
- Signage
- Shutter(s)
- Porch

- Rehabilitation
- New Construction
- Demolition
- Relocation

- Site Improvements (describe) Remodel / Rehab existing house, add wrap
- Other (describe) around porch. Build garage

Please provide a detailed description of the proposed work to be performed: House: Replace windows, siding, roof, doors. Add front porch and add a bathroom. Turn existing bathroom into a screened in porch. Add a bathroom to existing laundry room. Build a 14 x 22 foot garage, Picket Fence.

Have other alterations been made to the site within the last 12 months? No Yes, _____

Will the proposed work require a Zoning Variance? No Yes, Code Section(s): SECTION 22-28.1
SIDE SET BACK FROM 5' TO 4.9' ON NORTH & FROM 5' TO 0.7' ON SOUTH
LINE, ALSO REAR SET BACK FOR RECONSTRUCTION TO PORCH
FROM 40' TO 104' WHICH IS EXISTING

Application Requirements

- \$10.00 Application fee
- Site Plan with dimensions.
- Architectural Drawings:
 - Drawings should show all current and proposed floor plans and elevations, fences, walls, and any other landscape features.
 - Drawings should indicate materials to be used.
- Photos - One (1) color photograph of the main façade of the site and photographs of any areas affected by the proposed project.
- Material(s) specifications and/or sample(s)
- Color samples.
- Demolition - Plans for what will be taking the demolished structure's place should be submitted.

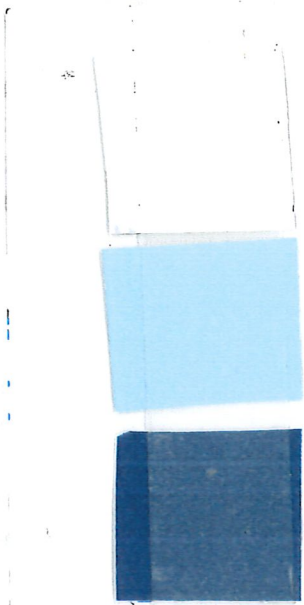

House color

trim

Doors









WHERE TO BUY ▾

LIVE CHAT

MY IDEA BOOK

DOOR IMAGINATION SYS

SEARCH

GARAGE DOORS

COMMERCIAL DOORS

ENTRY DOORS

PHOTOS

BUYING GUIDE

SERVICE & SUPPORT

CANYON RIDGE

COACHMAN

GRAND HARBOR

GALLERY

CLASSIC

MODERN STEEL

AVANTE

RESERVE

CLASSIC WOOD

HOME / RESIDENTIAL GARAGE DOORS / GRAND HARBOR COLLECTION

STEEL CARRIAGE HOUSE GARAGE DOORS



click to zoom

← Different windows



GRAND HARBOR® COLLECTION

★★★★★ (0) Write a review

steel and composite carriage house garage doors with or without insulation.



When budget is the deciding factor, this low-maintenance, insulation-optional steel frame carriage house style garage door combines clean lines and classic charm to provide a popular style at a great value.

WHERE TO BUY

SEE ON MY HOUSE

ADD TO IDEA BOOK

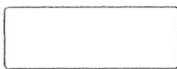

OVERVIEW

DESIGN OPTIONS

CONSTRUCTION

BROCHURE

INSTALLATION & CARE

ENTER TO WIN \$1,000!

SOLID TOP SECTIONS - SERIES 3 & SERIES 4

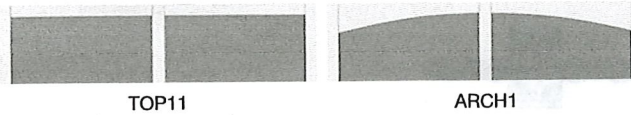

WINDOW DESIGNS

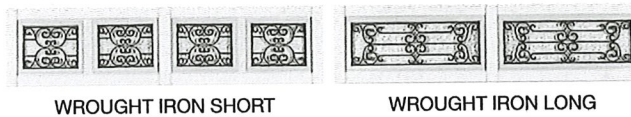
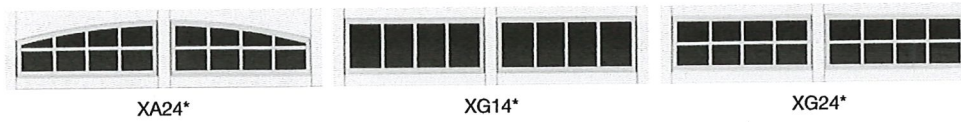
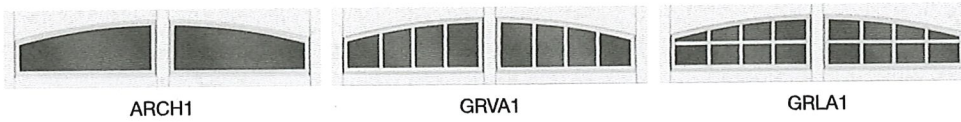
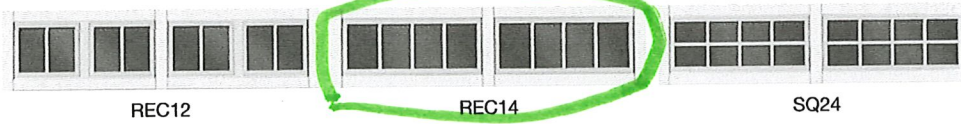
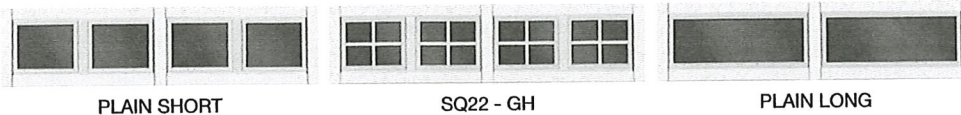

DOUBLE TOP SECTIONS



*Faux windows.

COLORS

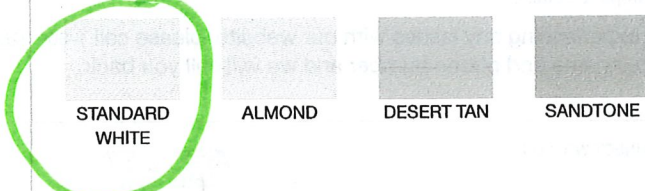

*Available on select models. For more information regarding color availability, [click here](#).
Color Blast Custom Paint Option Available.

REQUEST COLOR SAMPLES

HARDWARE DESIGNS

ENTER TO WIN \$1,000!

Glass Details

Door Surrounds



Rainglass

An elegantly fashioned glass, featuring ripples of cascading water.

Glass Privacy Rating

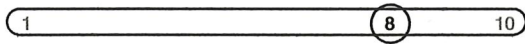

Craftsman Step - TDS-CRSLT

Add a beautiful, finished look to the entry with a stylish, low-maintenance door surround. The Craftsman Step Crosshead pairs best with High-Fashion Farmhouse, Single Barn and Craftsman-style frames. The flat trim provides a versatile look.

Jones Lumber

Phone: 772-318-6649 Fax:
7408 Commercial Circle

Ft. Pierce Florida 34951



BILL TO:

SHIP TO:

Phone:

Fax:

Phone:

Fax:

| QUOTE NAME | PROJECT NAME | CUSTOMER PO# | DATE REQUESTED |
|---------------------------|--------------|--------------|----------------|
| DOUGLAS & LINDA GRANFIELD | 410 N 2ND ST | | 1/1/0001 |
| QUOTED BY | SHIP VIA | QUOTE NUMBER | |
| fwilliams | | 42779 | |

| Line/Item # | Description | Net Price | Quantity | Extended Price |
|-------------|-------------|-----------|----------|----------------|
| 100-1 | | \$444.12 | 3 | \$1,332.36 |

Actual Size:

28" X 65"

RO:

28.5" X 65.5"

Comments:

SH 28" X 65"

| | |
|------------------------|--|
| <u>Product</u> | 9000 Dominator I Impact SH Operable 28 x 65 |
| <u>Dimensions</u> | Frame Width 28 |
| | Frame Height 65 |
| | Sash Split Even |
| <u>Unit Type</u> | Complete Unit |
| | Frame Yes |
| | Operation SHOperable |
| | Screen Yes |
| | ship separate |
| | HVHZ Unit No |
| <u>Color</u> | Unit Color Cream White |
| <u>Glass</u> | Tempered No |
| | Package Type Standard IGU |
| | Glass Package LowE Package |
| | LowE Type Florida LowE |
| | Exterior Glass Thickness 1/8" |
| | Interior Glass 090 Lami |
| | Exterior Glass Florida LowE |
| | Gas-Filled No |
| <u>Hardware</u> | Has Grilles No |
| | Balance Standard |
| | Install Clips No |
| <u>Screen</u> | Sash Limiter No |
| | Screen Option Half Screen |
| | Mesh Type Fiberglass |
| <u>Ratings</u> | FL Number 8153.1 |
| | DP+ 50 |
| | DP- 50 |
| | U-Factor 0.31 |
| | SHGC 0.21 |
| | CR 57 |
| | VT 0.48 |
| | CPD SHW-M-14-00179-00002 |
| <u>Wrapping -</u> | STC Rating 38 |
| <u>Exterior Casing</u> | Exterior Fin Option Nail Fin |
| <u>Options</u> | Fin Option All 4 Sides |
| | Pre-Punched Jamb No |

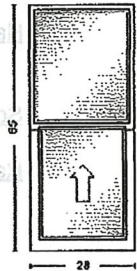

| QUOTE NAME | PROJECT NAME | CUSTOMER PO# | DATE REQUESTED |
|------------------------------|--------------|--------------|----------------|
| DOUGLAS & LINDA GRANFIELD | 410 N 2ND ST | | 1/1/0001 |
| QUOTED BY | SHIP VIA | | QUOTE NUMBER |
| fwilliams | | | 42779 |

| Line/Item # | Description | Net Price | Quantity | Extended Price |
|-------------|-------------|-----------|----------|----------------|
| 300-1 | | \$397.62 | 2 | \$795.24 |

Actual Size:

30" X 60"

RO:

30.5" X 60.5"

Comments:

SH 30" X 60"

Product Dimensions

Unit Type

Color Glass

Hardware

Screen

Ratings

Wrapping - Exterior Casing Options

| | |
|--|----------------------|
| 9000 Dominator I Impact SH Operable | 30 x 60 |
| Frame Width | 30 |
| Frame Height | 60 |
| Sash Split | Even |
| Unit Type | Complete Unit |
| Frame | Yes |
| Operation | SHOperable |
| Screen | Yes |
| ship separate | |
| HVHZ Unit | No |
| Unit Color | Cream White |
| Tempered | No |
| Package Type | Standard IGU |
| Glass Package | LowE Package |
| LowE Type | Florida LowE |
| Exterior Glass Thickness | 1/8" |
| Interior Glass | 090 Lam |
| Exterior Glass | Florida LowE |
| Gas-Filled | No |
| Has Grilles | No |
| Balance | Standard |
| Install Clips | No |
| Sash Limiter | No |
| Screen Option | Half Screen |
| Mesh Type | Fiberglass |
| FL Number | 8153.1 |
| DP+ | 50 |
| DP- | 50 |
| U-Factor | 0.31 |
| SHGC | 0.21 |
| CR | 57 |
| VT | 0.48 |
| CPD | SHW-M-14-00179-00002 |
| STC Rating | 38 |
| Exterior Fin Option | Nail Fin |
| Fin Option | All 4 Sides |
| Pre-Punched Jamb | No |

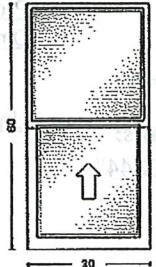

| | | | |
|------------------------------|---------------------|---------------------|-----------------------|
| QUOTE NAME | PROJECT NAME | CUSTOMER PO# | DATE REQUESTED |
| DOUGLAS & LINDA GRANFIELD | 410 N 2ND ST | | 1/1/0001 |
| QUOTED BY | | SHIP VIA | QUOTE NUMBER |
| fwilliams | | | 42779 |

| Line/Item # | Description | Net Price | Quantity | Extended Price |
|-------------|-------------|------------|----------|----------------|
| 500-1 | | \$1,588.71 | 1 | \$1,588.71 |

Actual Size:

72" X 80"

RO:

72.5" X 80.5"

Comments:

SGD 72 X 80

| | |
|------------------------|---|
| <u>Product</u> | 9700 Guardian I Impact Double Sliding Door XO 72 x 80 |
| <u>Dimensions</u> | Frame Width 72 Frame Height 80 |
| <u>Unit Type</u> | Unit Type Complete Unit |
| | Frame Yes |
| | Operation XO |
| | Shipping Method Standard |
| | Screen Yes |
| | ship separate |
| | Knockdown Frame No |
| <u>Color</u> | Unit Color Cream White |
| <u>Glass</u> | Tempered Yes |
| | Package Type Standard IGU |
| | Glass Package LowE Package |
| | LowE Type Soft-Coat Florida LowE |
| | Exterior Glass Thickness 3/16" |
| | Interior Glass 090 Lami |
| | Exterior Glass Florida LowE |
| | Gas-Filled No |
| | Has Grilles No |
| <u>Hardware</u> | Handle Color Color Matched |
| | Handle Type Standard |
| | Key Cylinder No |
| | Install Clips Yes |
| <u>Screen</u> | Screen Option Deluxe |
| | Mesh Type Fiberglass |
| <u>Ratings</u> | FL Number 12519.3 |
| | DP+ 50 |
| | DP- 50 |
| | U-Factor 0.37 |
| | SHGC 0.18 |
| | CR 48 |
| | VT 0.39 |
| | CPD SHW-M-22-00021-00003 |
| <u>Wrapping -</u> | Exterior Fin Option Nail Fin |
| <u>Exterior Casing</u> | Pre-Punched Jamb No |
| <u>Options</u> | |

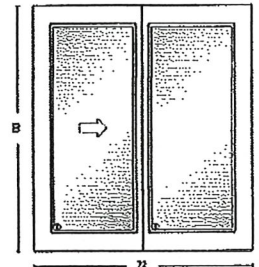

CUSTOMER SIGNATURE _____ DATE _____

We appreciate the opportunity to provide you with this quote!

| | |
|---------------|-------------------|
| SUB-TOTAL | \$6,840.97 |
| SETUP | \$0.00 |
| LABOR | \$0.00 |
| FREIGHT | \$0.00 |
| SALES TAX | \$478.88 |
| TOTAL: | \$7,319.85 |
| DEPOSIT | (\$0.00) |
| BALANCE | \$7,319.85 |

| |
|---------------------|
| Quote Expires |
| Quote Not Certified |

**Boundary & Topographic Survey For:
Douglas & Linda Granfield**

LEGAL DESCRIPTION:

BEGINNING 80 FEET SOUTH OF THE NORTHWEST CORNER OF LOT 5, BLOCK 12(G) OF ASSESSOR'S MAP OF NORTH FORT PIERCE, AS PER PLAT BOOK 1, PAGE 164, OF THE PUBLIC RECORDS OF SAINT LUCIE COUNTY, FLORIDA, RUN THENCE SOUTHERLY ALONG THE WEST LINE OF SAID LOT 5, A DISTANCE OF 80 FEET FOR THE POINT OF BEGINNING, THENCE CONTINUE SOUTHERLY 50 FEET ALONG SAID WEST LINE OF LOT 5, THENCE TURN AND RUN EAST 90 FEET, THENCE RUN NORTH 50 FEET AND THENCE RUN WEST 90 FEET TO THE POINT OF BEGINNING.

STREET ADDRESS:

410 N 2ND STREET, FORT PIERCE, FL 34950

LEGEND & ABBREVIATIONS:

| | | | |
|------|------------------------------------|-------|--------------------------------|
| A/C | AIR CONDITIONER | ORP | OFFICIAL RECORDS BOOK |
| B/S | BUILDING SETBACK LINE | P | PLAT BOOK |
| C | CALCULATED FROM FIELD MEASUREMENTS | PC | PLAT CONTROL POINT |
| CONG | CONCRETE BLOCK STRUCTURE | PC(S) | PLAT CONTROL POINT(S) |
| CM | CONCRETE MONUMENT | POB | POINT OF BEGINNING |
| C/L | CENTERLINE | POC | POINT OF COMMENCEMENT |
| ELEV | ELEVATION | PSM | PROFESSIONAL SURVEYOR & MAPPER |
| FFE | FINISH FLOOR ELEVATION | R/W | RIGHT OF WAY |
| FND | FOUND | TOB | TOP OF BANK |
| IR | IRON PIPE | TOE | TOE OF SLOPE |
| IP | IRON ROD | US | ELEVATION (TYPICAL) |
| IRP | IRON ROD & CAP | W | WATER METER |
| IRP | IRON ROD & CAP | WM | WATER METER |
| LB | LICENSED BUSINESS | WMP | WATER MAIN/POLE |
| LS | LICENSED SURVEYOR | Δ | DELTA |
| M | MEASURED DATA | ⊕ | ELECTRIC SERVICE BOX |
| NAD | NORTH AMERICAN DATUM | ⊕ | TELEPHONE SERVICE BOX |
| NAVD | NORTH AMERICAN VERTICAL DATUM | | |

GENERAL NOTES:

1. THE EXPLECTED USE OF THIS SURVEY AND/OR MAP IS RESIDENTIAL.
2. ADDITIONS OR DELETIONS TO THIS SURVEY AND/OR MAP IS NOT CERTIFIED BY THE SIGNING FLORIDA LICENSED SURVEYOR & MAPPER.
3. REPRODUCTIONS OF THIS MAP ARE NOT VALID WITHOUT THE SIGNATURE AND ORIGINAL SEAL OF A FLORIDA LICENSED SURVEYOR & MAPPER.
4. THE BEARINGS SHOWN HEREON ARE REFERENCED TO THE CENTERLINE OF 2ND STREET HAVING A BEARING OF S01°01'38"E, ACCORDING TO THE ASSESSOR'S MAP OF NORTH FORT PIERCE, AS RECORDED IN PLAT BOOK 1, PAGE 164, PUBLIC RECORDS, SAINT LUCIE COUNTY, FLORIDA, (ASSUMED DATUM).
5. FLOOD NOTE: BY GRAPHIC PLOTTING ONLY, THIS PROPERTY IS IN ZONE "X", ACCORDING TO THE FLOOD INSURANCE RATE MAP, COMMERCIAL RISK MAP, C-0179 J, EFFECTIVE DATE FEBRUARY 16, 2012. THE EXACT DESIGNATION CAN ONLY BE DETERMINED BY AN ELEVATION CERTIFICATE.
6. ELEVATIONS, IF SHOWN, ARE IN NORTH AMERICAN VERTICAL DATUM (NAVD) OF 1988.
7. ALL MEASUREMENTS ARE IN ACCORDANCE WITH UNITED STATES STANDARDS, IN FEET AND DECIMALS THEREOF.
8. ALL ABOVE GROUND FIXED IMPROVEMENTS, IF ANY, HAVE BEEN LOCATED AND SHOWN HEREON.
9. UNDERGROUND UTILITIES AND UTILITY SERVICES HAVE NOT BEEN LOCATED ON THIS SURVEY.
10. THE SURVEYOR HAS NO KNOWLEDGE OF UNDERGROUND FOUNDATIONS WHICH MAY OCCUPY LAND SURVEYED OR LAND OF OTHERS.
11. LANDS SHOWN HEREON WERE NOT ABSTRACTED BY THIS OFFICE FOR RIGHTS-OF-WAY, EASEMENTS OF RECORD, OWNERSHIP, ABANDONMENT'S DEED RESTRICTIONS, OR MURPHY ACT DEEDS.
12. THE LAST DATE OF FIELD WORK WAS AUGUST 21, 2019.

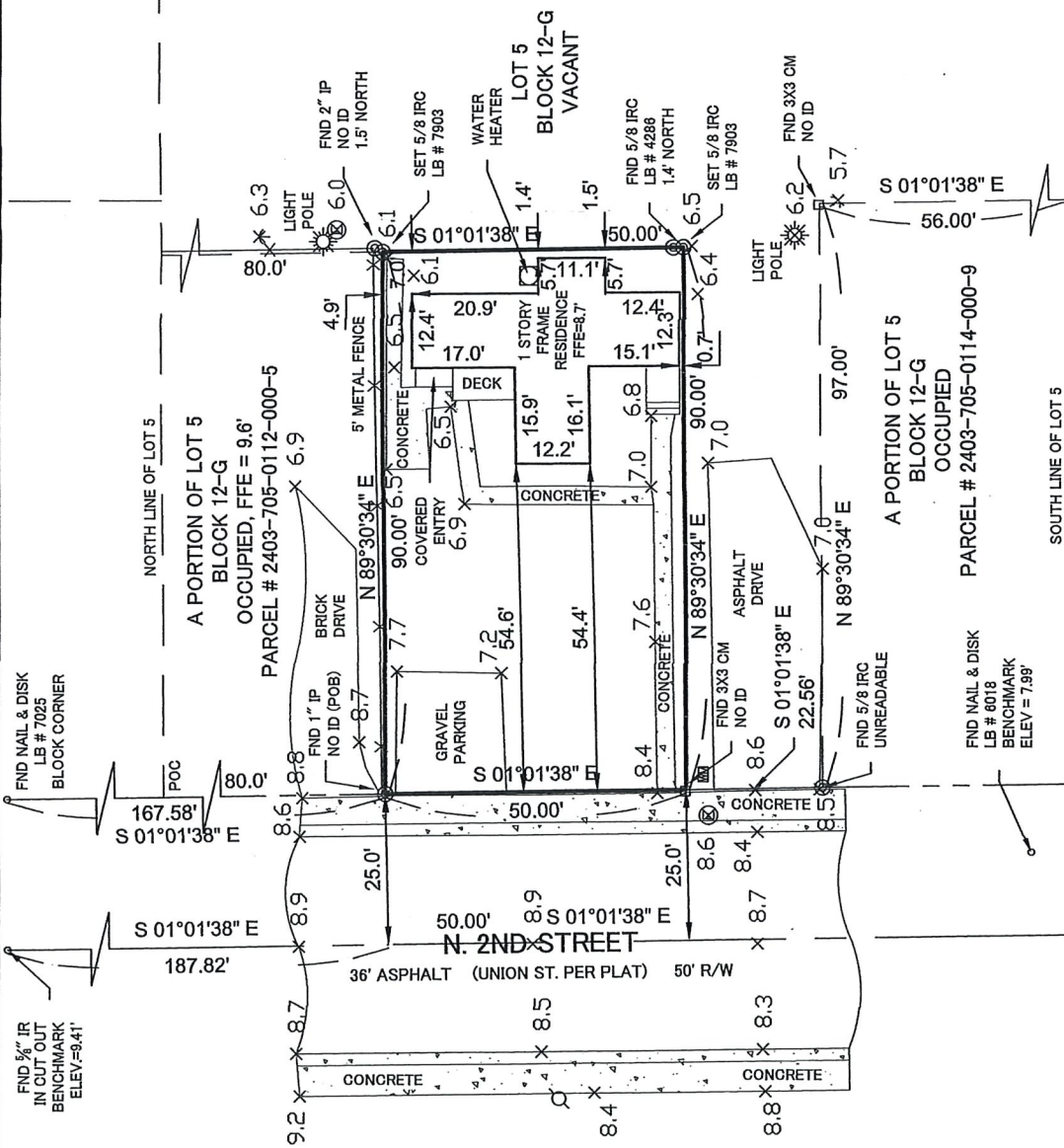

ARNOLD SURVEYING, INC.
PROFESSIONAL SURVEYORS AND MAPPERS
FLORIDA LICENSED BUSINESS NUMBER 7903
4888 N. WINDS HIGHWAY #48, FORT PIERCE, FLORIDA 34981
(772) 708-1819 SURVEY@ASI-SURVEY.COM

JOB NO. 19-530
DATE: 08/24/2019
SCALE: 1"=20'
DRAWN BY: CA
REVIEWED BY: CA

© COPYRIGHT ARNOLD SURVEYING, INC.
ALL DRAWINGS OR DOCUMENTS AND COPIES THEREOF ARE INSTRUCTIONS OF SERVICE AND REMAIN THE PROPERTY OF ARNOLD SURVEYING, INC. THE REPRODUCTION OR UNAUTHORIZED USE OF THESE DRAWINGS OR ANY OTHER PROJECT DOCUMENTS WITHOUT WRITTEN PERMISSION FROM ARNOLD SURVEYING, INC. IS STRICTLY PROHIBITED. THIS DRAWING OR DOCUMENT IS PROTECTED BY FEDERAL COPYRIGHT LAWS.

CHARLES ARNOLD DATE SIGNED
PROFESSIONAL SURVEYOR & MAPPER
FLORIDA LICENSE NO. 4971

CERTIFIED TO:
DOUGLAS G. GRANFIELD;
LINDA GRANFIELD;

