

Michelle Franklin, CFA -- Saint Lucie County Property Appraiser -- All rights reserved.

Property Identification

Site Address: 3205 BOSTON AVE Map ID: 24/08S Parcel ID: 2408-805-0013-000-3 Zoning: R3 Account #: 20874 Use Type: 0100 Sec/Town/Range: 08/35S/40E Jurisdiction: Fort Pierce

Ownership

Pedro Moreno
3205 Boston Ave
Fort Pierce, FL 34950

Legal Description

WYLDWOOD PARK S/D BLK 2 LOT 3 (OR 1399-305)

Current Values

Just/Market: \$31,100 Assessed: \$14,275
Exemptions: \$14,275 Taxable: \$0

Historical Values 3-year

Year	Just/Market	Assessed	Exemptions	Taxable
2018	\$31,100	\$14,275	\$14,275	\$0
2017	\$18,300	\$13,982	\$13,982	\$0
2016	\$15,000	\$13,695	\$13,695	\$0

Sale History

Date	Book/Page	Sale Code	Deed	Grantor	Price
05-07-2001	1399 / 0305	XX01	QC	Adams Vicki	\$46,000
11-13-1995	0984 / 0854	XX01	WD	Bates Edward C	\$36,000
12-18-1989	0668 / 2726	XX00	WD	Donald A Watts	\$92,000

Primary Building Information

Finished Area of this building: 606 SF
Gross Sketched Area: 1,394 SF

Exterior Data

View: Roof Cover: Fibrglss Shg Roof Structure: Gable Building Type: HD
Year Built: 1950 Frame: Grade: D Effective Year: 1950
Primary Wall: Wood no Sh Story Height: 1 Story No. Units: 1 Secondary Wall:

Interior Data

Bedrooms: 2 A/C %: 0% Electric: MAXIMUM Primary Int Wall:
Full Baths: 1 Heated %: 0% Heat Type: Avg Hgt/Floor: 0
Half Baths: 0 Sprinkled %: N/A% Heat Fuel: Primary Floors: Double Pine

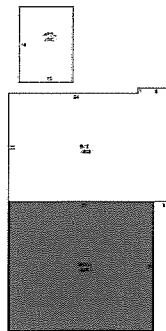

Total Areas

Finished/Under Air (SF):	1,086
Gross Sketched Area (SF):	2,112
Land Size (acres):	0.17
Land Size (SF):	7,224
Total Building Count:	2

Special Features and Yard Items

Type	Qty	Units	Year Blt
CHAINLINK 4'	1	21	2004

All information is believed to be correct at this time, but is subject to change and is provided without any warranty.
© Copyright 2019 Saint Lucie County Property Appraiser. All rights reserved.