

**GENERAL NOTES**

PROJECT NAME: FRESH WIND FRESH FIRE CHURCH  
 OWNER: Fresh Wind Fresh Fire Inc.  
 LOCATION: 2000 N. 43rd Street, Ft. Pierce FL 34947  
 CURRENT ZONING: R-4 & C-3  
 FUTURE LAND USE: RM & GC  
 CURRENT USE: VACANT  
 PIN#: Lots(1&16) 2408-501-0003-0007  
 Lots(1,2,3,4&5) 2408-507-0133-0005

**LEGAL DESCRIPTION:**

LOTS 1, LESS THE EAST 10, AND ALL OF LOT 16, BLOCK 1, EMANCIPATION PARK, ACCORDING TO THE PLAT THEREOF AS RECORDED IN PLAT BOOK 1, AT PAGE 38, OF THE PUBLIC RECORDS OF ST. LUCIE COUNTY, FLORIDA, TOGETHER WITH LOT 1 LESS THE EAST 10 FEET, AND ALL OF LOTS 2, 3, 4 AND 5, BLOCK 15, FORT PIERCE PARK SUBDIVISION, ACCORDING TO THE PLAT THEREOF AS RECORDED IN PLAT BOOK 1, PAGE 39, OF THE PUBLIC RECORDS OF ST. LUCIE COUNTY, FLORIDA.

BUILDING HEIGHT: 30.0 FEET  
 NUMBER OF STORIES: ONE

**UTILITIES**  
 ELECTRICAL: FPUA  
 WATER & SEWER: FPUA FOR WATER AND WASTEWATER  
 SOLID WASTE: BELL SOUTH PIERCE SOLID WASTE  
**NOTE:** ALL UTILITIES SHALL BE INSTALLED UNDERGROUND

**AREA TABULATION**

SITE COVERAGE	SF	ACREAGE	% OF SITE
PROP. BLDG	5610	0.1288	7.25
COVERED ENTRY	180	0.0041	0.23
UTILITY SHED	400	0.0069	0.53
SIDEWALKS/PADS	3190	0.0732	4.12
PAVED AREA	30049	0.6898	38.85
TOTAL IMPERVIOUS	39429	0.9052	50.98
STABILIZED GRASS PKG	8576	0.1969	11.09
GREEN AREA	29335	0.6734	37.93
TOTAL	77340	1.7755	100.00

**PARKING CALCULATIONS**

PARKING SPACES REQUIRED: 220 SEATS/1 PKG SPACE PER 3 SEATS = 73.00 SPACES  
 ADD 15%: 73.33 SPACES x 15% = 11.00 SPACES  
 STABILIZED GRASS PKG: TOTAL 84.00 SPACES  
 PARKING PROVIDED: 81 REGULAR, 4 H.C. TOTAL 85.00 SPACES  
 % OF PAVED PARKING: 4 H.C., 57 REG SPACES = 61 SPACES  
 MIN% OF PAVED PKG SPACES 50%, PROVIDED 72%  
 % OF GRASS PARKING: 24 REG. SPACES, 28%

**BUILDING SETBACKS**

BUILDING	
FRONT	39.00 FT
REAR	127.00 FT
LEFT SIDE	22.00 FT
RIGHT SIDE	168.11 FT

PROPERTY LIES IN F.I.R.M. ZONE X & "AE"(EL 21) AS SCALED FROM THE NATIONAL FLOOD INSURANCE RATE MAP, PANEL NUMBER 12111C0178J DATED FEB 16, 2012

**STORMWATER STATEMENT:**

PROPOSED STORMWATER DRAINAGE SYSTEM WILL CONSIST OF DETENTION AREA, CULVERTS AND A CONTROL STRUCTURE & MUST COMPLY WITH CITY OF PIERCE CH 17&22

**HAZARDOUS WASTE:**

ANY & ALL HAZARDOUS OR TOXIC MATERIALS GENERATED OR USED OR STORED ON SITE SHALL BE DISPOSED OF IN ACCORDANCE WITH ALL LOCAL, STATE AND FEDERAL REGULATIONS

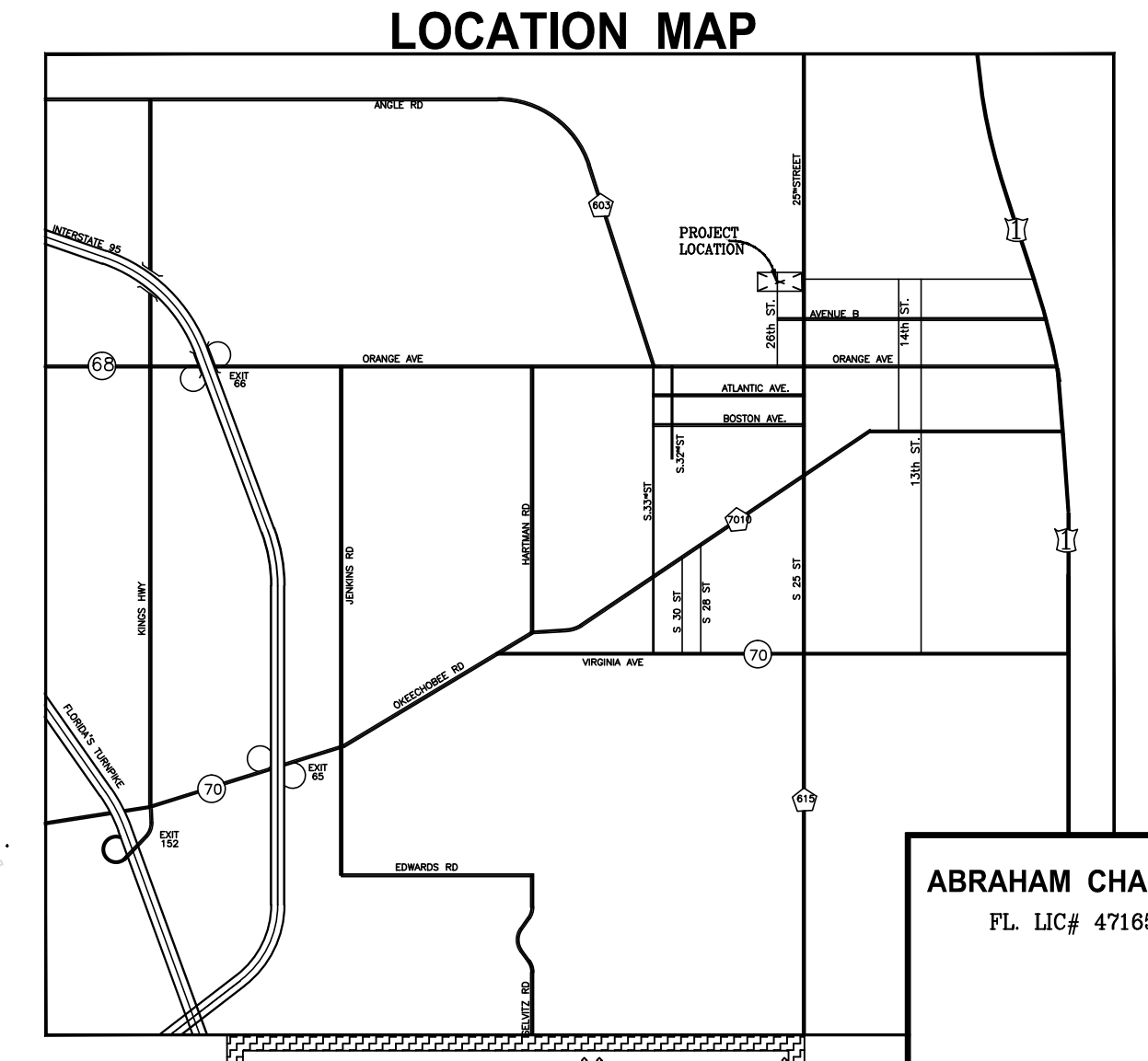

ABRAHAM CHABAB, PE  
 FL LIC# 47185

SCALE 1" = 20'

**ABRAHAM CHABAB, Inc.**  
 FL BOARD OF PROF. ENG. AUTH.#26790  
 5428 NW EDGEWATER AVE  
 PORT ST. LUCIE FL 34983  
 Email agchababi@msn.com  
 772 878-5079/475-6630  
 Fax 772 785-8291

**FRESH WIND FRESH FIRE CHURCH**  
**SITE PLAN**

DESIGNED BY	AC	TRC Cmts	DATE
DRAWN BY	AC		
DATE	Aug. 30/17		
SHEET	1 OF 1		