

Michelle Franklin, CFA -- Saint Lucie County Property Appraiser -- All rights reserved.

Property Identification

Site Address: 2911 OKEECHOBEE RD
 Sec/Town/Range: 17/35S/40E
 Map ID: 24/17N
 Zoning: General Co

Parcel ID: 2417-506-0018-000-8
 Account #: 26692
 Use Type: 1100
 Jurisdiction: Fort Pierce

Ownership

ID 2911 LLC
 18651 SW 39th ST
 Miramar, FL 33029

Legal Description

FAIRLAWN S/D BLK 1 LOTS 18 TO 32 INC-LESS OKEE RD R/W AND LESS E 5 FT LOTS 18, 19 AND 20 AS IN OR 328-417- (OR 1846-797)

Current Values

Just/Market Value: \$486,500
 Assessed Value: \$486,500
 Exemptions: \$0
 Taxable Value: \$486,500



Total Areas

Finished/Under Air (SF): 7,802
 Gross Sketched Area (SF): 8,160
 Land Size (acres): 1.11
 Land Size (SF): 48,184

Property taxes are subject to change upon change of ownership.

- Past taxes are not a reliable projection of future taxes.
- The sale of a property will prompt the removal of all exemptions, assessment caps, and special classifications.

Taxes for this parcel: SLC Tax Collector's Office
 Download TRIM for this parcel: [Download PDF](#)

Sale History

Date	Book/Page	Sale Code	Deed	Grantor	Price
Nov 7, 2003	1846 / 0797	XX00	WD	Addison Michael T	\$335,000
Oct 26, 1994	0926 / 1998	XX01	WD	Michael T Addison	\$100
Dec 20, 1989	0670 / 0117	XX01	PR	Clara G Addison	\$100
Aug 15, 1989	0651 / 0006	XX01	WI		\$0

Building Information (1 of 1)

Finished Area: 7,802 SF

Gross Sketched Area: 8,160 SF

Exterior Data

View:
 Building Type: STRH
 Grade: Y_C
 Story Height: 1 Story

Roof Cover: Tar & Gravel
 Year Built: 1960
 Effective Year: 1960
 No. Units: 1

Roof Structure: Flat/Shed
 Frame:
 Primary Wall: CB Stucco
 Secondary Wall:

Interior Data

Bedrooms: 0
 Full Baths: 0
 Half Baths: 0

Electric: MAXIMUM
 Heat Type: FrcdHotAir
 Heat Fuel: ELEC

Primary Int Wall:
 Avg Hgt/Floor: 0
 Primary Floors: Terrazo

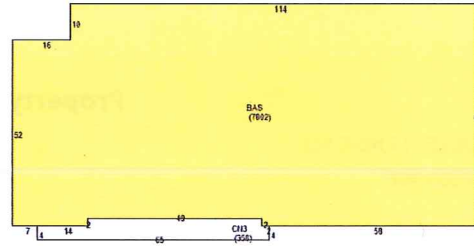

Sketch Area Legend

Sub Area	Description	Area	Fin. Area	Perimeter
BAS	BASE AREA	7802	7802	388
CN3	CANOPY	358	0	142

Special Features and Yard Items

Type	Qty	Units	Year Blt
CONCRETE LOW	1	140	1979
ASP2 LOW	1	28100	1979

Current Year Values

Current Values Breakdown		Current Year Exemption Value Breakdown				
		Tax Year	Grant Year	Code	Description	Amount
Building:	\$223,000					
Land:	\$263,500					
Just/Market:	\$486,500					
Ag Credit:	\$0					
Save Our Homes or 10% Cap:	\$0					
Assessed:	\$486,500					
Exemption(s):	\$0					
Taxable:	\$486,500					

Current Year Special Assessment Breakdown

Start Year	AssessCode	Units	Description	Amount
1999	0041	15.6	Fort Pierce Stormwater Charge	\$1,076.40

This does not necessarily represent the total Special Assessments that could be charged against this property. The total amount charged for special assessments is reflected on the most current tax statement and information is available with the SLC Tax Collector's Office

Historical Values

Year	Just/Market	Assessed	Exemptions	Taxable
2020	\$486,500	\$486,500	\$0	\$486,500
2019	\$489,800	\$453,871	\$0	\$453,871
2018	\$468,500	\$412,610	\$0	\$412,610
2017	\$375,100	\$375,100	\$0	\$375,100

Permits