

Michelle Franklin, CFA -- Saint Lucie County Property Appraiser -- All rights reserved.

**Property Identification**

Site Address: 119 N 11th ST  
 Sec/Town/Range: 09/35S/40E  
 Map ID: 24/09N  
 Zoning: Medium Den

Parcel ID: 2409-516-0017-000-7  
 Account #: 21594  
 Use Type: 0100  
 Jurisdiction: Fort Pierce

**Ownership**

Atlantic 509 LLC  
 709 Neapolitan WAY  
 Naples, FL 34103-8502

**Legal Description**

M E GOLDSMITH'S S/D BLK 1 LOT 17(OR 4099-1402)

**Current Values**

Just/Market Value: \$71,200  
 Assessed Value: \$71,200  
 Exemptions: \$0  
 Taxable Value: \$71,200



**Property taxes are subject to change upon change of ownership.**

- Past taxes are not a reliable projection of future taxes.
- The sale of a property will prompt the removal of all exemptions, assessment caps, and special classifications.

**Total Areas**

Finished/Under Air (SF): 2,116  
 Gross Sketched Area (SF): 2,212  
 Land Size (acres): 0.25  
 Land Size (SF): 10,980

Taxes for this parcel: SLC Tax Collector's Office  
 Download TRIM for this parcel: [Download PDF](#)

**Sale History**

Date	Book/Page	Sale Code	Deed	Grantor	Price
Feb 12, 2018	4099 / 1402	0119	TR	Jean-Pierre Mireille	\$60,000
Sep 14, 2005	2364 / 1472	XX00	WD	Rochester Herbert	\$120,000
Jun 14, 2005	2275 / 0102	XX01	QC	Charles Wadson	\$100
May 23, 2000	1302 / 0337	XX01	WD	Sunrise City Properties LLC	\$45,000
May 23, 2000	1302 / 0336	XX01	QC	Maudlin Arthur	\$35,000
Feb 16, 2000	1280 / 1924	XX01	WD	Sunrise City Properties LLC	\$35,000
Feb 15, 2000	1280 / 1169	XX02	CT	M Tucker Enterprise Inc	\$100
Nov 14, 1995	1192 / 1775	XX00	QC	McKenzie Alisa	\$30,000
Nov 6, 1995	0984 / 2503	XX00	WD	Herbert Rochester	\$45,000
Dec 29, 1993	0877 / 0939	XX01	QC	FINANCIAL DATA SOURCE INC	\$100
Dec 3, 1993	0872 / 2031	XX01	WD	Jose L Luna-Garcia	\$5,800
Nov 19, 1992	0817 / 1362	XX00	WD		\$6,000

**Building Information (1 of 1)**

Finished Area: 2,116 SF

Gross Sketched Area: 2,212 SF

**Exterior Data**

View:	Roof Cover: Tar & Gravel	Roof Structure: Flat/Shed
Building Type: HD+	Year Built: 1926	Frame:
Grade: D+	Effective Year: 1966	Primary Wall: CB Stucco
Story Height: 2 Story	No. Units: 1	Secondary Wall:

Property Card

Bedrooms: 4  
 Full Baths: 2  
 Half Baths: 0  
 A/C %: 0%

Electric: MAXIMUM  
 Heat Type:  
 Heat Fuel:  
 Heated %: 0%

Primary Int Wall:  
 Avg Hgt/Floor: 0  
 Primary Floors: Double Pine  
 Sprinkled %: N/A%

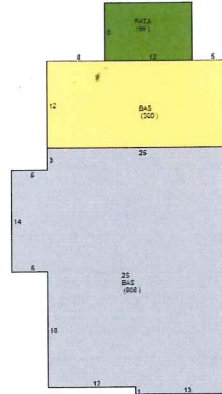

Sketch Area Legend

Sub Area	Description	Area	Fin. Area	Perimeter
2S	ONE FULL STORY OVER BASE (TOTAL 2 FLOORS)	908	908	128
BAS	BASE AREA	1208	1208	202
PATA	Patio Average (Plain Slab)	96	0	40

Special Features and Yard Items

Type	Qty	Units	Year Blt
CHAINLINK 4'	1	400	1979

Current Year Values

Current Values Breakdown

Building:	\$59,100
Land:	\$12,100
Just/Market:	\$71,200
Ag Credit:	\$0
Save Our Homes or 10% Cap:	\$0
Assessed:	\$71,200
Exemption(s):	\$0
Taxable:	\$71,200

Current Year Exemption Value Breakdown

Tax Year	Grant Year	Code	Description	Amount
----------	------------	------	-------------	--------

Current Year Special Assessment Breakdown

Start Year	AssessCode	Units	Description	Amount
1999	0041	1	Fort Pierce Stormwater Charge	\$69.00

This does not necessarily represent the total Special Assessments that could be charged against this property. The total amount charged for special assessments is reflected on the most current tax statement and information is available with the SLC Tax Collector's Office

Year	Just/Market	Assessed	Exemptions	Taxable
2020	\$71,200	\$71,200	\$0	\$71,200
2019	\$70,900	\$70,900	\$0	\$70,900
2018	\$62,300	\$51,150	\$0	\$51,150
2017	\$46,500	\$46,500	\$0	\$46,500

### Permits

Number	Issue Date	Description	Amount	Fee
BP11-0185	Dec 19, 2011	Alterations/Remodeling	\$6,000	\$129
F00-000362	Mar 22, 2000	Alterations/Remodeling	\$10,000	\$0
F93-001651	Dec 29, 1993	Alterations/Remodeling	\$3,500	\$3,500
0800001355	Aug 7, 2008	Alterations/Remodeling	\$1,000	\$50
bp11-0185	Feb 14, 2011	Demolition	\$6,000	\$79
BP13-2540	Jul 30, 2013	Plumbing	\$1,500	\$79
BP19-3709	Nov 19, 2019	Roof	\$11,500	\$0

Notice: This does not necessarily represent all the permits for this property.

Click the following link to check for additional permit data in Fort Pierce

All information is believed to be correct at this time, but is subject to change and is provided without any warranty.

© Copyright 2020 Saint Lucie County Property Appraiser. All rights reserved.