

### Property Identification

Site Address: 500 S 10th ST  
Sec/Town/Range: 10/35S/40E  
Parcel ID: 2410-709-0017-000-3  
Jurisdiction: Fort Pierce

Use Type: 1700  
Account #: 23660  
Map ID: 24/10S  
Zoning: Office Co

### Ownership

Women's Care Center Inc  
360 N Notre Dame AVE  
South Bend, IN 46617

### Legal Description

OAKLAND PARK BLK 4 W 1/2 OF LOT 2 AND ALL LOTS 3, 4 AND 5  
(MAP 24/10F)

### Current Values

Just/Market Value: \$100,100  
Assessed Value: \$100,100  
Exemptions: \$0  
Taxable Value: \$100,100



### Property taxes are subject to change upon change of ownership.

- Past taxes are not a reliable projection of future taxes.
- The sale of a property will prompt the removal of all exemptions, assessment caps, and special classifications.

### Total Areas

Finished/Under Air (SF): 1,243  
Gross Sketched Area (SF): 1,258  
Land Size (acres): 0.56  
Land Size (SF): 24,570

Taxes for this parcel: SLC Tax Collector's Office   
Download TRIM for this parcel: [Download PDF](#)

### Building Design Wind Speed

Occupancy Category	I	II	III & IV
Speed	140	160	160

### Sale History

Date: Oct 29, 2020  
Book/Page: 4502 / 2319  
Sale Code: 0001  
Deed: WD  
Grantor: Lennon Ethan B  
Price: \$135,000

Date: Dec 26, 2017  
Book/Page: 4082 / 0428  
Sale Code: 0001  
Deed: WD  
Grantor: Pickering Keith C  
Price: \$75,000

Date: Jul 23, 1996  
Book/Page: 1027 / 2412

Sale Code:	XX01
Deed:	WD
Grantor:	JEFFERSON BANK OF FLORIDA
Price:	\$31,000
Date:	Jun 6, 1995
Book/Page:	0959 / 0903
Sale Code:	XX01
Deed:	CT
Grantor:	Jacqueline G Jones
Price:	\$100
Date:	Sep 29, 1991
Book/Page:	0757 / 1983
Sale Code:	XX01
Deed:	QC
Grantor:	INDIAN RIVER LTD
Price:	\$100
Date:	Mar 1, 1987
Book/Page:	0533 / 1080
Sale Code:	XX01
Deed:	CV
Grantor:	
Price:	\$0
Date:	Oct 1, 1986
Book/Page:	0521 / 0535
Sale Code:	XX01
Deed:	CV
Grantor:	
Price:	\$0

### Building Information (1 of 1)

Finished Area: 1,243 SF

Gross Sketched Area: 1,258 SF

#### Exterior Data

View:  
 Building Type: LROF  
 Grade: Y\_D  
 Story Height: 1 Story

Roof Cover: Metal  
 Year Built: 1920  
 Effective Year: 1945  
 No. Units: 1

Roof Structure: Gable  
 Frame: Conc Blk  
 Primary Wall: Wood/Sheath  
 Secondary Wall:

#### Interior Data

Bedrooms: 0  
 Full Baths: 0  
 Half Baths: 0  
 A/C %: 100%

Electric: MAXIMUM  
 Heat Type: FrcdHotAir  
 Heat Fuel: ELEC  
 Heated %: 100%

Primary Int Wall:  
 Avg Hgt/Floor: 0  
 Primary Floors: Carpet  
 Sprinkled %: 0%

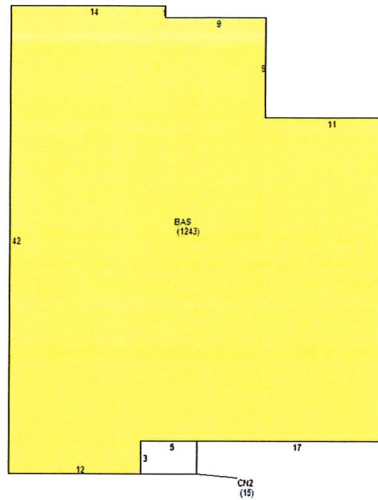

### Special Features and Yard Items

Type	Qty	Units	Year Blt
WOOD FEN 6'	1	87	1999

### Current Year Values

#### Current Values Breakdown

Building:	\$14,100
Land:	\$86,000
Just/Market:	\$100,100
Ag Credit:	\$0
Save Our Homes or 10% Cap:	\$0
Assessed:	\$100,100
Exemption(s):	\$0
Taxable:	\$100,100

#### Current Year Exemption Value Breakdown

### Current Year Special Assessment Breakdown

Start Year	AssessCode	Units	Description	Amount
1999	0041	1.7	Fort Pierce Stormwater Charge	\$117.30

This does not necessarily represent the total Special Assessments that could be charged against this property. The total amount charged for special assessments is reflected on the most current tax statement and information is available with the SLC Tax Collector's Office ☐.

### Historical Values

Year	Just/Market	Assessed	Exemptions	Taxable
2020	\$100,100	\$100,100	\$0	\$100,100
2019	\$100,600	\$100,600	\$0	\$100,600
2018	\$99,300	\$99,300	\$0	\$99,300

### Permits

Number	Issue Date	Description	Amount	Fee
SH2003-26	Jun 12, 2003	Shed	\$1,967	\$100
0800000006	Jan 2, 2008	Air Conditioning Only	\$3,200	\$75
BP13-1526	Jul 1, 2013	Demolition	\$1,500	\$293
BP18-1736	Sep 11, 2018	Roof	\$4,000	\$0
BP18-1736	Nov 14, 2019	Roof	\$4,000	\$0

Notice: This does not necessarily represent all the permits for this property.  
Click the following link to check for additional permit data in Fort Pierce

---

All information is believed to be correct at this time, but is subject to change and is provided without any warranty.  
© Copyright 2020 Saint Lucie County Property Appraiser. All rights reserved.