

Michelle Franklin, CFA -- Saint Lucie County Property Appraiser -- All rights reserved.

Property Identification

Site Address: 529 N 11th ST Parcel ID: 2409-501-0118- Account #: 21132 Sec/Town/Range:
 000-9 09/35S/40E
 Map ID: 24/09N Zoning: Medium Den Use Type: 0100 Jurisdiction: Fort Pierce

Ownership

Qamar U Wahaj
 233 SW Whitmore DR
 Port St Lucie, FL 34984

Legal Description

LINCOLN PARK NO 2 BLK 4 LOTS 21 AND 22

Current Values

Just/Market: \$68,900 Assessed: \$62,799
 Exemptions: \$0 Taxable: \$62,799

Historical Values 3-year

Year	Just/Market	Assessed	Exemptions	Taxable
2019	\$68,900	\$62,799	\$0	\$62,799
2018	\$65,400	\$57,090	\$0	\$57,090
2017	\$51,900	\$51,900	\$0	\$51,900

Sale History

Date	Book/Page	Sale Code	Deed	Grantor	Price
10-28-2019	4338 / 1315	0118	CT	Parker (EST) Donnie A	\$55,100
01-01-1900	0377 / 2311				\$0

Primary Building Information

Finished Area of this building: 634 SF
 Gross Sketched Area: 730 SF

Exterior Data

View: Roof Cover: Roll Comp Roof Structure: Flat/Shed Building Type: HD+
 Year Built: 1951 Frame: Grade: D+ Effective Year: 1951
 Primary Wall: Conc Block Story Height: 1 Story No. Units: 1 Secondary Wall:

Interior Data

Bedrooms: 2 A/C %: 0% Electric: AVERAGE Primary Int Wall:
 Full Baths: 1 Heated %: 0% Heat Type: Avg Hgt/Floor: 0
 Half Baths: 1 Sprinkled %: N/A% Heat Fuel: Primary Floors: Terrazo

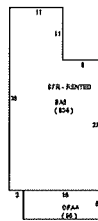

Total Areas

Finished/Under Air (SF):	2,074
Gross Sketched Area (SF):	2,626
Land Size (acres):	0.23
Land Size (SF):	10,152
Total Building Count:	2

Special Features and Yard Items

Type	Qty	Units	Year Blt
CHAINLINK 6'	1	70	1951
CHAINLINK 4'	1	120	1951
Driv-Concret	1	700	1951

All information is believed to be correct at this time, but is subject to change and is provided without any warranty.
 © Copyright 2020 Saint Lucie County Property Appraiser. All rights reserved.