

PALM STAKING DETAIL

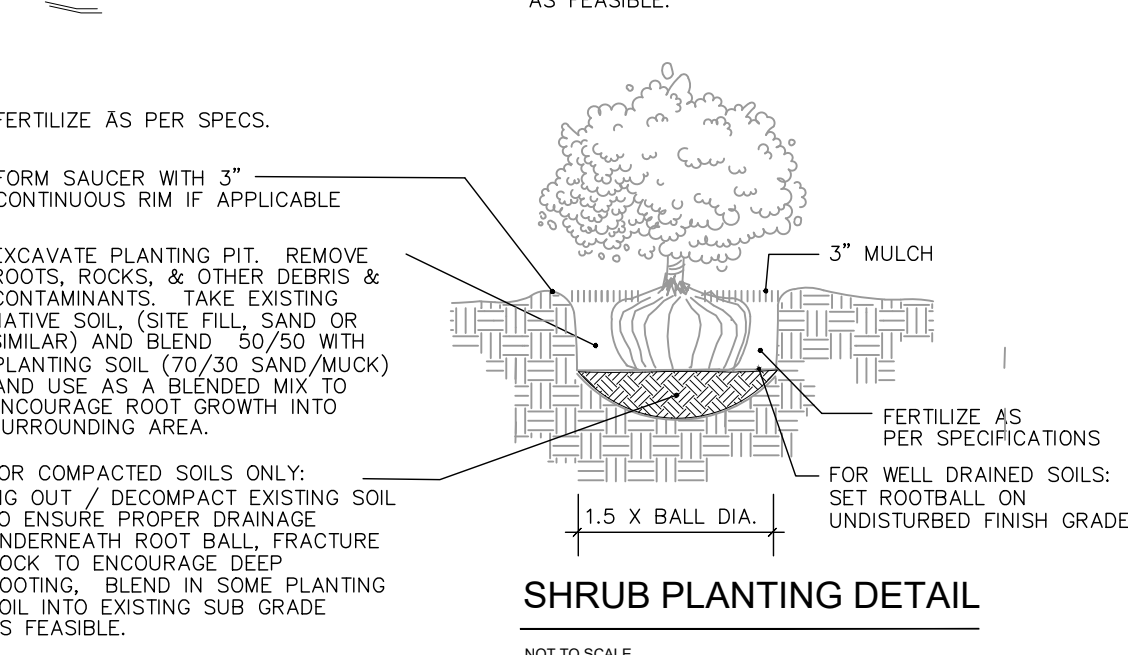

SHRUB PLANTING DETAIL

Tree Barricade Notes

- Existing trees that are to remain shall be barricaded according to City of West Palm Beach tree protection guidelines.
- Barricades must be constructed around the critical protection (CIP) zone of each tree or cluster of trees.
- Barricades must be constructed of a minimum of 4\"/>

TREE BARRICADE DETAIL

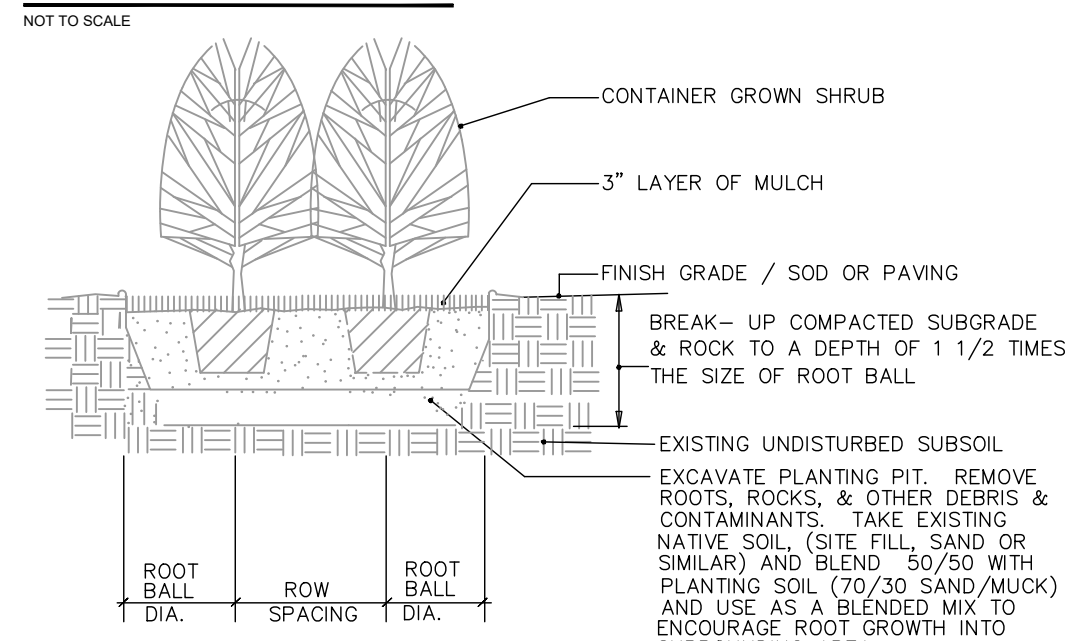

HEDGE OR MASS PLANTING DETAIL

CALIPER	CLEATS	STRAPS	BRACES	NAILS
4" - 8"	2 x 4 x 8"	1 # 12	3 - 2 x 4	2 - 16d
8" - 10"	2 x 4 x 12"	1 # 12	3 - 2 x 4	3 - 16d
10" - 16"	2 x 4 x 12"	2 # 12	4 - 2 x 4	3 - 16d

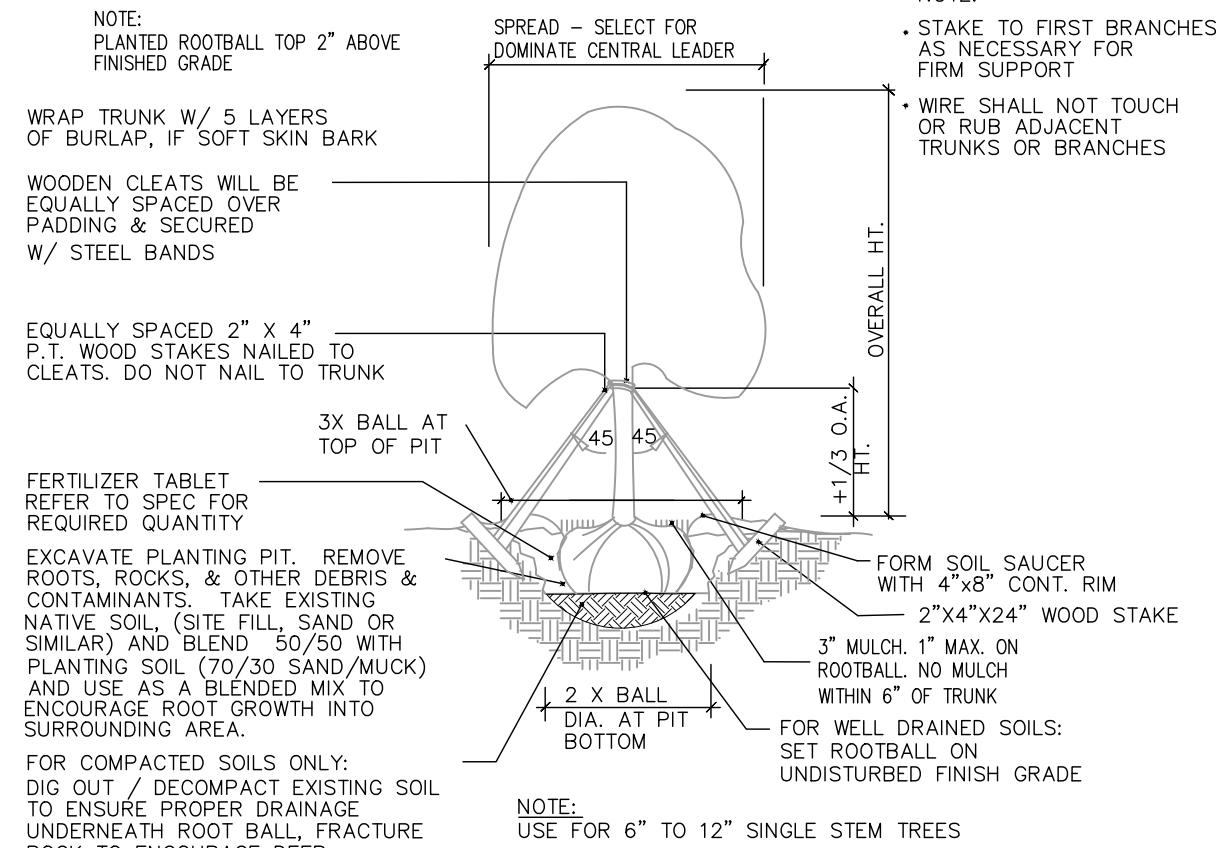

TREE BRACING DETAIL

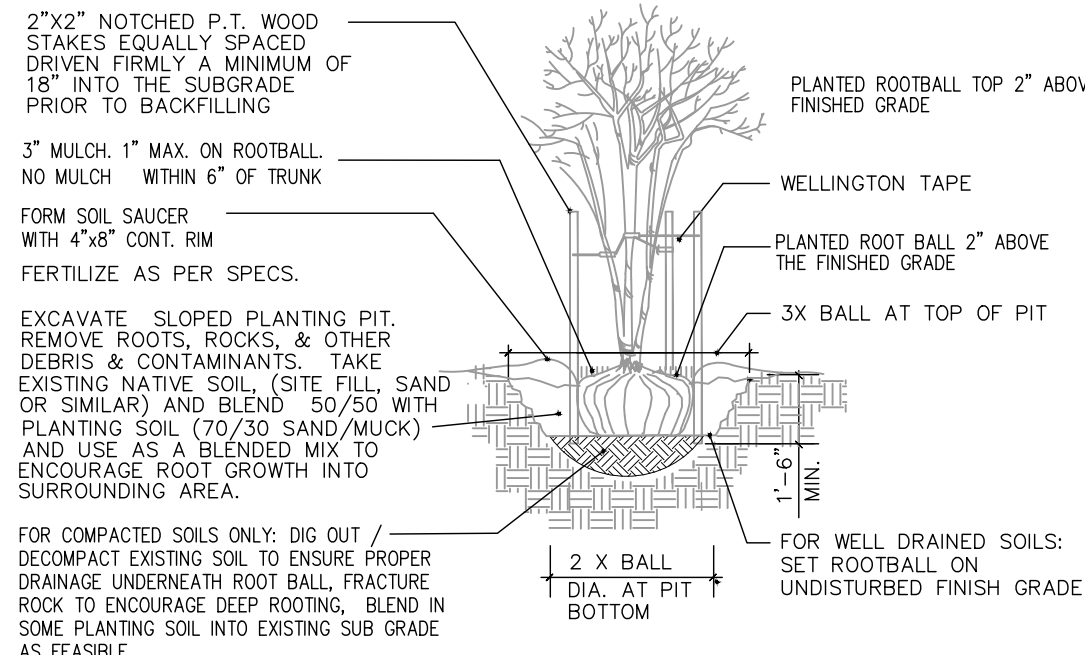

MULTI-TRUNK TREE STAKING

NOTE:

- ROOT BARRIER SHALL BE A MIN. 3\"/>

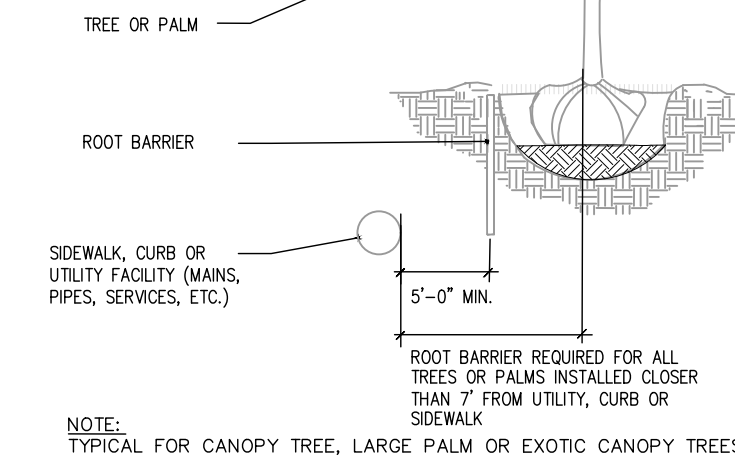

ROOT BARRIER DETAIL

CALIPER	TIES	STRANDS	STAKES
1" - 1 1/2"	2	1 # 12	2 - 2 X 2
1 1/2" - 2"	3	1 # 12	3 - 2 X 2
2" - 3"	3	2 # 12	2 - 2 X 2
3" - 6"	3	2 # 12	3 - 2 X 2

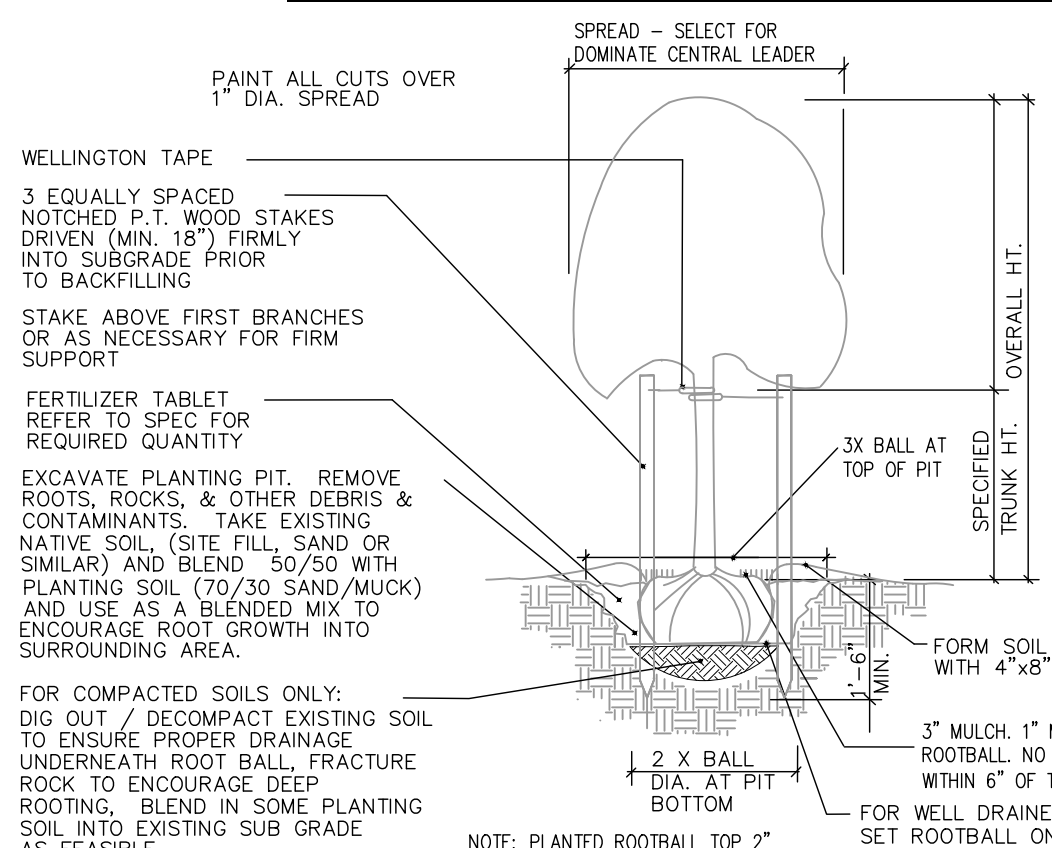

TREE PLANTING - VERTICAL STAKES

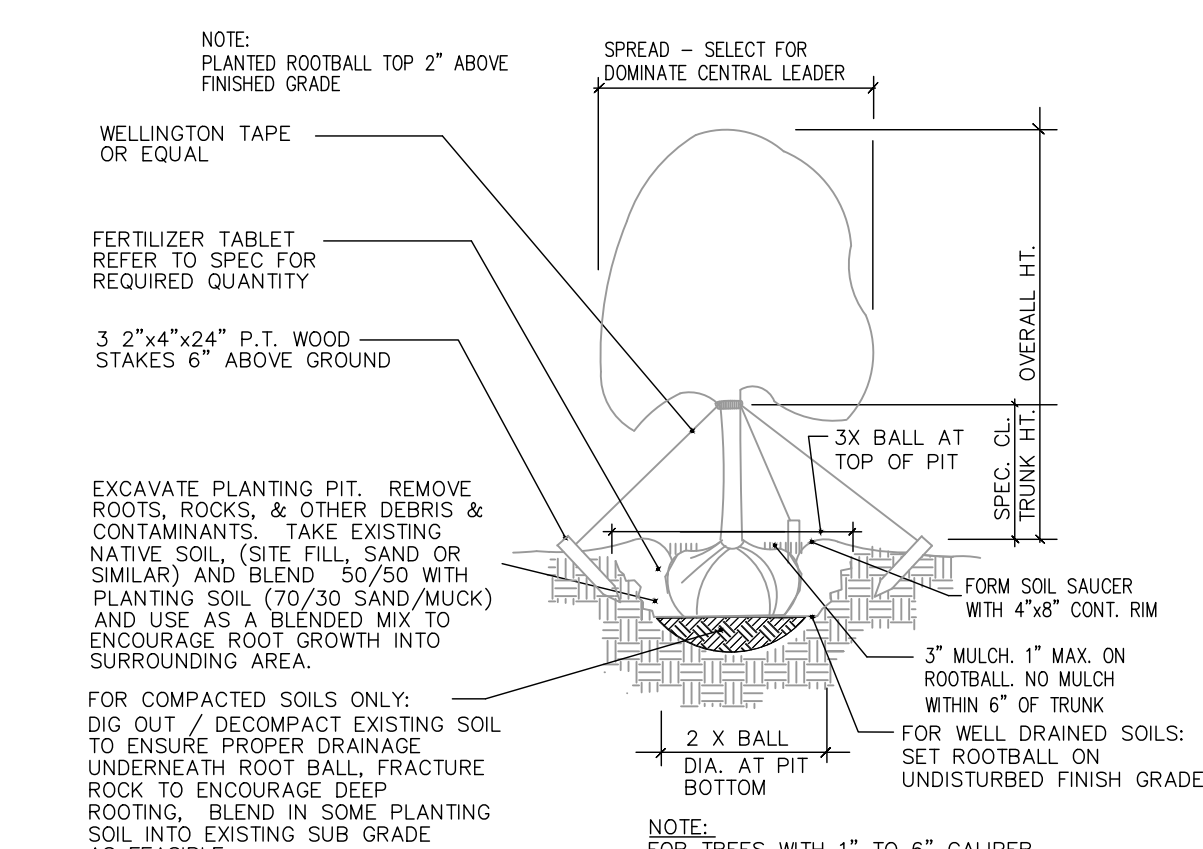

TREE PLANTING - GUY WIRES or WELLINGTON TAPE

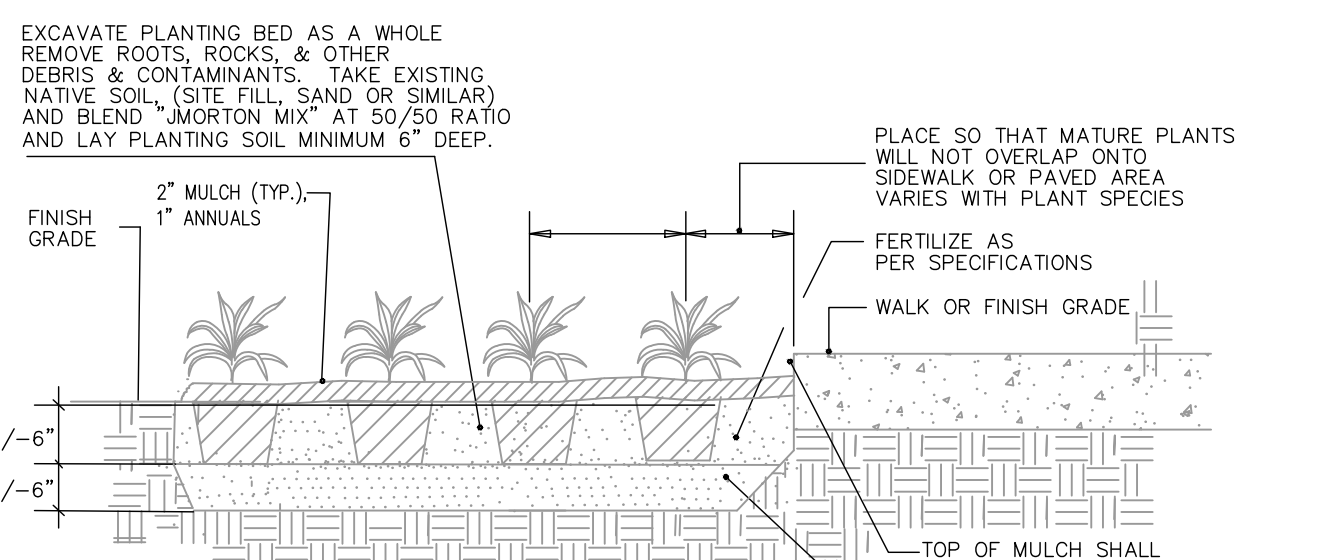

GROUND COVER PLANTING DETAIL

PLANT SPACING	ROW SPACING
12"	10.4"
18"	15.6"
24"	20.8"
30"	26.0"
36"	31.2"
48"	41.6"
60"	52.0"

NOTE: IN MOST CASES TRIANGULAR SPACING IS PREFERRED. USE SQUARE SPACING ONLY IN SMALL RECTILINEAR AREAS.

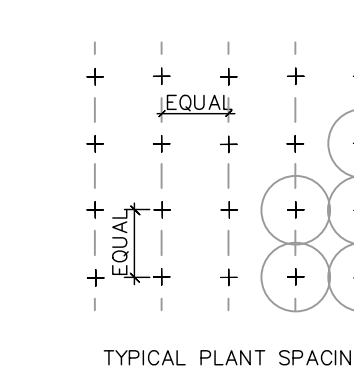

NEW TREE - 1 YEAR MAINTENANCE PLAN (BY OTHERS)

WATER:
 ALL NEW TREES TO BE ON A AUTOMATED IRRIGATION SYSTEM WITH RAIN SENSOR.
 1ST MONTH WATER EVERYDAY
 2ND THROUGH 6TH MONTHS - EVERY OTHER DAY.
 7TH THROUGH COMPLETE YEAR - 2 TIMES A WEEK.
NOTE: ADJUST IRRIGATION DURATION TIMES TO ENSURE THAT TREE'S ROOT BALL IS COMPLETELY SATURATED WITH WATER.
 IRRIGATION WATER FREQUENCY AND DURATIONS MAY VARY DUE TO TIME OF YEAR AND CLIMATE CONDITIONS.

FERTILIZER:
 USE A PALM 'SPECIAL' FERTILIZER, 8-2-12, FROM ATLANTIC FERTILIZER, 1 LBS. PER INCH CALIPER OF TREE EVERY 3 MONTHS.

MULCH:
 INSPECT AND REPLACE MULCH AFTER 6 MONTHS WITH APPROVED EUCALYPTUS OR MELALEUCA MULCH ONLY.
 NO RED COLORED OR CYPRESS MULCH TO BE USED.

TRIMMING & PRUNING:
 PRUNE ONLY CRITICAL BRANCHES (DEAD OR BROKEN).

STAKING AND BRACING:
 INSPECT ALL TREE TIES AND STAKING AND ADJUST AS NEEDED. REMOVE ANY STAKING MATERIAL THAT IS IN CONTACT TREE AFTER A PERIOD OF NO MORE THAN 6 MONTHS AFTER INITIAL PLANTING AS THE TREE SHOULD BE WELL ESTABLISHED BY THEN.

PLANTING SPECIFICATIONS AND WARRANTIES

- THE DEMOLITION OF EXISTING PLANT MATERIAL MUST BE MARKED WITH SPRAY PAINT BY LANDSCAPE ARCHITECT (L.A.)
- ALL TREES AND PALMS TO BE LAID OUT BY LANDSCAPE CONTRACTOR IN THE FIELD WITH STAKES AND SPRAY PAINT. TO BE REVIEWED AND APPROVED BY (L.A.)
- PLANT LIST IS FOR INFORMATION ONLY. IF THERE ARE ANY DISCREPANCIES BETWEEN "PLANT QUANTITIES" ON PLAN VERSUS "PLANT LIST", "THE PLANS" WILL TAKE PRIORITY. PLEASE NOTIFY L.A. OF ANY DISCREPANCIES
- ONLY UNIT PRICE INSTALLED PLANTING BIDS BASED ON LANDSCAPE ARCHITECT'S PLANTING PLANS AND PLANT LIST WILL BE ACCEPTED. OWNER RETAINS THE RIGHT TO REMOVE PORTIONS OF THE WORK FROM THE CONTRACT AND / OR CREATE SEPARATE CONTRACTS FOR PHASING OF THE PROJECT. LANDSCAPE ARCHITECT RESERVES THE RIGHT TO DENY ANY AND ALL BIDS WHEN SUCH REJECTIONS ARE IN THE BEST INTEREST OF THE OWNER.
- ALL PLANT MATERIAL MUST BE FLORIDA #1 OR BETTER, UNLESS SPECIFIED AS "CHARACTER" OR WITH WRITTEN APPROVAL FROM L.A.
- LANDSCAPE CONTRACTOR TO SUBMIT PLANTING PRODUCT AND / OR SAMPLE SUBMITTALS FOR L.A. APPROVAL PRIOR TO PURCHASING. SUBMITTALS TO INCLUDE NURSERY SOURCE & PHOTOGRAPHS WITH MEASURING TAPE AND / OR PERSON STANDING NEXT TO PLANT MATERIAL FOR SCALE REFERENCE.
- ALL PLANTING BEDS MUST BE FREE OF SURFACE ROCK OVER 1/2" DIAMETER, PRIOR TO MULCHING.
- PLANTING BEDS SHOULD RECEIVE 6" OF 'JMORTON MIX' PLANTING SOIL MIX. SEE PLANTING SOIL SPECIFICATION.
- PLANTING SOIL SPECIFICATION: 'JMORTON MIX' (20% FLORIDA PEAT, 20% COMPOST, 20% LAKE WALES SILICA SAND, 20% LOCAL "SCREENING SAND" OR "BEACH SAND" AND 20% CYPRESS SHAVINGS), LANDSCAPE CONTRACTOR TO SUBMIT SAMPLE TO BE APPROVED BY L.A.
- FERTILIZE ALL PLANTS WITH OSMOCOTE "SIERRA BLEND" 18-7-10: 1/2 HAND FULL FOR 1 - 3 GALLONS, 1 HAND FULL FOR 7-20 GALLON, AND 4 HANDS FULL FOR BALL AND BURLAPPED (B & B) MATERIAL.
- FERTILIZE ALL B&B MATERIAL WITH 10 "AGRIFORM" TABLETS OR EQUAL.
- MULCH ALL LANDSCAPE AREAS WITH 2-1/2" - 3" OF EUCALYPTUS OR MELALEUCA MULCH "ECO MULCH" (NO CYPRESS OR RED COLOR MULCH)
- ALL SOD AREAS LAID WITH ST. AUGUSTINE 'PALMETTO' TO BE HAND RAKED PRIOR TO INSTALLING THE SOD.
- ALL SOD AREAS TO BE TOP DRESSED WITH 2" OF 80/20 LAKE WALES SILICA SAND/ FLORIDA PEAT MOSS PRIOR TO SODDING.
- ALL PLANT MATERIAL, EXCLUDING SOD, TO BE WARRANTED AS FOLLOWS: SHRUBS AND GROUND COVERS FOR 90 DAYS, LARGE SHRUBS (OVER 10 GAL.) AND SMALL PALMS FOR 180 DAYS, AND B&B MATERIAL FOR 360 DAYS PROVIDED THAT PLANT MATERIAL IS RECEIVING PROPER MAINTENANCE PRESCRIBED BY LANDSCAPE CONTRACTOR.
- NOTE: HURRICANES AND OTHER CAUSES BEYOND THE CONTROL OF THE LANDSCAPE CONTRACTOR ARE NOT COVERED.
- ALL WARRANTIES TO RUN CONCURRENTLY, BEGINNING UPON LANDSCAPE ARCHITECT'S FINAL ACCEPTANCE OF THE INSTALLATION, UNLESS OWNER OR GENERAL CONTRACTOR (G.C.) REQUIRES CONSTRUCTION PHASING BEYOND CONTROL OF THE INSTALLER.
- INSTALLER TO NOTIFY OWNER, G.C. AND / OR L.A. OF ANY PARTIAL COMPLETION DUE TO PHASING.
- ALL MATERIALS STORED ON SITE ARE THE PROPERTY OF THE INSTALLER UNTIL ACCEPTED BY OWNER. OWNER IS NOT RESPONSIBLE FOR THEFT, UNLESS NOTIFIED IN WRITING PRIOR TO INSTALLATION AND SECURITY ARRANGEMENT AGREED TO.
- WATERING IS THE RESPONSIBILITY OF THE INSTALLER DURING THE INSTALLATION AND UNTIL FINAL ACCEPTANCE.
- LANDSCAPE CONTRACTOR IS RESPONSIBLE FOR COORDINATING THEIR WORK WITH IRRIGATION CONTRACTOR.
- LANDSCAPE CONTRACTOR IS RESPONSIBLE TO ASSURE IRRIGATION INSTALLATION IS PROPERLY PROGRESSING, AND IN THE END ADEQUATE FOR GOOD GROWTH. THE OWNER OR G.C. MUST BE NOTIFIED IN WRITING OF ANY PROBLEMS WITH IRRIGATION PHASING OR PERFORMANCE.
- ANY EXISTING IRRIGATION TO BE BROUGHT TO A GOOD FUNCTIONING STANDARD TO ENSURE PROPER WATERING OF NEW MATERIAL.
- ALL LANDSCAPE AREAS MUST BE ON AN AUTOMATIC IRRIGATION SYSTEM FROM TIME OF INSTALLATION, WITH 100% COVERAGE AND 100% OVERLAPS, WITH RAIN SENSORS PER CITY CODES. NO HAND WATERING.
- LANDSCAPE CONTRACTOR TO EXERCISE EXTREME CARE WHEN DIGGING AND PERFORMING OTHER WORK SO NOT TO DAMAGE ANY EXISTING WORK SUCH AS UNDERGROUND AND OVERHEAD UTILITIES, (ELECTRICAL, SEWAGE, IRRIGATION, & PLUMBING). IN THE EVENT OF PLANTING CONFLICTS THE L.A. OR OWNER'S AUTHORIZED REPRESENTATIVE TO BE NOTIFIED TO PROVIDE ALTERNATE LOCATIONS OF PLANTING OR UTILITY / OBSTRUCTION CONFLICTS.
- LANDSCAPE CONTRACTOR IS RESPONSIBLE FOR IMMEDIATE REPAIR OF ANY DAMAGE CAUSED BY THEIR INSTALLATION. LANDSCAPE CONTRACTOR IS RESPONSIBLE FOR WORKING WITH THE GENERAL CONTRACTOR TO ASSURE THAT ALL CEMENTITIOUS CONTAMINANTS AND OTHER CONSTRUCTION DEBRIS ARE REMOVED FROM ALL SODS.
- IN PLANTING BEDS, PARTICULARLY BY BUILDINGS, LANDSCAPE CONTRACTOR TO EXCAVATE EXISTING SOILS TO A MINIMUM DEPTH OF 12" AND BACKFILLED WITH PLANTING SOIL. IN SOD AREAS, LANDSCAPE CONTRACTOR TO DECOMPACT SOIL WITH BACK HOE TEETH TO A DEPTH OF 6" AND ADD 2" MIN. OF TOP SOIL FOR SODDING.
- ALL CIRCULAR PITS TO BE EXCAVATED WITH SLOPED SIDES FOR ALL PLANTS, EXCEPT FOR HEDGES & PLANTING BEDS. THE DIAMETER OF THESE PITS FOR TREES AND SHRUBS TO BE 1/3 LARGER THAN THE DIAMETER OF THE ROOT BALL.
- ALL TREE PITS TO HAVE THE SOIL REMOVED IN THE AMOUNT OF 1/3 LARGER THAN THE ROOT BALL OF THE TREE AND REPLACED WITH APPROVED SPECIFIED SOIL.
- ALL PALM TREE PITS TO HAVE THE SOIL REMOVED IN THE AMOUNT OF 1/3 LARGER THAN THE ROOT BALL OF THE PALM AND REPLACED WITH CLEAN YELLOW SAND.
- ALL TREE & PALM PITS TO BE EXCAVATED WITH A BACKHOE ONLY. ABSOLUTELY NO USE OF AUGERS.

LANDSCAPE DETAILS AND SPECIFICATIONS

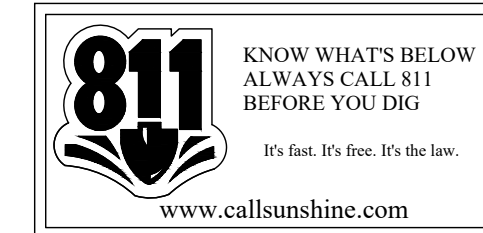

Fort Pierce Municipal Golf Course
 Prepared for 'Client'
 Fort Pierce, Florida

NAME	LA
REVISIONS	
Landscape Plan	
SCALE	AS SHOWN
DRAWN	KB/JR
CHECKED BY	KB/SDP
FILE	G257.01 - FPMGC - Landscape
DATE	2021-05-xx