



Ocean Village Conditional Use Approval for Racquet Courts and Court Covering Seaward of the Coastal Construction Control Line (CCCL)

2400 S. Ocean Drive

Location Map



Imagery © 2016 Google, Map data © 2016 Google

Northern Legend

- | | | |
|------------------|--------------------------|-------------------------|
| A. Capstan | D. Beachtree I | G. Catamaran I |
| B. Golf Villas | E. Beachtree II | H. Cayman Center & Pool |
| C. Coral Cluster | F. Bermuda Center & Pool | I. Seascape I |

Southern Legend

- | | | | |
|--------------------|------------------------|----------------------|----------------|
| J. Office | K. Tennis Courts | L. Tennis Pro Shop | M. Golf Shack |
| N. Restaurant | O. Club House | P. Tiki Bar | Q. Seascape II |
| R. Ocean House | S. Aruba Center & Pool | T. Ocean Villas I | |
| U. Ocean Villas II | V. Ocean Villas III | W. Southpointe Homes | |
| X. Catamaran II | Y. Golf Lodges South | Z. Golf Lodges North | |

FLU Map

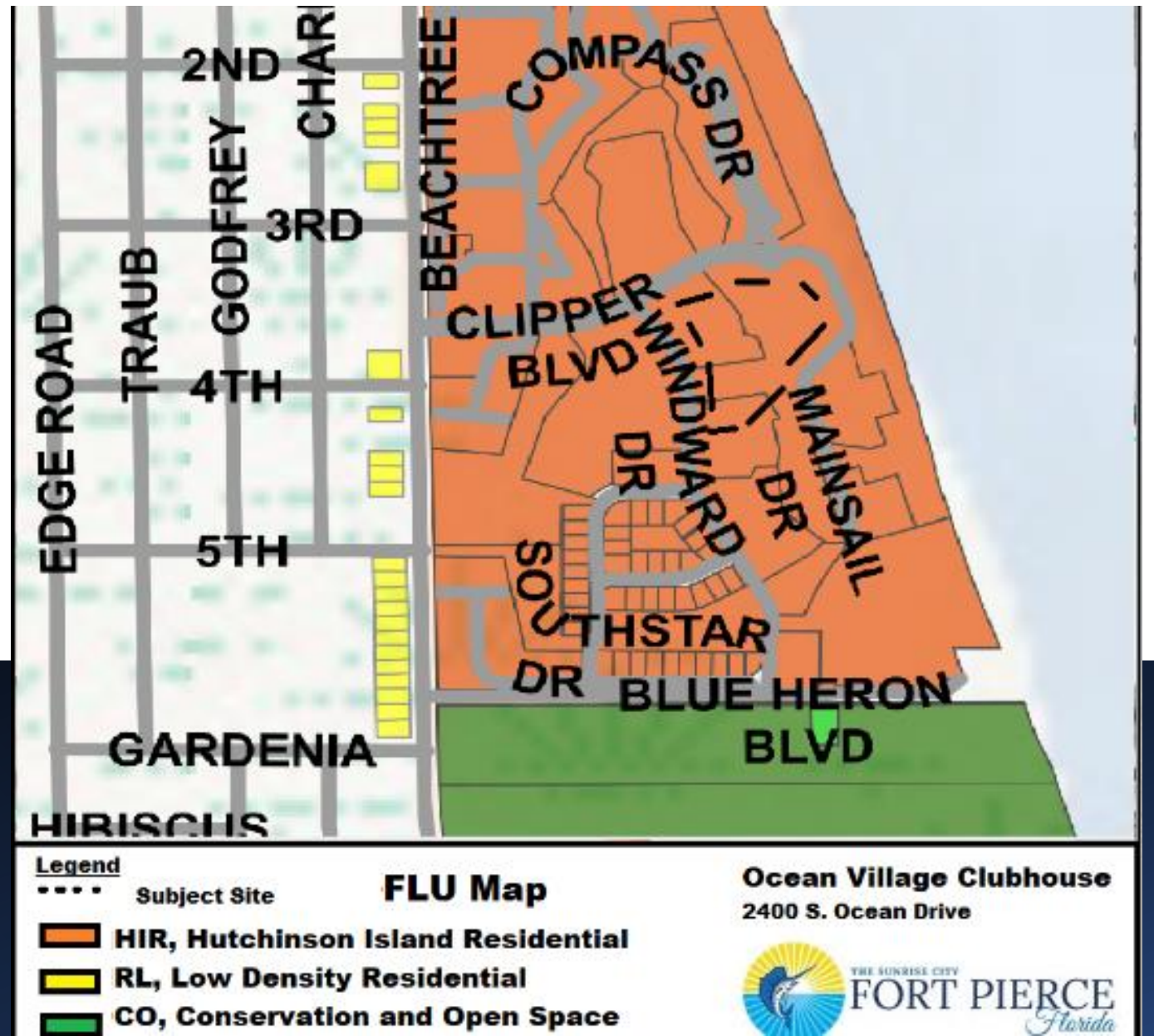

Zoning Map

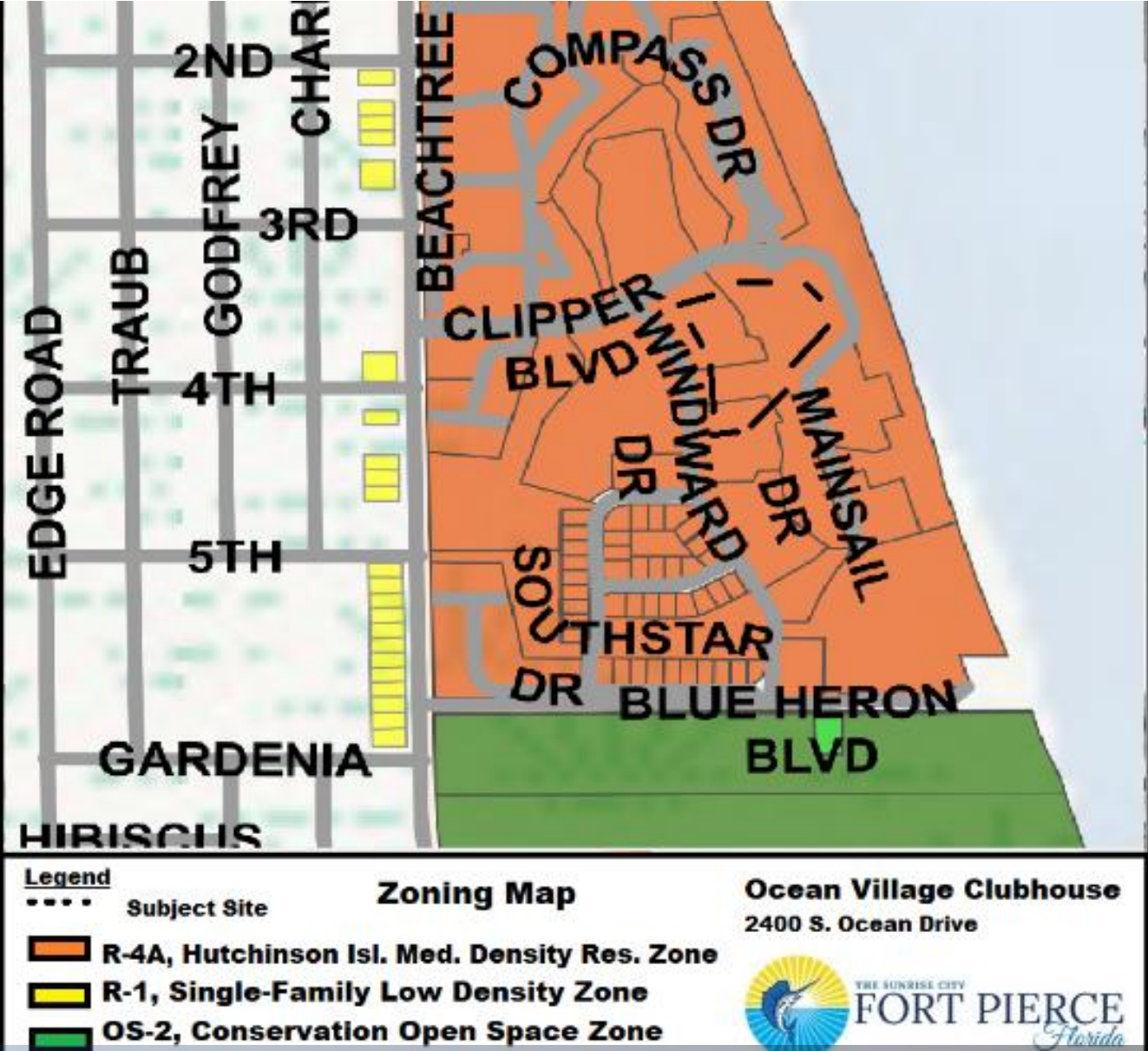

Proposed Construction Seaward of the CCCL

CCC Line 

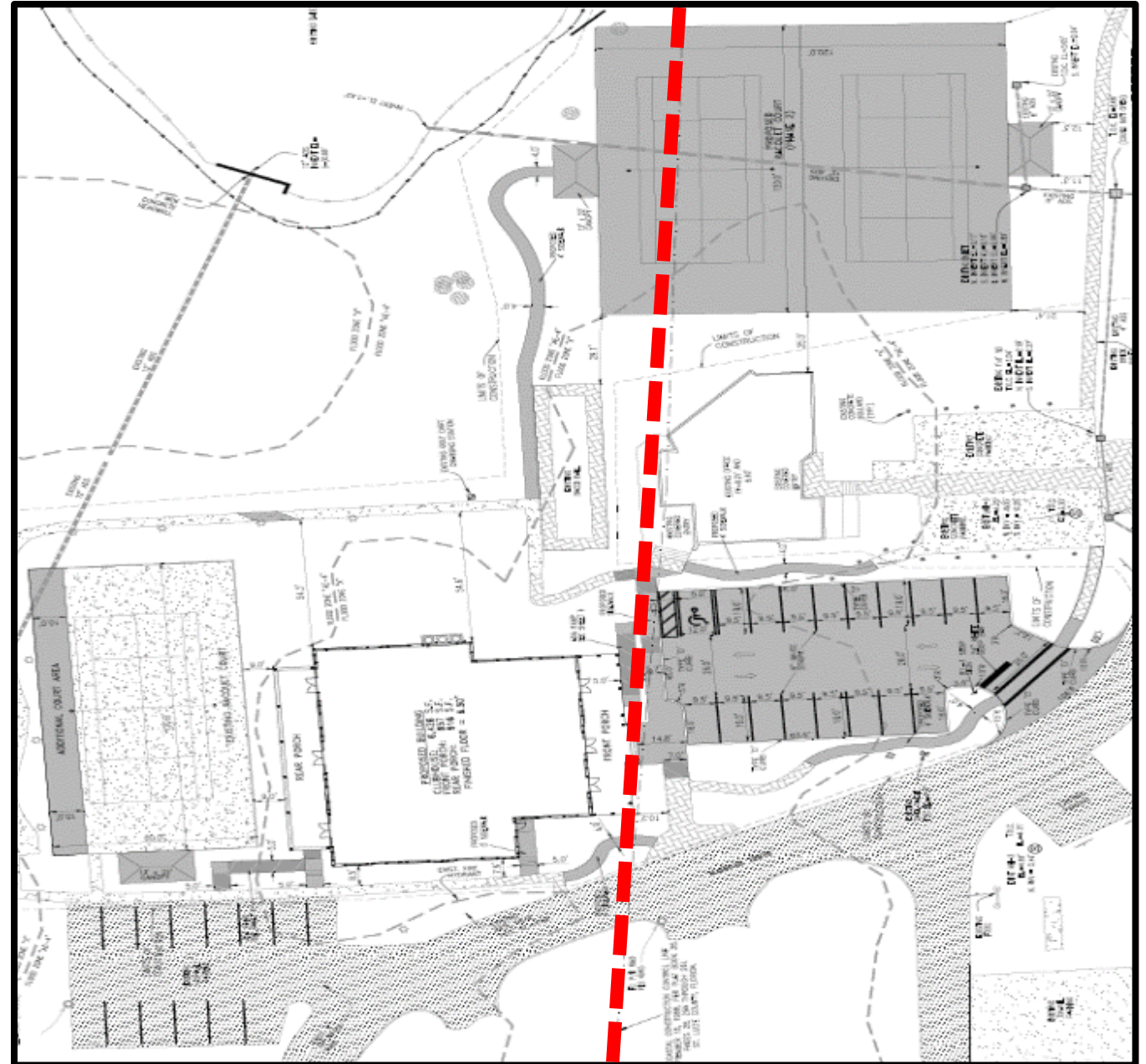

Staff and Planning Board Recommendation

- Staff recommends Approval.
- Planning Board on July 14, 2021, Recommended Approval of the Conditional Use Approval.

CC Actions

- **Possible actions of the City Commission:**
- APPROVAL of the Conditional Use Approval
- APPROVAL of the proposed Conditional Use Approval with changes
- DISAPPROVAL of the proposed Conditional Use Approval



Ocean Village Conditional Use Approval for Racquet Courts and Court Covering Seaward of the Coastal Construction Control Line (CCCL)

2400 S. Ocean Drive