

### Property Identification

Site Address: 1102 Avenue D  
Sec/Town/Range: 09/35S/40E  
Parcel ID: 2409-501-0098-000-2  
Jurisdiction: Fort Pierce

Use Type: 0800  
Account #: 21114  
Map ID: 24/09N  
Zoning: General Co

### Ownership

1102 Avenue D LLC  
5659 Whirlaway RD  
Palm Beach Gardens, FL 33418

### Legal Description

LINCOLN PARK NO 2 BLK 4 LOT 1- LESS S 10 FT FOR RD R/W AS IN  
OR 1366-2878- (0.10 AC - 4,323 SF)

### Current Values

Just/Market Value: \$82,800  
Assessed Value: \$82,800  
Exemptions: \$0  
Taxable Value: \$82,800

### Property taxes are subject to change upon change of ownership.

- Past taxes are not a reliable projection of future taxes.
- The sale of a property will prompt the removal of all exemptions, assessment caps, and special classifications.



### Total Areas

Finished/Under Air (SF): 2,446  
Gross Sketched Area (SF): 2,620  
Land Size (acres): 0.1  
Land Size (SF): 4,323

### Building Design Wind Speed

Occupancy Category	I	II	III & IV
Speed	140	160	160

Sources/links:

Taxes for this parcel: [SLC Tax Collector's Office](#)   
Download TRIM for this parcel: [Download PDF](#)

### Sale History

Date:	Dec 28, 2018
Book/Page:	4218 / 2392
Sale Code:	0001
Deed:	WD
Grantor:	Leach Sara S
Price:	\$80,000
Date:	Mar 13, 2018
Book/Page:	4107 / 2653
Sale Code:	0318
Deed:	CT
Grantor:	Jones Gayle F
Price:	\$9,600
Date:	Nov 13, 2000
Book/Page:	1346 / 1667

Sale Code:	XX01
Deed:	QC
Grantor:	Moffitt Tina M
Price:	\$20,000
Date:	Jun 28, 1999
Book/Page:	1232 / 0945
Sale Code:	XX01
Deed:	WD
Grantor:	JACOBSON AUCTION COMPANY INC
Price:	\$30,500
Date:	Apr 6, 1999
Book/Page:	1214 / 1387
Sale Code:	XX01
Deed:	CT
Grantor:	Lee Merricks
Price:	\$22,100
Date:	Aug 1, 1981
Book/Page:	0361 / 2691
Sale Code:	XX01
Deed:	CV
Grantor:	
Price:	\$0
Date:	Mar 1, 1978
Book/Page:	0284 / 0923
Sale Code:	XX01
Deed:	CV
Grantor:	
Price:	\$0
Date:	Jan 1, 1977
Book/Page:	0262 / 2225
Sale Code:	XX01
Deed:	CV
Grantor:	
Price:	\$0

### Building Information (1 of 2)

Finished Area: 1,932 SF

Gross Sketched Area: 2,070 SF

#### Exterior Data

View:  
 Building Type: MFH  
 Grade: MFFQ  
 Story Height: 1 Story

Roof Cover: Dim Shingle  
 Year Built: 1945  
 Effective Year: 1970  
 No. Units: 3

Roof Structure: Gable  
 Frame:  
 Primary Wall: CB Stucco  
 Secondary Wall:

#### Interior Data

Bedrooms: 0  
 Full Baths: 3  
 Half Baths: 0  
 A/C %: 0%

Electric: MAXIMUM  
 Heat Type:  
 Heat Fuel:  
 Heated %: N/A%

Primary Int Wall:  
 Avg Hgt/Floor: 0  
 Primary Floors: Carpet  
 Sprinkled %: 0%

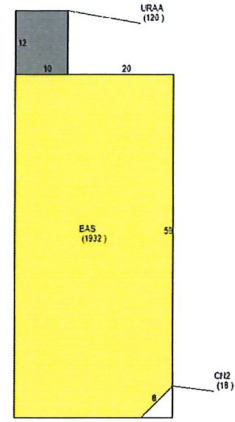

### Building Information (2 of 2)

Finished Area: 514 SF

Gross Sketched Area: 550 SF

#### Exterior Data

View:  
 Building Type: MFH  
 Grade: MFFQ  
 Story Height: 1 Story

Roof Cover: Dim Shingle  
 Year Built: 1945  
 Effective Year: 1945  
 No. Units: 1

Roof Structure: Gable  
 Frame:  
 Primary Wall: Frm Stucco  
 Secondary Wall:

#### Interior Data

Bedrooms: 0  
 Full Baths: 1  
 Half Baths: 0  
 A/C %: 0%

Electric: MAXIMUM  
 Heat Type:  
 Heat Fuel:  
 Heated %: %

Primary Int Wall:  
 Avg Hgt/Floor: 0  
 Primary Floors: Carpet  
 Sprinkled %: 0%

