

Property Identification

Site Address: 708 BOSTON AVE
 Sec/Town/Range: 10/35S/40E
 Parcel ID: 2410-704-0013-000-0
 Jurisdiction: Fort Pierce

Use Type: 0100
 Account #: 23551
 Map ID: 24/10S
 Zoning: SF Moderat

Ownership

Jose Alanis
 8400 Orange AVE
 Fort Pierce, FL 34945

Legal Description

SAMPLE'S RE-S/D OF BECK'S S/D LOT 13 AND 14 AND 20 FT DUE E OF AND ADJ SAME (MAP 24/10E) (OR 2303-77)

Current Values

Just/Market Value: \$76,200
 Assessed Value: \$14,573
 Exemptions: \$0
 Taxable Value: \$14,573



Property taxes are subject to change upon change of ownership.

- Past taxes are not a reliable projection of future taxes.
- The sale of a property will prompt the removal of all exemptions, assessment caps, and special classifications.

Total Areas

Finished/Under Air (SF): 649
 Gross Sketched Area (SF): 793
 Land Size (acres): 0.6
 Land Size (SF): 26,000

Taxes for this parcel: [SLC Tax Collector's Office](#)
 Download TRIM for this parcel: [Download PDF](#)

Building Design Wind Speed

Occupancy Category	I	II	III & IV
Speed	140	160	160

Sources/links:

Sale History

Date	Book/Page	Sale Code	Deed	Grantor	Price
Jul 9, 2005	2303 / 0077	XX02	WD	Conroy Michael	\$423,500
Sep 1, 2004	2059 / 0753	XX01	WD	Pike Stephen H	\$100
Mar 10, 1992	0780 / 0297	XX01	QC	Carson B Gatch	\$100
Jul 2, 1990	0698 / 1166	XX00	WD	Brian K Peace	\$40,000
Sep 1, 1987	0556 / 0221	XX00	CV		\$65,000
Apr 1, 1976	0250 / 2633	XX00	CV		\$50,000

Building Information (1 of 1)

Finished Area: 649 SF

Gross Sketched Area: 793 SF

Exterior Data

View:	Roof Cover: Dim Shingle	Roof Structure: Gable
Building Type: HC-	Year Built: 1926	Frame:
Grade: C-	Effective Year: 1960	Primary Wall: Hardwood Lap
Story Height: 1 Story	No. Units: 1	Secondary Wall:

Interior Data

Bedrooms: 2
 Full Baths: 1
 Half Baths: 0
 A/C %: 100%

Electric: MAXIMUM
 Heat Type: FredHotAir
 Heat Fuel: ELEC
 Heated %: 100%

Primary Int Wall:
 Avg Hgt/Floor: 0
 Primary Floors: Double Pine
 Sprinkled %: 0%

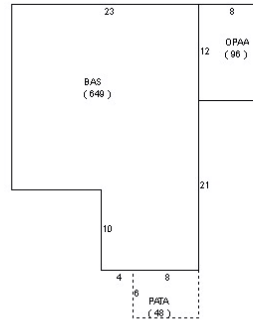

Sketch Area Legend

Sub Area	Description	Area	Fin. Area	Perimeter
BAS	BASE AREA	649	649	112
OPAA	Open Porch Attached Average	96	0	40
PATA	Patio Average (Plain Slab)	48	0	28

Special Features and Yard Items

Type	Qty	Units	Year Blt
Fen WoodSB 6'	1	160	1999

Current Year Values

Current Values Breakdown

Building:	\$33,300
Land:	\$42,900
Just/Market:	\$76,200
Ag Credit:	\$0
Save Our Homes or 10% Cap:	\$61,627
Assessed:	\$14,573
Exemption(s):	\$0
Taxable:	\$14,573

Current Year Exemption Value Breakdown

Current Year Special Assessment Breakdown

Start Year	AssessCode	Units	Description	Amount
1999	0041	0.6	Fort Pierce Stormwater Charge	\$41.40

This does not necessarily represent the total Special Assessments that could be charged against this property. The total amount charged for special assessments is reflected on the most current tax statement and information is available with the SLC Tax Collector's Office .

Historical Values

Year	Just/Market	Assessed	Exemptions	Taxable
2021	\$76,200	\$14,573	\$0	\$14,573
2020	\$55,300	\$13,249	\$0	\$13,249
2019	\$59,900	\$12,045	\$0	\$12,045
2018	\$45,000	\$10,950	\$0	\$10,950

Permits

Number	Issue Date	Description	Amount	Fee
F00-000229	Feb 22, 2000	Alterations/Remodeling	\$45,000	\$0
F00-001395	Nov 20, 2000	Demolition	\$0	\$0
F00-1396	Nov 20, 2000	Demolition	\$0	\$50
F89000825B	Aug 1, 1989	Additions to existing construction	\$1,000	\$1,000
F900000871	Jul 6, 1990	Alterations/Remodeling	\$2,500	\$2,500
F900001458	Nov 9, 1990	Roof	\$1,850	\$1,850
F94-000449	Apr 6, 1994	Fence	\$800	\$800
F96-000058	Jan 16, 1996	Demolition	\$2,000	\$2,000

Notice: This does not necessarily represent all the permits for this property.

[Click the following link to check for additional permit data in Fort Pierce](#)

All information is believed to be correct at this time, but is subject to change and is provided without any warranty.

© Copyright 2021 Saint Lucie County Property Appraiser. All rights reserved.