

SOUTH OCEAN DRIVE

(70' WIDE)

120.00'

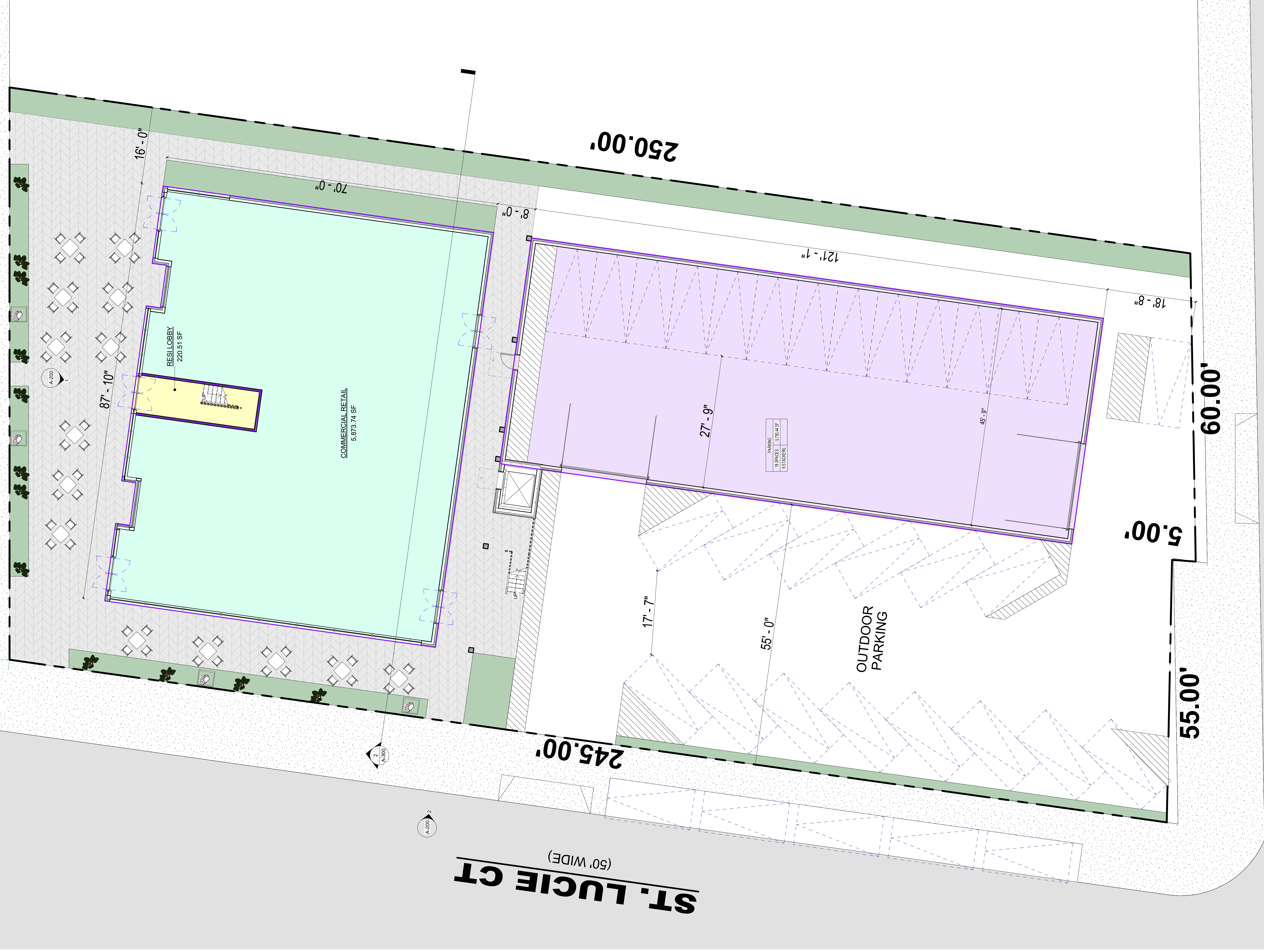

ST. LUCIE CT
(50' WIDE)

HERNANDO STREET
(50' WIDE)

01 - FIRST FLOOR

Scale: 1/8" = 1'-0"

<p>Gerald J. Caliendo, R.A. - A.I.A. Architect, P.C.</p> <p>138-72 Queens Boulevard Briarwood, NY 11435</p> <p>Tel: (718) 268-9098 Fax: (718) 268-9097</p> <p>www.caliendoarchitects.com</p>		<p>Architecture Interior Design Code Consultant Building Dept. Expediting</p>																			
<p>KEY PLAN:</p>		<p>CONSULTANTS: STRUCTURAL ENGINEER</p>																			
<p>MEP ENGINEER</p>		<p>ENERGY CONSULTANT</p>																			
<p>CONTRACTOR: CORAL REEF GC LLC 2250 N US HIGHWAY 1 FORT PIERCE FL 34946 772-292-4784</p>		<p>OWNER:</p>																			
<p>001 FLOOR PLAN</p>		<p>PROPOSED MIXED BUILDING 301 SOUTH OCEAN DRIVE FORT PIERCE, FLORIDA 34949</p>																			
<p>REVISIONS</p> <table border="1"> <thead> <tr> <th>No.</th> <th>Date</th> <th>Description</th> </tr> </thead> <tbody> <tr> <td> </td> <td> </td> <td> </td> </tr> <tr> <td> </td> <td> </td> <td> </td> </tr> <tr> <td> </td> <td> </td> <td> </td> </tr> <tr> <td> </td> <td> </td> <td> </td> </tr> <tr> <td> </td> <td> </td> <td> </td> </tr> </tbody> </table>	No.	Date	Description																<p>DATE: 08/17/22</p>	<p>PROJECT ADDRESS:</p>	<p>JOB No: 22019</p>
No.	Date	Description																			
<p>DESIGNER:</p>	<p>DATE:</p>	<p>PROJECT ADDRESS:</p>	<p>DATE:</p>																		
<p>ARCHITECT:</p>	<p>DATE:</p>	<p>PROJECT ADDRESS:</p>	<p>DATE:</p>																		
<p>DATE:</p>	<p>DATE:</p>	<p>PROJECT ADDRESS:</p>	<p>DATE:</p>																		

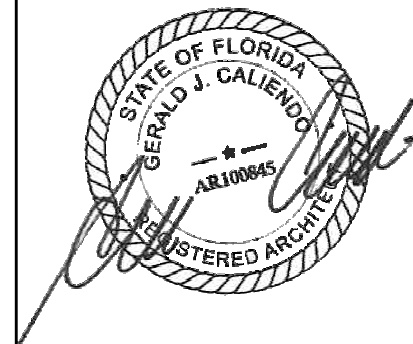

123

14 OF

A-110.00

THE ARCHITECT SHALL HAVE CONTROL AND RESPONSIBILITY FOR CONSTRUCTION METHODS, MATERIALS, TECHNIQUES, SEQUENCES OF PROCEDURE, OR SAFETY REGULATIONS AND PROGRAMS CONNECTION WITH THE WORK OR THE COSTS OR DAMAGES OF THE CONTRACTOR. SUBCONTRACTORS AND OTHER PERSONS PERFORMING ANY OF THE WORK OR THE FAILURE OF THEM TO CARRY OUT THE WORK IN ACCORDANCE WITH THE CONTRACT DOCUMENTS. THE ARCHITECT SHALL NOT BE RESPONSIBLE FOR CONSTRUCTION METHODS, MATERIALS, TECHNIQUES, SEQUENCES OF PROCEDURE, OR SAFETY REGULATIONS AND PROGRAMS CONNECTION WITH THE WORK OR THE COSTS OR DAMAGES OF THE CONTRACTOR. SUBCONTRACTORS AND OTHER PERSONS PERFORMING ANY OF THE WORK OR THE FAILURE OF THEM TO CARRY OUT THE WORK IN ACCORDANCE WITH THE CONTRACT DOCUMENTS.



THE ARCHITECT SHALL HAVE CONTROL AND RESPONSIBILITY FOR THE DESIGN AND CONSTRUCTION OF THE WORK. THE ARCHITECT SHALL NOT BE RESPONSIBLE FOR THE DESIGN OR CONSTRUCTION OF THE WORK OF OTHER PROFESSIONS PERFORMING ANY OF THE WORK OR FOR THE FAILURE OF THEM TO COMPLY WITH THE REQUIREMENTS OF THE CONTRACT DOCUMENTS. THE ARCHITECT'S LIABILITY IS LIMITED TO THE SCOPE OF THE CONTRACT DOCUMENTS. THE ARCHITECT'S LIABILITY IS LIMITED TO THE SCOPE OF THE CONTRACT DOCUMENTS. THE ARCHITECT'S LIABILITY IS LIMITED TO THE SCOPE OF THE CONTRACT DOCUMENTS.

ARCHITECTURE
 INTERIOR DESIGN
 CODE CONSULTANT
 BUILDING DEPT.
 EXPEDITING

Gerald J. Caliendo, R.A., A.I.A.
Architect, P.C.
 138-72 Queens Boulevard
 Briarwood, NY 11435
 Tel: (718) 268-9098
 Fax: (718) 268-9097
 www.caliendoarchitects.com

KEY PLAN:

CONSULTANTS:
 STRUCTURAL ENGINEER
 MEP ENGINEER
 ENERGY CONSULTANT

CONTRACTOR:
CORAL REEF GC LLC
 2250 N US HIGHWAY 1
 FORT PIERCE FL 34946
 772-292-4784
 OWNER:

AXONOMETRIC
PROPOSED MIXED BUILDING
301 SOUTH OCEAN DRIVE
FORT PIERCE, FLORIDA 34949

REVISION	DATE	DESCRIPTION

SHEET TITLE:

NO.	DATE	DESCRIPTION

DESIGNER: GJC
 CHECKER: GJC
 JOB NO: 2019
 DATE: 08/17/22
 PLOT: 08/17/22

DATE: **123**
 DRAWING: 29 OF

A-230.00