

Property Identification

Site Address: 111 ORANGE AVE
 Use Type: 1800
 Parcel ID: 2410-509-0002-000-1
 Jurisdiction: Fort Pierce
 Account #: 23132
 Map ID: 24/10N
 Sec/Town/Range: 10/35S/40E
 Zoning: Central Co

Ownership

One Eleven Orange LLC
 4521 PGA BLVD Ste 201
 Palm Beach Gardens, FL 33418

Legal Description

MCMULLEN'S PLAT BLK 1 BEG 56 FT S OF NW COR OF BLK 1, TH E 95 FT, TH N 28 FT, TH E 10 FT, TH S 68 FT, TH W 105 FT, TH N 40 FT TO POB AND LOT 4- LESS W 6 FT OF N 28 FT- AND ALL OF LOTS 5, 6, 7, 8 AND 9 AND E 157.87 FT OF W 282.87 FT OF LOT 1 OF AARON LEE'S MAP OF FORT PIERCE BLK K (0.69 AC - 30,128 SF) (MAP 24/10N) (OR 3735-2813)

Current Values

Just/Market: \$1,124,800
 Exemptions: \$0
 Assessed: \$971,080
 Taxable: \$971,080

Historical Values 3-year

Year	Just/Market	Assessed	Exemptions	Taxable
2023	\$1,124,800	\$971,080	\$0	\$971,080
2022	\$882,800	\$882,800	\$0	\$882,800
2021	\$879,700	\$847,240	\$0	\$847,240

Sale History

Date	Book/Page	Sale Code	Deed	Grantor	Price
03-27-2015	3735 / 2813	0002	WD	Eviva Group Florida Inc	\$800,000
02-10-2012	3367 / 0340	0205	WD	Spurrier Investments Inc	\$1,250,000
06-26-2009	3104 / 0566	0205	WD	Boca Ven Land of Ft Pierce Inc	\$1,398,300

Primary Building Information

Finished Area of this building: 31,011 SF
 Gross Sketched Area: 40,438 SF

Exterior Data

View: Roof Cover: Mod Bitimun
 Year Built: 1919 Frame: Conc Blk
 Primary Wall: CB Stucco Story Height: 3 Story
 Roof Structure: BarJst/Rigid
 Grade: Y_D
 No. Units: N/A2
 Building Type: HROF
 Effective Year: 1939
 Secondary Wall:

Interior Data

Bedrooms: 0 A/C %: 100%
 Full Baths: 0 Heated %: 100%
 Half Baths: 0 Sprinkled %: 100%
 Electric: AVERAGE
 Heat Type: FrcdHotAir
 Heat Fuel: ELEC
 Primary Int Wall:
 Avg Hgt/Floor: 0
 Primary Floors: Vinyl Tiles

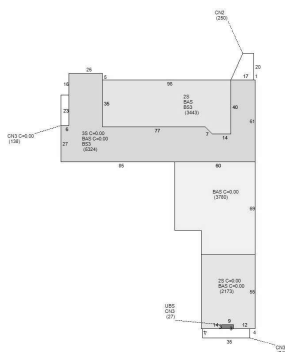

Total Areas

Finished/Under Air (SF):	31,187
Gross Sketched Area (SF):	40,862
Land Size (acres):	0.68
Land Size (SF):	29,836
Total Building Count:	2

Special Features and Yard Items

Type	Qty	Units	Year Blt
ASP2 LOW	1	4485	1976
ELEVATOR	1	2000	1976
ELEVATOR	1	1200	1976