

### Property Identification

Site Address: 409 CEDAR PL  
 Sec/Town/Range: 10/35S/40E  
 Parcel ID: 2403-705-0135-000-2  
 Jurisdiction: Fort Pierce

Use Type: 0800  
 Account #: 16032  
 Map ID: 24/10N  
 Zoning: General Co

### Ownership

CEDAR PLACE LLC  
 1860 SW Fountainview BLVD #  
 STE100  
 Port Saint Lucie, FL 34986

### Legal Description

ASSESSOR'S MAP OF N PART OF FORT PIERCE BLK 16-K- LOTS 10  
 AND 12 (MAP 24/10C)

### Current Values

Just/Market Value: \$78,000  
 Assessed Value: \$78,000  
 Exemptions: \$0  
 Taxable Value: \$78,000



**Property taxes are subject to change upon change of ownership.**

- Past taxes are not a reliable projection of future taxes.
- The sale of a property will prompt the removal of all exemptions, assessment caps, and special classifications.

Taxes for this parcel: [SLC Tax Collector's Office](#)  
 Download TRIM for this parcel: [Download PDF](#)

### Total Areas

Finished/Under Air (SF): 1,612  
 Gross Sketched Area (SF): 1,612  
 Land Size (acres): 0.23  
 Land Size (SF): 10,000

### Building Design Wind Speed

Occupancy Category	I	II	III
Speed	140	160	160

Sources/links:

### Sale History

Date	Book/Page	Sale Code	Deed	Grantor	Price
Aug 7, 2023	5028 / 2812	0111	DEED-WD	Cruickshank Cephus W	\$100
Jul 13, 2006	2629 / 1688	XX01	QC	Cruickshank Cephus	\$100
Apr 1, 1986	0498 / 0478	XX00	CV		\$30,000
Aug 1, 1972	0204 / 2356	XX00	CV		\$11,500

### Building Information (1 of 2)

Finished Area: 832 SF

Gross Sketched Area: 832 SF

### Exterior Data

View:

Roof Cover: Dim Shingle

Roof Structure: Gable

Building Type: MFH  
 Grade: MFFQ  
 Story Height: 1 Story

Year Built: 1947  
 Effective Year: 1947  
 No. Units: 2

Frame:  
 Primary Wall: Wood no Sh  
 Secondary Wall:

Interior Data

Bedrooms: 0  
 Full Baths: 1  
 Half Baths: 0  
 A/C %: 0%

Electric: AVERAGE  
 Heat Type:  
 Heat Fuel:  
 Heated %: 0%

Primary Int Wall:  
 Avg Hgt/Floor: 0  
 Primary Floors: Double Pine  
 Sprinkled %: N/A%

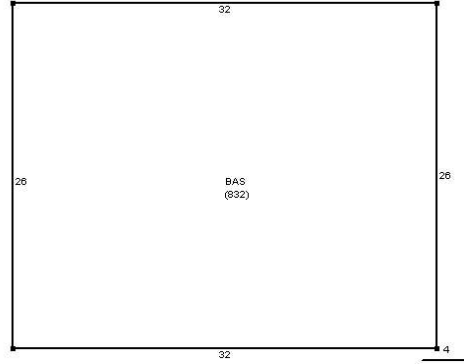

Sketch Area Legend

Sub Area	Description	Area	Fin. Area	Perimeter
BAS	BASE AREA	832	832	116

Building Information (2 of 2)

Finished Area: 780 SF

Gross Sketched Area: 780 SF

Exterior Data

View:  
 Building Type: MFH  
 Grade: MFFQ  
 Story Height: 1 Story

Roof Cover: Dim Shingle  
 Year Built: 1947  
 Effective Year: 1947  
 No. Units: 2

Roof Structure: Gable  
 Frame:  
 Primary Wall: Wood no Sh  
 Secondary Wall:

Interior Data

Bedrooms: 0  
 Full Baths: 1  
 Half Baths: 0  
 A/C %: 0%

Electric: AVERAGE  
 Heat Type:  
 Heat Fuel:  
 Heated %: 0%

Primary Int Wall:  
 Avg Hgt/Floor: 0  
 Primary Floors: Double Pine  
 Sprinkled %: %

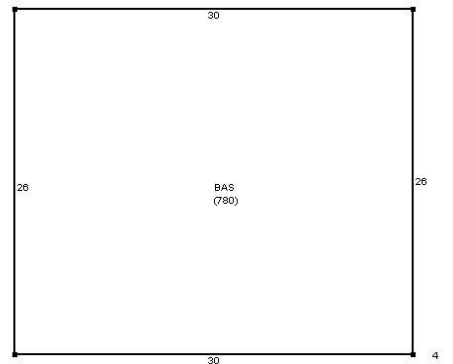

## Sketch Area Legend

Sub Area	Description	Area	Fin. Area	Perimeter
BAS	BASE AREA	780	780	112

## Special Features and Yard Items

Type	Qty	Units	Year Blt
------	-----	-------	----------

## Current Year Values

Current Values Breakdown		Current Year Exemption Value Breakdown	
Building and SFYI:	\$41,400		
Land:	\$36,600		
Just/Market:	\$78,000		
Ag Credit:	\$0		
Save Our Homes or 10% Cap:	\$0		
Assessed:	\$78,000		
Exemption(s):	\$0		
Taxable:	\$78,000		

## Current Year Special Assessment Breakdown

Start Year	AssessCode	Units	Description	Amount
2020	0041	2.4	Fort Pierce Stormwater Charge	\$165.60

This does not necessarily represent the total Special Assessments that could be charged against this property. The total amount charged for special assessments is reflected on the most current tax statement and information is available with the SLC Tax Collector's Office .

## Historical Values

Year	Just/Market	Assessed	Exemptions	Taxable
2024	\$78,000	\$78,000	\$0	\$78,000
2023	\$47,000	\$47,000	\$0	\$47,000
2022	\$45,900	\$45,900	\$0	\$45,900
2021	\$44,600	\$44,600	\$0	\$44,600

## Permits

Number	Issue Date	Description	Amount	Fee
BP16-2469	Nov 7, 2016	Electric	\$900	\$0
BP16-2470	Nov 7, 2016	Electric	\$900	\$0
BP17-2284	Feb 28, 2018	Shed	\$8,000	\$0
BP21-2694	May 3, 2021	Electric	\$100	\$0
24-1408	Apr 25, 2024	Roof	\$8,000	\$0
24-1409	Apr 25, 2024	Roof	\$8,000	\$0

Notice: This does not necessarily represent all the permits for this property.  
Click the following link to check for additional permit data in Fort Pierce