

Michelle Franklin, CFA -- Saint Lucie County Property Appraiser -- All rights reserved.

**Property Identification**

Site Address: 6737 Parcel ID: 2324-342-0001- Account #: 14290 Sec/Town/Range:  
 DARTER CT 000-9 24/35S/39E  
 Map ID: 23/24S Zoning: General Co Use Type: 2200 Jurisdiction: Fort Pierce

**Ownership**

Steak N Shake Oper Inc  
 c/o Ryan LLC  
 PO Box 460169  
 Houston, TX 77056

**Legal Description**

24 35 39 THAT PART OF SEC MPDAF: FROM SW COR OF SEC RUN S 88 24 15 E ALG S LI OF SW 1/4 1848.42 FT TO ELY LI OF CROSSROADS PARK OF COMMERCE PHASE 1, TH N 00 26 24 E 427.36 FT TO N R/W R/W LI OF REYNOLDS DR AND POB, TH S 89 33 15 E ALG N RD R/W LI 141.08 FT, TH N 00 26 24 E 627.88 FT TO S RD R/W LI OF DARTER COURT, TH S 70 36 10 W ALG S RD R/W LI 160.61 FT, TH S 00 26 24 W 562.86 FT TO CURVE CONCAVE NE, R OF 35 FT, TH SELY ALG ARC 12.34 FT, TH S 00 26 24 W 3.37 FT TO POB (1.99 AC) (OR 1261-2150)

**Current Values**

Just/Market: \$1,234,200 Assessed: \$1,234,200  
 Exemptions: \$0 Taxable: \$1,234,200

**Historical Values 3-year**

Year	Just/Market	Assessed	Exemptions	Taxable
2023	\$1,234,200	\$1,234,200	\$0	\$1,234,200
2022	\$1,284,200	\$1,131,350	\$0	\$1,131,350
2021	\$1,345,900	\$1,028,500	\$0	\$1,028,500

**Sale History**

Date	Book/Page	Sale Code	Deed	Grantor	Price
10-25-1999	1261 / 2150	XX00	WD	Merchant Clyde E	\$497,000
11-01-1978	0298 / 0706	XX01	CV		\$0
03-01-1978	0284 / 0650	XX00	CV		\$250,000

**Primary Building Information**

Finished Area of this building: 3,730 SF  
 Gross Sketched Area: 3,883 SF

**Exterior Data**

View: Roof Cover: Mod Bitimun Roof Structure: BarJst/Rigid Building Type: FSFD  
 Year Built: 2000 Frame: Grade: Y\_D Effective Year: 2000  
 Primary Wall: Frm Stucco Story Height: 1 Story No. Units: 1 Secondary Wall:

**Interior Data**

Bedrooms: 0 A/C %: 100% Electric: AVERAGE Primary Int Wall:  
 Full Baths: 0 Heated %: 100% Heat Type: FrcdHotAir Avg Hgt/Floor: 0  
 Half Baths: 0 Sprinkled %: 100% Heat Fuel: ELEC Primary Floors: Tile-Quarry

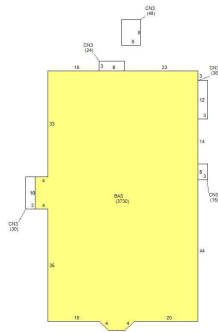

**Total Areas**

Finished/Under Air (SF):	3,730
Gross Sketched Area (SF):	3,883
Land Size (acres):	1.99
Land Size (SF):	86,684
Total Building Count:	1

### Special Features and Yard Items

Type	Qty	Units	Year Blt
6FT CB Wall	1	52	2000
CEMENT CURB	1	285	2000
SINGLE LIGHT	1	1	2000
DOUBLE LIGHT	2	20	2000
CHAINLINK 6'	1	32	2000
ASP2 LOW	1	37952	2000
CONCRETE LOW	1	750	2000

---

All information is believed to be correct at this time, but is subject to change and is provided without any warranty.  
© Copyright 2024 Saint Lucie County Property Appraiser. All rights reserved.