

### Property Identification

Site Address: 1409 DELAWARE AVE Map ID: 24/09S	Parcel ID: 2409-818-0003- 000-3 Zoning: General Co	Account #: 22783 Use Type: 2100	Sec/Town/Range: 09/35S/40E Jurisdiction: Fort Pierce
--	--	------------------------------------	--

### Ownership

Xiang Lin  
712 Carriage Lake WAY  
Vero Beach, FL 32968

### Legal Description

LA FOND S/D BLK 1 LOT 2-LESS RD R/W- (OR 3572-656;  
3636-1491)

### Current Values

Just/Market: \$135,600	Assessed: \$36,905	Year	Just/Market	Assessed	Exemptions	Taxable
Exemptions: \$0	Taxable: \$36,905	2023	\$135,600	\$36,905	\$0	\$36,905
		2022	\$110,100	\$33,550	\$0	\$33,550
		2021	\$30,500	\$30,500	\$0	\$30,500

### Historical Values 3-year

### Sale History

Date	Book/Page	Sale Code	Deed	Grantor	Price
10-16-2013	3636 / 1491	0112	SPWD	Lin Xiang	\$0
10-16-2013	3572 / 0656	0112	SPWD	Suntrust Bank Trea Coast Na	\$80,500
08-16-2013	3578 / 0797	0112	CertTtle	Land Acquisitions of SE FL LLC	\$100

### Primary Building Information

Finished Area of this building: 1,502 SF  
Gross Sketched Area: 1,502 SF

#### Exterior Data

View:	Roof Cover: Mod Bitimun	Roof Structure: Flat/Shed	Building Type: REST
Year Built: 1950	Frame:	Grade: Y_D	Effective Year: 1970
Primary Wall: CB Stucco	Story Height: 1 Story	No. Units: 2	Secondary Wall:

#### Interior Data

Bedrooms: 0	A/C %: 100%	Electric: AVERAGE	Primary Int Wall:
Full Baths: 0	Heated %: 100%	Heat Type: FrcdHotAir	Avg Hgt/Floor: 0
Half Baths: 0	Sprinkled %: 0%	Heat Fuel: ELEC	Primary Floors: Tile-Ceramic

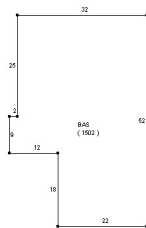

### Total Areas

Finished/Under Air (SF):	1,502
Gross Sketched Area (SF):	1,502
Land Size (acres):	0.14
Land Size (SF):	6,106
Total Building Count:	1

### Special Features and Yard Items

Type	Qty	Units	Year Blt
CHAINLINK 6'	1	120	1960
CONCRETE LOW	1	600	1960